



2026 Time to Camp RV Show

Thurs-Sat 9am-6pm
April 2nd-4th

Huge volume discounts!

OUR LARGEST SELECTION EVER!

New RVs Starting at *\$134/month

BRINKLEY SALEM inTech SUNSET PARK RV MANUFACTURING ADVENTURE Open Range KZ KEYSTONE

SHOW SPECIAL!

****\$195/month**

\$20,991

2026 Open Range Colt 26DBS

RV BUSINESS

TOP 50

DEALER AWARDS

WHAT CUSTOMERS WANT AND DESERVE

- Premier RV Named RVDA Top 50 Dealers in the Nation 2 years in a row!
- Iowa's *ONLY* 2025 Top 50 Dealer!
- Quality Brands at Volume Discounted Prices
- No Pressure, Transparent Sales Process
- Family Owned with Over 400 Years of RV Experience

NO HIDDEN FEES

563-424-7788

746 Industrial Drive, Blue Grass, Iowa 52726

www.premierrv.com

Check out our Facebook page!

facebook.com/premierrviowa

Not responsible for printing errors

RVDA Top 50 Dealership in North America Press Release

[Blue Grass, IA] – Local business Premier RV was recently recognized as a 2024 & 2025 RVBusiness Magazine Top 50 RV Dealers of North America before hundreds of colleagues, friends and family at a gala awards ceremony held in conjunction with the RV Dealers Association Convention/Expo in Las Vegas.

Brad and Brandy Thompson were thrilled to receive this award on behalf of their team in only their fourth year back in the RV business after owning and operating Thompson Family RV from 1957 to 2017 with their family partners Darlene (Jim) Thompson, Mark (Dawn) Thompson, Tim (Brenda) Thompson, Jill (Larry) Tappendorf and Ann (Paul) Thordyke. Jason Rettler, VP of Service and Kayla Taylor, comptroller, Payton Thompson, finance manager, Natalie Moore, administrative assistant, also represented Premier RV leadership team in Vegas.

Now in its 14th year, RVB's Top 50 program is designed to recognize the very best RV dealerships in the United States and Canada. This season's run began earlier this year when RV manufacturers nominated elite dealer partners for consideration, who were then invited to complete comprehensive application materials. An anonymous, independent panel of judges, all with decades of experience in the RV industry, then convened for two days of review and selection to arrive at the Top 50 and its special awardees.

"It's amazing to be recognized as part of one of the best teams in the country," Brad Thompson stated. It's no wonder why Premier RV separates itself from the over 3000 RV Dealers in the country with its over 400 years of combined RV experience, transparent, no fee pricing structure, A+ BBB rating, and 4.9 Google reviews.

Program Administrator BJ Thompson explained that judges evaluate dealers on sound business practices, marketing savvy, proactive employee development, community involvement and commitment to high-quality customer care.

"Throughout the RV industry's evolution, the one constant is the need to take care of people – the RVers themselves, as well as their staff and their neighbors," said Thompson. "Holding up these awardees as examples each year illustrates all the good things happening in our industry and inspires others to do more of the same. Everyone wins." Premier RV is proud to carry on the legacy of the Thompson Family and its team. With this award Premier RV and Thompson Family RV have won this award a total of 5 times out of the last fourteen years even with a 5-year hiatus out of the industry.





GET PRE-APPROVED IN SECONDS!

- ✓ No effect on credit score
- ✓ No SSN or DoB



SCAN TO GET
PRE-APPROVED!

2025 Closeouts

 2025 InTech Sol Eclipse #2545 \$35,951 Super Value ***\$295 per month	 2025 Brinkley Model I 265 #2678 \$48,991 Super Value ***\$400 per month	 2025 Venture Stratus 262VFK #2505 \$34,991 Super Value ***\$285 per month	 2025 Venture Stratus 302VBH #2608 \$38,891 Super Value ***\$320 per month	 2025 Forest River Salem CL 22 Veranda #2426, #2428 \$29,981 Super Value ***\$245 per month
 2025 Keystone Bullet 310RES #2473 \$37,751 Super Value ***\$310 per month	 2025 KZ Connect 323MKK #2512, 2621 \$44,891 Super Value ***\$365 per month	 2025 Forest River Salem Hemisphere (FW) 375FAM #2453, #2454 \$59,991 Super Value ****\$430 per month	 2025 Forest River Salem Hemi (FW) Roost43 #2618 \$79,991 Super Value ****\$570 per month	 2025 Brinkley Model G (FW) 4100 #2450 \$147,991 Super Value ****\$1,055 per month

*Financing figured with 15% down plus tax, title and license WAC for 120 Months at 7.99% **Financing figured with 15% down plus tax, title and license WAC for 144 Months (Some inventory over \$50,000 may qualify for 240 months) at 7.99% ***Financing figured with 15% down plus tax, title and license WAC for 180 Months at 7.99%. ****Financing figured with 15% down plus tax, title and license WAC for 240 Months at 7.99%. See your sales associates for more details*

2026 Sportsmen Classic/Se

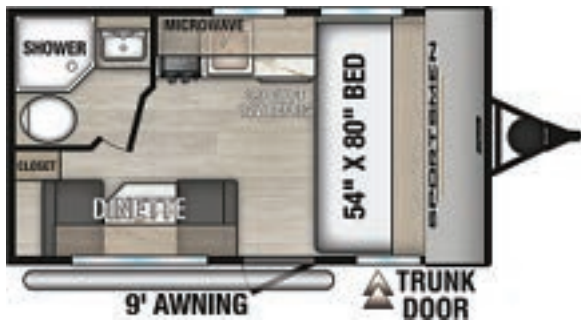

- ### 2026 Sportsmen SE Advantages over the Competition
- Made by Thor Industries- #1 manufacturer of RVs in the World
 - Conventional construction – Studs are 16” on center
 - 5/8” tongue and groove plywood floor decking w/sub floor vs competition’s OSB planks
 - One-piece PVC roof membrane – Higher solar reflectivity so you aren’t as hot in the summer
 - 3/8” roof decking – Fully walkable when most of this size you cannot stand on
 - 2-year True hitch to bumper warranty
 - Tankless on-demand water heater
 - Keyed-Alike system for entry and baggage doors
 - Bathroom Sink Standard
 - 13.5K ROOF mounted AC vs competition’s side mounted AC
 - Stabilizer jacks in all corner vs only two on the rear corners

Classic 130RD 2,570 lbs

\$12,991 ***\$134** per month



2026 Sunset Park Travel Trailers



Sunray 119 1,795lbs
\$13,691 ***\$145** per month



Sunray 149 2,140lbs
\$15,491 ****\$160** per month



"Cha Cha" Retro R186 3,380 lbs
\$23,991 ****\$225** per month

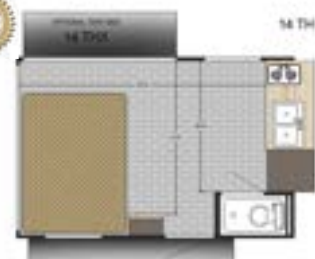

Sun Lite 14THX Toy Hauler 2,630lbs
\$19,991 ****\$190** per month

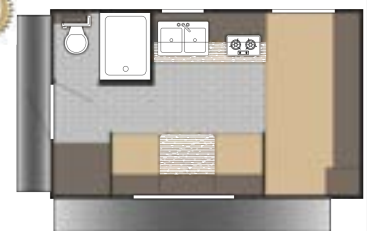

Sun Lite 16BH 2,580 lbs
\$16,991 ***\$175** per month

*Financing figured with 15% down plus tax, title and license WAC for 120 Months at 7.99%. **Financing figured with 15% down plus tax, title and license WAC for 144 Months (Some inventory over \$50,000 may qualify for 240 months) at 7.99%. ***Financing figured with 15% down plus tax, title and license WAC for 180 Months at 7.99%. ****Financing figured with 15% down plus tax, title and license WAC for 240 Months at 7.99%. See your sales associates for more details*.

2026

Open Range Colt

A JAYCO FAMILY COMPANY



2026 Colt 17QB 3,120 lbs

\$13,491 ****\$140**
per month



2026 Colt 17DB 3,330 lbs

\$13,491 ****\$140**
per month



2026 Colt 18MBS 3,990 lbs

\$17,991 ****\$170**
per month



2026 Colt 21QB 4,522 lbs

\$18,991 ****\$175**
per month



2026 Colt 26DB 4,715 lbs

\$18,991 ****\$175**
per month



2026 Colt 26DBS 5,750 lbs

\$20,991 ****\$195**
per month



Fiberglass Exterior 2026 Colt 32DSB 7,075 lbs

\$34,991 *****\$285**
per month



2026 Open Range Colt Advantages

- Magnum Roof Truss – 4,500lb rating, screwed not stapled, 50% stronger than the competition.
- PVC Roof membrane – reflects heat so camper stay cooler & limited lifetime warranty.
- 3/8" marine grade roof decking – 4'x8' sheets, fully walkable & superior water resistance.
- All models are 8' wide – more floor space and more storage
- 5/8" marine grade main floor decking – screwed & glued = stronger and less squeaks.
- 16" on center floor joists – stronger & no saggy floors.
- Integrated A-frame – more welds and double the fastening points for superior strength.
- Extruded 1-piece I beams – no seams = stronger frames.
- Full width floor outriggers – supports the full weight of the walls
- PEX water lines – residential grade water lines.
- Galvanized wheel wells – wont crack like plastic.
- Magnetic baggage door catches – no more broken plastic clips
- Self-adjusting electric brakes & EZ lube axles
- 12v refrigerator – more efficient to run.
- 75lb. ball bearing drawer glides.
- 81" interior height vs most of the competition is 78" tall.
- Flush floor slides – no annoying lip to trip over.
- Residential hidden cabinet hinges – last longer and they are adjustable.
- Pocket screwed lumber core cabinetry – made with real wood and screwed not stapled together.
- All windows, entry & baggage doors are perimeter framed – support for all openings.
- Double wide exterior corner molds – twice the seal area to protect from water.
- Tankless on demand water heater – more hot water and no cold showers.
- Prepped for rear wall ladder & back up camera – easy installation.
- Molded holding tanks – no seams for less leaks.

*Financing figured with 15% down plus tax, title and license WAC for 120 Months at 7.99%. **Financing figured with 15% down plus tax, title and license WAC for 144 Months (Some inventory over \$50,000 may qualify for 240 months) at 7.99%. ***Financing figured with 15% down plus tax, title and license WAC for 180 Months at 7.99%. ****Financing figured with 15% down plus tax, title and license WAC for 240 Months at 7.99%. See your sales associates for more details*.

2026

Salem LE & Salem FSX

**FOREST RIVER**

177ICE 4,099 lbs

\$18,871****\$175 per month**

178BHSX 4,375 lbs

\$19,991****\$185 per month**

Fiberglass Exterior

2026

Salem & Salem Cruise Lite

2026 Salem & Salem Cruise Lite Advantages

Salem Cruise Lite

- Power Stabilizer Jacks
- Versa Furniture
- Enclosed Accessible Underbelly
- Tankless Water Heater
- PVC Roof
- Heavy Duty Aluminum Siding
- Versa-Tilt KING Bed
- LED Blade Lighting

Salem

- Versa-Flex: Desk, Dinette & Chaise
- Heated and Enclosed Accessible Underbelly
- 81" Ceiling Height
- Flush Floor Slideout
- Power Stabilizer Jacks
- Versa Furniture
- Enclosed Accessible Underbelly
- Tankless Water Heater
- PVC Roof
- Heavy Duty Aluminum Siding
- Versa-Tilt KING Bed
- LED Blade Lighting



Cruise Lite 28VBXL 6,208 lbs

*****\$260 per month****\$31,991**

300ICE 7,893 lbs

*****\$285 per month****\$34,491**

31KQBTS 8,537 lbs

*****\$325 per month****\$39,991**

2026

Sienna & Sienna Lite by Venture RV



SIENNA LITE 140VFD

\$14,991 2,750 lbs

*****\$155**
per month



SIENNA 251VRB 6,190 lbs

\$29,991 ******\$245**
per month



8,510 lbs Sienna 293VIK

\$39,731 ******\$325**
per month



Sienna & Sienna Lite Advantages

Sienna Lite:

- Gloss Armor Guard Siding - .030 high gloss white exterior metal w/ baked enamel finish:
 - 30% thicker than industry norm
 - High gloss = easier cleaning & longer lasting exterior finish
 - White metal has less heat absorption = efficient cooling
- BAL NXG Frame vs competitions manual welded/painted frame
- Tankless on-demand water heater
- Fully walkable roof – easier to service
- PVC roof membrane – limited lifetime warranty
- Seamless Surf(X) counter & tabletops
- Full extension ball bearing drawer guides
- Dexter axles & hubs w/self-adjusting brakes

Sienna:

- Gloss Armor Guard Siding - .030 high gloss white exterior metal w/ baked enamel finish: (same as Sienna Lite - see above)
- BAL NXG Frame vs competitions manual welded/painted frame
- Invision appliance suite:
- 10CuFt 12V fridge
- 18" 3-burner stove w/ oven
- Forced air heated and enclosed underbelly
- Residential fiberglass insulation
- Insulation wrapped holding tanks-camp longer in cooler season
- 50amp service w/ second AC prep on most models
- Tankless on-demand water heater
- 30,000 BTU furnace – competitors are around 20k BTU
- Plus 5000 BTU fireplace (except 231VRK)
- Central command center (w/ app control)
- BAL 5.0 power stabilizers – easy to use push button control



2026 Model Ix Advantages

- Premium Residential Cabinets with Dovetail Drawers, a hallmark of high-end cabinetry
- Road Armor™ suspension equalizer system & Hankook D rated 8-ply tires with 14" custom aluminum wheels
- Ultra Quiet & Efficient AC with 18K BTU of ducted cooling power
- Powerful Power Package with 200 watt solar panel w/ Victron 30 amp MPPT charge controller + inverter prep
- Road Mode access to refrigerator & bathroom
- Seamless Laminated Aluminum Exterior with automotive grade fully body paint and modern graphics offers clean modern styling and lasting beauty
- Brinkley Slide-Out Dining Table with utensil drawer and 2 folding chairs
- One-Piece Fiberglass Shower with NEON LED marine lighting
- 40" Smart TV with articulating mount
- SoundCore Boom 2 Bluetooth waterproof speaker
- Brinkley automotive-grade sealant package with 3-Year warranty
- Designed For full-time RVing warrantied for full-time RVing
- Queen bed w/ residential 7" memory foam bamboo mattress (60" x80")
- Dual bedside wardrobes & nightstand cubbies w/ USB & USB-C charging ports (CPAP Ready)
- Optional 62" trifold sofa (52"x70" sleeper)
- Tankless on-demand water heater
- 30k BTU furnace
- Heated & enclosed underbelly (circulated forced air)
- Straight frame chassis
- Brinkley On-Command™ docking & utility center
- Industry first brass plumbing fittings
- Industry first low-maintenance roof
- Demco EZ latch trailer coupler

2026

FIRST LOOK Brinkley Model Ix



Model Ix20

5,583 lbs

\$47,995

*****\$390**
per month

- ✓ Lightweight
- ✓ Half-Ton Towable
- ✓ SUV-Towable

\$47,995

*****\$390**
per month



Model Ix 23

5,771 lbs

*Financing figured with 15% down plus tax, title and license WAC for 120 Months at 7.99%. **Financing figured with 15% down plus tax, title and license WAC for 144 Months (Some inventory over \$50,000 may qualify for 240 months) at 7.99%.
Financing figured with 15% down plus tax, title and license WAC for 180 Months at 7.99%. *Financing figured with 15% down plus tax, title and license WAC for 240 Months at 7.99%. See your sales associates for more details*.

2026 KZ Connect SE



301BHKSE
7,050 lbs **\$37,991**
2 Baths!

***\$305
per month



2026 Keystone Bullet Classic Brand Advantages

- Laminated Gel-Coat Fiberglass Exterior
- Fully Walkable Roof
- Tankless Water Heater
- HyperDeck High Performance Water-Resistant Floor
- 3 Year Limited Structural Warranty

2026

Keystone Bullet Classic



Super Value

18RBC 3,890 lbs

\$24,991

**\$230
per month



2026 Open Range - Range Lite

A JAYCO FAMILY COMPANY



Super Value

211RKM
4,960 lbs **\$29,991**

***\$245
per month



250RBL
5,545 lbs **\$33,991**

***\$275
per month



280MKI
7,305 lbs **\$36,991**

***\$300
per month

Range Lite Highlights

- Magnum Roof System
 - PVC Roofing Membrane
 - Walkable Roof
- Tuffshell Fiberglass walls
 - Aluminum Framed w/ Block Foam Vacuum Bonded laminated walls
- Enclosed Docking Station
- Xtend Solar 1 Package Standard
- 12v 10cu. ft. fridge
- Rain guttering with molded drip spouts
- Self adjusting electric brakes
- Thermal seal enclosed insulated and heated underbelly
- 75 lb. ball bearing drawer guides
- 81" Int. height
- Flush floor slides w/ residential vinyl flooring
- Hardwood cabinet doors w/ hidden hinges
- Nitrogen Filled Radial tires w/ aluminum rims

2026 Venture Stratus



Super Value
*****\$320**
 per month
\$38,991



261vrB 6,720 lbs

2026 SportTrek Advantages over the Competition

Sporttrek TT:

- Fiberglass front cap – Durable, aerodynamic front profile resists road wear & enhances exterior styling.
- Azdel laminated sidewalls & rear wall - Lightweight, water-resistant construction prevents rot & improves insulation.
- 5/8" tongue-and-groove floor decking –Strong, residential-grade flooring reduces flex & increases long-term durability.
- Power tongue & stabilizer jacks – Makes setup fast & effortless
- NXG huck-bolt frame – Rigid, automotive-style frame built for superior strength & stability.
- High-polished aluminum rims w/ black accents – Premium wheels add durability & style.
- 82" interior ceiling height – Taller ceilings create more open & spacious interior. More storage than most campers in its class - Offers expanded space for gear without sacrificing living area.
- Beaufloor wood plank flooring w/Beaufloor slide floors – Durable, low-maintenance flooring resists moisture & looks like real wood.
- 12V heat pad on fresh water tank –Protects your fresh tank from freezing so you can camp confidently in cold weather.
- Reflective PVC roof membrane – Provides long-lasting, heat-reflective protection to keep the RV cooler & prevent roof wear.
- Serta memory foam mattress - Upgrades sleep quality.
- Modern Farmhouse interior w/ hand-glazed cabinet doors – Creates warm, stylish living space w/ high-quality craftsmanship.
- Bluetooth connectivity on main control panel - Lets you monitor & operate key RV systems conveniently from your phone.

Sporttrek Touring TT:

- BAL Huck Bolt frame with auto leveling
- AZDEL composite fiberglass sidewalls
- Drop frame for maximum passthrough storage
- One-piece TUFFLEX PVC roof w/ limited lifetime warranty
- Keyed alike entry doors and baggage doors
- 200W Solar standard
- 5/8" tongue and groove plywood flooring – Beaufloor with 7 year limited warranty
- Tankless water heater
- 2 fireplaces standard
- Solid surface countertops
- Heat and massage on theater seating in applicable units
- Forced air heated and enclosed underbelly including gate valves and a 12V heat pad on the fresh tank

2026

SportTrek Total Luxury Trailers



Super Value
\$23,991 3,840 lbs
****\$225**
 per month



Super Value
\$41,491 6,770 lbs
*****\$340**
 per month



Super Value
\$53,991 8,030 lbs
******\$385**
 per month



Super Value
\$61,991 9,290 lbs
******\$440**
 per month



*Financing figured with 15% down plus tax, title and license WAC for 120 months at 7.99% **Financing figured with 15% down plus, tax, title and license WAC for 144 Months (Some inventory over \$50,000 may qualify for 240 months) at 7.99%
 Financing figured with 15% down plus tax, title and license WAC for 180 Months at 7.99%. *Financing figured with 15% down plus tax, title and license WAC for 240 Months at 7.99%. See your sales associates for more details*



2026 Intech RV

Intech Advantages

- (Class leading) Fully welded cage to the chassis to eliminate twists or structural weaknesses
- Weight friendly- cut by 1/3 using aluminum instead of steel

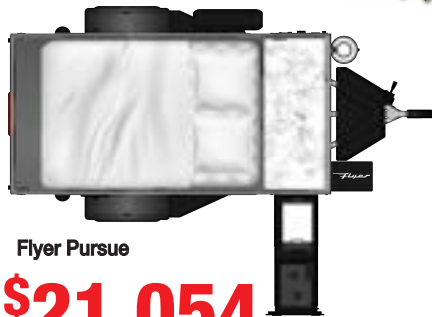

Flyer Pursue

\$21,054

1,690 lbs

****\$200**
per month



Sol Dusk

3,980 lbs

\$44,621

*****\$365**
per month

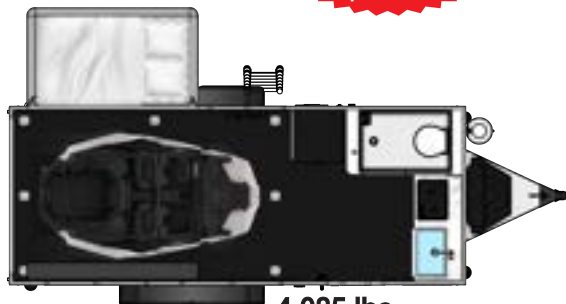

Flyer Forge

4,085 lbs

2nd pull down
bunk optional!

\$38,285

*****\$315**
per month



Aucta Magnolia Rover

5,086 lbs

\$59,995

******\$430**
per month



Aucta Willow

5,850 lbs

\$64,885

******\$460**
per month



Aucta Sycamore

6,930 lbs

\$69,995

******\$500**
per month

Bunks/Multi Office



Black Wing 830-x

6,500 lbs

\$79,995

******\$570**
per month



2026 BRINKLEY TRAVEL TRAILERS



2025 Model I 265

\$48,991

7,623 lbs

***\$400/mo*



Model I 275

\$62,995

7,894 lbs

****\$450/mo*



Model I 280

\$69,995

8,411 lbs

****\$500/mo*



Model Z Air 285

\$69,991

9,888 lbs

****\$500/mo*



Model Z Air 310

\$91,995

10,961 lbs

****\$660/mo*



*Financing figured with 15% down plus tax, title and license WAC for 120 Months at 7.99% **Financing figured with 15% down plus tax, title and license WAC for 144 Months (Some inventory over \$50,000 may qualify for 240 months) at 7.99% ***Financing figured with 15% down plus tax, title and license WAC for 180 Months at 7.99%. ****Financing figured with 15% down plus tax, title and license WAC for 240 Months at 7.99%. See your sales associates for more details*

2026 Open Range Roamer Advantages

Roamer Light Duty

- Alpha Ply TPO Roof Membrane (Thickest roof membrane)
- Thermal Seal zero-degree tested weather protection
- Dexter Rubberized Suspension for smoother ride and less road shock
- Vacuum Bonded Laminated Construction- superior construction process exclusive to Jayco's Family of recreation vehicles. EVERY sidewall, rear wall and slide room wall is bonded together for a minimum of 16 minutes under 144 tons of pressure to create the lightest yet strongest construction available in the RV industry
- Porcelain Toilet
- 15,000 BTU Whisper Quiet A/C
- On Demand Water Heater
- 200 watt solar panel & 30amp Solar Charge Controller

Roamer:

- Everything above
- LED Fireplace with 5,000 BTU electric space heater
- Solid Surface Countertops
- Auto Leveling



2026 Open Range Roamer 5th Wheel

A Jayco Family Company



Roamer Light Duty
24MLDS 8,115 lbs

\$36,991

*****\$300
per month**



29RLDS 9,750 lbs

\$49,991

*****\$410
per month**



32RLTS 11,050 lbs

\$59,991

*****\$430
per month**



35MRQS 13,125 lbs

\$63,991

*****\$455
per month**



Keystone Arcadia 5th Wheel



\$38,991

Select 27SBH
7,895 lbs

*****\$320
per month**



2026 Keystone Arcadia Advantages

- Frameless windows
- Painted fiberglass front cap – Resists Fading & Wear
- Rotoflex pinbox – Reduces chucking & absorbs road shock
- Giddy Box – Centralized, wiring hub simplifies troubleshooting & improves electrical reliability.
- Tankless water heater
- Heated enclosed underbelly – Protects tanks and lines
- Color-coded wiring – Streamlined wiring layout
- Residential hardwood cabinet doors
- Blade air handling system – Maximizes airflow efficiency for faster cooling & more consistent interior comfort.
- Towing hitch – Adds rear utility for bike racks or small cargo carriers to expand what you can bring along.
- Dual-zone Bluetooth radio with DVD player – Lets you enjoy separate indoor/outdoor audio zones w/ wireless control.
- Keystone's network of dealerships & customer support – Provides nationwide service access for peace of mind wherever you travel.

2026 Keystone Sprinter Advantages

- Wide body for more space inside
- TPO roof membrane with lifetime warranty
- One-piece DynaSpan flooring
- Heated & enclosed underbelly, including gate valves and tank heating pads
- Full profile for maximum space in the front of the coach
- 2 interior color options, Teak and Sand
- E-Z Lube Dexter axles w/ Nev-R-Adjust brakes
- Winegard 360 antenna with built in WiFi hotspot
- Radiant foil insulation in the floor, roof, and main slidebox floor
- Solarflex prepped- packages can include 220W, 440W, or 660W of solar
- Units are inverter prepped
- Tru-Fit slide construction to increase slide durability, decrease motor stress, and protect from weather



2026

Keystone Sprinter FW



3980FBS

\$67,991

12,661 lbs

****\$485 per month

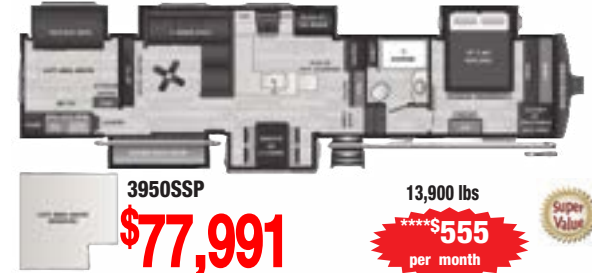

3950SSP

\$77,991

13,900 lbs

****\$555 per month

2026 Venture SportTrek Touring FW



Sporttrek 303VIK

10,390 lbs

\$62,991

****\$450 per month



Sporttrek 353VIK

11,750 lbs

\$69,991

****\$500 per month



Sporttrek Touring 354VBH

12,610 lbs

\$68,741

****\$490 per month



Sporttrek Touring 365VFL

12,510 lbs

\$79,995

****\$570 per month

2026 SportTrek 5th Wheel Advantages over the Competition

- BAL NXG Huck-bolted, powder-coated drop-frame construction engineered to prevent frame failure
- MorRyde CRE 3,000 suspension for smoother towing and reduced road shock
- Painted fiberglass front cap with LED lighting
- Laminated rear wall and Azdel laminated sidewalls with closed-cell foam insulation
- Three-layer insulation system with residential fiberglass and radiant foil in roof, floor, and front wall
- Fully heated and enclosed one-piece underbelly with forced-air heated gate valves
- Radiant foil-wrapped and heated holding tanks
- Heat ducting into pass-thru storage areas
- Reflective Tufflex PVC roof membrane with limited lifetime warranty; higher tear resistance and reduced heat absorption
- 5/8" tongue-and-groove plywood flooring
- Best-in-class 185 cu ft of pass-thru storage
- 200W solar panel with 30A MPPT controller and 1200W inverter
- Tankless on-demand water heater
- 18 cu ft 12V double-door refrigerator
- 21" oven with air-fryer functionality
- Solid hardwood cabinet doors and drawer faces with solid-surface countertops
- Venture Control Center with Bluetooth connectivity
- BAL 4-point electric leveling system
- Multiple fireplaces including 5,000-BTU living room and bedroom units (select models)
- Washer/dryer prep
- Outside kitchen (select models) with 40" smart TV, JBL Bluetooth speaker, 3 cu ft fridge, Lodge griddle, stainless sink, spray hose, and hot/cold adjustable faucet

2026 Open Range 3X Luxury Fifth Wheels by Highland Ridge RV



14,565 lbs 3X 390TBS



\$89,991

****\$640 per month

- 3" Thick Side Walls
- 102" Wide Body
- 84" tall & 48" Deep Accu-slide
- Tuff-Shell Vacuum Bonded Construction
- 3x 15000 BTW A/Cs Standard

*Financing figured with 15% down plus tax, title and license WAC for 120 Months at 7.99% **Financing figured with 15% down plus tax, title and license WAC for 144 Months (Some inventory over \$50,000 may qualify for 240 months) at 7.99%
 Financing figured with 15% down plus tax, title and license WAC for 180 Months at 7.99%. *Financing figured with 15% down plus tax, title and license WAC for 240 Months at 7.99%. See your sales associates for more details*

2026

BRINKLEY

Model Z



Brinkley 2680

11,118 lbs

\$87,995

****\$625
per month



Brinkley 2700

11,462 lbs

\$96,995

****\$690
per month



Brinkley 2810

12,296 lbs

\$89,995

****\$640
per month



Brinkley 2900

12,190 lbs

\$96,995

****\$690
per month



Brinkley 3100

12,524 lbs

\$98,995

****\$705
per month



Brinkley 3200

12,476 lbs

\$102,995

****\$735
per month



Brinkley 3420

ON ORDER

14,794 lbs

\$111,995

****\$800
per month ..



Brinkley 3600

\$123,995 (****\$885/mo) - FULL BODY PAINT

\$104,995

****\$750
per month



Brinkley 3610

15,192 lbs

\$113,995

13,998 lbs
****\$810
per month



Model Z

Advantages over the Competition

- Every units undergoes a 350+ point inspection at the factory
- 3-year limited internal seals & gasket warranty
- 20- year roof membrane warranty & 25-year seal warranty
- Industry exclusive road simulation shake test
- Monotube chassis (built to Brinkleys specs and certified)
- Chassis is triple powder coated
- 4-point or 6-point one-touch auto leveling with wide stance jacks is standard
- Backup camera & wireless monitor with observation/security mode
- Pre-wired for up to 5500w generator (front storage compartment)
- Hydraulic jacks and slides
- Soft close cabinets and drawers
- 18k BTU Furrion Chill Cube main air conditioner with heat pump
- 13.5k BTU Front (bed & bath) with heat pump is standard
- Ductless floors in main living areas(better distribution of heat)
- 76" slide box height
- 79.5" ceiling height in front bedroom (industry best)
- Full-time RV warranty
- 17.5" H-Rated Michelin tires with TPMS
- Banded tire pressure monitoring system (TPMS) with wireless display is standard
- Galvanized wheel well shields
- TCS suspension with 5" of travel (reduces frame shock by 50%)
- Anit-lock braking system (ABS) with anti-sway & Dynamic brake boost is standard
- 2" rear receiver hitch with 4-way connector (300lbs tongue weight & 3,000lbs GTW)
- Curt Helux pinbox standard (30% shock reduction from average pinbox)
- PEX plumbing with Brass fittings (industry first)
- ALL water sources have shutoff valves
- 65' retractable city water hose on every model
- Thermaflex heat duct (no kinks binds or tears)
- 5/8" Marine grade OSB one-piece floor decking
- Average CCC of 3,400lbs
- 370W solar panel and 50A charge controller standard (scalable to 740W)
- Full body paint is an option in 2026

2026



2026 Brinkley Model G



3970

\$181,995

18,982 lbs
1,295
per month



2025 Closeout!

4100

\$147,991

18,724 lbs
1,055
per month

Advantages over the Competition

- 7k Dexter axles with disc brakes, 8k leaf springs & SUMO springs for improved stopping power, shorter stopping distances, and reduced shock
- FireFly control center for remote control of A/C, generator, and subsystems via WiFi
- RGB front cap light with turn signal functionality
- Impact Guard fiberglass roof with .040" UV-protected membrane (10-year warranty, 30-50 year life expectancy)
- Victron MultiPlus II inverter/charger, 50A charge controller & DC-to-DC charger
- Three-season doors with residential handle, rubber seals, and sealed hinges to prevent water intrusion
- Brinkley chassis with full hanger boxes, V-brackets between hangers, thicker aluminum wall tubing, added gussets, and individually powder-coated frames
- 5/16" chassis flanges at pin box/gooseneck connection (vs. standard 1/4")
- Only brand with GEN-Y king pin standard and gooseneck option
- Highest average CCC in its class (over 4,900 lbs)
- .078" thick fiberglass (vs. .065" competitors) for better resistance to temperature, moisture, and environmental stress
- RVMP Flex Temp on-demand tankless water heater: zero fuel when idle, 140° emergency cutoff, freeze protection, unlimited hot water
- Furrion Vision S+ observation system standard
- Industry-leading 110+ cu ft pass-through storage
- 12V outdoor fridge/freezer
- RVMP 5500e dual-fuel generator with EFI (no elevation or cold-weather issues)
- Dovetail drawer boxes, soft-close cabinet doors and drawers
- Largest pull-out pantry in the industry with adjustable shelves
- 30" GE Profile microwave with air fryer & 19 cu ft GE Profile refrigerator
- Dishwasher prep
- Multifunctional garage (flex space/bonus room/office)
- Premium Rockford Fosgate audio system throughout

*Financing figured with 15% down plus tax, title and license WAC for 120 Months at 7.99% **Financing figured with 15% down plus tax, title and license WAC for 144 Months (Some inventory over \$50,000 may qualify for 240 months) at 7.99%
Financing figured with 15% down plus tax, title and license WAC for 180 Months at 7.99%. *Financing figured with 15% down plus tax, title and license WAC for 240 Months at 7.99%. See your sales associates for more details.*

SCHEDULE YOUR APPOINTMENT NOW!

With over 400 years of RV experience, Premier RV has the service dept. you can trust!

DID YOU KNOW MANUFACTURERS RECOMMEND:

- **Preventative sealing** all windows, doors, and extrusions on your RV every 6-12 months
- **Wheel bearings and breaks adjusted** once a year or every 12,000 miles (Adding grease to the buddy bearings is not the same and typically customers will add too much causing problems)
- **Clean and condition** your rubber roof at least once a year

Servicing your RV on a regular maintenance schedule is necessary to ensure its safety and reliability!

PREFERRED

-WHEEL/HUB MAINTENANCE \$490

Pack wheel bearings & replace axle seals

Inspect & adjust brakes & inspect suspension

Check tire wear & inflation

Torque wheel lug nuts

-DLX. EXTERIOR ROOF MAINTENANCE \$1325

Rubber roof clean & wash

Condition rubber roof including slideout rooms

Seal Roof seals/seams (R&R roof tape excluded)

(may need to stay overnight for sealant to setup)

-EXTERIOR SEAL PACKAGE \$1525

Reseal exterior trim & moldings (no roof)

Reseal windows, doors,

compartments

Reseal belt rails & running lights

-SLIDE OUT MAINTENANCE \$485

Inspect slide out seals & spray w/ conditioner

All exposed slide out gear lubed

Inspect slide out adjustment

-HOUSE BATTERY CHECK \$119

Check fluid levels & test battery

Cleaning of battery cables, posts & battery top

-WATER HEATER INSPECTION \$179

Clean & adjust burner

Clean pilot orifice & burner tube

Adjust airflow to insure proper operation

-LP FURNACE INSPECTION \$359/EA.

Clean & inspect burner

Clean & inspect orifice/ignitor

Check for proper LP pressure & adjust as needed

Perform a carbon monoxide & LP test

-REFRIGERATOR INSPECTION (NON RESID) \$239

Check operation on 110V, 12V & LP

Inspect refrigeration ventilation

Clean & adjust burner & orifice

LP test

(takes 2 days for maintenance)

-ROOF AIR INSPECTION \$299/EA.

Amp draw test & clean filter

Inspect air flow & tighten installation bolts

-OVEN & RANGE INSPECTION \$179

Check & clean manifold & burner

Clean & adjust pilot light

Clean & adjust LP pressure & air flow for efficiency

LP test

Zero Slides

retail \$4359 **YOUR COST \$3639**

With Slide Out

retail \$5199 **YOUR COST \$4939**

3 or More Slide Outs

retail \$6589 **YOUR COST \$6259**

VALUE

-WHEEL/HUB MAINTENANCE \$490

Pack wheel bearings & replace axle seals

Inspect & adjust brakes

inspect suspension

Check tire wear & inflation

Torque wheel lug nuts

-DLX. EXTERIOR ROOF MAINTENANCE \$1325

Rubber roof clean & wash

Condition rubber roof including slideout rooms

Seal Roof seals/seams (R&R roof tape excluded)

(may need to stay overnight for sealant to setup)

-EXTERIOR SEAL PACKAGE \$1525

Reseal exterior trim & moldings (no roof)

Reseal windows, doors, compartments

Reseal belt rails & running lights

Zero Slides

retail \$2500 **YOUR COST \$2229**

With Slide Out

retail \$3340 **YOUR COST \$2999**

3 or More Slide Outs

retail \$4240 **YOUR COST \$3849**

BASIC

-WHEEL/HUB MAINTENANCE \$490

Pack wheel bearings & replace axle seals

Inspect & adjust brakes

inspect suspension

Check tire wear & inflation

Torque wheel lug nuts

-DLX. EXTERIOR ROOF MAINTENANCE \$1325

Rubber roof clean & wash

Condition rubber roof including slideout rooms

Seal Roof seals/seams (R&R roof tape excluded)

(may need to stay overnight for sealant to setup)

Zero Slides

retail \$1565 **YOUR COST \$1379**

With Slide Out

retail \$1815 **YOUR COST \$1619**

3 or More Slide Outs

retail \$1965 **YOUR COST \$1739**

ECONOMY

-WHEEL/HUB MAINTENANCE \$490

Pack wheel bearings & replace axle seals

Inspect & adjust brakes

inspect suspension

Check tire wear & inflation

Torque wheel lug nuts

-BASIC EXT. ROOF MAINT. \$359

Rubber roof clean & wash

Condition rubber roof including slideout rooms

Inspect roof seals & seams

Zero Slides

retail \$709 **YOUR COST \$679**

With Slide Out

retail \$849 **YOUR COST \$739**

3 or More Slide Outs

retail \$909 **YOUR COST \$799**

X Based on Tandem Axle



Travel Trailers

Stock#	Layout	Seeds	Ext.	Side	Year	Model	Bed	Air	Amino	UVW	Status	Price	Super Value
2908	FK	4	FIB	1	2025	KZ Connect Mini 181FKK	CQ	1	electric	4220	90 day	\$22,995	\$19,991
3223	RB	2	AL	0	2024	Sunset Park Sun Lite 18RD	QI	1	electric	2850	as-is	\$16,795	
2865	RB	2	FIB	0	2021	Forest River No Boundries 19.2	MB	1	electric	3565	as-is	\$19,995	\$14,991
2879	RB	4	FIB	1	2022	Forest River Surveyor Legend 19RBLE	QI	1	electric	3865	as-is	\$18,995	\$15,991
3020	BH	8	FIB	0	2022	Primetime Tracer LE 200BHSLE	QI	1	electric	4321	as-is	\$16,995	\$15,991
3116	RB	4	FIB	1	2023	Starcraft Autumn Ridge 20FBS	QI	1	electric	4799	as-is	\$19,995	\$18,991
3021	BH	8	FIB	0	2025	Keystone Passport Classic 214BH	MB	1	electric	4370	90 day	\$23,995	
3182	RB/RK	4	FIB	1	2022	FR Rockwood Mini Lite 2109S	QI	1	electric	4508	as-is	\$22,995	
2321	RE	3-4	FIB	1	2023	KZ Connect SE 221RESE	QI	1	electric	5134	as-is	\$25,991	\$22,991
2792	RB	4	FIB	1	2017	Dutchmen Kodiak 223RBSL	QI	1	electric	4500	as-is	\$16,995	\$13,991
2876	RB	4	AL	1	2022	Winnebago Minnie 2201MB	MB	1	electric	5741	as-is	\$20,595	\$17,991
3016	FD	4	AL	0	2024	InTech Terra Magnolia	QC	1	electric	5086	as-is	\$49,995	\$47,991
2852	RB	4	FIB	1	2013	Forest River Rockwood 2304S	MB	1	electric	4775	as-is	\$8,995	\$7,991
3296	RD	6	FIB	1	2024	Gulfstream Vintage Cruiser 23TWS	QI	1	electric	3924	as-is	\$24,995	
2898	BH	8	FIB	1	2023	Coachmen Apex Ultra-lite 245BHS	QI	1	electric	4668	as-is	\$26,995	\$21,991
3022	BH	8	FIB	1	2024	Jayco Jay Feather 24BH	QI	2	electric	6266	as-is	\$32,995	\$28,991
3065	RL	6	AL	1	2019	Jayco Jay Flight SLX 8 245RSL	QI	1	electric	5343	as-is	\$14,995	
3269	BH	8	FIB	1	2021	Keystone Bullet 2430BH	QI	1	electric	5030	as-is	\$18,595	
2783	RB	4	FB	1	2024	Wildwood HG Hyper-Lyte 25RBHL	QI	1	electric	6729	as-is	\$29,995	\$28,991
2882	BH	8	FIB	1	2023	Jayco Whitehawk 25MBH	MB	1	electric	6489	as-is	\$34,981	\$32,991
2894	RB	6	FIB	2	2017	Keystone Cougar X-lite 26RBI	KI	1	electric	6120	as-is	\$19,995	\$18,991
3227	RB	6	FIB	1	2018	Keystone Outback 266RB	QI	1	electric	6560	as-is	\$17,995	
3292	RB	6	FIB	1	2017	Open Range Lite 2604RB	QI	1	electric	?	as-is	Late March	
3294	RL	6	FIB	1	2022	Starcraft Super Lite 262RL	QI	1	electric	6105	as-is	\$22,995	
2648	FK	6	FIB	2	2023	KZ Connect 272FK	KI	1	electric	7120	as-is	\$39,995	\$29,981
2939	RL	4	FIB	2	2020	Keystone Laredo 275RL	KI	1	electric	6540	as-is	\$25,995	\$23,991
3155	RL	2	AL	0	2025	Intech OVR Navigate	TB	1	electric	6057	90 day	\$48,995	
3193	BH	10	AL	0	2021	East To West Silver Lake 27KNS	QI	1	electric	5509	as-is	\$12,995	
3285	RL	6	FIB	1	2019	Heartland Mallard M27	QI	1	electric	5660	as-is	\$16,995	
3290	BH	10	FIB	1	2020	Forest River Rockwood 2706WS	QI	1	electric	?	as-is	Mid April	
3298	RK	6	AL	1	2019	Forest River Salem 27RKS	QI	1	electric	6836	as-is	\$16,995	
3300	RB	6	FIB	2	2017	Forest River Tracer UL 2750RBS	QI	1	electric	6264	as-is	\$16,895	
3306	RK	2	AL	1	2025	Brinkley Model I 275	QI	1	electric	?	90 day	?	
2843	RB	6	AL	1	2022	Crossroads Zinger 280RB	QI	1	electric	6700	as-is	\$23,895	
3289	RK	6	AL	1	2018	Keystone Hideout 28RKS	QI	1	electric	?	as-is	Late April	
3208	RL	4	AL	3	2025	Venture Sienna 293VIK	QI	2	electric	8370	90 day	\$36,995	
3214	RL	6	FIB	1	2006	Jayco Jay Feather LGT 29N	QI	1	manual	5065	as-is	\$5,995	
2964	RK	6	AL	1	2022	KZ Sportsmen SE 301RKSE	QI	2	electric	6440	as-is	\$28,985	\$25,991
3006	BH	9	FIB	2	2022	KZ Connect 312BHKSE	QI	1	electric	7340	as-is	\$28,995	
3083	BH	8	FIB	2	2019	Grand Design Imagine 3170BH	QI	2	electric	8102	as-is	\$24,995	
3104	BH	9	FIB	1	2011	FR Rockwood Ultra Lite 8318SS	QI	1	electric	6743	as-is	\$12,995	
3038	BH	10	AL	2	2018	Jayco Jay Flight 324BDS	QI	1	electric	7758	as-is	\$18,495	
3291	BH	10	FIB	3	2016	Crossroads Sunset Trail 320BH	QI	1	electric	7626	as-is	\$9,995	
3267	RL	4	FIB	3	2024	Venture Sporttrek 343VIK	QI	2	electric	8980	as-is	\$46,995	
Fold Down Campers													
3255	No	4	FIB	0	2012	Rockwood Premier Series A 122BH	QC	1	no	2109	as-is	\$6,995	Super Value
3262	No	2	FIB	0	2016	Atiner Scout	QC	1	no	1844	as-is	\$8,995	
Travel Trailer Tow Haulers													
3152	11'9"	4	AL	0	2022	Intech Fiver Discover	CD	1	electric	2784	as-is	\$22,695	\$20,591
3002	16'	8	AL	2	2022	Grand Design Momentum 28G	QI	2	electric	9172	as-is	\$39,995	\$37,981
Tow Hauler Fifth Wheels													
2915	FWTH	7	FIB	3	2024	Brinkley Model G 3500	QI	3	electric	17470	as-is	\$123,595	\$109,695
Fifth Wheels													
2918	RL	6	FIB	2	2017	FR Rockwood Ultra Lite 2440WS	QI	1	electric	6590	as-is	\$19,995	\$17,991
2465	RD	4	FIB	2	2023	Keystone Arcadia S.L. 2535LRD	QI	1	electric	7720	as-is	\$39,995	\$32,991
3071	RL	4	FIB	2	2014	Keystone Sprinter 269FWRLS	QI	2	electric	8600	as-is	\$14,995	
2978	RL	6	FIB	3	2013	Starcraft Travel Star 286RL	QI	1	electric	8609	as-is	\$19,995	\$16,991
3243	BH	8	FIB	1	2023	Grand Design Reflection 298BH	QI	1	electric	8962	as-is	\$44,895	
3288	BH	9	FFB	1	2009	Palomino Puma 259RBSS	QI	1	manual	6419	as-is	\$6,995	
3299	RL	4	FIB	2	2019	Keystone Hideout 299RLDS	QI	1	electric	8910	as-is	\$19,995	
2873	RL	4	FIB	3	2023	Grand Design Reflection 303RLS	QI	2	electric	9848	as-is	\$45,995	
2931	RL	4	FIB	3	2021	Primetime Crusader 305RLP	QI	2	electric	9444	as-is	\$39,995	
3195	RL	4	FIB	3	2013	Keystone Montana Big Sky 3100RL	QI	2	electric	11587	as-is	\$21,995	
3286	RL	4	FIB	3	2011	Keystone Montana 3150RL	QI	2	electric	?	as-is	Aor 1st	
2690	RL	4	FIB	3	2011	Heartland Big country 3250TS	QI	1	electric	10524	as-is	\$17,995	\$16,991
3203	RL	4	FIB	3	2022	FR Heritage Glen Elite 34RL	KI	2	electric	11009	as-is	\$38,995	
3190	RL	6	FIB	4	2017	Keystone Sprinter 353FWDEN	QB	2	electric	10860	as-is	\$28,995	
3153	BH	8	FIB	3	2022	Open Range Roamer 364BHS	QI	2	electric	11337	as-is	\$46,995	
Motorhomes													
3284	20'428"	6	FIB	1	2022	Jayco Grevhawk 30Z	QI	2	electric	Gas	as-is	\$74,995	
3275	16'766"	6	FIB	2	2014	Jayco Grevhawk 31DS	QI	1	electric	Gas	as-is	Mid April	
3220	109'026"	4	FIB	3	2012	Itasca Ellipse 42QD	KI	3	electric	Diesel	as-is	Mid Mar	

Key: QI = queen island, KI = king island, CQ = corner queen, CD = corner double, QRS = queen rear slide, QF = queen foldout, MB = Murphy Bed, HY = Hybrid

Disclaimer - all information and weights are approximate. Not responsible for errors in information, weights and pricing. See Salesperson for complete information.