

Jayco | 2026 Jay Feather Travel Trailer



JAY FEATHER

ADVENTURE IS CALLING



2+3
YEAR | YEAR
LIMITED STRUCTURAL
WARRANTY

JAY FEATHER TRAVEL TRAILER



19MRK OPTIONS: B, C

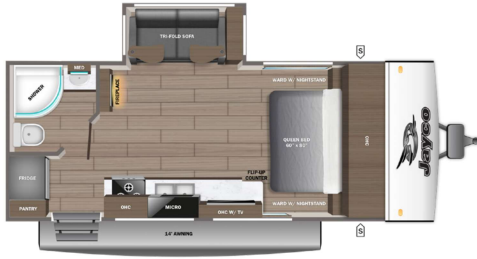

19MRK OPTION: A

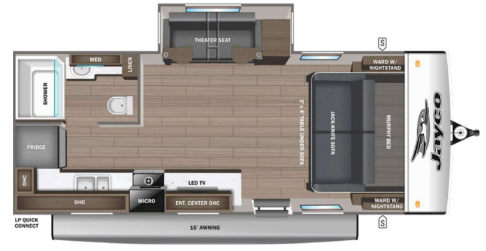

21MBH OPTION: A, B



21MML



23MBD OPTIONS: A, B

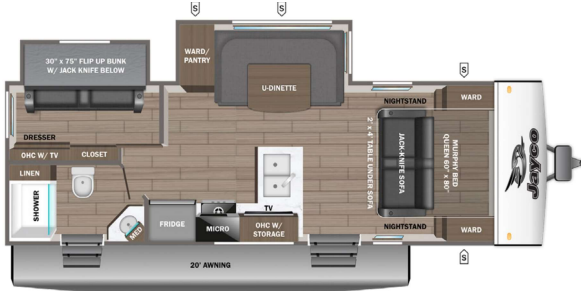

23RK OPTIONS: A, C



24FK

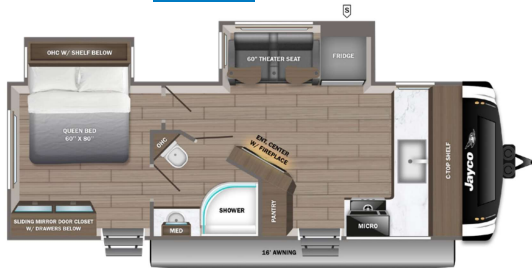

25BH OPTIONS: B, C



S	STORAGE
MICRO	MICROWAVE
OHC	OVERHEAD CABINETS
FRIDGE	REFRIGERATOR
WARD	WARDROBE

OPTIONS

A	B	C	D
Tri-fold Sofa	Theater Seat	King Bed	Table & Chairs

JAY FEATHER TRAVEL TRAILER



25RB OPTIONS: B, C, D



26FK OPTIONS: C, D

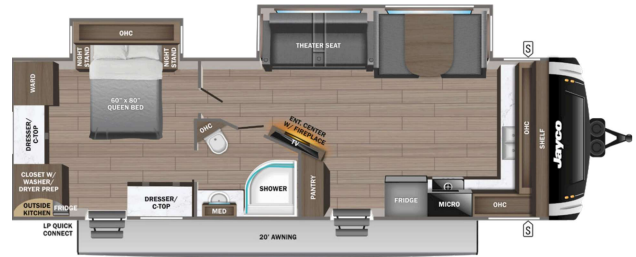

26RL OPTIONS: C, D



27BH OPTIONS: B, C, D



27MK OPTIONS: B, C, D

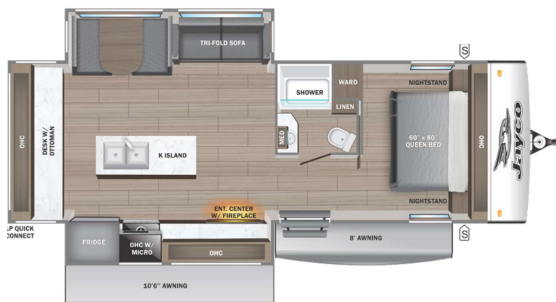

28RB OPTIONS: B, C, D



29BHB OPTIONS: B, C, D



	STORAGE
MICRO	MICROWAVE
OHC	OVERHEAD CABINETS
FRIDGE	REFRIGERATOR
WARD	WARDROBE

OPTIONS

A	B	C	D
Tri-fold Sofa	Theater Seat	King Bed	Table & Chairs

JAY FEATHER TRAVEL TRAILER

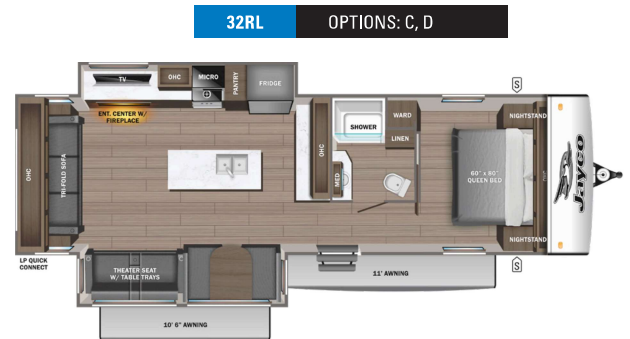
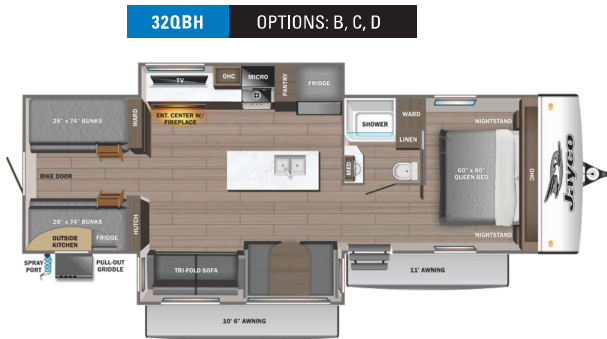
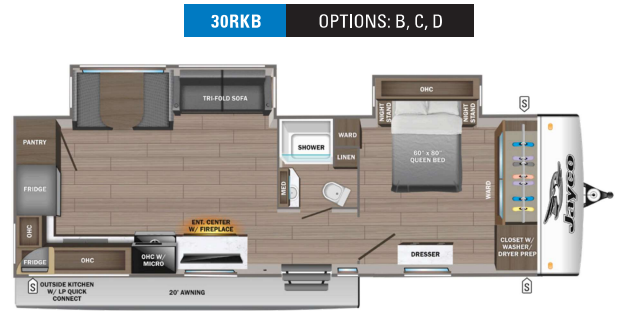
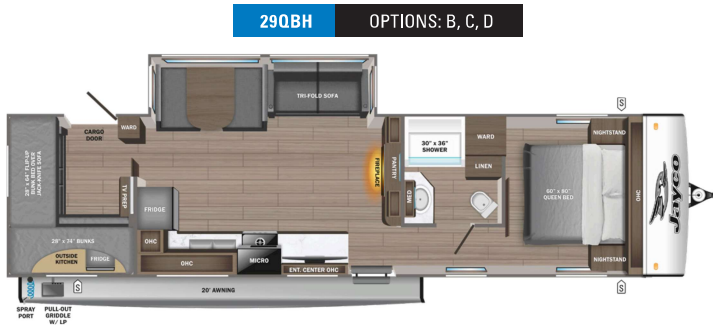

S STORAGE
MICRO MICROWAVE
OHC OVERHEAD CABINETS
FRIDGE REFRIGERATOR
WARD WARDROBE

OPTIONS

A Tri-fold Sofa **B** Theater Seat **C** King Bed **D** Table & Chairs

*Indicates split tanks

FLOORPLAN	EXTERIOR TRAVEL LENGTH	EXTERIOR WIDTH	EXTERIOR HEIGHT (WITH A/C)	INTERIOR HEIGHT	UNLOADED VEHICLE WEIGHT	DRY HITCH WEIGHT	GVWR	CARGO CARRYING CAPACITY	FRESH WATER CAPACITY (INCLUDING WATER HEATER)	GRAY WASTE WATER CAPACITY	BLACK WASTE WATER CAPACITY	SLEEPING CAPACITY
18RBF	23' 1"	8' 0"	10' 8"	6' 6"	4,630	532	6,200	1,570	55	38	38	2-4
19MRK	23' 14"	8' 0"	10' 9"	6' 6"	4,820	550	6,400	1,580	55	38	30.5	1-2
21MBH	26' 8"	8' 0"	10' 9"	6' 6"	5,450	600	6,995	1,545	55	30.5	30.5	6-8
21MML	25' 5"	8' 0"	10' 7"	6' 6"	5,085	615	6,500	1,415	55	30.5	30.5	1-3
23MBD	28' 0"	8' 0"	10' 8"	6' 5"	5,910	610	7,500	1,590	55	76*	40.5	5-7
23RK	28' 7"	8' 0"	10' 8"	6' 6"	5,780	665	7,400	1,620	55	30.5	30.5	2-4
24FK	27' 0"	8' 0"	10' 8"	6' 6"	5,855	785	7,500	1,645	55	76*	38	1-2
25BH	29' 8"	8' 0"	10' 8"	6' 6"	6,015	635	7,600	1,585	55	76*	38	6-8
25RB	30' 1"	8' 0"	10' 8"	6' 6"	5,900	715	7,500	1,600	55	61*	38	4-6
26FK	33' 10"	8' 0"	11' 0"	6' 6"	7,090	955	8,700	1,610	55	91.5*	30.5	2-4
26RL	31' 4"	8' 0"	10' 8"	6' 6"	5,930	630	7,600	1,670	55	30.5	30.5	2-4
27BH	32' 3"	8' 0"	11' 0"	6' 6"	6,490	840	8,200	1,710	55	38	38	8-10
27MK	33' 2"	8' 0"	10' 11"	6' 6"	6,925	705	8,850	1,925	55	71*	30.5	4-6
28RB	33' 1"	8' 0"	10' 11"	6' 6"	6,510	745	8,400	1,890	55	76*	38	4-6
29BHB	34' 0"	8' 0"	10' 11"	6' 6"	6,820	615	8,500	1,680	55	68.5*	30.5	8-10
29QBH	36' 1"	8' 0"	10' 11"	6' 6"	7,295	750	8,995	1,700	55	61*	30.5	8-10
30RKB	35' 10"	8' 0"	10' 10"	6' 6"	7,265	985	8,995	1,730	55	61*	30.5	2-4
32QBH	37' 8"	8' 0"	11' 0"	6' 6"	7,855	1,015	9,800	1,945	55	57	30.5	8-10
32RL	35' 6"	8' 0"	11' 1"	6' 6"	7,400	930	9,300	1,900	55	71*	30.5	4-6

Some specs at the time of print may include estimates. For the most updated information, please visit Jayco.com

STANDARDS & OPTIONS

EXTERIOR

5 in. fresh water drain valve
2 in. Stronghold VBL™ floor with 2 lb. density foam
Aerodynamic, rounded front profile with aluminum framing
American-made Norco® Z-frame with integrated A-frame
Battery quick-disconnect
Dark-tinted safety-glass windows
Exterior TV 120V receptacle and cable hook-ups
Front diamond plating
Galvanized steel and impact-resistant wheel wells
Magnum Truss™ roof system
Outdoor camp kitchen with galvanized steel bases (select models)
PVC roofing membrane (limited lifetime warranty)
Swing-out entry door assist handle

INTERIOR

4 in. high-density dinette cushions with vinyl backing
4 in. soft-touch bunk mats (select models)
75 lb. full-extension drawer guides
Decorative kitchen backsplash
Bathroom skylight
Directional and closeable A/C vents
Gas-strutted under-bed storage (most models)
Handcrafted hardwood door and drawer fronts
High-output, auto-ignition LP gas furnace
LED lighting throughout
Plywood dinette, bed, bunk, and shower/tub bases
Powered roof vent in bathroom
Seamless countertops throughout
Residential vinyl flooring throughout
Screwed-and-glued cabinet stiles
USB charging ports (multiple locations throughout)
Interior speakers

CUSTOMER VALUE PACKAGE (MANDATORY)

Radial tires with self-adjusting electric brakes
13,500 BTU roof-mounted Quiet Series A/C
Vacuum-bonded sidewalls with interior and exterior Azdel® composite panels
20 lb. LP gas bottles with auto regulator, ABS cover, and fill gauge
55 gal. freshwater tank
Automotive-style aluminum rims
Black tank flush
Detachable power cord
Inverter pre-wire outlets
Max-length power awning with LED light
On-demand 60K BTU water heater
Power tongue jack
Rear 2 in. receiver prep
Residential cabinetry with large doors and drawers and hidden cabinet hinges
Rock Solid Stabilizer System (not available with Premier Package)
Rear back-up camera prep
Under-mount spare tire
Roller shades with radiant barrier backer
Electric fireplace (N/A 21MBH, 21MML, 23RK, 23MBD, 25BH)
Slide topper prep

JAY SPORT PACKAGE (MANDATORY)

11 cu. ft. 12V refrigerator
App-monitored TPMS
Climate Shield™ zero to 100 degree tested weather insulation package
Front slam-latch baggage doors
InVision™ kitchen appliance package
Solid fold-down step with aluminum tread on main entry door step
LED Smart TV
Modern graphics package

Porcelain foot-flush toilet
Overlander I Solar Package: (1) 200W solar panel and 30-amp digital controller
Stainless steel double-basin kitchen sink
Keyed-Alike™ doors
Rear exterior ladder
Dark-tinted privacy windows

PREMIER PACKAGE

Molded front cap
Power 5-point stabilization system
Solid surface countertops
Multi-function "All in One" stainless steel kitchen sink
Dual MaxxAir® vent fan in bathroom and living room
Premier graphic legend

OPTIONS

Overlander II Solar Package: (2) 200W panels, 30-amp digital controller and 1800W inverter
JAYCOMMAND™ Smart RV System with TPMS
15K BTU Quiet Series A/C IPO 13.5K BTU
Second 13,500 BTU Quiet Series Direct Dump A/C
50-amp service with second and third A/C prep (select models)
30 lb. LP gas bottles with auto regulator, ABS cover, and fill gauge
120V heated tank pads
Front molded cap (mandatory on 26FK, 24FK, and 30RKB)
Goodyear® tires
2 in. rear receiver
Theater seating
Freestanding table and four chairs (select models)
Furniture cup holder tables (1 pair)
72 x 80 in. king bed (select models)

Meet your Jayco Dealer



Scan QR code for specification definitions



Some specs at the time of print may include estimates. For the most updated information, please visit Jayco.com

Jayco, Inc. | P.O. Box 460 | Middlebury, IN 46540

See dealer for further information and prices. All information in this brochure and on www.jayco.com is the latest available at the time of publication approval. Jayco reserves the right to make changes and to discontinue models without notice or obligation. Photography may show optional equipment or props used for decoration purposes only. RVs built for sale in Canada may differ to conform to Canadian codes. JAYCO and the JAYCO BIRD IN FLIGHT are registered trademarks of Jayco, Inc. Printed in USA 2/26 ©2026 Jayco, Inc. 2033102

Jayco - Part of Jayco Family of Companies