

F U Z I O N

# IMPACT

FIFTH WHEEL TOY HAULERS • TRAVEL TRAILER TOY HAULERS • VAPOR LITE TOY HAULERS



LIVE IT OUT.



# IMPACT



---

IMPACT | TOY HAULERS

---

## WORK HARD, PLAY HARDER

Let's be honest, if you're looking for a toy hauler you're likely to have a gear habit. Impact offers weekend warriors a lineup of shorter toy haulers, lightweight travel trailers, and fifth wheels- all with the same robust construction as the brand's big brother, Keystone Fuzion. Focused on providing the most value for your dollar, Impact makes it easy for you to get outside.

For more information, please visit [keystonerv.com/Impact](http://keystonerv.com/Impact)



# KEYSTONE EXCLUSIVE INNOVATIONS

Designed to deliver superior performance, quality and a best-in-class camping experience, every Impact model includes engineering innovation available EXCLUSIVELY to Keystone owners.

For more information about these features and the Keystone Innovation Lab, visit us online at [www.keystonerv.com/innovations](http://www.keystonerv.com/innovations).



## 3-YEAR LIMITED STRUCTURAL WARRANTY, 1-YEAR LIMITED BASE WARRANTY

Every new Keystone RV comes with the industry's best three-year limited structural warranty AND a one-year limited base warranty. Ask your dealer, visit [keystonerv.com](http://keystonerv.com), or call Keystone Owner Relations for details.



### KeyTV™

No more connection guesswork or poor reception. KeyTV offers a game-changing, single point of control of over-the-air, cable, and satellite feeds.



### 4G LTE and Wi-Fi Prep

All units are equipped with a new antenna that integrates 4G LTE and Wi-Fi with standard VHF/UHF/AM/FM reception.



### Color-Coded Unified Wiring Standard

Easy-to-trace circuits simplify electrical and entertainment system troubleshooting.



### In-floor Heating Ducts

Distributes heat evenly through your coach for superior comfort.

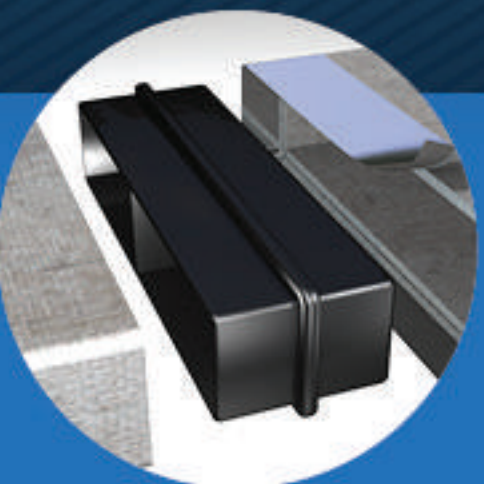

### Tuf-Lok™ A/C Duct Joiners

Crush resistant design securely joins ductwork and A/C units, and drastically reduces chilled-air leaks to boost cooling efficiency and comfort.



### Tru-fit™ Slide Construction

A more durable slide room design that minimizes functional motor and structural stress and resists leaking.





more product detail at  
[www.keystonerv.com/Impact](http://www.keystonerv.com/Impact)



## INTERIORS

This year Impact is delivering the same stunning interior redesign as Fuzion. They've added a subway tile back splash, lighter wallboard, and soft gray hardwood cabinetry. With a focus on brighter and more authentic finishes, the new design maintains Impact's contemporary vibe but with a warmer, more universal appeal.







## CONTEMPORARY VIBE

Our new interior updates offer you a fresh and inviting space.



## IN FINE STYLE

Impact features sleek black appliances throughout the space.





# blade

HIGH-PERFORMANCE AIR FLOW SYSTEM



## BLADE™ HIGH PERFORMANCE AIR HANDLING SYSTEMS

Engineered to maximize the output from today's high-performance RV air conditioners, Keystone's NEW patented air handling system delivers an average of 20% more cooling power and is built to withstand the rigors of the road. The Blade™ system is designed to accelerate air flow, eliminate leakage and failure points, deliver 360° circulation in the cabin, and withstand environmental and road stressors that lead to reduced performance.

## OMNI-CHILL

- 3/4 ton residential A/C, Equivalent to 16,200 BTU's
- Most energy efficient, highest performing system available
- Run 2 A/C's on a 30amp service with power to spare
- Residential style system achieves 15% greater airflow

# OMNI-CHILL™



KEYSTONE  
RV COMPANY



# MODERN AMENITIES

From the EQ smart level to the industry leading 5K interlock tie-down system Impact gives camping a whole new meaning.

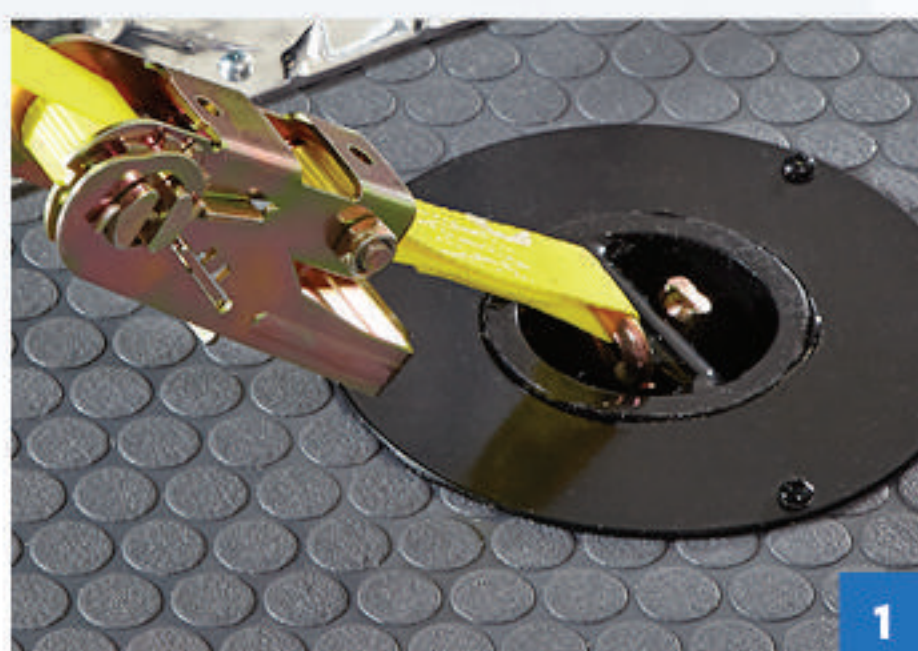

## 1. 5K INTERLOCK TIE-DOWN SYSTEM

Industry-leading 5,000 lb. capacity tie-downs for increased safety & security.

## 2. G-RATED TIRES ON FIFTH WHEEL TRAILERS

Tow your toys confidently with higher ply, heavy duty tires.

## 3. 30-GALLON FUEL STATION

Built-in fueling for more hours of play.

## 4. LED TV W/ DVD AND 3-ZONE STEREO

Have total control of your entertainment.

## 5. PREMIUM VINYL FLOORING IN BEDROOM

More durable and easier to maintain.

## 6. EQ SMART LEVEL BY EQUALIZER SYSTEMS

Class exclusive, one touch leveling with smartphone app integration. Available on fifth wheel models only.

## 7. CNC ROUTED SIDEWALLS

Ensures perfectly cut / perfectly fit windows, doors, and slide-boxes and creates a better seal around windows and doors.

## 8. DEXTER AXLES W/ ELECTRIC SELF ADJUSTING BRAKES

Equipped with U.S. made, heavy-duty axles, and electric self-adjusting brakes that significantly decrease stopping distance and cause less wear and tear on your tow vehicle.

## 9. EXTERIOR CONVENIENCE CENTER

Complete with easy-to-read operation instructions for hook-ups, dry camping, black tank flush, winterizing, and more.



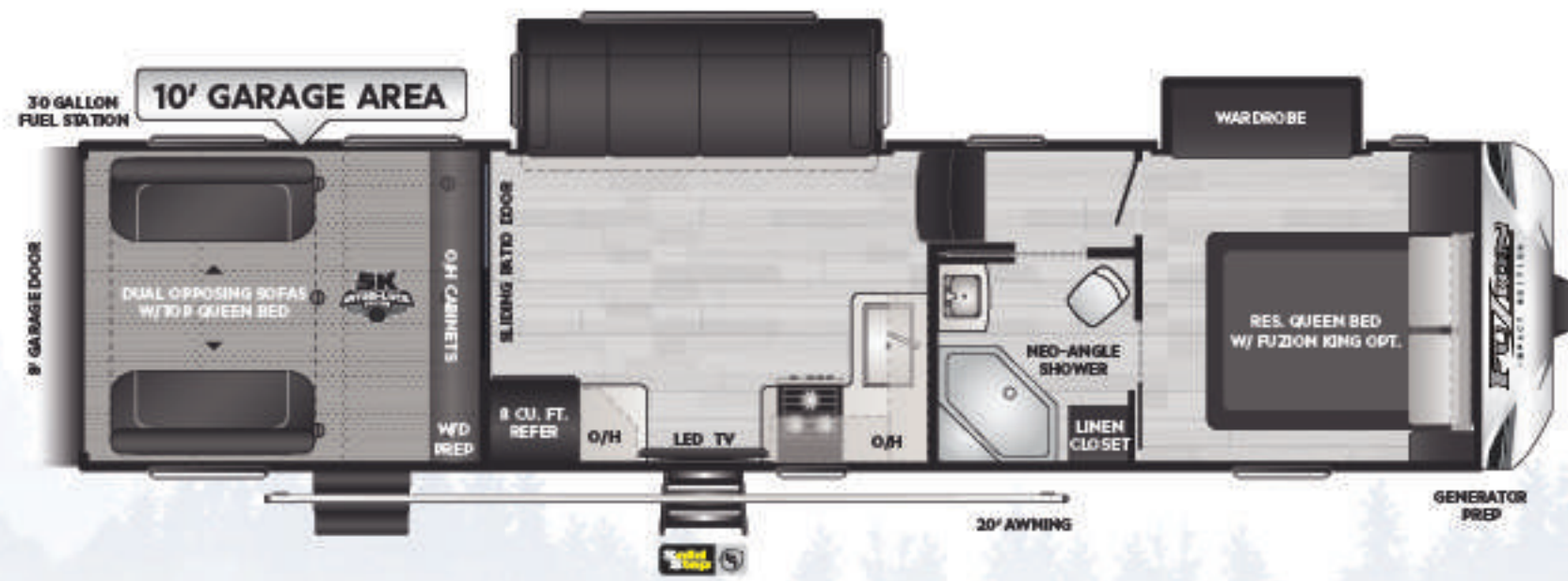

**311** | Tandem-axle, two slides, 10' garage

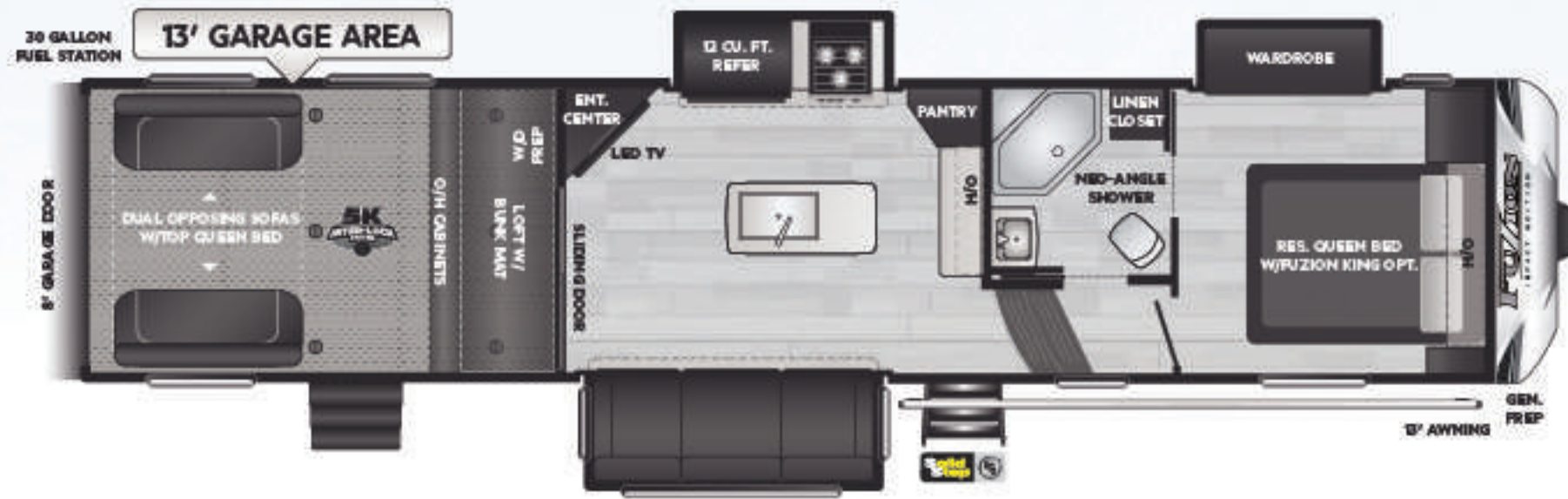

**343** | Tandem-axle, kitchen island, three slides, 13' garage

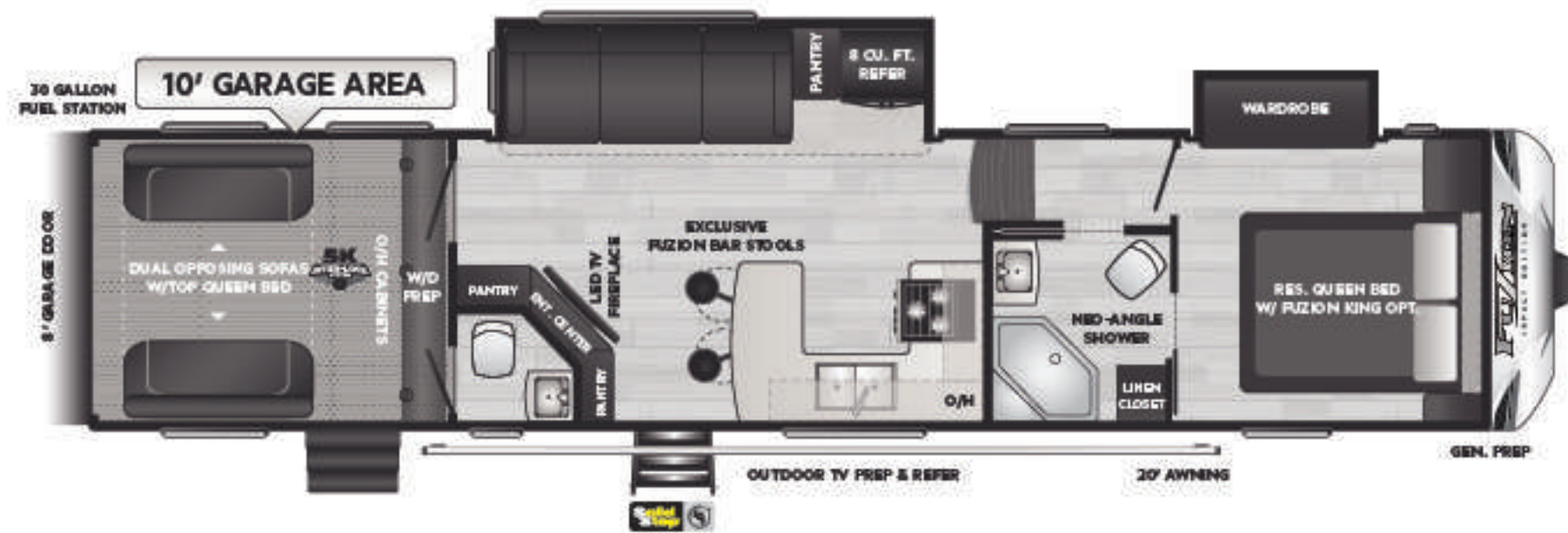

**359** | U-shaped kitchen, tandem axle, 1 1/2 baths, 10' garage

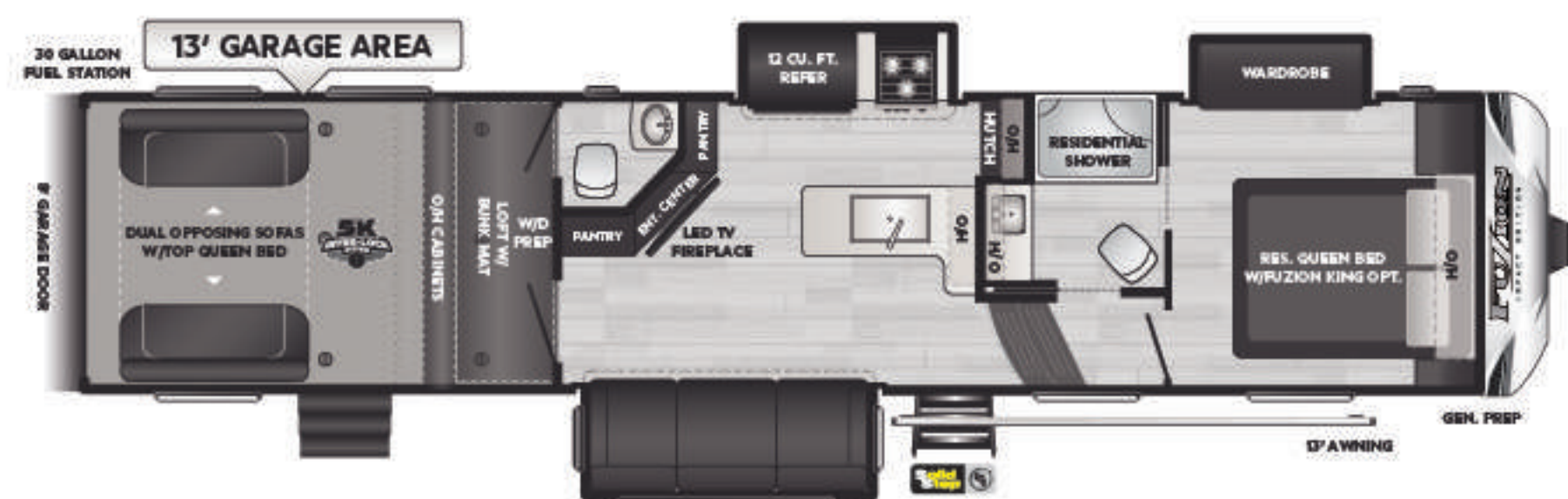

**367** | Tandem-axle, 1 1/2 baths, 12 cu. ft. refer, 13' garage

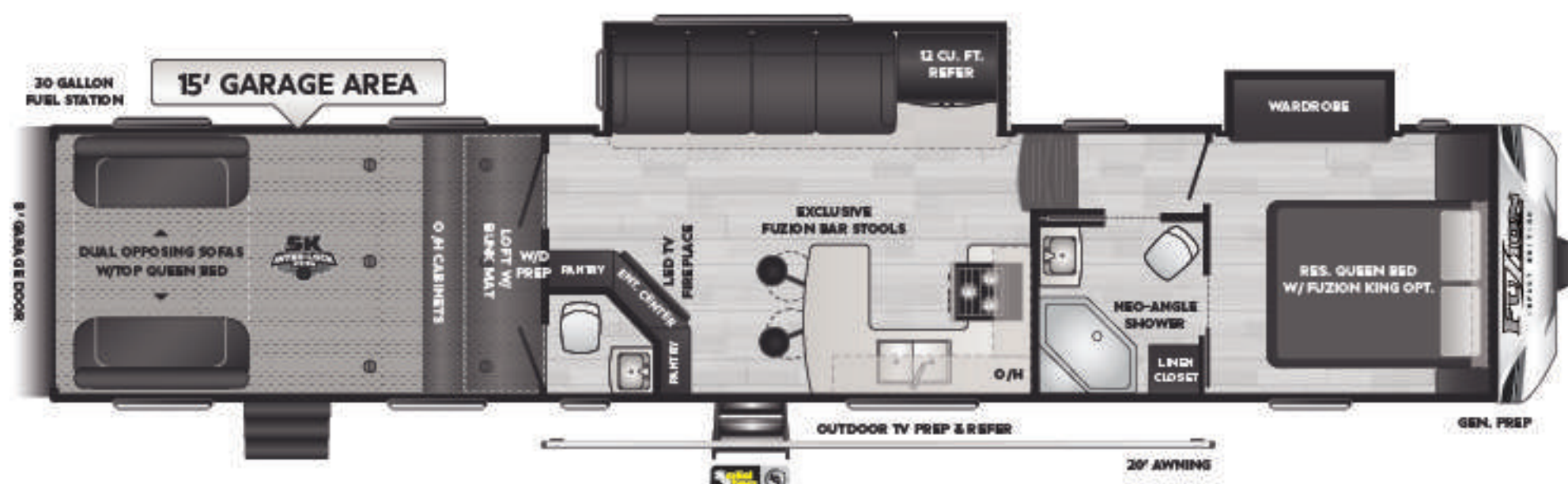

**415** | U-shaped kitchen, triple axle, 1 1/2 baths, 15' garage





**317** | U-shaped kitchen, swing out stools, two slides, 11' garage

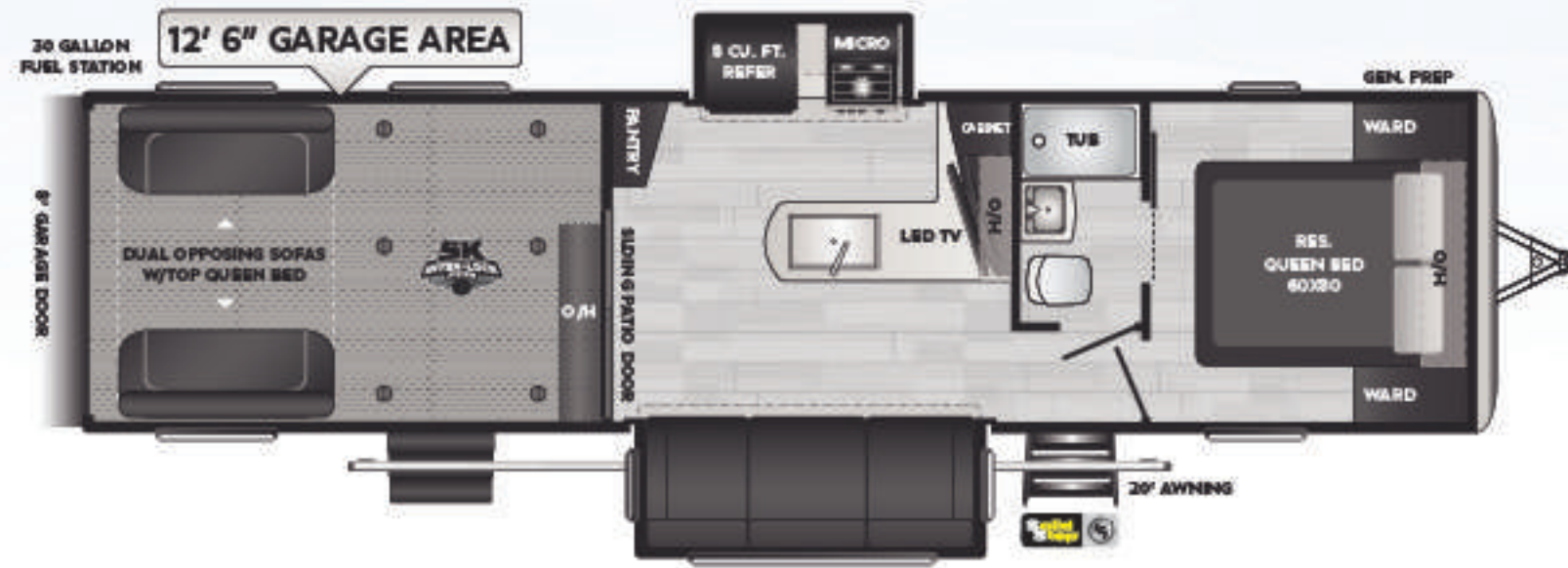

**330** | Angled entertainment center, two slides, 12' 6" garage

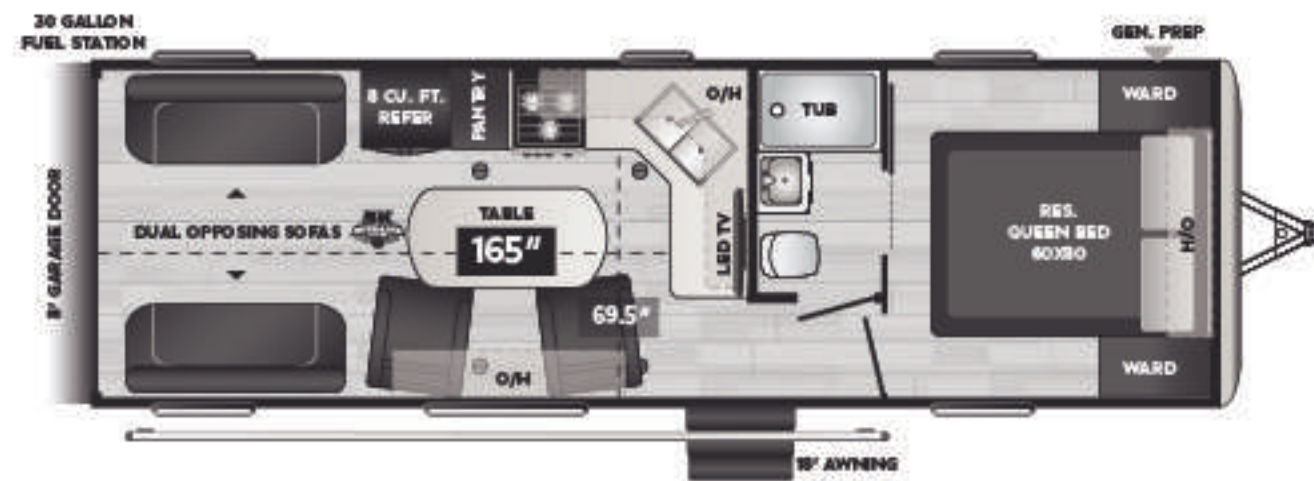

**26V** | Lightweight, open concept, 13' 9" garage

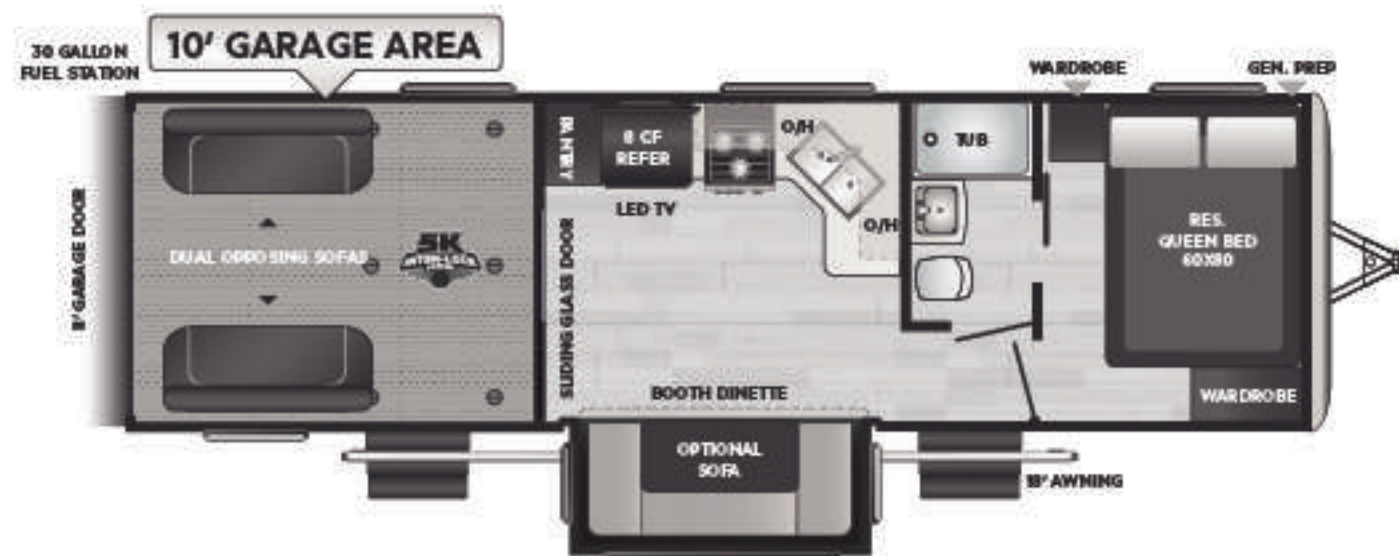

**28V** | Lightweight, one slide, 10' garage

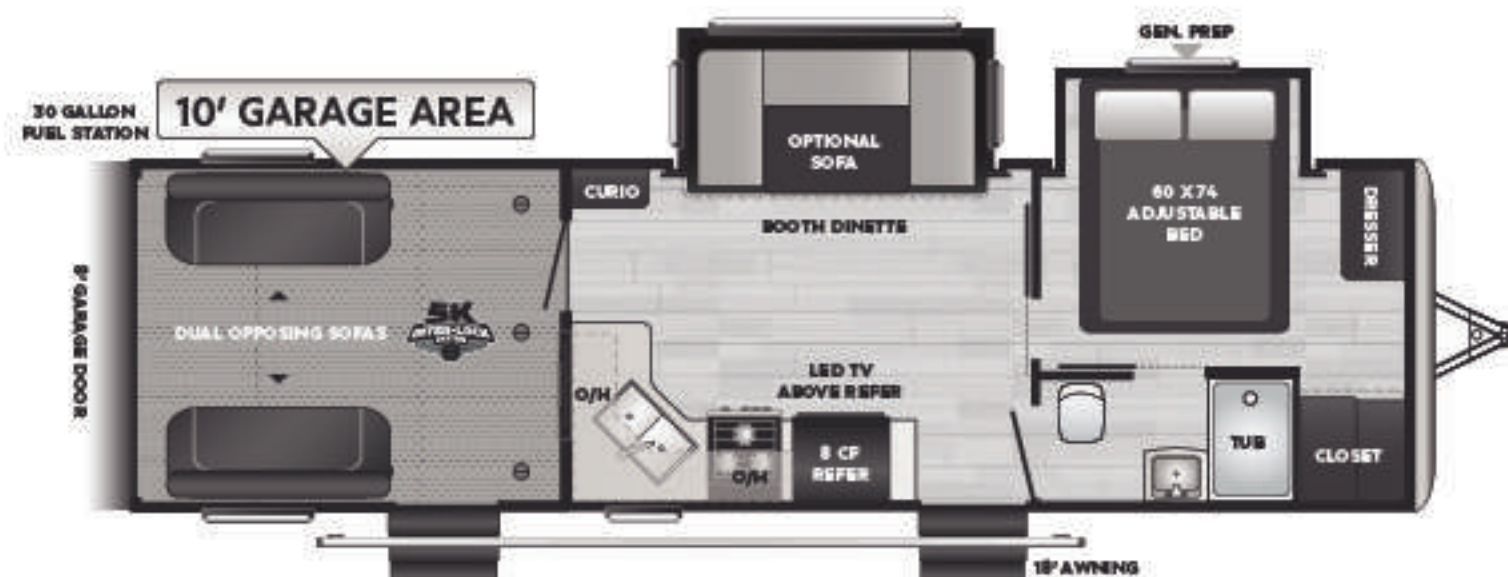

**29V** | Lightweight, two slides, 10' garage



MODEL	WEIGHT	CARRYING CAPACITY	HITCH WEIGHT	FRESH WATER	WASTE WATER	GRAY WATER	LPG	LENGTH*	WIDTH	HEIGHT	AWNING
26V	6497	3273	970	60	30	30	60	30' 5"	8' 4"	12' 2"	18'
28V	7330	2670	1225	60	30	30	60	32' 8"	8' 4"	12' 2"	18'
29V	7725	2275	1225	60	30	60	60	33' 10"	8' 4"	12' 2"	18'
311	11447	5003	2450	106	44	88	60	35' 7"	8' 4"	13' 1"	20'
317	9700	3300	1680	100	30	60	60	37' 6"	8' 4"	12' 4"	20'
330	9454	3546	1415	100	30	60	60	37' 6"	8' 4"	12' 4"	20'
343	12312	4588	2905	106	44	86	60	39' 0"	8' 4"	13' 1"	13'
359	12469	4411	2880	106	88	88	60	39' 0"	8' 4"	13' 1"	20'
367	12955	4015	2970	106	88	88	60	39' 0"	8' 4"	13' 1"	13'
415	13835	5165	3155	106	88	88	60	44' 0"	8' 4"	13' 3"	20'

DISCLAIMER: Product information is as accurate as possible as of the date of publication of this brochure. All features, floor plans, and specifications in this brochure are subject to change without notice. Please also consult Keystone's web site at [www.keystonerv.com](http://www.keystonerv.com) for more current product information and specifications. Tow Vehicle Disclaimer. CAUTION: Owners of Keystone recreational vehicles are solely responsible for the selection and proper use of tow vehicles. All customers should consult with a motor vehicle manufacturer or their dealer concerning the purchase and use of suitable tow vehicles for Keystone products. Keystone disclaims any liability or damages suffered as a result of the selection, operation, use or misuse of a tow vehicle. KEYSTONE'S LIMITED WARRANTY DOES NOT COVER DAMAGE TO THE RECREATIONAL VEHICLE OR THE TOW VEHICLE AS A RESULT OF THE SELECTION, OPERATION, USE OR MISUSE OF THE TOW VEHICLE. \*Length is defined as the distance from the centerline of hitch pin/coupler to rear bumper of trailer. Please review owner's manual prior to purchase for more information on service warranties, extended use, towing and maintenance. Owner's manuals can be found at [keystonerv.com](http://keystonerv.com).



## KEY PERFORMANCE

Impact is a Keystone Key Performance brand, what that means is every model is designed by a dedicated toy hauler team to deliver a higher standard of durability and performance. Each floorplan is specifically created to haul power-sports vehicles, with extra security built in for toys and the humans that travel with them.



	FW	TT	VL
<b>KEYSTONE EXCLUSIVES</b>			
3-year limited structural warranty	○	○	○
1-year limited base warranty	○	○	○
Color-coded unified wiring standard	○	○	○
4G LTE and Wi-Fi prep	○	○	○
Tuf-Lok™ thermoplastic duct joiners	○	○	○
KeyTV™ multi-source signal controller	○	○	○
In-floor heating ducts	○	○	○
Tru-fit™ slide construction	○	○	○
<b>EXTERIOR</b>			
Aluminum Constructed fully laminated fiberglass sidewalls	○	○	○
Electric front and rear stab jacks	○	○	
100" wide body	○	○	○
8 ft. ramp door	○	○	○
Exterior convenience center	○		
16" wheels with 7,000 lb. Dexter EZ Lube® axles	○	○	
15" wheels with 4,400 lb. Dexter EZ Lube® axles			○
Spare tire with carrier	○	○	○
LED lighted electric awning	○	○	○
Diamond plate rock guard on front TT only		○	○
12-gallon gas/electric water heater with DSI FW only	○		
6-gallon gas/electric water heater with DSI TT only		○	○
30-gallon fuel station with pump	○	○	○
G-rated tires	○		
F-rated tires		○	
E-rated tires			○
Generator prep	○	○	○
LED tail lights, brake lights & ramp loading lights	○	○	○
Aluminum wheels	○	○	○
Exterior shower with hot and cold water	○	○	○
Heated enclosed underbelly	○	○	○
<b>INTERIOR</b>			
Oversized shower	○		
40" LED TV (Impact)	○	○	
32" LED TV (Vapor Lite)			○
Bluetooth CD/DVD Player with MP3 connection	○	○	○
Residential reclining furniture w/ heat, LED, massage	○	○	

	FW	TT	VL
<b>INTERIOR (CONT.)</b>			
Dual electric beds with collapsible rollover sofa	○	○	
8 cu. ft. refrigerator	○	○	○
12 cu. ft. refrigerator (343, 367, 415 Only)	○		
Furrion® 3-burner stove w/ oven	○	○	○
Hardwood cabinetry	○	○	○
30" wide entry doors	○	○	○
Tuff Ply flooring in the cargo area	○	○	○
35K BTU ducted furnace	○	○	○
2 Interior, 2 exterior speakers	○	○	○
Residential queen-sized mattress in bedroom	○	○	○
Night shades	○	○	○
Microwave oven	○	○	○
3/4 ton A/C system	○	○	○
5K InterLock system	○	○	○
Two (2) RAM air vents in the cargo area	○	○	○
Stainless steel sink	○	○	○
<b>SAFETY</b>			
Fire extinguisher	○	○	○
Smoke detector	○	○	○
LPG detector	○	○	○
CO detector	○	○	○
Safety chains		○	○
Emergency breakaway switch	○		
<b>OPTIONS</b>			
Sliding rear patio door	○	○	
2000 watt inverter and 265 watt solar panel	○	○	
6pt EQ Smart Level by Equalizer Systems	○		
King bed Glide-A-Bed system w/ under-bed storage	○		
Frameless dual-pane safety glass windows	○	○	
Ramp door patio package	○	○	○
Onan 5500 watt gasoline generator	○	○	
Onan 4000 watt gasoline generator			○
Dual ¾ ton A/C's	○	○	
3-seat sofa w/ LED, heat, massage (28v, and 29v) IPO booth dinette			○
HappiJac® bed w/ upper bunks & table	○	○	
HappiJac® bed system w/ table and upper bunk			○



# BUILT FOR THE LONG HAUL



## 1 EASIER SHOPPING.

At Keystone, we make choosing an RV as easy as finding the Big Dipper on a dark summer night. With comprehensive online product information, Key Connect™ product advisors, and an unparalleled dealer network, we will help you select the perfect RV for your family's adventure.

## 2 INNOVATIVE THINKING.

The road's a nicer place when you have the industry's smartest features behind you. Keystone leads the pack in patented innovations that make our RVs safer, more comfortable, and easier to operate.

## 3 LONG HAUL QUALITY.

To keep you on the road, there are certain things we just won't build a Keystone RV without. Game-changing features like our Unified Wiring Standard, Tru-Fit™ five-point slide construction, and no-fail Tuf-Lok™ A/C duct joiners combined with exhaustive testing and inspections are some of the reasons why Keystone is able to offer our owners the industry's best 3-year limited structural warranty.

## 4 WORRY-FREE CUSTOMER SERVICE.

Wherever the road takes you, you're never too far from an authorized Keystone service center. We also offer live service assistance, ultra-fast parts shipping, online maintenance tips and tricks, and a single-point warranty claims policy. *That's* peace of mind.

## 5 KEYSTONE NATION.

When you choose Keystone, you become a part of one of the largest camping families in the country. We're Keystone Nation. A friendly community where people share photos, travel tips and amazing stories — all in the spirit of camaraderie and adventure. Come join us.