

# Sunseeker

BY FOREST RIVER



GTS



A Berkshire Hathaway company.



MBS



TS



*Shown in Truffle Decor with optional Weathered Teak cabinetry*

*Tasteful design, combined with a unique combination of style, value and preferred amenities make travel in the Sunseeker comfortable and loads of fun. Sunseeker's unique split level design provides maximum headroom in the living area, while still offering pass-through storage on every floorplan. Plus, all Sunseekers are "Certified Green" by TRA Certification.*



*This outdoor camp kitchen is standard on 2860DS.*

*Sunseeker*  
BY FOREST RIVER

STANDARD SERIES



**CLASS C TOP  
FEATURES**

- ◆ 7' Ceiling height
- ◆ Crowned fiberglass roof
- ◆ 2" Thick gel coat sidewalls with Azdel "Superlight" composite
- ◆ Firestone Ride Right suspension
- ◆ Enclosed and heated tanks
- ◆ Water filtration system
- ◆ 7500 Lb. tow rating
- ◆ Windows in cab over bunk area
- ◆ Residential cabinetry
- ◆ Waste Master® RV sewer management system



*Shown in Carmel Decor with optional Rustic Cherry cabinetry*

**DECOR**  
CARMEL



PEWTER



TRUFFLE

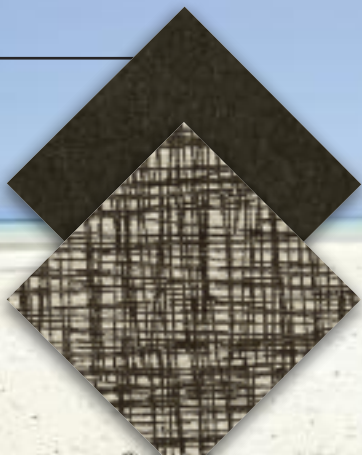

**CABINETY**

**RUSTIC CHERRY**



**WEATHERED TEAK**



*Not available in LE Models*

# Sunseeker

BY FOREST RIVER

## CLASS C FLOORPLANS

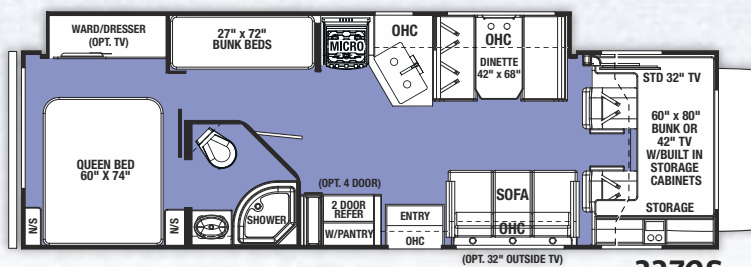
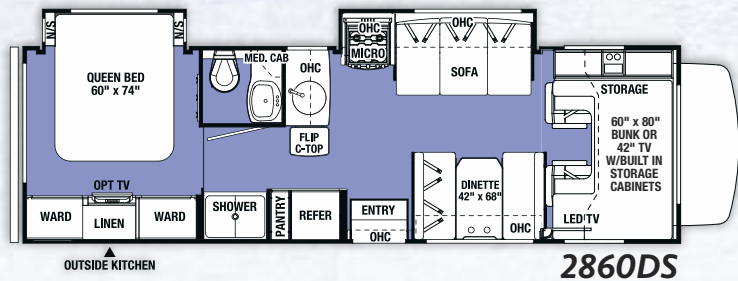
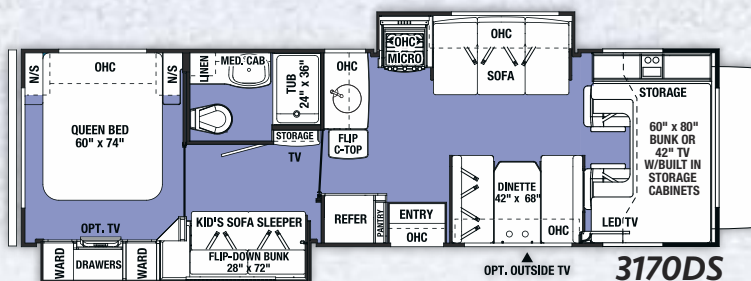
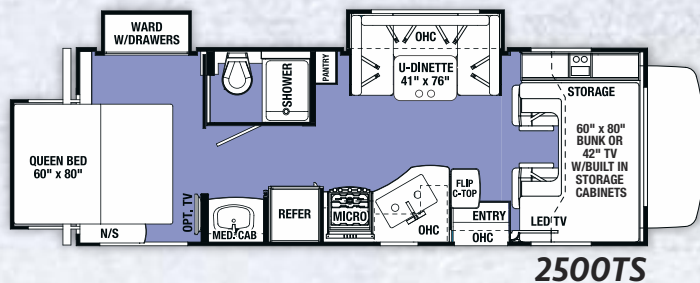
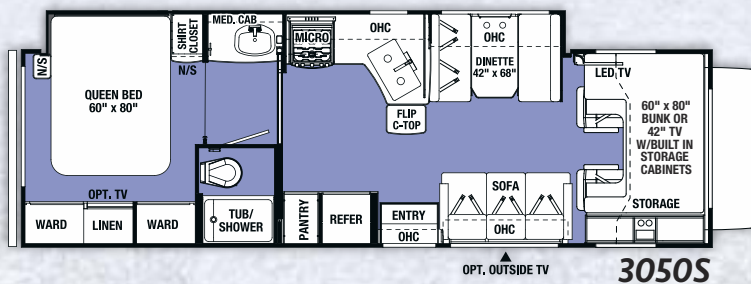
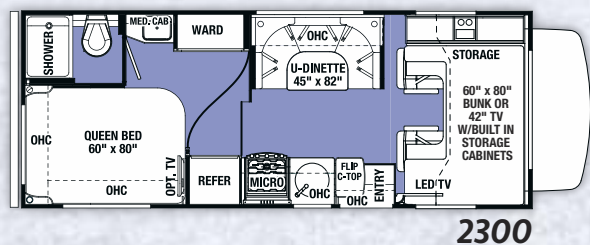
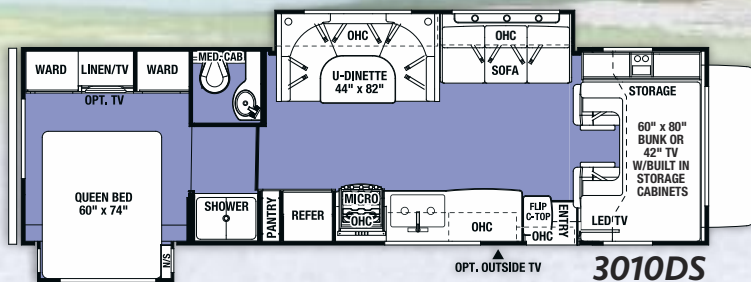
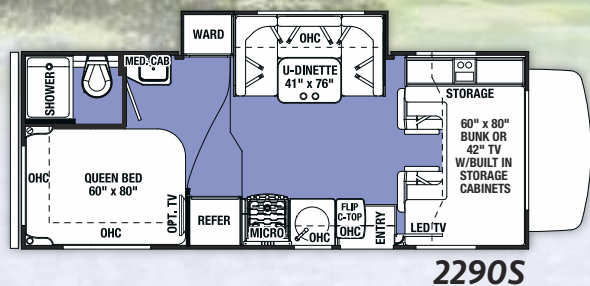

### OPTIONS



OPT. RECLINERS

3010DS



OPT. 4-DOOR REFER

OPT. SIDE-BY-SIDE REFER  
2860DS,  
3010DS,  
3050S

Sunseeker Ford • Chevy Chassis	2290	2300	2500	2860	3010	3050	3170	3270
Wheelbase	158" • 159"	158" • 159"	182" • 183"	202" • 203"	220" • NA	220" • NA	220" • NA	220" • NA
GVWR	14500 • 14200	14500 • 14200	14500 • 14200	14500 • 14200	14500 • NA	14500 • NA	14500 • NA	14500 • NA
GAWRR	9600 • 9600	9600 • 9600	9600 • 9600	9600 • 9600	9600 • NA	9600 • NA	9600 • NA	9600 • NA
GAWRF	5000 • 4600	5000 • 4600	5000 • 4600	5000 • 4600	5000 • NA	5000 • NA	5000 • NA	5000 • NA
UVW	10624 • 10452	10624 • 9890	11721 • 11500	12300 • 12400	12400 • NA	12848 • NA	12500 • NA	TBD
GCWR	22000 • 20000	22000 • 20000	22000 • 20000	22000 • 20000	22000 • NA	22000 • NA	22000 • NA	TBD
CCC	3876 • 3748	3876 • 4310	2779 • 2700	2200 • 1800	2100 • NA	1652 • NA	2000 • NA	TBD
Fuel Capacity (Gal.)	55 • 57	55 • 57	55 • 57	55 • 57	55 • NA	55 • NA	55 • NA	TBD
Hitch Rating	7500/500 • 5000/500	7500/500 • 5000/500	7500/500 • 5000/500	7500/500 • 5000/500	7500/500 • NA	7500/500 • NA	7500/500 • NA	TBD
Length - Bumper To Bumper	24' - 6" • 25'	24' - 6" • 25'	26' - 11" • 27' - 5"	30' - 9" • 31' - 3"	32' - 3" • NA	31' - 11" • NA	32' - 3" • NA	TBD
Exterior Height With A/C	11' - 3"	11' - 3"	11' - 3"	11' - 3"	11' - 3"	11' - 3"	11' - 3"	11' - 3"
Exterior Width	101"	101"	101"	101"	101"	101"	101"	101"
Interior Width	95.5"	95.5"	95.5"	95.5"	95.5"	95.5"	95.5"	95.5"
Interior Height Frt/Rear	84"/77"	84"/77"	84"/77"	84"/77"	84"/77"	84"/77"	84"/77"	84"/77"
Fresh/Grey/Black Water (Gal.)	44/39/39	44/39/39	44/39/39	44/39/39	44/39/39	44/39/39	44/39/39	44/39/39
L.P. Capacity (Gal.)	9.8	9.8	9.8	9.8	9.8	9.8	9.8	9.8
Awning Length	15' - 6"	15' - 6"	18'	14'	15' - 6"	18'	11'	TBD
Water Heater (Gal.)	6	6	6	6	6	6	6	6
Exterior Storage (Cu. Ft.)	61	61	50	62.5	101.7	81.8	80	TBD

GVWR (Gross Vehicle Weight Rating) - is the maximum permissible weight of the unit when fully loaded. It includes all weights, inclusive of all fluids, occupants, cargo, optional equipment and accessories. For safety and product performance do NOT exceed the GVWR.

GCWR (Gross Combined Weight Rating) - is the maximum permissible loaded weight of your motor home and any towed trailer or towed vehicle. Actual GCWR of this vehicle may be limited by the sum of the GVWR and the installed hitch receiver maximum capacity rating; see hitch rating label for detail.

GAWR (Gross Axle Weight Rating) - is the maximum permissible weight, including cargo, fluids, optional equipment and accessories that can be safely supported by each axle.

UVW (Unloaded Vehicle Weight)\* - is the typical weight of the unit as manufactured at the factory. It includes all weight at the unit's axle(s), including full fuel, all fluids and LP Gas. The UVW does not include cargo, fresh potable water, additional optional equipment or dealer installed accessories.

CCC (Cargo Carrying Capacity)\*\* - is the amount of weight available for fresh potable water, cargo, passengers, additional optional equipment and accessories. CCC is equal to GVWR minus UVW. Available CCC should accommodate fresh potable water (8.3 lbs. per gallon). Before filling the fresh water tank, empty the black and gray tanks to provide for more cargo capacity.

\*Estimated Average based on standard build optional equipment. \*\* Estimated average based on standard build optional equipment.

Each Forest River RV is weighed at the manufacturing facility prior to shipping. A label identifying the unloaded vehicle weight of the actual unit and the cargo carrying capacity is applied to every Forest River RV prior to leaving our facilities. The load capacity of your unit is designated by weight, not by volume, so you cannot necessarily use all available space when loading your unit. Actual towing capacity is dependent upon your particular loading and towing circumstances, which includes the GVWR, GAWR and GCWR as well as adequate trailer brakes. Please refer to the Operator's Manual of your vehicle for further towing information.

## PAINT OPTIONS



**AMBER Full body paint**



**STERLING Full body paint**



**STANDARD Exterior**

# Sunseeker

BY FOREST RIVER

HIGH QUALITY CONSTRUCTION



**DARE TO COMPARE**

### Multi-Layered Laminated Roof System

1. Crowned Fiberglass Roof
2. Luan Decking
3. Block Foam Insulation
4. A/C Ducts
5. Tubular Aluminum Framing
6. Interior Ceiling Material

### Vacuum-Bond Laminated Sidewalls

7. Decorative Interior Wall Board
8. Tubular Aluminum Framing
9. EGS Metal Backers
10. Block Foam Insulation
11. Opening Framed In Aluminum
12. Superlite Composite - Azdel
13. Gelcoat Fiberglass Exterior

### Vacuum-Bond Laminated Floor System

14. Fiberglass Bottom Board
15. Block Foam Insulation
16. Seamless Floor Decking
17. Beauflor Flooring (In Some Areas)
18. Aluminum Framing



**LARGE WINDOWS WITH BLACK-OUT ROLLER SHADES**  
Large panoramic windows for plenty of fresh air and natural light.



**LED LIGHTING**  
LED lights generate almost no heat compared to incandescent lights and use substantially less power.



**RESIDENTIAL STYLE CABINETRY**  
Sunseeker is appointed with ball bearing drawer glides and rich hardwood cabinetry.



**USB CHARGING STATION**  
12V 4-port USB charging station (Living room/bedroom)



**FULLY DUCTED AIR**  
All floorplans are ducted for better air flow throughout the coach and front cabover.



**ENCLOSED BATTERIES**  
Two batteries in a single housing for easy access. (One battery LE and Transit)



**MEMORY FOAM**  
Memory foam mattress will ensure a good nights sleep.



**HEATED AND ENCLOSED HOLDING TANKS**  
The Sunseeker features a heated and enclosed utility station. Your tanks and valves are protected using warm air from the furnace. (N/A 2250 SLE, MBS and Transit Series)



**KING JACK ANTENNA**  
This HD digitally amplified antenna enhances reception.



**FIBERGLASS ROOF**  
Durable, easy to clean (R-18) crowned fiberglass sheds water and doesn't cause black streaks like a rubber roof.

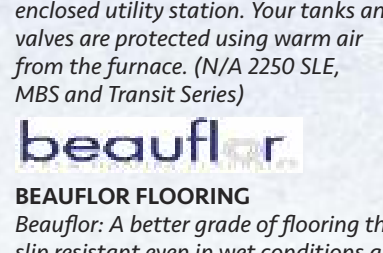

**BEAUFLOR FLOORING**  
Beauflor: A better grade of flooring that is slip resistant even in wet conditions and highly resistant to tears. Unlike vinyl floors with paper backing, our backing remains stable in extreme hot or cold and is backed by a seven-year cold crack warranty.



**WATER FILTRATION**  
This compact unit filters water for the entire coach, eliminating those unwanted contaminants and odors, ensuring safe drinking water for you and your family. (N/A LE Series)



**SEAMLESS FRONT CAP**  
For enhanced aerodynamics



**WASTE MASTER SEWAGE MANAGEMENT SYSTEM**  
Rugged for quick, easy and sanitary disposal of waste. (N/A LE and Transit)



**SOLAR PREP**



**OUTSIDE SPEAKERS**



**WHOLE HOUSE ENTERTAINMENT**  
This multimedia system features AM/FM/DVD, Bluetooth, plus outside speaker control.



**INTEGRATED STEP**  
Sunseeker's entry step is integrated into the sidewall. No more slippery, or damaged power steps.



**OPTIONAL CAB OVER BUNK SAFETY NET**  
The overhead bunk is rated for 500 lbs.



**POWER AWNING WITH LED STRIP**  
Extend and retract your awning with the push of a button. Both arms are adjustable to get just the right angle.



**Pioneer IN-DASH STEREO SYSTEM**  
Pairs up with your smart phone to access GPS and other applications. (N/A on Transit or LE Series)



**WINTERIZING TUBE**  
Easy access for quick maintenance includes bypass valve.



**MAXX AIR FAN**  
Recirculates air throughout the entire coach.



**7,500 LB. TOW CAPACITY**  
Ford E450 only (N/A on LE Series)

**ATWOOD WATER HEATER**

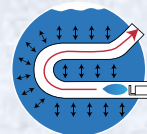

**ATWOOD WATER HEATER**  
Atwood 18 GPH water heaters (6 gallon tank) out perform traditional 10 and 12 gallon tank water heaters. They're also 50% lighter and have no anode rod to replace.

**TRADITIONAL WATER HEATER**

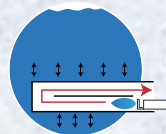

**FIRESTONE RIDE-RITE**  
Adjustable air springs provide an improved ride and a better way to balance loads. (N/A LE or MBS Series)



This holding tank vent cap eliminates odors and gases from the holding tanks and exhausts them out the roof, without the use of costly chemicals.



## SUNSEEKER VS. THE COMPETITION

### CHARGE WIZARD

Progressive Dynamics converter with the patented 4-stage Charge Wizard® system has been shown to increase the battery life by 2 to 3 times or more. The Charge Wizard constantly monitors battery voltage and battery usage then selects one of four operating modes to properly charge and maintain the battery. Boost, Normal, Storage and Equalization.

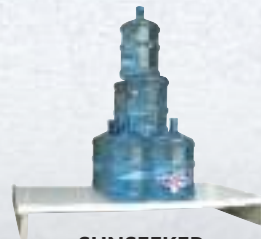

**SUNSEEKER**  
2" Wall with Block Foam and Superlite (R-10)



### SUPER LITE WALLS

All models use SuperLite composite instead of a wood substrate on the sidewalls. It is lightweight, formaldehyde free and is not affected by moisture.



**COMPETITION**  
1.5" Wall with Luan (R-6)



*LE Series are only available with standard Weathered Teak cabinetry.*

*Sunseeker LE Series is the industry's best value on the market today! Enjoy years of carefree travel with these well-built Class Cs.*

Ford • Chevy	2250SLE	2850SLE	3250DSLE
Wheelbase	158" • 159"	220"	220" • NA
GVWR	14500 • 14200	14500	14500 • NA
GAWRR	9600 • 9600	9600	9600 • NA
GAWRF	5000 • 4600	5000	5000 • NA
UVW	9660 • 9640	11742 • NA	12500 • NA
GCWR	22000 • 20000	22000	22000 • NA
CCC	2840 • 4560	2758 • NA	2000 • NA
Fuel Capacity (Gal)	55 • 57	55	55 • NA
Hitch Rating	7500/500 • 5000/500	7500/500	7500/500 • NA
Length - Bumper To Bumper	23' - 10" • 24' - 4"	31' - 5" • NA	32' - 3" • NA
Exterior Height With A/C	11' - 3"	11' - 3"	11' - 3"
Exterior Width	101"	101"	101"
Interior Width	95.5"	95.5"	95.5"
Interior Height Frt/Rear	84"/77"	84"/77"	84"/77"
Fresh/Grey/Black Water (Gal)	35/32/27	44/39/39	44/39/39
L.P. Capacity (Gal)	9.8	9.8	9.8
Awning Length	14'	15' - 6"	11'
Water Heater (Gal)	6	6	6
Exterior Storage (Cu. Ft.)	32	102	80

## LE SERIES

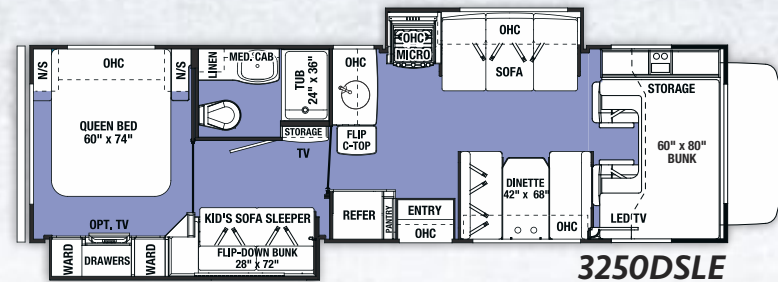
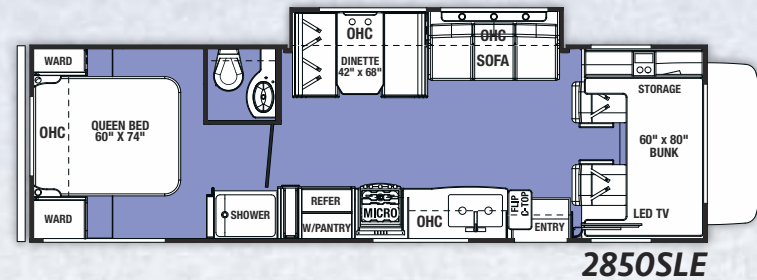
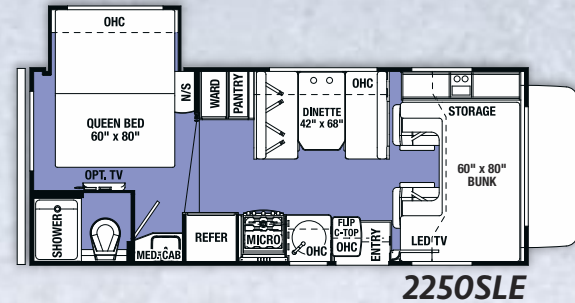





Shown in Pewter Decor with Rustic Cherry cabinetry.



**GRAND TOURING SERIES**

The streamlined GTS is the perfect vehicle for the ultimate getaway.

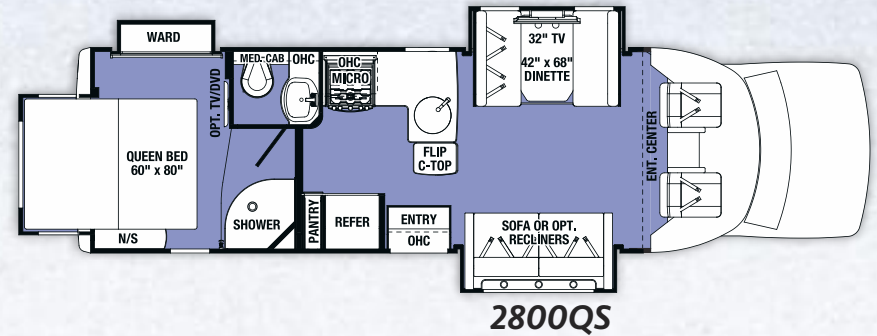
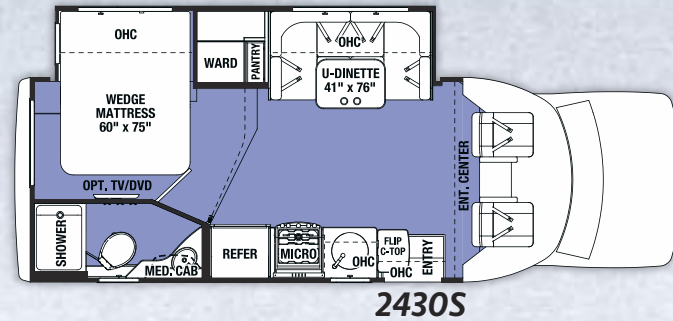

Sunseeker GTS	2430	2800
Wheelbase	176"	212"
GVWR	14500	14500
GAWR	9600	9600
GAWR	5000	5000
UVW	10920	11596
GCWR	22000	22000
CCC	3580	2904
Fuel Capacity (Gal)	55	55
Hitch Rating	7500/500	7500/500
Length - Bumper to Bumper	25' - 9"	30' - 4"
Exterior Height with A/C	10' - 8"	10' - 8"
Exterior Width	97"	97"
Interior Width	91"	91"
Interior Height Front/Rear	81"/75.5"	81"/75.5"
Fresh Water (Gal)	42/39/39	43/42/28
L.P. Capacity (Gal)	9.8	9.8
Awning Length	15' - 6"	18'
Water Heater (Gal)	6	6
Exterior Storage (Cu. Ft.)	37.8	73

**OPTIONS**

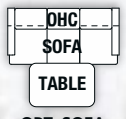

OPT. SOFA 2430S





# MBS MERCEDES-BENZ® SERIES

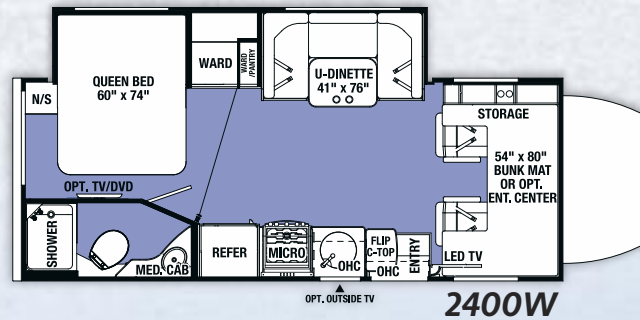
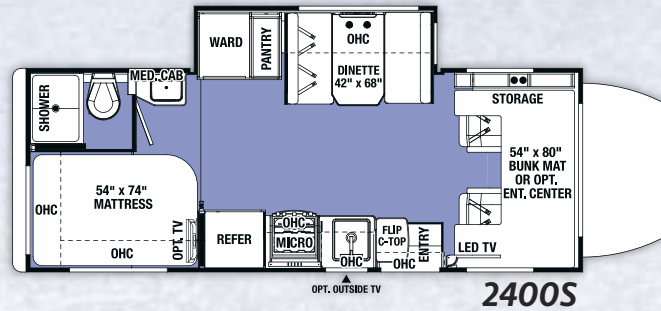
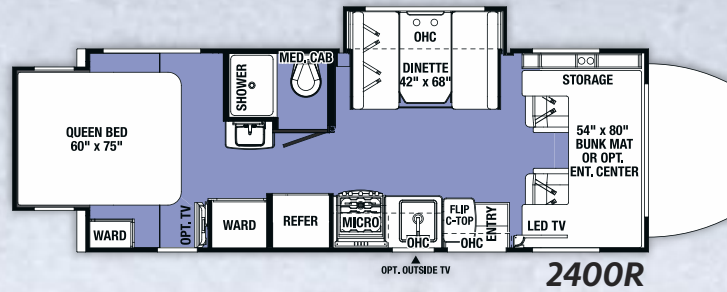

## OPTIONS

MBS

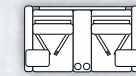

OPT. RECLINERS  
2400R



OPT. SOFA  
2400R, 2400S,  
2400W



Standard swivel seats  
and booster cushions.



## BlueTec Diesel Engine

BlueTec SCR Technology is one of the world's cleanest diesel engines, delivering more power, while producing fewer emissions. The 3.0l V-6 engine boasts 188 hp and 325 lb-ft of rated torque.

Shown with low profile Trekker cap option for aerodynamic styling and improved fuel economy. Seamless front cap is accented with LED light strips.



Sunseeker MBS	2400R	2400S	2400W
Wheelbase	170.3	170.3	170.3
GVWR	11030	11030	11030
GAWRR	7720	7720	7720
GAWRF	4080	4080	4080
UVW	9852	9700	9924
GCWR	15250	15250	15250
CCC	1178	1330	1106
Fuel Capacity (Gal)	26.4	26.4	26.4
Hitch Rating	4200/350	4200/350	4200/350
Length - Bumper To Bumper	24' - 11"	24' - 8"	24' - 11"
Exterior Height With A/C	11' - 3"	11' - 3"	11' - 3"
Exterior Width	94.5"	94.5"	94.5"
Interior Width	91"	91"	91"
Interior Height Frt/Rear	81"/74"	81"/74"	81"
Fresh/Grey/Black Water (Gal)	35/30/30	35/33/33	35/32/32
L.P. Capacity (Gal)	16.6	16.6	16.6
Awning Length	16'	15' - 6"	15' - 6"
Water Heater (Gal)	6	6	6
Exterior Storage (Cu. Ft.)	75	67	50.3

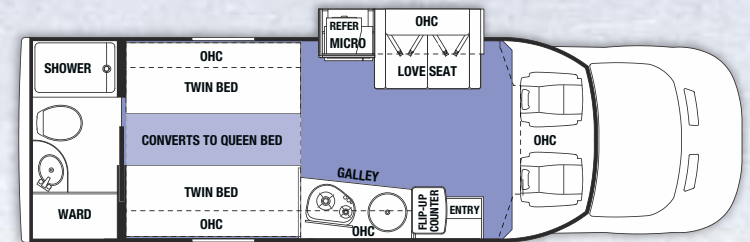

TS2370

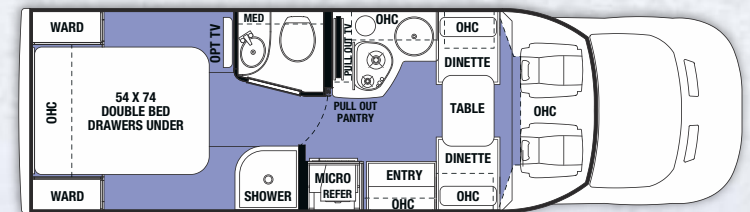

TS2390

Shown in Charcoal Decor

Sunseeker TS	2370	2390
Wheelbase	178"	178"
GVWR	10360	10360
UVW	8706	8050
GCWR	13500	13500
CCC	1654	2310
Fuel Capacity (Gal.)	25	25
Hitch Rating (Lb.)	0	0
Length - Bumper to Bumper	26' - 1"	25' - 6"
Exterior Height with A/C	10' - 5"	10' - 5"
Exterior Width	87"	87"
Interior Width	84"	84"
Interior Height Front/Rear	78"	78"
Fresh/Grey/Black Water (Gal.)	35/30/28	35/30/30
L.P. Capacity (Gal.)	9.8	9.8
Awning Length	15'	15'
Exterior Storage (Cu. Ft.)	30.5	38
Seat Belts	4	4



TRANSIT SERIES

Ultra-Light Weight Maneuverability with Exceptional Fuel Efficiency

The ultra-light Sunseeker TS is engineered for fuel efficiency with eco-friendly building materials. These lightweight, Poplar cabinets are certified to be sustainably sourced from European forests.

DECOR

CHARCOAL

Transit Series is available in Charcoal decor only.



WARRANTY	SS	GTS	MBS	LE	TS
12 Months/12,000 mile basic limited warranty	S	S	S	S	S
Chassis warranty (see owners manual)					
SYSTEMS	SS	GTS	MBS	LE	TS
Battery disconnect	S	S	S	S	S
Water heater bypass	S	S	S	S	S
(2) Deep cycle coach batteries (1 battery in LE and Transit)	S	S	S	S	S
"Easy Access" battery in step-well	S	S	S	S	S
30 Amp service with detachable cord	S	S	S	S	S
60 Amp Progressive Dynamics converter	S	S	S	S	S
6 Gallon DSI gas/electric water heater	S	S	S	S	-
30,000 BTU furnace	S	S	S	S	-
Truma Combi water heater/furnace	-	-	-	-	S
Emergency start switch	S	S	-	S	S
Satellite/cable connection	S	S	S	S	S
13,500 BTU ceiling ducted roof air	S	S	S	S	S
4.0 KW Onan Microquiet generator	S	S	-	S	-
3.6 KW Onan LP generator	-	-	S	-	-
2.5 KW Onan LP generator	-	-	-	-	S
Automatic generator transfer switch	S	S	-	S	-
Firestone Ride-Rite air helper springs	S	S	-	-	-
Hellwig sway bar	-	-	S	-	-
Water filtration system	S	S	S	-	S
Heated, enclosed holding tanks and valves	S	S	-	-	-
Arctic Package (12V tank heaters)	O	O	S	O	O
15K BTU A/C with heat pump	O	O	O	O	-
CO <sub>2</sub> , LP and smoke detector	S	S	S	S	S
Jack digital antenna	S	S	S	S	S
EXTERIOR	SS	GTS	MBS	LE	TS
2" Aluminum framed laminated sidewalls	S	S	-	S	-
1.5" Aluminum framed laminated sidewalls	-	-	S	-	S
Azdel Superlight composite substrate	S	S	S	S	-
Gel Coat exterior fiberglass	S	S	S	S	S
Block foam insulation	S	S	S	S	S
Power patio awning with LED light strip	S	S	S	S	S
Slide-out awnings	S	S	S	-	-
Fiberglass roof	S	S	S	S	S
One-piece fiberglass front cap	S	S	S	S	S
LED exterior lights	S	S	S	S	S
Stainless steel wheel liners	S	S	S	S	S
Valve stem extensions	S	S	S	-	-
Roto-cast storage compartments	S	S	S	S	S
Driver side security light	-	-	S	-	-
Aluminum running boards	S	-	-	O	-
Fiberglass running boards	-	S	S	-	S
110V, GFI protected exterior receptacle	S	S	S	S	S
Tinted sliding windows	S	-	-	S	-
Tinted frameless windows	-	S	S	-	S
Heated, remote exterior mirrors	S	S	-	-	-
7,500 Lbs. hitch, 7-pin connector (E450)	S	S	-	-	-
5,000 Lbs. hitch, 7-pin connector (Chevy/E350)	S	S	-	S	-
4,200 Lbs. hitch, 7-pin connector	-	-	S	-	-
Spare tire	S	S	S	S	S
Roof ladder (N/A 2400R, 2800QS)	S	-	S	S	-
Integrated entry step	S	S	-	S	S
Power entry step	-	-	S	-	-
Outside shower	S	S	S	-	S

	SS	GTS	MBS	LE	TS
Automatic leveling system (4-point)	O	O	-	O	-
Stabilizer jacks (2-point)	-	-	S	-	-
Full body paint	O	O	O	-	O
32" Outside 12V TV with speakers (3010DS, 3050S, 3170DS only)	O	-	-	-	-
19" Outside TV	-	-	O	-	-
Exterior grill with quick connect (standard 2860DS)	O	O	O	-	-
Black tank flush	S	S	S	-	S
19" Outside 12V TV with DVD and speakers	-	-	O	-	-
CAB AREA	SS	GTS	MBS	LE	TS
7" Touch screen radio with USB and Bluetooth	S	S	S	S	-
Cab area privacy curtain	S	S	S	S	S
Ultra leather driver and passenger seats	S	S	S	-	S
Power windows and door locks	S	S	S	S	S
Keyless entry (N/A Chevy)	S	S	S	S	S
Color back-up camera	S	S	S	S	S
Side view cameras	S	S	S	-	S
Removable cab mat	-	-	S	-	-
Swivel driver seat (N/A Chevy, Power)	O	O	S	-	-
Power driver seat (Ford only)	O	O	-	-	-
Swivel passenger seat (N/A Chevy)	O	O	S	-	-
KITCHEN	SS	GTS	MBS	LE	TS
Recessed 3-burner range with flush glass cover	S	S	S	S	-
Range hood with fan and light	S	S	S	S	-
Oven IPO drawer	S	O	O	S	-
Microwave oven	S	-	-	S	-
Convection microwave (Standard in 3050S)	O	S	S	-	S
6 Cu. ft. double door refrigerator	S	S	S	S	-
12 Cu. ft. four door refrigerator with ice maker (2860DS, 3010DS, 3050S)	O	-	-	-	-
5.3 Cu. ft. lightweight LP/Electric 110V Refrigerator	-	-	-	-	S
Raised wood refrigerator panel (N/A 12 cu. ft.)	S	S	S	-	-
Full extension ball bearing drawer guides	S	S	S	S	S
Flip-up countertop extension	S	S	S	S	-
BATHROOM	SS	GTS	MBS	LE	TS
Lightweight composite toilet with hand sprayer	S	S	S	S	S
Glass shower door	S	S	-	-	-
Lightweight Arcadia shower door	-	-	S	S	-
Towel bar, tissue, toothbrush and soap holder	S	S	S	S	S
Electric roof fan	S	S	S	S	S
Shower head with flexible extension	S	S	S	S	S
Shower skylight	S	S	S	S	S
BEDROOM	SS	GTS	MBS	LE	TS
Upgraded memory foam mattress	S	S	S	S	S
Bedspread	S	S	S	S	S
Black-out roller shades	S	S	S	S	-
Bedroom TV with DVD	O	O	O	-	O
LIVING ROOM	SS	GTS	MBS	LE	TS
Dream dinette (N/A with U-shape dinettes)	S	S	S	-	-
Visionary pull out sofa (60" x 74") (3010DS)	S	-	-	-	-
12V LED flat panel adjustable side TV	S	S	S	S	S
Cab over cabinets with 42" TV (IPO side TV)	O	-	-	-	-
Child seat head tethers in dinette	S	S	S	-	-
Maxx Air fan in living room	S	S	S	S	S
LED lighting throughout	S	S	S	S	S
Dual recliners IPO Sofa (3010DS, 2800QS, 2400R)	O	O	-	-	-
12V USB charging station	S	S	S	-	S



### PRE-DELIVERY INSPECTION FACILITY

20,000 square feet of quality assurance. The bare essentials for a premium product. This state-of-the-art facility gives immediate daily feedback to production for quality assurance in every unit built.

### 24/7 EMERGENCY ROADSIDE ASSISTANCE

For a worry-free ownership experience Forest River includes one year of Coach-Net RV Technical & Roadside Assistance with each RV purchase. Whether new to the RV lifestyle or an experienced RV enthusiast, Forest River owners have 24/7 access to technical, operational and emergency road service coverage throughout the US & Canada. Coach-Net's fast, dependable service is just a phone call away.



**Learn More**  
Scan this barcode using a QR Reader on your smart phone to learn more about Forest River.



A Berkshire Hathaway company.

All information contained in this brochure is believed to be accurate at the time of publication. However, during the model year, it may be necessary to make revisions and Forest River, Inc., reserves the right to make all such changes without notice, including prices, colors, materials, equipment and specifications as well as the addition of new models and the discontinuance of models shown in this brochure. Therefore, please consult with your Forest River dealer and confirm the existence of any materials, design or specifications that are material to your purchase decision ©2016 Sunseeker - a Division of Forest River, Inc. - a Berkshire Hathaway Company 5/17

### CUSTOMER SATISFACTION



www.ForestRiverBuyLocal.com

Your Local Sunseeker Dealer

For more information please visit: [www.forestriverinc.com/sunseeker](http://www.forestriverinc.com/sunseeker)  
914 CR 1 • Elkhart, In 46514 • 574.262.2212 • 800.445.2825

