

# ORION



CLASS C MOTORHOMES



# ORION

Leader to the Great Outdoors.

**ORION** INTERIOR APPOINTMENTS



T24TB shown with Cobblestone décor

## ORION CLASS C MOTORHOMES

The Coachmen Orion is distinctive, there's no question. But you'll also be impressed with its luxurious and spacious camper body, designed for versatility and low cost of ownership. The Orion will catch your eye with its sleek, expansive windshield and oversized, bright-finished, high-positioned headlamps. And when you get behind the wheel, you'll feel the power behind its award-winning 3.7L, 275HP V6 engine, delivering competitive fuel efficiency. Orion's unique and premium steering gear enhances drive and reliability, and provides an incredibly tight turning circle. Steering control is firm, responsive and confident.

As one of the top selling brands in the nation, Coachmen has been providing generations a product they can rely on for over 50 years. That same dedication to quality and value is evident in the intelligently-designed Orion.



**T24TB shown as lounge area**

Generous seating area • Large tinted radius slider windows • Soft touch ceiling

LED Interior lights throughout • Bamboo rolled flooring • Day/night roller shades •  
32" LCD TV/DVD/Bluetooth stereo w/speakers/subwoofer • Seating areas convert into sleeping areas



**T24RB/T24TB shown**



**T24RB/T24TB shown**

*(top)* Curved shower door • Undermount stonecast sink • composite foot flush toilet • ABS molded shower surround • Skylight over shower

*(bottom)* Euro-style sink and faucet with glass lid • Pop-up kitchen recept • Low profile range hood with lights • Euro-style 3-way refrigerator • Even Cool ceiling-ducted A/C

# ORION INTERIOR APPOINTMENTS



**T24RB shown as sleeping area**

60" x 80" Powered drop-down queen bed with bunk ladder • Luxury seating with integrated safety belts • Belted swivel chairs with flip-up table • Sofa converts to sleeping area • 32" LCD TV/DVD/speakers/subwoofer

Backup & side view monitor • Tilt steering wheel • Dash air conditioning • Exterior mirrors with heat & remote



**T24TB shown as sleeping area**



Shown with Cobblestone décor

# ORION EXTERIOR FEATURES



Coachmen's Even Cool™ air conditioning system is ducted through the crowned, vacuum-bonded roof. The system uses AMOCO insulated ductwork with radiused corners to provide maximum cooling efficiency.

TPO roof membrane – lightweight, durable and easy to maintain. 12-Year Limited Warranty.



Molded fiberglass front and rear caps w/integrated LED Lighting add a sleek automotive touch.



Orion's one-touch carefree armless power awning w/LED lights

2" thick aluminum cage construction, color-infused, hi-gloss fiberglass sidewalls. (standard)



Privacy windshield cover.

Long Arm Heated Exterior Mirrors w/Remote



LED Clearance, marker and tail lights



Azdel SuperLite™ sidewall substrate – lightweight, durable and moisture resistant.

Fiberglass rear wheel skirts

Stainless steel wheel inserts



Power entry step with 80" entry door and dual auxiliary battery box.



Solar Panel Plug-in Connection. (Solar panel sold separately)



Exterior Entertainment Center w/24" LCD TV/Stereo/DVD and Speakers.



Standard ONAN 2.8kw gas generator gives you 110v power when shoreline power is not available.



Fresh water fill, city hook-up, black water flush panel and pump switch winterize.

# ORION FLOOR PLANS AND SPECIFICATIONS

## T24TB

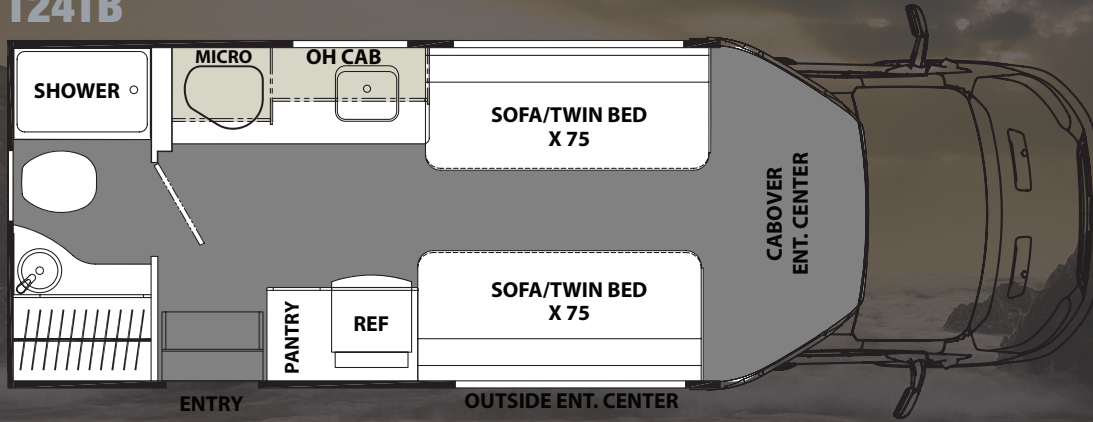

## T24RB

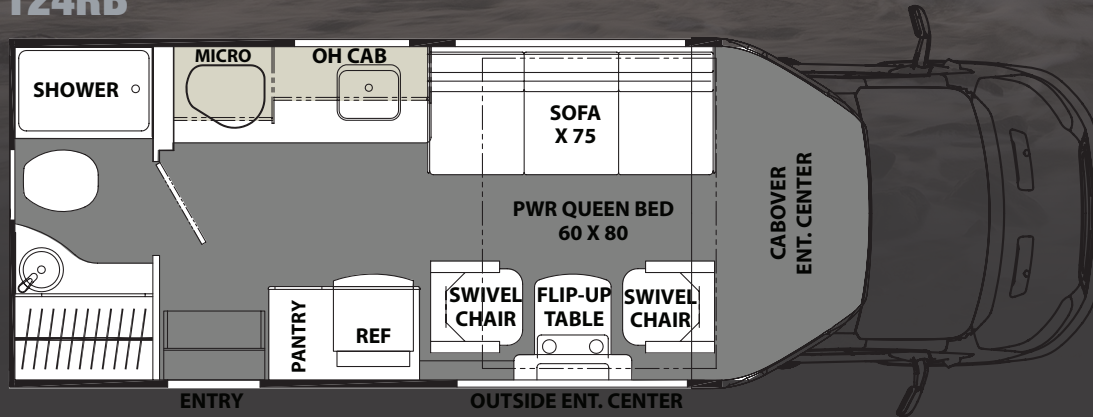

## SPECIFICATIONS

| MODEL                        | T24TB              | T24RB              |
|------------------------------|--------------------|--------------------|
| CHASSIS                      | FORD 350HP TRANSIT | FORD 350HP TRANSIT |
| ENGINE                       | V6-3.7L            | V6-3.7L            |
| HORSE POWER                  | 275                | 275                |
| TORQUE                       | 260                | 260                |
| WHEEL BASE                   | 156"               | 156"               |
| GVWR* (LBS.)                 | 10,360             | 10,360             |
| GCWR* (LBS.)                 | 12,125             | 12,125             |
| CW* (APPROX. LBS.)           | 8,140              | 8,140              |
| CCC (APPROX. LBS.)           | 2,220              | 2,220              |
| GAWR FRONT (LBS.)            | 4,130              | 4,130              |
| GAWR REAR (LBS.)             | 7,275              | 7,275              |
| INTERIOR HEIGHT              | 6' 7"              | 6' 7"              |
| EXTERIOR WIDTH               | 7' 7 1/2"          | 7' 7 1/2"          |
| EXTERIOR HEIGHT (W/ A/C)     | 10' 4"             | 10' 4"             |
| EXTERIOR LENGTH (W/ HITCH)   | 24' 0"             | 24' 0"             |
| HITCH WEIGHT (LBS.)          | 2,000              | 2,000              |
| FUEL CAPACITY (GAL.)         | 25                 | 25                 |
| LP CAPACITY (LBS.)           | 40                 | 40                 |
| FRESH WATER CAPACITY (GAL.)  | 28                 | 28                 |
| WATER HEATER CAPACITY (GAL.) | 6                  | 6                  |
| GREY TANK CAPACITY (GAL.)    | 32                 | 32                 |
| BLACK TANK CAPACITY (GAL.)   | 32                 | 32                 |
| EXTERIOR STORAGE (CU. FT.)   | 24                 | 24                 |
| AWNING LENGTH                | 14'                | 14'                |

**GVWR (Gross Vehicle Weight Rating)** is the maximum permissible weight of the unit when fully loaded. It includes all weights, inclusive of all fluids, occupants, cargo, optional equipment and accessories. For safety and product performance do NOT exceed the GVWR.

**GCWR (Gross Combined Weight Rating)** is the maximum permissible loaded weight of your motor home and any towed trailer or towed vehicle. Actual GCWR of this vehicle may be limited by the sum of the GVWR and the installed hitch receiver maximum capacity rating; see hitch rating label for detail.

**GAWR (Gross Axle Weight Rating)** is the maximum permissible weight, including cargo, fluids, optional equipment and accessories that can be safely supported by each axle.

**UVW (Unloaded Vehicle Weight)** \* is the typical weight of the unit as manufactured at the factory. It includes all weight at the unit's axle(s), including full fuel, all fluids and LP Gas. The UVW does not include cargo, fresh potable water, additional optional equipment or dealer installed accessories.

\*Estimated Average based on standard build optional equipment.

**CCC (Cargo Carrying Capacity)** \*\* is the amount of weight available for fresh potable water, cargo, passengers, additional optional equipment and accessories. CCC is equal to GVWR minus UVW. Available CCC should accommodate fresh potable water (8.3 lbs per gallon). Before filling the fresh water tank, empty the black and gray tanks to provide for more cargo capacity.

\*\* Estimated average based on standard build optional equipment

Each Coachmen motorhome is weighed at the manufacturing facility prior to shipping. A label identifying the unloaded vehicle weight of the actual unit and the cargo carrying capacity is applied to every Coachmen motorhome prior to leaving our facilities.

The load capacity of your unit is designated by weight, not by volume, so you cannot necessarily use all available space when loading your unit.

Actual towing capacity is dependent upon your particular loading and towing circumstances, which includes the GVWR, GAWR and GCWR as well as adequate trailer brakes. Please refer to the Operator's Manual of your vehicle for further towing information.

## STANDARD

### WARRANTY

- Motorhome – 12 Month/ 12,000 mile limited warranty
- Chassis Warranty – See Chassis Owners Manual
- Travel Easy Roadside Assistance

### AUTOMOTIVE/EXTERIOR/CONSTRUCTION

- 25-Gallon Fuel Tank
- 3.7 Liter V6 Gas w/6-speed Auto w/ Tow Haul 275HP/260TRQ
- Driver & Passenger Air Bags
- Cruise Control
- Tilt Steering Wheel
- Dash Air Conditioning
- Power Windows & Locks
- Factory Exterior Mirrors w/Heat & Remote
- 2,000 lb. Hitch w/4-way Flat Plug
- Laminated Aluminum 2" Floor
- Laminated Aluminum 2" Sidewalls
- Crowned, Laminated TPO Roof
- Steel Entry Step w/Battery Storage
- Carmel Exterior Moldings
- Carmel Slam Latch Trunk Doors
- Carmel 80" Radius Entry Door w/Window, Deadbolt & Strut
- Carmel Lamilux 4000 Sidewalls & Rear Wall
- Vinyl Graphics
- Plasti-Cote Metal Side Boxes
- Fiberglass Rear Cap
- Fiberglass Front Cap
- Fiberglass Rear Wheel Skirts
- SS Wheel Inserts
- Carefree Armless Power Awning
- Aluminum Body Side Moldings
- Smooth Exterior Range Vent
- Exterior LED Lights w/Center Bar
- LED Accent Strip Lights in Front Cap
- Color Backup Camera
- Color Side View Cameras
- All Aluminum Walls
- Tread-Lite Single Step Power Entrance Step

### INTERIOR APPOINTMENTS

- Dahat Teak Cabinet Woodgrain
- Serenity Ash Panel Woodgrain and Bathdoor
- Thermo Foil Wood Accent Color - Etched Medallion
- Twain Nutmeg - Sidewalls
- Black Hardware (3-3/4" spread)
- Granite Chocolate 1 1/4" Laminate Foam Countertops Throughout
- Bamboo 793 Rolled Flooring
- Vinyl Soft Touch Ceiling
- Roller Bearing Metal Drawer Guides throughout
- Poplar Drawers (ex. behind doors are techwood)
- Window Shades & Valance Topper (where applicable)
- Tinted Radius Slider Windows
- Belted Swivel Chairs w/Flip-up Table (T24RB)
- 74" Jackknife Sofa (T24RB)
- Sofas w/Remote Tilt (T24TB)
- Slab Style Doors & Drawers
- Flat Panel House-type Bath Door
- Black Recepts/Rotaires/Switches
- Black Curved Bar Grab Handle at Entrance Door
- Vinyl Padded Up & Angle Pads
- Vinyl Padded Headnocker

### INTERIOR EQUIPMENT

- Powered Jack Wing Antenna
- LP Leak Alarm
- Smoke Detector
- Carbon Monoxide Detector
- Fire Extinguisher
- Factory Dash Radio AM/FM/CD
- Backup Monitor on Rear View Mirror
- Furrion 32" Coach LCD TV, DVD & Speakers & Sub
- Pre-wired for Satellite Dish through Coax Input

### GALLEY

- Furrion Microwave
- Dometic Euro Style 3-way Refrigerator
- Euro Style Sink & Faucet w/Glass Lid
- Power Lighted Low Profile Range Hood
- Euro Style 2-burner Cooktop w/Glass Lid
- Kitchen Tile Border

### BATH AND WATER

- Water Panel w/City/Tank/Winterize/Waste Tank Flush
- Low Point Drain & Winterize Valve at Fresh Tank
- Outside Shower on ODS
- Power Bath Vent
- Demand Water Pump
- Under Mount American Stonecast Sink
- Satin Nickel Single Post/Single Lever Lav Faucet
- Satin Nickel Shower Head & Faucet
- Lav Mirror
- Plastic Curved Shower Door
- Towel Ring/TP Holder/Robe Hooks
- ABS Molded Shower & Surround
- Composite Foot Flush Toilet
- 6-Gallon Gas Eenergy Efficient Water Heater
- Skylight Over Shower

### SLEEPING

- Queen Bed 60" x 80" Powered Lowering Bed (T24RB)
- Twin Beds w/Remote Tilt (T24TB)
- Fabric Covered Upgrade 4" Mattress
- Windshield Privacy Cover
- Bunk Ladder

### ELECTRICAL/HEATING/AC

- 30 Amp Power Cord
- 55 Amp Electronic Converter
- Dual Auxiliary Battery
- Manual Generator Changeover
- 2.8 KW Gas Onan Generator
- GFI Circuit
- Black Manual Auxiliary Battery Disconnect
- LED Patio Light
- Wall Mounted Thermostat
- 18,000 BTU Energy Efficient Ducted Furnace
- 13,500 Low Profile Ducted A/C w/Heat Strip
- Recept & Coax Connection Under Awning
- New LED Interior Lights
- Exterior Entertainment Center (Furrion 24" TV/Stereo/DVD/Speakers)
- Exterior Grab Handle at Entrance Door
- Command Center
- Heated Holding Tanks
- Pop Up Kitchen Recept

- Exterior Solar Panel Plug-in Connection (by Entry Door)
- EMS Power Shedding System
- Remote Fill LP Tank
- Bed Area 110V CPAP Ready Area & 12V/USB Charging Station

## DÉCOR



**COBBLESTONE**



**CHAMPAGNE**

*Standards and Options subject to change without notice.*



**Travel Easy™  
Roadside Assistance**

RVing is easier with Coachmen's Travel Easy™ Roadside Assistance provided FREE the first year of ownership to those who purchase a New Coachmen RV. Administered by Coach-Net, this service provides you with 24/7 operational, technical and emergency road service coverage. Also included is towing, fuel delivery, jump starts, lockout service, tire changes, mobile mechanic and unlimited technical assistance. Anywhere. Anytime. Travel Easy™ is the security of knowing that help is an easy phone call away.



**Free One Year Membership –  
Coachmen Owners' Association**

Coachmen is proud to sponsor the largest manufacturer sponsored camping club in North America ... Coachmen Owners' Association (COA). COA provides a broad breadth of value propositions for our owners including: planned trips/ tours and rallies at bulk rate discounts, free trip routing, free campground directory, free Easy RVing magazine, theme park discounts, fuel discounts, mail forwarding, a dedicated COA web site, local and state club activities and Caravan Chapter membership opportunities. Most importantly, COA enhances the Coachmen ownership and RV lifestyle experience.

**Every new Coachmen RV buyer is eligible for a 1 Year FREE membership in the Coachmen Owners' Association. It all adds up to an easy ownership experience!**



**Forest River, Inc. encourages our customers to purchase their Forest River products from a local dealership whenever possible for the following reasons:**

- 1) Forest River, Inc. dealers are independently owned and operated businesses so priority service and scheduling is at their discretion and is often provided to customers that purchased their unit at that dealership.
- 2) Purchasing locally allows customers to establish meaningful relationships with a dealer, enhancing the RV experience through assistance with product questions, user tips or RV regulations for your state or country, and much more!
- 3) Canadian customers must meet requirements to bring an RV purchased out of the country to their home. These requirements may involve additional inspections and certifications, taxes and fees. Your local Canadian Dealer is a professional at meeting these requirements.
- 4) Scheduling timely warranty repairs and adjustments through a local dealership provides far greater flexibility and convenience to you, the customer!

It is the goal of Forest River, Inc. that all of our RV owners fully enjoy the RV experience and that customer satisfaction meets or exceeds their expectations!



**Learn More**  
Scan this barcode using a QR Reader on your smart phone to learn more about Forest River.



A Berkshire Hathaway company.

All information contained in this brochure is believed to be accurate at the time of publication. However, during the model year, it may be necessary to make revisions and Coachmen reserves the right to make all such changes without notice, including prices, colors, materials, equipment and specifications as well as the addition of new models and the discontinuance of models shown in this brochure. Therefore, please consult with your Coachmen dealer and confirm the existence of any materials, design or specifications that are material to your purchase decision. 3/16

©Copyright 2016 Coachmen RV a Division of Forest River Inc – All Rights Reserved.



**Coachmen RV Owner "Digital Kit" App**

Now you can have your Owners Manual with you wherever you are. Download our free App from iTunes and you'll have the information at your fingertips.

**Your ORION Dealer**



**Coachmen**  
Leader to the Great Outdoors.

**423 N. Main Street • P.O. Box 30  
Middlebury, IN 46540**

To learn more about Coachmen RV and our products and see how Coachmen is making the easy life easier, call us toll free at **(800) 353-7383**, or visit **www.coachmenrv.com**