

UN·MAPPED

r.pod



FOREST RIVER

FORESTRIVERINC.COM

UN·MAPPED FLOORPLANS

r.pod



22RB	UVW	HITCH	CCC	LENGTH	HEIGHT	WIDTH	CAPACITY (GAL)		
	5,693	640	1,500	27' 11"	10' 8"	8'	40	60	30



24RK	UVW	HITCH	CCC	LENGTH	HEIGHT	WIDTH	CAPACITY (GAL)		
	5,928	760	1,500	28' 11"	10' 6"	8'	40	70	30

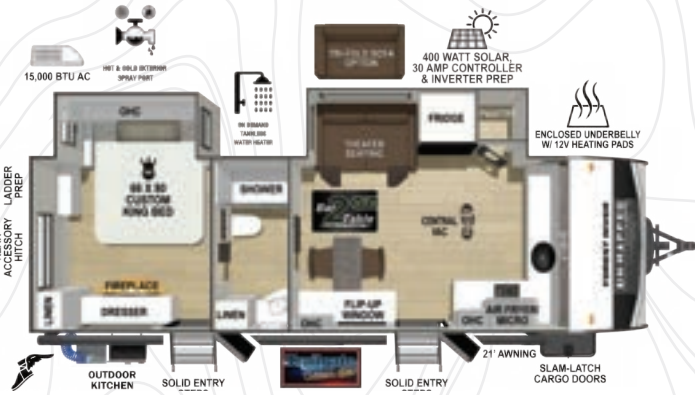

25FK	UVW	HITCH	CCC	LENGTH	HEIGHT	WIDTH	CAPACITY (GAL)		
	6,258	670	1,412	29'	10' 6"	8'	40	70	30

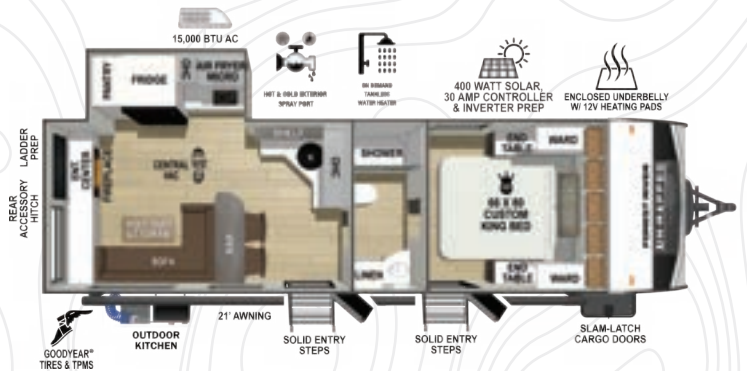

25RL	UVW	HITCH	CCC	LENGTH	HEIGHT	WIDTH	CAPACITY (GAL)		
	5,778	735	1,500	29' 0"	10' 8"	8'	40	40	30



26BH	UVW	HITCH	CCC	LENGTH	HEIGHT	WIDTH	CAPACITY (GAL)		
	5,878	875	1,500	28' 11"	10' 8"	8'	40	60	30



26ML	UVW	HITCH	CCC	LENGTH	HEIGHT	WIDTH	CAPACITY (GAL)		
	5,668	720	1,500	28' 11"	10' 6"	8'	40	40	30

BAR 2 TABLE



Bar2Table is a new concept that allows you to enjoy a bar top for 2—or to convert the layout into a more traditional 4-person dinette top. The **Bar2Table** feature comes complete with a flip up, truck style window for open air dining and pristine views.

TRAILGATE OUTDOOR BAR



Select Un•mapped floorplans will also debut with the new **TrailGate Outdoor Bar**. This unique outdoor setup maximizes space while providing an area to prepare refreshments or entertain guests.



Un-Matched Standard Features



SUPERIOR CONSTRUCTION



1 Laminated Sidewalls, Rear Wall, Slide-Outs, & Floor

- Solid wall construction
- Block foam insulated
- Superior durability

2 Azdel Composite Sidewalls, Rear Wall, Front Wall, & Slide-Outs

- Replaces plywood used by competing brands
- Water resistant material
- Helps prevent rot, mold, & delamination
- Increases insulation values

3 Laminated Sidewalls, Rear Wall, Slide-Outs, and Floor

- Welded aluminum framing around all openings
- Lighter weight than competing brands: true half ton towable
- Stronger & better constructed

4 Fully walkable roof with industry-best PVC membrane

- 16" on-center trusses, plywood decking, & residential style insulation
- 15 year warranty on PVC membrane
- No treatments required on PVC — saves time & money

5 Extended Season Ready

- 2" aluminum framed floor with block foam insulation
- Underbelly sealed and insulated with radiant foil
- Forced heat to underbelly through dedicated duct
- Heated holding tanks with 12V heating pads



SCAN ME
FOR MORE UN-MAPPED DETAILS

EACH NEW FOREST RIVER PURCHASE PROVIDES:

- ✓ Pre-delivery Inspection. ✓ Digital Owner's Manual.
- ✓ Free Membership to Forest River Owners Group (FROG).
Learn more at www.forestriverfrog.com.
- ✓ A Contribution to Care Camps Foundation www.carecamps.org.
- ✓ 1 Year Free Roadside Assistance from Date of Purchase.



LEARN MORE:

Scan this QR code with your mobile device to learn more about Forest River.



SPECIFICATION DEFINITIONS:

Scan this barcode using a QR reader on your smartphone to learn RV terminology and more!



YOUR **UN-MAPPED** DEALER