

**OPTIONS**

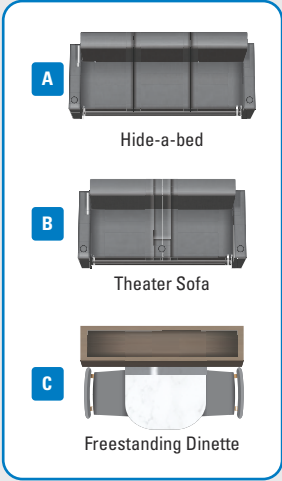

**37K** OPTIONS: C



**37L** OPTIONS: B



**37M** OPTIONS: A, C

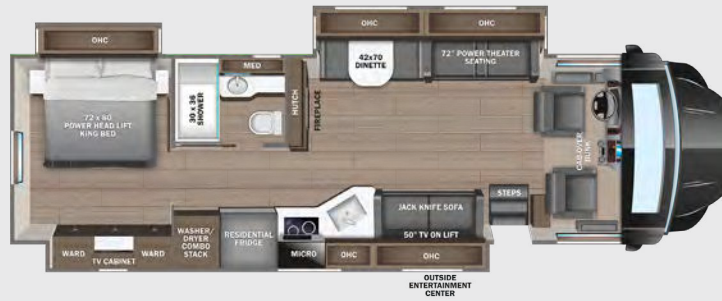

**EXTERIOR SELECTIONS**



Beige Marvel Full-Body Paint



Blue Marvel Full-Body Paint



Grey Marvel Full-Body Paint



Red Marvel Full-Body Paint

# STANDARDS & OPTIONS

## CUSTOMER VALUE PACKAGE

JRIDE® PREMIUM: Computer-balanced driveshaft, rear air suspension, heavy-duty rear stabilizer bar, full air brakes, SACHS shocks  
 Dual-pane, tinted, safety-glass windows  
 Roof-mounted Girard® NOVA II dual-pitched patio awning with LED lights  
 2,000W pure sine wave inverter  
 Power cord reel with 50 amp service  
 Aqua-Hot® 250D hydronic water and heating system with 5 in. LED screen  
 9 in. Sony® infotainment center with Apple CarPlay® and Android Auto™  
 Backup and side-view cameras  
 21 cu.ft. side-by-side residential refrigerator with ice and water in door  
 Flush-mounted convection microwave

## DRIVING

Freightliner® S2RV chassis  
 Cummins® ISB 6.7L 360 HP diesel engine with 800 ft.-lb. torque  
 Allison® 3000 MH automatic transmission  
 Variable geometry engine exhaust brake  
 185 amp alternator  
 Michelin® tires- 275/80R 22.5 14 ply  
 12,000 lb. rear hitch receiver  
 7-pin plug  
 Dual 12V chassis batteries  
 100 gal. fuel tank  
 10 gal. DEF tank  
 6-way power driver and passenger seats  
 Auxiliary start switch  
 Privacy curtains for cab area  
 Color-coordinated carpeted floor mat

## EXTERIOR

Onan® 8,000W diesel generator with auto-gen start  
 (4) 6V AGM (220Ah) house batteries on slideout tray  
 Solar prep  
 Dual 15,000 BTU A/C unit with heat pumps  
 5,000 BTU thermostat-controlled electric fireplace  
 Thetford® Sani-Con Turbo macerator system  
 Exterior utility center  
 Winterization drain system  
 Black tank flush  
 Outside shower  
 12V demand water pump  
 Water filtration system  
 Power windows and door locks  
 Tilt and telescoping leather-wrapped steering wheel  
 StrongholdVBL™ roof, floor and sidewalls for superior insulation and sound absorption  
 One-piece, seamless, crowned fiberglass roof  
 Bead-foam insulation (R-24 max roof, R-9 max floor, R-5 max walls)  
 One-piece, seamless, fiberglass front and rear caps  
 Automotive-bonded panoramic window in front cap with power shade

Premium Sikkens full-body paint  
 Automatic hydraulic leveling jacks  
 Alcoa® aluminum wheels  
 Exterior entertainment center with outside speakers, LED TV mounted on swivel bracket and AM/FM radio  
 Winegard® In-motion satellite dish  
 Deluxe heated, remote-controlled, side-view mirrors  
 Entrance door with industry's largest travel-view window  
 Electric-powered entrance step  
 Slideout awning(s)  
 Chrome exterior baggage door handles and locks  
 Carpeted, full pass-through storage compartments with lockable slam-latch doors

## INTERIOR

Custom-molded ABS surround in cab-over area  
 Overhead bunk with 750 lb. capacity and safety net with 300 lb. capacity  
 Collapsible bunk ladder  
 JAYCOMMAND™ powered by Firefly offers control of important coach features via LED touchscreen or mobile app  
 High-intensity recessed LED ceiling lights  
 Raised-panel hardwood cabinetry and stiles throughout  
 Deluxe hidden cabinet hinges  
 Matte-finish woodgrain porcelain floor tile with heated floor mat  
 Entegra-exclusive, easy-operation legless dinette table  
 Car seat tethers on forward-facing dinette seats  
 2-point lap safety belts in all designated seating locations  
 50 in. LED TV in living area (40 in. on 37K)  
 CableTV hookup with RG-6 coax and video selector switch  
 Wood-framed kitchen window with spice cabinets  
 2-burner induction cooktop with LED display  
 Solid-surface kitchen countertop with large recessed stainless steel sink with sink covers  
 One-piece, fiberglass shower with glass door, skylight and light  
 Porcelain toilet with foot flush  
 Solid-surface bathroom sink  
 Powered roof vent in bathroom with wall switch  
 Walk-around, king-size bed with bedspread and nightstands  
 32 in. Smart LED TV in bedroom  
 Large wardrobes  
 Smoke alarm  
 Carbon monoxide detector

## OPTIONS

Power theater seating (37L only)  
 Freestanding table with 4 chairs (N/A 37L)  
 Hide-a-bed sofa (37M only)  
 Stackable washer/dryer  
 Winegard® TRAV'LER® satellite dish - DIRECTV®  
 Winegard® TRAV'LER® satellite dish - Dish Network®  
 Canadian Shaw® TRAV'LER® satellite dish

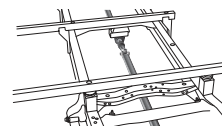

### COMPUTER-BALANCED DRIVESHAFT

Ensures smooth and efficient power transfer to the wheels

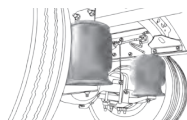

### REAR AIR SUSPENSION

Softens ride and improves handling

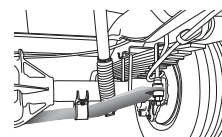

### HEAVY-DUTY REAR STABILIZER BAR

A larger bar and polyurethane bushings, instead of rubber, transfer power faster for extra support, more stability and easier handling

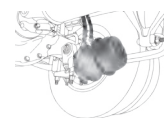

### FULL AIR BRAKES

Deliver robust stopping power, even on grades

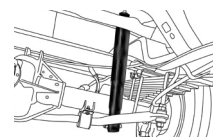

### SACHS SHOCKS ABSORBERS

Large diameter tube design pairs gas and hydraulics to resist heat and pressure while independently adjusting to changing road conditions

FLOORPLAN	GVWR (lbs.)	GCWR (lbs.)	WHEEL BASE	OVERALL LENGTH	EXTERIOR HEIGHT WITH SATELLITE AND A/C	EXTERIOR WIDTH	INTERIOR HEIGHT	FRESH WATER CAPACITY (gal.)	GRAY WASTE WATER CAPACITY (gal.)	BLACK WASTE WATER CAPACITY (gal.)
37K	31,000	43,000	279"	39' 4"	13' 4"	101"	84"	72	51/40	40/23
37L	31,000	43,000	279"	39' 4"	13' 4"	101"	84"	72	50/31	50
37M	31,000	43,000	279"	39' 4"	13' 4"	101"	84"	72	40/40	33/23

Meet your Jayco Dealer



Scan QR code for specification definitions

Some specs at the time of print may include estimates. For the most updated information, please visit [Jayco.com/seneca-prestige](http://Jayco.com/seneca-prestige)

Jayco, Inc. | P.O. Box 460 | Middlebury, IN 46540

See dealer for further information and prices. All information in this brochure and on [www.jayco.com](http://www.jayco.com) is the latest available at the time of publication approval. Jayco reserves the right to make changes and to discontinue models without notice or obligation. Photography may show optional equipment or props used for decoration purposes only. RVs built for sale in Canada may differ to conform to Canadian codes. JAYCO and the JAYCO BIRD IN FLIGHT are registered trademarks of Jayco, Inc. Printed in USA 8/22 ©2022 Jayco, Inc. 2032586.2023



Jayco - Part of Jayco Family of Companies