

Jayco | 2025 Jay Feather SL Travel Trailer



JAY FEATHER SL

ADVENTURE BOUND



2+3
YEAR | YEAR
WARRANTY



2026 JAY FEATHER SL 26BHSL TRAVEL TRAILER



JAY FEATHER SL TRAVEL TRAILER



25RSL OPTIONS: A, B

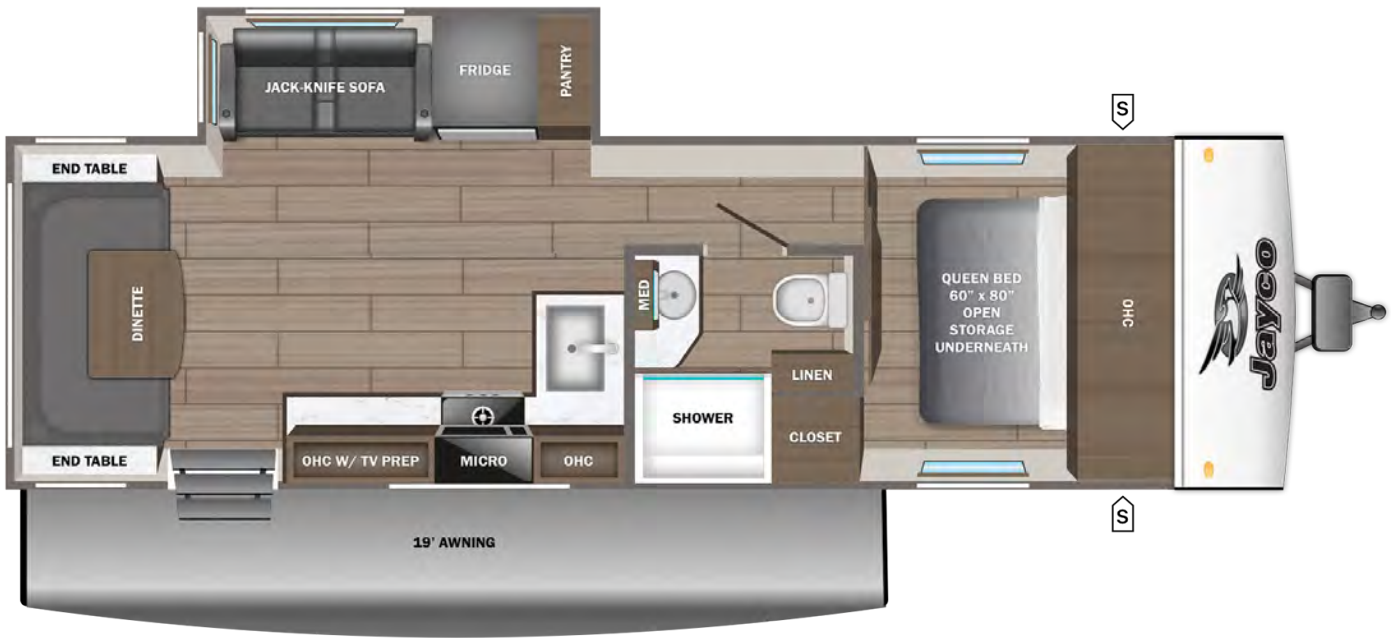

26BHS OPTIONS: A, B

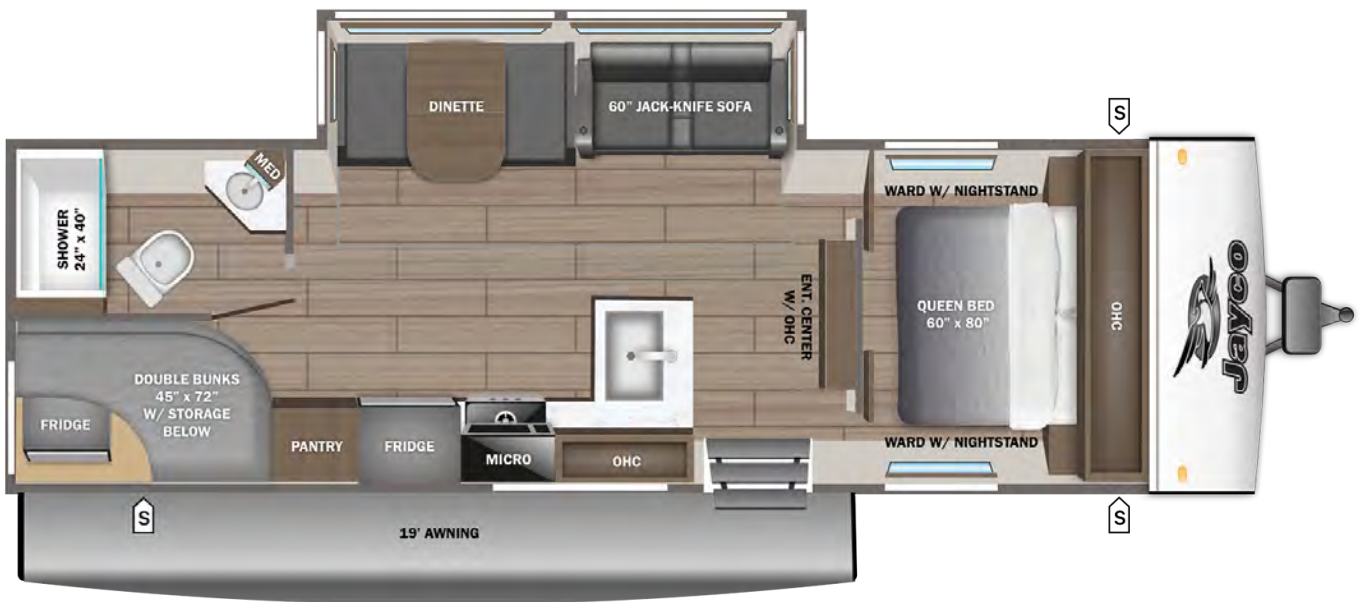

	STORAGE
MICRO	MICROWAVE
OHC	OVERHEAD CABINETS
FRIDGE	REFRIGERATOR
WARD	WARDROBE

OPTIONS

A		B	
	Tri-fold Sofa		Theater Seat

STANDARDS & OPTIONS

EXTERIOR

120V power outlet
 30-amp service
 Axles with electric, self-adjusting brakes and easy-lube hubs
 Fully-integrated A-frame
 Galvanized-steel, impact-resistant wheel wells
 Large exterior downspouts
 Magnum Truss™ Roof System
 Nitrogen-filled radial tires
 PVC roofing membrane (limited lifetime warranty)
 Slide topper prepped

INTERIOR

300 lb. rated single bunk beds / 600 lb. rated double bunk beds (bunk only models)
 Digital TV antenna
 Heavy-duty, 75 lb. full-extension steel ball-bearing drawer guides
 High-rise kitchen faucet
 Marine-grade toilet with foot flush
 Plywood bed platforms
 Queen mattress
 Residential-style kitchen countertops

Solid hardwood cabinet doors with screwed-stile construction and hidden hinges
 Vinyl flooring throughout
 Wood-trimmed mirror in bathroom

CUSTOMER VALUE PACKAGE (MANDATORY)

11 cu. ft. 12V fridge
 13.5K BTU Roof A/C
 20 lb. LP bottle with auto regulator & fill gauge
 Automotive-style Aluminum Rims
 Bathroom skylight
 Detachable power cord
 Electric Fireplace Prep
 Electric vent in bathroom
 Entry door with window and shade prep
 G20 dark-tinted privacy windows
 Hidden cabinet hinges
 Inverter pre-wire outlets
 Keyed-Alike™ lock system
 Large folding entry door grab handle
 LED interior and exterior lights
 Microwave oven
 MORryde Step Above® Entry Steps
 On-demand Tankless Water Heater

Pleated window shades
 Plywood dinette bases
 Power awning with LED lights
 Power tongue jack
 Range hood
 Rear 2 in. receiver prep
 Rear back-up camera prep
 Roof mounted solar prep
 Shower surround
 Stabilizer jacks
 Under-mount spare tire
 Vacuum-bonded sidewalls with interior and exterior Azdel® composite panels

OPTIONS

15K BTU roof mounted A/C
 2nd 13,500 BTU roof mounted A/C
 50-amp service
 Overlander 1 Solar Package: (1) 200W solar panel and 30-amp digital controller
 Tri-fold Sofa

*Indicates split tanks

FLOORPLAN	TOTAL EXTERIOR LENGTH	EXTERIOR WIDTH	EXTERIOR HEIGHT (WITH A/C)	INTERIOR HEIGHT	UNLOADED VEHICLE WEIGHT	DRY HITCH WEIGHT	GVWR	CARGO CARRYING CAPACITY	FRESH WATER CAPACITY	GRAY WASTE WATER CAPACITY	BLACK WASTE WATER CAPACITY	SLEEPING CAPACITY
25RLSL	TBD	TBD	TBD	TBD	TBD	TBD	TBD	TBD	TBD	TBD	TBD	TBD
26BHSL	30' 0"	8' 0"	10' 9"	6' 6"	5,675	765	7,200	1,525	55	38	38	8-10

Meet your Jayco Dealer



Scan QR code for specification definitions



Some specs at the time of print may include estimates. For the most updated information, please visit Jayco.com

Jayco, Inc. | P.O. Box 460 | Middlebury, IN 46540

See dealer for further information and prices. All information in this brochure and on www.jayco.com is the latest available at the time of publication approval. Jayco reserves the right to make changes and to discontinue models without notice or obligation. Photography may show optional equipment or props used for decoration purposes only. RVs built for sale in Canada may differ to conform to Canadian codes. JAYCO and the JAYCO BIRD IN FLIGHT are registered trademarks of Jayco, Inc. Printed in USA 10/25 ©2025 Jayco, Inc. 2033113

Jayco - Part of Jayco Family of Companies