

Jayco | 2026 Jay Feather Travel Trailer



# JAY FEATHER

ADVENTURE IS CALLING



**2+3**  
YEAR | YEAR  
WARRANTY



2026 JAY FEATHER 29BHB TRAVEL TRAILER (PREMIER PACKAGE)





# JAY FEATHER TRAVEL TRAILER



**26FK** OPTIONS: C, D

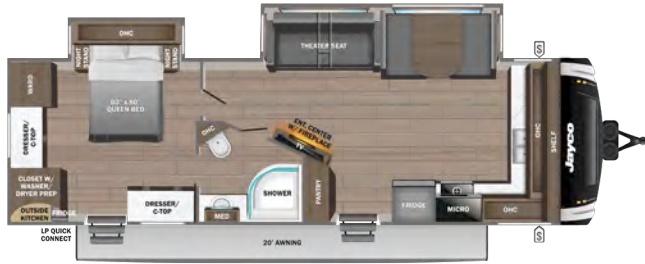

**26RL** OPTIONS: C, D



**27BH** OPTIONS: B, C, D



**27MK** OPTIONS: B, C, D



**28RB** OPTIONS: B, C, D



**29BHB** OPTIONS: B, C, D



	STORAGE
<b>MICRO</b>	MICROWAVE
<b>OHC</b>	OVERHEAD CABINETS
<b>FRIDGE</b>	REFRIGERATOR
<b>WARD</b>	WARDROBE

**OPTIONS**

<b>A</b>		<b>B</b>		<b>C</b>		<b>D</b>	
	Tri-fold Sofa		Theater Seat		King Bed		Table & Chairs

# JAY FEATHER TRAVEL TRAILER

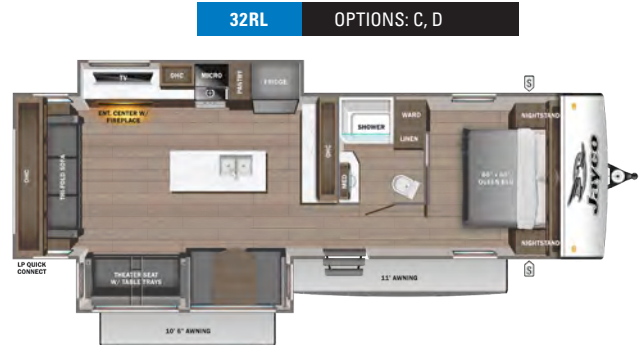
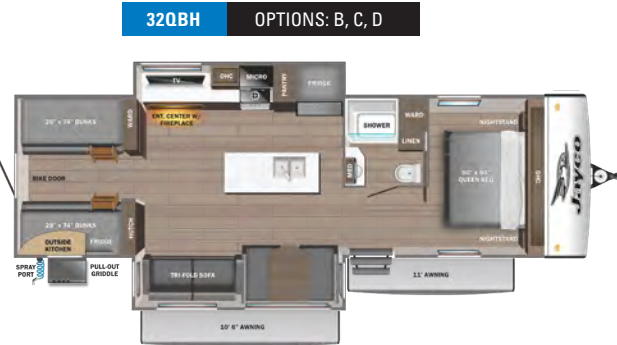
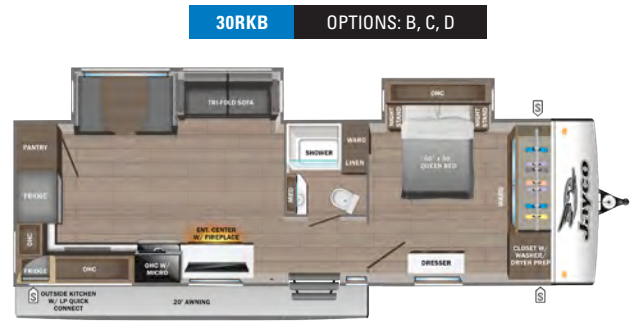
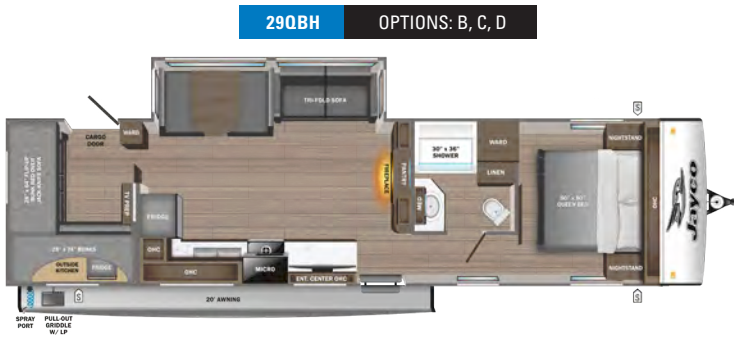

**STORAGE**

**MICRO**    MICROWAVE

**OHC**        OVERHEAD CABINETS

**FRIDGE**    REFRIGERATOR

**WARD**        WARDROBE

**OPTIONS**

**A**    Tri-fold Sofa

**B**    Theater Seat

**C**    King Bed

**D**    Table & Chairs

\*Indicates split tanks

FLOORPLAN	EXTERIOR TRAVEL LENGTH	EXTERIOR WIDTH	EXTERIOR HEIGHT (WITH A/C)	INTERIOR HEIGHT	UNLOADED VEHICLE WEIGHT	DRY HITCH WEIGHT	GVWR	CARGO CARRYING CAPACITY	FRESH WATER CAPACITY (INCLUDING WATER HEATER)	GRAY WASTE WATER CAPACITY	BLACK WASTE WATER CAPACITY	SLEEPING CAPACITY
19MRK	23' 14"	8' 0"	10' 9"	6' 6"	4,820	550	6,400	1,580	55	38	30.5	1-2
21MBH	26' 8"	8' 0"	10' 9"	6' 6"	5,450	600	6,995	1,545	55	30.5	30.5	6-8
21MML	25' 5"	8' 0"	10' 7"	6' 6"	5,085	615	6,500	1,415	55	30.5	30.5	1-3
23MBD	TBD	TBD	TBD	TBD	TBD	TBD	TBD	TBD	TBD	TBD	TBD	TBD
23RK	28' 7"	8' 0"	10' 8"	6' 6"	5,780	665	7,400	1,620	55	30.5	30.5	2-4
24FK	26' 6"	8' 0"	10' 8"	6' 6"	5,855	785	7,500	1,645	55	76*	38	1-2
25BH	TBD	TBD	TBD	TBD	TBD	TBD	TBD	TBD	TBD	TBD	TBD	TBD
25RB	30' 1"	8' 0"	10' 8"	6' 6"	5,900	715	7,500	1,600	55	61*	38	4-6
26FK	33' 10"	8' 0"	11' 0"	6' 6"	7,090	955	8,700	1,610	55	91.5*	30.5	2-4
26RL	31' 4"	8' 0"	10' 8"	6' 6"	5,930	630	7,600	1,670	55	30.5	30.5	2-4
27BH	32' 3"	8' 0"	11' 0"	6' 6"	6,490	840	8,200	1,710	55	38	38	8-10
27MK	33' 2"	8' 0"	10' 11"	6' 6"	6,925	705	8,850	1,925	55	71*	30.5	4-6
28RB	33' 1"	8' 0"	10' 11"	6' 6"	6,510	745	8,400	1,890	55	76*	38	4-6
29BHB	34' 0"	8' 0"	10' 11"	6' 6"	6,820	615	8,500	1,680	55	68.5*	30.5	8-10
29QBH	36' 1"	8' 0"	10' 11"	6' 6"	7,295	750	8,995	1,700	55	61*	30.5	8-10
30RKB	35' 10"	8' 0"	10' 10"	6' 6"	7,265	985	8,995	1,730	55	61*	30.5	2-4
32QBH	37' 8"	8' 0"	11' 0"	6' 6"	7,855	1,015	9,800	1,945	55	57	30.5	8-10
32RL	35' 6"	8' 0"	11' 1"	6' 6"	7,400	930	9,300	1,900	55	71*	30.5	4-6

Some specs at the time of print may include estimates. For the most updated information, please visit Jayco.com

# STANDARDS & OPTIONS

## EXTERIOR

5 in. fresh water drain valve  
2 in. Stronghold VBL™ floor with 2 lb. density foam  
Aerodynamic, rounded front profile with aluminum framing  
American-made Norco® Z-frame with integrated A-frame  
Battery quick-disconnect  
Dark-tinted safety-glass windows  
Exterior TV 120V receptacle and cable hook-ups  
Front diamond plating  
Galvanized steel and impact-resistant wheel wells  
Magnum Truss™ roof system  
Outdoor camp kitchen with galvanized steel bases (select models)  
PVC roofing membrane (limited lifetime warranty)  
Swing-out entry door assist handle

## INTERIOR

4 in. high-density dinette cushions with vinyl backing  
4 in. soft-touch bunk mats (select models)  
75 lb. full-extension drawer guides  
Decorative kitchen backsplash  
Bathroom skylight  
Directional and closeable A/C vents  
Gas-strutted under-bed storage (most models)  
Handcrafted hardwood door and drawer fronts  
High-output, auto-ignition LP gas furnace  
LED lighting throughout  
Plywood dinette, bed, bunk, and shower/tub bases  
Powered roof vent in bathroom  
Seamless countertops throughout  
Residential vinyl flooring throughout  
Screwed-and-glued cabinet stiles  
USB charging ports (multiple locations throughout)  
Interior speakers

## CUSTOMER VALUE PACKAGE (MANDATORY)

Radial tires with self-adjusting electric brakes  
13,500 BTU roof-mounted Quiet Series A/C  
Vacuum-bonded sidewalls with interior and exterior Azdel® composite panels  
20 lb. LP gas bottles with auto regulator, ABS cover, and fill gauge  
55 gal. freshwater tank  
Automotive-style aluminum rims  
Black tank flush  
Detachable power cord  
Inverter pre-wire outlets  
Max-length power awning with LED light  
On-demand 60K BTU water heater  
Power tongue jack  
Rear 2 in. receiver prep  
Residential cabinetry with large doors and drawers and hidden cabinet hinges  
Rock Solid Stabilizer System (not available with Premier Package)  
Rear back-up camera prep  
Under-mount spare tire  
Roller shades with radiant barrier backer  
Electric fireplace (N/A 21MBH, 21MML, 23RK, 23MBD, 25BH)  
Slide topper prep

## JAY SPORT PACKAGE (MANDATORY)

11 cu. ft. 12V refrigerator  
App-monitored TPMS  
Climate Shield™ zero to 100 degree tested weather insulation package  
Front slam-latch baggage doors  
InVision™ kitchen appliance package  
Solid fold-down step with aluminum tread on main entry door step  
LED Smart TV  
Modern graphics package

Porcelain foot-flush toilet  
Overlander I Solar Package: (1) 200W solar panel and 30-amp digital controller  
Stainless steel double-basin kitchen sink  
Keyed-Alike™ doors  
Rear exterior ladder  
Dark-tinted privacy windows

## PREMIER PACKAGE

Molded front cap  
Power 5-point stabilization system  
Solid surface countertops  
Multi-function "All in One" stainless steel kitchen sink  
Dual MaxxAir® vent fan in bathroom and living room  
Premier graphic legend

## OPTIONS

Overlander II Solar Package: (2) 200W panels, 30-amp digital controller and 1800W inverter  
JAYCOMMAND™ Smart RV System with TPMS  
15K BTU Quiet Series A/C IPO 13.5K BTU  
Second 13,500 BTU Quiet Series Direct Dump A/C  
50-amp service with second and third A/C prep (select models)  
30 lb. LP gas bottles with auto regulator, ABS cover, and fill gauge  
120V heated tank pads  
Front molded cap (mandatory on 26FK, 24FK, and 30RKB)  
Goodyear® tires  
2 in. rear receiver  
Theater seating  
Freestanding table and four chairs (select models)  
Furniture cup holder tables (1 pair)  
72 x 80 in. king bed (select models)

Meet your Jayco Dealer



Scan QR code for specification definitions



Some specs at the time of print may include estimates. For the most updated information, please visit [Jayco.com](http://Jayco.com)

Jayco, Inc. | P.O. Box 460 | Middlebury, IN 46540

See dealer for further information and prices. All information in this brochure and on [www.jayco.com](http://www.jayco.com) is the latest available at the time of publication approval. Jayco reserves the right to make changes and to discontinue models without notice or obligation. Photography may show optional equipment or props used for decoration purposes only. RVs built for sale in Canada may differ to conform to Canadian codes. JAYCO and the JAYCO BIRD IN FLIGHT are registered trademarks of Jayco, Inc. Printed in USA 10/25 ©2025 Jayco, Inc. 2033102

Jayco - Part of Jayco Family of Companies