

Jayco | Jay Feather Travel Trailer

JAY FEATHER

ADVENTURE IS CALLING



2+3
YEAR | YEAR
WARRANTY

INTERIOR DESIGN



VINTAGE WASHED GREY



Wood



Floor

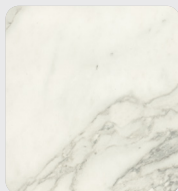

Countertop

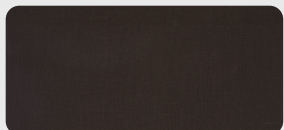

Main Fabric

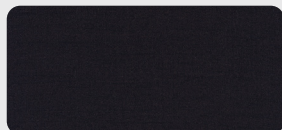

Accent Fabric

MODERN FARMHOUSE

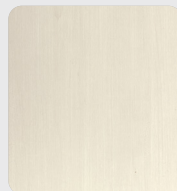

Wood



Floor

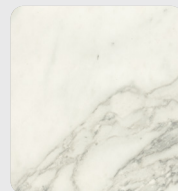

Countertop

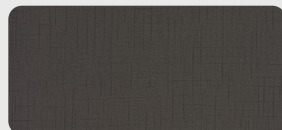

Main Fabric

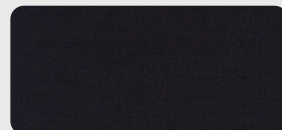

Accent Fabric

19MRK

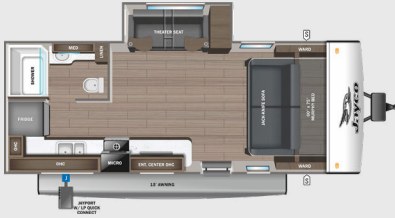

21MML



22BH



22RB

OPTIONS: B

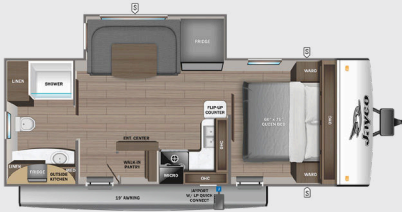

24BH

OPTIONS: B



24RL

OPTIONS: A, B



25RB

OPTIONS: A, B



26RL

OPTION: A



27BHB

OPTIONS: A, B



30QB

OPTIONS: B

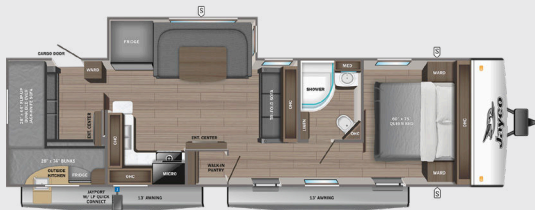

STORAGE
MICRO
OHC
FRIDGE
WARD

STORAGE
MICROWAVE
OVERHEAD CABINETS
REFRIGERATOR
WARDROBE

OPTIONS

A



Tri-Fold Sofa

B



Theater Seat

STANDARDS & OPTIONS

EXTERIOR

Aerodynamic, rounded front profile with diamond plate
Modern retro graphics package with two-colored sidewall
Stronghold VBL™ vacuum-bonded, laminated side and rear walls (including slideout room walls)
Azdel laminated interior and exterior walls
2 in. vacuum-bonded floor with 2 lb. foam insulation
Keyed-Alike™ lock system
Magnum Truss™ Roof System with one-piece seamless roof material
American-made I-beam frame with integrated A-frame
Dual axles
G20 tinted safety-glass windows
Marine-grade exterior speakers with blue LED accent lighting (2)
Galvanized steel and impact-resistant wheel wells
30-amp service
Outside grill propane quick-connect port
Outside camp kitchen (standard on select models)
Battery quick disconnect
Slide topper prep (select models with slide rooms)
Exterior TV bracket with 120V electric and cable outlets
Front molded fiberglass cap (select models)

INTERIOR

Choice of two interior design packages- Modern
Farmhouse or Vintage Washed Grey
LED lighting throughout
Smoked glass decorative inserts (select overhead cabinets)
Screwed and glued cabinetry
Residential vinyl flooring with cold crack resistance
Plywood dinette, bunk and bed bases (applicable models)
Ball-bearing drawer guides with 75 lb. capacity
8 cu. ft. 12V refrigerator with black glass door inserts

Residential oven with 3-burner recessed cooktop and glass cover
Residential-style kitchen countertops
Microwave
Decorative backsplash
4 in. high-density dinette cushions with vinyl backing
Jayco exclusive Teddy Bear "soft-touch" residential-style bed mats (select models)
120V outlet and cargo net in fixed bunks
Plastic foot flush toilet
Bath skylight and roof vent
Decorative roller shades with reflective backer

CUSTOMER VALUE PACKAGE (MANDATORY)

American-made nitro-filled Goodyear® radial tires with self-adjusting electric brakes
Aluminum rims
20 lb. propane bottles with auto regulator (2)
15,000 BTU A/C
Spare tire
Detachable power cord
Power awning with LED lights
Black tank flush
Outside shower
Power tongue jack
Rock Solid Stabilizer System
On-demand tankless water heater
55 gal. fresh water tank
AM/FM/Bluetooth® stereo
Side-marker camera prep
Rear camera backup prep
Inverter pre-wire (2 bedroom nightstand outlets, main TV and outside kitchen refrigerator (select models))

SPORT PACKAGE (MANDATORY)

LCI Solid Step® fold-down aluminum tread entry steps
Enhanced graphics package
Roof-mount solar prep
Glacier Package includes enclosed underbelly
32 in. or 39 in. LED Smart TV
Drying rack/sink cover
MAXXAIR® roof vent (main living area)

OPTIONS

120V heated tank pads
50-amp service with 2nd A/C prep (select models)
30 lb. propane bottles with auto regulator (2) (select models)
6 cu. ft. gas/electric refrigerator with black glass door inserts
JAYCOMMAND® "Smart RV" system (includes TPMS)
Tri-fold sofa (select models)
Theater seating with table trays (select models)
Overlander 1 Solar Package: (1) 200W solar panel and 30-amp digital controller
Overlander 2 Solar Package: (2) 200W solar panels, 30-amp digital controller and 1800W inverter
Outside griddle for JayPort system (standard on models with an outside kitchen)

*Indicates split tanks

FLOORPLAN	TOTAL EXTERIOR LENGTH	EXTERIOR WIDTH	EXTERIOR HEIGHT (WITH A/C)	INTERIOR HEIGHT	UNLOADED VEHICLE WEIGHT	DRY HITCH WEIGHT	GVWR	CARGO CARRYING CAPACITY	FRESH WATER CAPACITY	GRAY WASTE WATER CAPACITY	BLACK WASTE WATER CAPACITY	SLEEPING CAPACITY
19MRK	24' 0"	8' 0"	10' 9"	6' 6"	4,795	500	6,250	1,455	55	30.5	30.5	2
21MML	26' 0"	8' 0"	10' 9"	6' 6"	5,185	585	6,500	1,315	55	30.5	30.5	4-6
22BH	28' 10"	8' 0"	10' 8"	6' 6"	5,565	610	7,500	1,395	55	61*	30.5	6-7
22RB	27' 9"	8' 0"	10' 9"	6' 6"	5,600	680	6,750	1,150	55	61*	22.5	2-3
24BH	30' 2"	8' 0"	10' 9"	6' 6"	6,115	740	7,500	1,385	55	61*	30.5	7-8
24RL	28' 7"	8' 0"	10' 9"	6' 6"	5,325	660	6,600	1,275	55	30.5	30.5	4-6
25RB	30' 8"	8' 0"	10' 9"	6' 6"	5,815	710	7,250	1,435	55	61*	22.5	4-6
26RL	31' 11"	8' 0"	10' 8"	6' 6"	6,115	690	7,500	1,385	55	30.5	30.5	2-4
27BHB	33' 2"	8' 0"	10' 9"	6' 6"	6,085	745	7,600	1,515	55	61*	30.5	8-9
30QB	36' 11"	8' 0"	10' 10"	6' 6"	7,265	840	8,500	1,235	55	30.5	30.5	7-10

Meet your Jayco Dealer



Scan QR code for specification definitions

Some specs at the time of print may include estimates. For the most updated information, please visit Jayco.com

Jayco, Inc. | P.O. Box 460 | Middlebury, IN 46540

See dealer for further information and prices. All information in this brochure and on www.jayco.com is the latest available at the time of publication approval. Jayco reserves the right to make changes and to discontinue models without notice or obligation. Photography may show optional equipment or props used for decoration purposes only. RVs built for sale in Canada may differ to conform to Canadian codes. JAYCO and the JAYCO BIRD IN FLIGHT are registered trademarks of Jayco, Inc. Printed in USA 1/23 ©2022 Jayco, Inc. 2032591.2023

Jayco - Part of Jayco Family of Companies

