



Jay Flight SLX



Serial #: 1UJBC0AJ0S1Y40266
 Model: 170FQ JAY FLIGHT SLX TT

Model Year: 2025 Dealer Name: CAMPERLAND OF OKLAHOMA LLC
 8347 EAST 11TH STREET
 TULSA, OK 74112
 USA

Manufacturer's Suggested Retail Price \$23,086.00

TOTAL AMOUNT DOES NOT INCLUDE STATE AND LOCAL TAXES OR LICENSE FEES. THE PRICE SHOWN ABOVE MAY OR MAY NOT BE REPRESENTATIVE OF THE ACTUAL SELLING PRICE OF SIMILAR RECREATIONAL VEHICLES IN YOUR AREA.

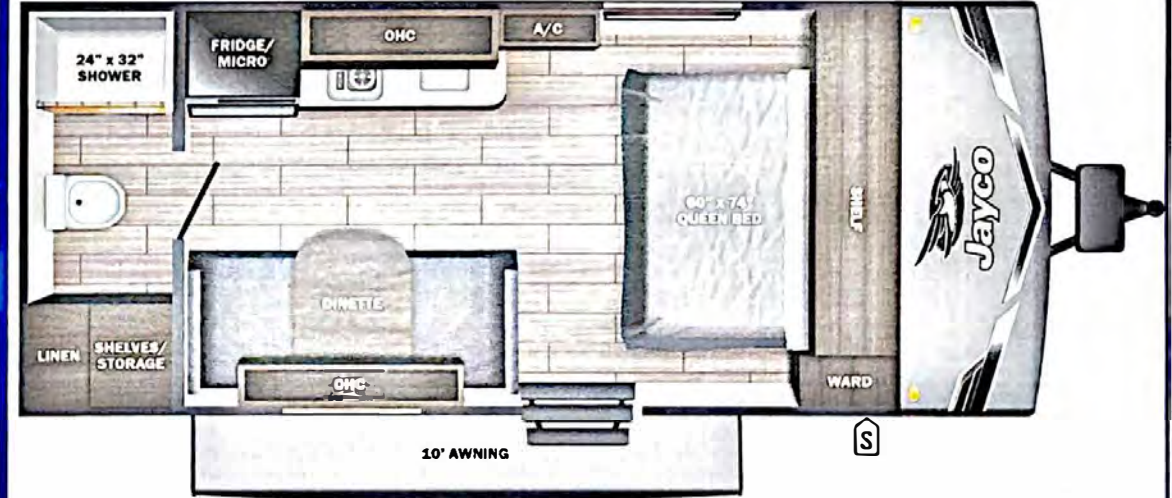

UVW 3175 lbs **Sleeps** **Length** 21' 4.63"

DIMENSIONS

Exterior height:.....122.00"
 Exterior width:.....96.00"

WEIGHTS

GVWR:.....3850
 GAWR (front):.....3700
 GAWR (rear):.....0
 Approx. Gross Cargo Carrying Capacity (GCCC):.....675

CAPACITIES

Fresh water tank (gals.):...30.00
 Gray water tank (gals.):...19.90
 Black water/toilet tank (gals.):...19.90
 Propane (lbs.):.....20
 Propane (gals.):.....4
 Water heater (gals.):.....0.25

SEATING & SLEEPING

TIRES

Tire size (front):.....ST205/75R14D
 Tire size (mid):.....
 Tire size (rear):.....
 Tire size (spare):.....ST205/75R14D

Standard Equipment

THE FOLLOWING ITEMS ARE STANDARD ON THIS MODEL

STANDARD EXTERIOR EQUIPMENT

- 30-amp service
- 8,000 BTU wall mount A/C (single axle models)
- Axles with electric, self-adjusting brakes and easy-lube hubs
- Exterior cable TV hookup
- Fully-integrated A-frame
- Galvanized-steel, impact resistant wheel wells
- Large exterior downspouts
- LP quick connect (outside grill prep)
- Magnum Truss™ Roof System
- Nitrogen filled radial tires
- PVC roofing membrane (limited lifetime warranty)

STANDARD INTERIOR EQUIPMENT

- 300 lb. rated single bunk beds
- 600 lb. rated double bunk beds
- Digital TV antenna
- Heavy-duty, 75 lb., full-extension, steel ball-bearing drawer guides
- High rise kitchen faucet
- Marine-grade toilet with foot flush
- Plywood bed platforms
- Queen mattress
- Residential-style hidden cabinet door hinges
- Residential-style kitchen countertops
- Shower curtain with curved shower track (select models)
- Solid hardwood cabinet doors with screwed stile construction and hidden hinges
- Vinyl flooring throughout
- Wood-trimmed mirror in bathroom

CUSTOMER VALUE PACKAGE SPORT EDITION

- 3.3 cu. ft. 12V refrigerator
- 19,000 BTU furnace
- 2 burner stove top
- Bathroom vent
- Detachable power cord
- Entry door with window and shade prep
- G20 dark tinted privacy windows
- LED interior and exterior lights
- LED interior and exterior lights
- Microwave oven
- Stabilizer jacks
- Window shades
- Power Awning
- Front Tongue Jack
- Rear bumper
- 20# LP bottle
- On-demand tankless water heater

Optional Equipment

OPTIONAL EQUIPMENT INSTALLED ON THIS VEHICLE BY MANUFACTURER

| | |
|--------------------------------------|-----------|
| Base price | 17,243.00 |
| USA STANDARDS | n/c |
| CUSTOMER VALUE PACKAGE SPORT EDITION | 5,250.00 |
| 13,500 BTU ROOF MOUNTED AC | 593.00 |

UNIT TOTAL 23,086.00

DEALER INSTALLED OPTIONS

25-22664N

Some dimensions may be rounded and may vary from the actual dimensions
 Weights may be estimated calculations and may vary from the actual weight - refer to the vehicle weight labels for actual weights
 Floorplans, features and specifications are subject to change without notice.

