



# Jay Flight SLX



Serial #: 1UJBC0AJ3S1Y50886  
 Model: 170BH JAY FLIGHT SLX TT

Model Year: 2025 Dealer Name: CAMPERLAND OF OKLAHOMA LLC  
 8347 EAST 11TH STREET  
 TULSA, OK 74112  
 USA

**Manufacturer's Suggested Retail Price \$22,493.00**

TOTAL AMOUNT DOES NOT INCLUDE STATE AND LOCAL TAXES OR LICENSE FEES. THE PRICE SHOWN ABOVE MAY OR MAY NOT BE REPRESENTATIVE OF THE ACTUAL SELLING PRICE OF SIMILAR RECREATIONAL VEHICLES IN YOUR AREA.

## Standard Equipment

THE FOLLOWING ITEMS ARE STANDARD ON THIS MODEL

## Optional Equipment

OPTIONAL EQUIPMENT INSTALLED ON THIS VEHICLE BY MANUFACTURER

### STANDARD EXTERIOR EQUIPMENT

- 30-amp service
- 8,000 BTU wall mount A/C (single axle models)
- Axles with electric, self-adjusting brakes and easy-kabe hubs
- Exterior cable TV hookup
- Fully-integrated A-frame
- Galvanized-steel, impact resistant wheel wells
- Large exterior downspouts
- LP quick connect (outside grill prep)
- Magnum Truss™ Roof System
- Nitrogen filled radial tires
- PVC roofing membrane (limited lifetime warranty)

### STANDARD INTERIOR EQUIPMENT

- 300 lb. rated single bunk beds
- 600 lb. rated double bunk beds
- Digital TV antenna
- Heavy-duty, 75 lb., full-extension, steel ball-bearing drawer guides
- High rise kitchen faucet
- Manne-grade toilet with foot flush
- Plywood bed platforms
- Queen mattress
- Residential-style hidden cabinet door hinges
- Residential-style kitchen countertops
- Shower curtain with curved shower track (select models)
- Solid hardwood cabinet doors with screwed stile construction and hidden hinges
- Vinyl flooring throughout
- Wood-trimmed mirror in bathroom

### CUSTOMER VALUE PACKAGE SPORT EDITION

- 3.3 cu. ft. 12V refrigerator
- 19,000 BTU furnace
- 2 burner stove top
- Bathroom vent
- Detachable power cord
- Entry door with window and shade prep
- G20 dark tinted privacy windows
- LED interior and exterior lights
- LED interior and exterior lights
- Microwave oven
- Stabilizer jacks
- Window shades
- Power Awning
- Front Tongue Jack
- Rear bumper
- 20# LP bottle
- On-demand tankless water heater

Base price	17,243.00
USA STANDARDS	n/c
CUSTOMER VALUE PACKAGE	
SPORT EDITION	5,250.00
8,000 BTU WALL MOUNT AC	n/c

UNIT TOTAL **22,493.00**

DEALER INSTALLED OPTIONS

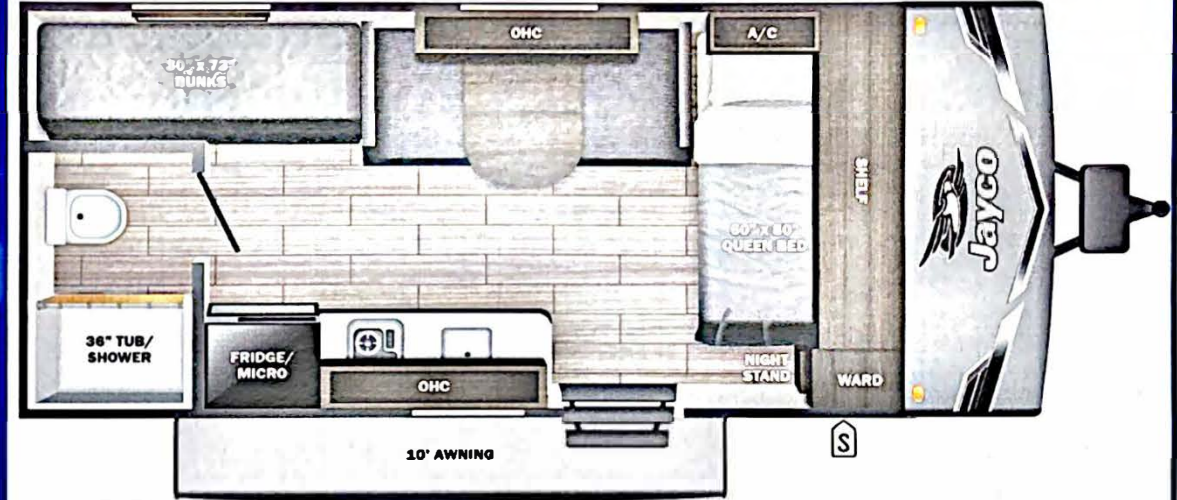

**UVW**  
 3050 lbs

**Sleeps**  
 4

**Length**  
 21' 2.63"

### DIMENSIONS

Exterior height:.....123.00"  
 Exterior width:.....96.00"

### WEIGHTS

GVWR:.....3750  
 GAWR (front):.....3700  
 GAWR (rear):.....0  
 Approx. Gross Cargo Carrying Capacity (GCCC):.....700

### TIRES

Tire size (front):.....ST205/75R14D  
 Tire size (mid):.....  
 Tire size (rear):.....  
 Tire size (spare):.....ST205/75R14D

### CAPACITIES

Fresh water tank (gals.):...30.00  
 Gray water tank (gals.):...19.90  
 Black water/toilet tank (gals.):...19.90  
 Propane (lbs.):.....20  
 Propane (gals.):.....4  
 Water heater (gals.):.....0.25

### SEATING & SLEEPING

\*\*\*Some dimensions may be rounded and may vary from the actual dimensions\*\*\*  
 \*\*\*Weights may be estimated calculations and may vary from the actual weight - refer to the vehicle weight labels for actual weights\*\*\*  
 Floorplans, features and specifications are subject to change without notice.



25-22662N