



Seismic



Serial #: 1UJCGSCV6S18L0068
 Model: 395 SEISMIC FW

Model Year: 2025 Dealer Name: CAMPERLAND OF OKLAHOMA LLC
 8347 EAST 11TH STREET
 TULSA, OK 74112
 USA

Manufacturer's Suggested Retail Price \$132,333.00

TOTAL AMOUNT DOES NOT INCLUDE STATE AND LOCAL TAXES OR LICENSE FEES. THE PRICE SHOWN ABOVE MAY OR MAY NOT BE REPRESENTATIVE OF THE ACTUAL SELLING PRICE OF SIMILAR RECREATIONAL VEHICLES IN YOUR AREA.

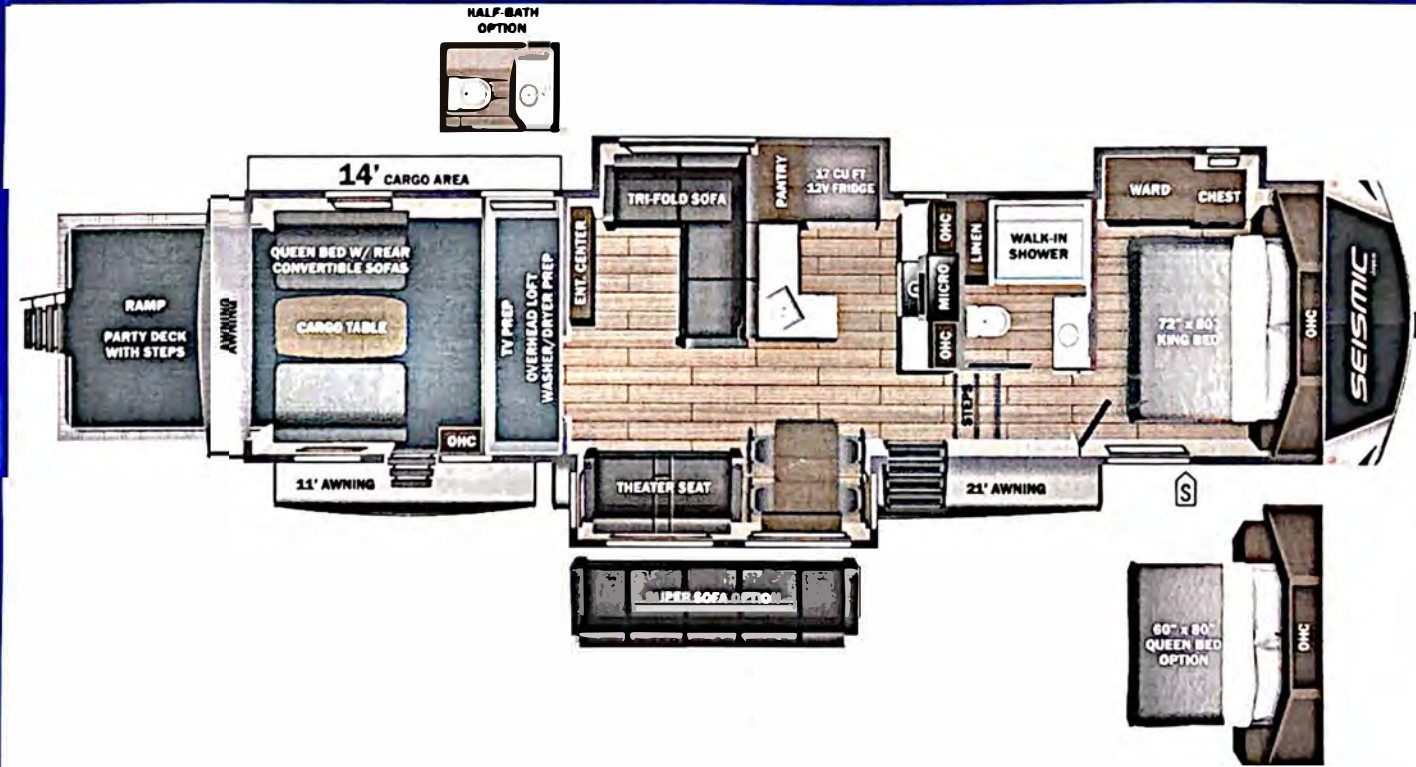

Standard Equipment

Optional Equipment

THE FOLLOWING ITEMS ARE STANDARD ON THIS MODEL AT NO EXTRA CHARGE

OPTIONAL EQUIPMENT INSTALLED ON THIS VEHICLE BY MANUFACTURER

- STANDARD EXTERIOR EQUIPMENT**
- 102 in. wide body structural steel I-beam construction
 - NPS - Powered by Yamaha 6,000 watt generator with built in pure sine inverter, gas/C.A.R.B certified
 - 6-point hydraulic auto-leveling system
 - Battery disconnect switch
 - Climate Shield™ zero-degree tested weather protection.
 - *PEX plumbing
 - *35,000 BTU output furnace
 - *Double layer fiberglass batt insulation in ceiling and floor
 - *Double sided radiant barrier insulation (roof and floor)
 - *Fully enclosed and heated underbelly (ducted)
 - Custom automotive-grade vinyl exterior graphics package
 - Detachable shore power cord
 - Digital TV antenna
 - Dual 30 lb. propane bottles with auto regulator
 - Exterior marine-grade speakers
 - Folding roof ladder
 - Fully enclosed, LED-lighted universal docking center:
 - *Black tank flush, winterization and sanitation
 - *Quick-connect outside shower
 - *Satellite prep
 - HELIX Cooling System™ (industry exclusive):
 - *Directional and closeable A/C vents
 - *Jayco-exclusive insulated dual duct design
 - *Two exterior-mounted 15,000 BTU ducted A/Cs (living room and bedroom)
 - JaySMART™ (Safety Markers And Reverse Travel)
 - LED lighting (patented)
 - LED exterior lighting package
 - LP quick-connect
 - Magnum Truss™ Roof System (strongest tested roof in the industry) with Alpha roof membrane system with limited lifetime warranty
 - Painted fiberglass front cap with clear coat and built-in specialty LED lighting
 - Pass-through storage with Slam-latch™ baggage doors
 - Stronghold VBL™ aluminum framed and vacuum bond laminated gel coated fiberglass exterior walls and slide room end walls
 - Under-mounted spare tire
 - Water heater bypass
- RAMP AND CARGO EQUIPMENT**
- 30 gal. fuel tank with timer
 - Garage D-rings mounted to steel frame
 - HappiJac® electric-lift queen beds/convertible sofas with folding armrests and cup holders
 - LED high-intensity ramp lights
 - Ram air vents and power roof vent
 - Ramp patio kit with exterior steps
 - Rear electric patio awning
 - Rear ramp door and patio with anti-slip, non-skid flooring
 - Three seasons removable garage wall/doors
 - Tuff-ply, rubberized garage floor liner
 - 15,000 AC Drop In Garage

- STANDARD INTERIOR EQUIPMENT**
- 12V charging station
 - 5/8 in. tongue-and-groove joined plywood main floor decking and 3/8 in. tongue-and-groove plywood in the roof
 - Bathroom skylight
 - Carbon monoxide and LP detector
 - Central command center with built-in tank monitoring
 - Custom interior design - Vintage Farmhouse
 - Gas-strutted under-bed storage
 - Handcrafted and glazed doors, drawers and trim
 - Hardwood safety handrail on hallway steps
 - Heavy-duty, 75 lb., full-extension, steel ball-bearing drawer guides
 - Inverter pre-wire
 - LED fireplace with electric space heater (select models)
 - LED interior lighting throughout
 - No in floor heat registers throughout the coach
 - Porcelain foot flush toilet
 - Residential "Do it all" sink with pull-out kitchen faucet, glass rinse and vegetable rinse
 - Residential finished dove tail jointed drawers throughout
 - Residential NuVo H2O whole coach water treatment system with water softening and triple cartridge filters
 - Residential quilted bedspread
 - Residential stainless steel kitchen sink with hi rise pull out faucet
 - Residential vinyl flooring (made in the USA)
 - Solid hardwood cabinet doors
 - Stain protected fabric on all furniture
 - SuperSofa with heat, massage and LED lighting (select models)
 - Vinyl flooring in slideouts (no carpet)
 - Washer/dryer prep
 - Super Lounge ILO Theater Seat and Dinette (18L)
 - Garage Half Bath (18L, 18M)
- CUSTOMER VALUE PACKAGE (MANDATORY)**
- 16 gal. gas/electric DSI water heater
 - 17 cu. ft. 12V refrigerator
 - 2nd electric awning
 - 30" Space saver microwave
 - 4K Smart LED HDTV with fully digital HDMI® output
 - 50-amp service and 3rd A/C prep
 - AM/FM/CD/DVD/Bluetooth® stereo with 4 speakers
 - Bathroom power vent
 - Custom machined aluminum rims
 - Electric awning with RGB LED lights
 - Hidden hinges and magnet door catches on cabinet doors
 - Keyed-Alike™ lock system
 - MORryde® strut-assisted fold-away entrance steps (main entrance)
 - Night shades
 - Residential 21" oven with three burners
 - Bedroom slide with under bed-storage
 - Rooftop and ground solar prep
- 4 STAR HANDLING PACKAGE (MANDATORY)**
- 17.5 in. 16 ply "H" rated Uniroyal tires
 - Dexter® Axles with ABS and Tow Assist - includes Nev-R-Adjust® brakes and E-Z Lube® hubs
 - Rota-flex lung pin
 - Wet bolt fasteners, bronze bushings and 4,000 lb. leaf springs

Base price	116,918.00
USA STANDARDS	n/c
CUSTOMER VALUE PACKAGE	7,500.00
FOUR STAR HANDLING PACKAGE	3,743.00
OVERLANDER II SOLAR PACKAGE	1,943.00
15,000 AC DROP IN CARGO	893.00
TINTED SAFETY GLASS	n/c
WINDOWS	n/c
OUTSIDE GRIDDLE FOR JAYPORT SYSTEM	443.00
THEATER SEAT & DINETTE	n/c
KING BED	n/c
HALF BATH	893.00

UNIT TOTAL **132,333.00**

DEALER INSTALLED OPTIONS

UVW 15738 lbs **Sleeps** **Length** 45' 7"

DIMENSIONS		CAPACITIES	
Exterior height:	158.88"	Fresh water tank (gals.):	106.10
Exterior width:	102.00"	Gray water tank (gals.):	87.00
WEIGHTS		Black water/toilet tank (gals.):	87.00
GVWR:	20400	Propane (lbs.):	60
GAWR (front):	7000	Propane (gals.):	14
GAWR (rear):	7000	Water heater (gals.):	16.00
Approx. Gross Cargo Carrying Capacity (GCCC):	4662	SEATING & SLEEPING	
TIRES			
Tire size (front):	215/75R17.5H		
Tire size (mid):	215/75R17.5H		
Tire size (rear):	215/75R17.5H		
Tire size (spare):	215/75R17.5J		

Some dimensions may be rounded and may vary from the actual dimensions
 Weights may be estimated calculations and may vary from the actual weight - refer to the vehicle weight labels for actual weights
 Floorplans, features and specifications are subject to change without notice.



25-22411N