



# Eagle HT



Serial #: 1UJCA0BRXR1BE0391  
 Model: 29RLC EAGLE HT FW

Model Year: 2024 Dealer Name: CAMPERLAND OF OKLAHOMA-SAPULPA  
 9889 STATE HWY 66  
 SAPULPA, OK 74066  
 USA

**Manufacturer's Suggested Retail Price \$77,041.00**

TOTAL AMOUNT DOES NOT INCLUDE STATE AND LOCAL TAXES OR LICENSE FEES. THE PRICE SHOWN ABOVE MAY OR MAY NOT BE REPRESENTATIVE OF THE ACTUAL SELLING PRICE OF SIMILAR RECREATIONAL VEHICLES IN YOUR AREA.

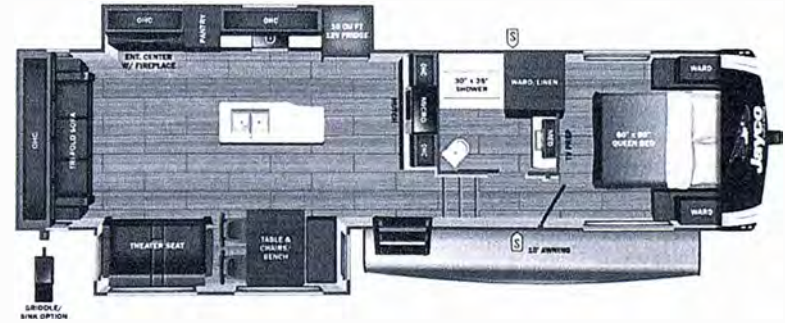

## Standard Equipment

## Optional Equipment

THE FOLLOWING ITEMS ARE STANDARD ON THIS MODEL AT NO EXTRA CHARGE

OPTIONAL EQUIPMENT INSTALLED ON THIS VEHICLE BY MANUFACTURER

**EXTERIOR**

- Stronghold VBL™ walls (laminated sidewalls, rear walls and slide out walls)
- 5 in. Magnum Truss™ Roof System with Alpha roof membrane system with limited lifetime warranty
- Climate Shield™ zero-degree tested weather protection
- Fully enclosed and heated underbelly (ducted)
- 35,000 BTU furnace
- Double layer fiberglass batt insulation in ceiling and floor
- Double sided radiant barrier insulation (roof, floor, and behind cap)
- PEX plumbing
- HELIX Cooling System™ (industry exclusive)
- Jayco exclusive insulated dual duct design
- Directional and closable A/C vents
- Larger return air vents with user accessible filters
- Automotive style painted front cap with max turn radius
- Auto-grade vinyl graphics
- LED exterior lighting package
- 50 amp detachable power cord
- Dual 30 lb LP bottles
- Metal slam latch baggage doors
- Digital TV antenna with Wi-Fi prep
- Dual channel exterior speaker
- Nautilus 2.5 water connections
- Quick connect water connections (door side hot/cold and off door side cold only)
- Black tank flush
- Independent satellite and whole coach cable hookups
- Nitrogen filled undermount spare tire (15 in.)
- LP quick connect for gas gndle (next to JayPort)
- Side lopper/awning prep
- 1.5 in. fresh water drain valve
- Commercial grade rubber flooring in pass through area
- Factory installed roof ladder
- Galvanized steel coated outside kitchens

**INTERIOR**

- Solid hardwood slide fascia
- Handcrafted and glazed door/drawer fronts (new sizes)
- 75 lb full extension drawer guides
- 5/8 in. tongue and groove plywood flooring
- Residential vinyl flooring throughout
- Tri-fold hide-a-bed sofa with residential memory foam sleep surface (select models)
- Theater seating (select models)
- Stainless steel kitchen sink
- Matte black kitchen faucet with pull-out sprayer
- USB charging ports (multiple locations throughout)
- Extra 120V power outlets in kitchen and slide rooms (where applicable)
- Gas struted under-bed storage
- Inverter pre-wire (multiple locations)
- C P A P prepped bedroom
- Bathroom skylight
- Porcelain foot flush toilet
- 2 piece high gloss bathroom surround
- Bedroom TV prep

**CUSTOMER VALUE PACKAGE (Mandatory)**

- 15K BTU "Whisper Quiet" A/C and bedroom A/C prep
- 50-amp service with dual A/C ducts
- Electric patio awning with integrated LED lights
- 60K on-demand water heater with mixing tank
- Custom machined aluminum rms
- Rear 2 in. towing receiver with 4 pin connector
- Keyed-Alike™ lock system (single key for all doors/locks)
- Security monitor prep (rear)
- Hidden hinges on cabinet doors
- Upgraded friction hinge entrance door
- 4K Ultra LED HD Smart TV in living room (50 in., 43 in., 39 in.)
- GE black and stainless 17 in. range with edge to edge grates
- GE microwave

|  |           |
|--|-----------|
| Base price                                   | 57,006.00 |
| USA STANDARDS                                | n/c       |
| CUSTOMER VALUE PACKAGE                       | 6,263.00  |
| LUXURY PACKAGE                               | 7,493.00  |
| FOUR STAR HANDLING PACKAGE                   | 3,743.00  |
| OVERLANDER I SOLAR PACKAGE                   | 893.00    |
| 2ND 15,000 AC IN BEDROOM                     | 1,043.00  |
| FIREPLACE                                    | 600.00    |
| FREE STANDING TABLE & CHAIRS WITH BENCH SEAT | n/c       |

**LUXURY PACKAGE (Mandatory)**

- Electric auto-leveling
- GE 10 cu ft 12V refrigerator
- Backout roller shades with reflective side throughout
- Residential style glass shower door
- JayPort 2 in. mount (for outside accessories)
- XL grab handle

**4 STAR HANDLING PACKAGE (Mandatory)**

- Goodyear® Endurance® tires (load range E)
- Dexter® Axles with Nev-R-Adjust® brakes and E-Z Lube® hubs
- MORryde® CRE-3000™ rubberized suspension
- Wet bolt fasteners, bronze bushings

UNIT TOTAL **77,041.00**

DEALER INSTALLED OPTIONS

24 SP710N

**UVW**  
9521 lbs

**Sleeps**

**Length**  
34' 1.25"

### DIMENSIONS

Exterior height: .....158.00"  
 Exterior width: .....96.50"  
**WEIGHTS**  
 GVWR: .....10750  
 GAWR (front): .....5145  
 GAWR (rear): .....5145  
 Approx. Gross Cargo Carrying Capacity (GCCC): .....1229

### CAPACITIES

Fresh water tank (gals.): .....52.00  
 Gray water tank (gals.): .....82.00  
 Black water/toilet tank (gals.): .....45.00  
 Propane (lbs.): .....60  
 Propane (gals.): .....14  
 Water heater (gals.): .....0.25

### SEATING & SLEEPING

### TIRES

Tire size (front): .....ST225/75R15E  
 Tire size (mid): .....  
 Tire size (rear): .....ST225/75R15E  
 Tire size (spare): .....ST225/75R15E

\*\*\*Some dimensions may be rounded and may vary from the actual dimensions\*\*\*  
 \*\*\*Weights may be estimated calculations and may vary from the actual weight - refer to the vehicle weight labels for actual weights\*\*\*  
 Floorplans, features and specifications are subject to change without notice.

