



### Granite Ridge



Serial #: 1UJLJCBK5R1FT4065  
 Model: 22T GRANITE RIDGE MHC  
 VIN#: 1FDRU8PG6PKB62934  
 Model Year: 2024 Dealer Name: CAMPERLAND OF OKLAHOMA LLC  
 8347 EAST 11TH STREET  
 TULSA, OK 74112  
 USA

### Standard Equipment

### Optional Equipment

THE FOLLOWING ITEMS ARE STANDARD ON THIS MODEL AT NO EXTRA CHARGE

OPTIONAL EQUIPMENT INSTALLED ON THIS VEHICLE BY MANUFACTURER

- STANDARD EXTERIOR EQUIPMENT**
- Ford® Transit 350HD AWD chassis
  - 156 in. wheelbase
  - GVWR - 11,000 lb
  - GCWR - 15,000 lb
  - 3.5L EcoBoost V6 310 HP engine with 400 ft-lb torque
  - 10 speed transmission
  - 3.73 limited slip axle
  - 250-amp alternator
  - Matte black aluminum wheels
  - Power anti-lock brakes with power steering
  - (2) 12V AGM chassis batteries (70 amp-hr)
  - 31 gal. fuel tank (gas)
  - TurfShell™ vacuum bond laminated roof, floor and sidewalls
  - Bead-foam insulation (R-24 max roof, R-9 max floor, R-8 max walls)
  - One piece, seamless, fiberglass roof
  - Fiberglass exterior walls with partial paint and vinyl graphics
  - Heated garage with L-track and (2) 120V charging ports
  - Electric patio awning with auto retract and LED lights
  - Roof rack
  - Collapsible exterior ladder
  - Daytime running headlamps
  - Cable TV hookup with RG-6 coax
  - Winegard® Connect 2.0 4G/Wi-Fi/digital TV antenna
  - 2,800W gas generator with auto gen start
  - Portable solar plug
  - 30-amp electrical service with detachable power cord
  - 120V exterior outlet
  - 6 gal. propane tank (20 lb.)
  - LP quick-connect hookup
  - LED lithium holding tank valves
  - Winterization drain system
  - 12V demand water pump
  - Water filtration system
  - Outside shower

- CUSTOMER VALUE PACKAGE**
- JRC® Computer balanced driveshaft, heavy duty rear stabilizer bar, standard front stabilizer bar, Helwig® helper springs and rubber isolation body mounts
  - One piece seamless fiberglass front cap
  - Van Compass™ front and rear lift kit
  - 3 gal. 12V lithium battery
  - 2,000W inverter
  - 360W roof mounted solar panel with dual controller
  - Expandable side port with second dual bank controller for solar
  - All-terrain tires
  - Backup camera
  - Aqua View® SHOWERMISER™ water management system
  - Internal holding tanks

- STANDARD INTERIOR EQUIPMENT**
- 12 in. SYNC 4 HD/NAVI/ACC multi-function display
  - 4-way swivel driver and passenger seats
  - Tilt and telescoping steering wheel
  - Power-adjusting, heated side-view mirrors
  - Intelligent adaptive cruise control
  - Lane-keeping system
  - Forward collision warning
  - Pre-collision assist with automatic emergency braking (AEB)
  - Post-collision braking
  - SOS Post-Crash Alert System™
  - Driver and passenger airbags
  - Safety Canopy® side curtain airbags
  - Ford® AdvanceTrac® with RSC® (roll stability control)
  - Side wind stabilization
  - Hill start assist
  - SecurLock® passive anti-theft system with engine immobilizer
  - Autolocking drive away with crash unlocking
  - Remote keyless entry
  - FordPass™ Connect
  - Tire pressure monitoring system (TPMS)
  - Rain-sensing wiper system
  - Automatic high beam headlights
  - Wiper-activated headlights
  - Power windows and door locks
  - Privacy shades for cab windows
  - Custom-molded ABS cab-over with storage
  - Soft-touch vinyl ceiling
  - High-intensity LED ceiling lights
  - Residential vinyl flooring
  - Factory Multiplex system - wall-mounted touchscreen and mobile app for total coach control
  - 13,500 BTU air conditioner
  - 17,000 BTU Timberline Binar 5D hydronic heating system with LED touchscreen control
  - Cassette screens and night shades
  - JBL® Flip 5 removable wireless Bluetooth speaker
  - Adjustable table with multiple mounts
  - 5.3 cu. ft. 12V refrigerator
  - Induction cooktop
  - Convection microwave
  - Stainless steel sink
  - Pressed counter tops
  - (2) twin-size beds with filler cushion converts to king-size bed
  - All-in-one wet bath with shower and cassette toilet
  - Shower with curtain surround
  - Powered roof vent in wet bath
  - Medicine cabinet with mirror
  - Seatbelts for driver/passenger seats and select cab locations
  - Smoke alarm
  - Carbon monoxide detector
  - Fire extinguisher

- Base price 204,300.00
- OAKLEY n/c
- MOHAVE GRAPHICS PACKAGE n/c
- USA STANDARDS n/c
- CUSTOMER VALUE PACKAGE 20,400.00
- CAB TV 675.00
- NO STARLINK n/c
- OUTDOOR KITCHEN 1,943.00
- NO POPTOP n/c
- PATIO AWNING n/c
- NO REAR AWNING n/c

UNIT TOTAL **227,318.00**

DEALER INSTALLED OPTIONS

### Manufacturer's Suggested Retail Price \$227,318.00

TOTAL AMOUNT DOES NOT INCLUDE STATE AND LOCAL TAXES OR LICENSE FEES. THE PRICE SHOWN MAY VARY FROM THE ACTUAL SELLING PRICE OF SIMILAR RECREATIONAL VEHICLES IN YOUR AREA.

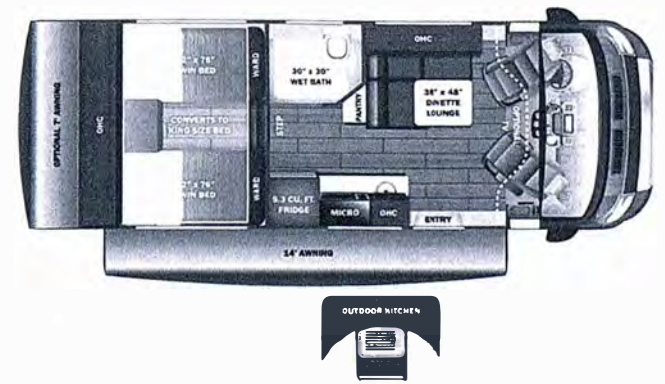

### DIMENSIONS

- Exterior height: 113.00"
- Exterior width: 85.00"
- Tire size (front): 205/75R16C
- Tire size (mid): 205/75R16C
- Tire size (rear): 205/75R16C

### CAPACITIES

- Fresh water tank (gals.): 53.00
- Gray water tank (gals.): 51.00
- Black water/toilet tank (gals.): 4.75
- Propane (lbs.): 20
- Propane (gals.): 4
- Water heater (gals.): 0.00

### TIRES

\*\*\*Some dimensions may be rounded and may vary from the actual dimensions\*\*\*  
 \*\*\*Weights may be estimated calculations and may vary from the actual weight - refer to the vehicle weight labels for actual weights\*\*\*  
 Floorplans, features and specifications are subject to change without notice.



24-22161N