



Terrain



Serial #: 1UJPBBH0P1SY4101
 Model: 19Y TERRAIN MHB
 VIN#: W1W4EBVY8NT093860
 Model Year: 2023 Dealer Name: CAMPERLAND OF OKLAHOMA LLC
 8347 EAST 11TH STREET
 TULSA, OK 74112
 USA

Standard Equipment

Optional Equipment

THE FOLLOWING ITEMS ARE STANDARD ON THIS MODEL
 AT NO EXTRA CHARGE

OPTIONAL EQUIPMENT INSTALLED ON THIS VEHICLE
 BY MANUFACTURER

- STANDARD EXTERIOR EQUIPMENT**
- Mercedes-Benz® Sprinter 2500 4x4 van with 1.14 in wheelbase
 - GVWR- 8,050 lb
 - GVW- 13,000 lb
 - 3.0L V6 engine with 188HP and 325 ft.-lb torque
 - 7 speed automatic transmission
 - 220 amp alternator
 - Daytime running headlamps
 - Power folding/heated side-view mirrors
 - 6,000 lb 10th hitch receiver with 7 pin connector
 - 12V chassis battery
 - 24.6 gal fuel tank (diesel)
 - 8 gal DEF Tank
 - LED hi running boards for cab and entry doors
 - 110V exterior outlet
 - Portable solar plug
 - LED hi holding tank valves
 - Side screen door with magnetic and zipper close off
 - Rear screen door with roll up and black out capabilities
 - Fold-down exterior table
 - On-board air compressor with front and rear chucks
 - 48V - 210 amp hour smart lithium battery providing 10KW hours of power
 - 3,500W inverter
 - 2nd 43V alternator dedicated to lithium battery
 - 30 amp electrical service with detachable power cord
 - 200W of roof-mounted solar panels
 - Slow charge solar panel for chassis battery
 - Utility center with water controls and outside hose
 - City water connection
 - Waterization drain system
 - 12V demand water pump
 - Water filtration system
 - House battery disconnect switch
 - Aqua View® SHOWERMISER™ water management system
 - Heated grey tank (12V pad) with skid plate
 - Interior-mounted fresh water tank
 - Remote keyless entry
- CUSTOMER VALUE PACKAGE**
- JRIIDE® Kon® shocks, heavy duty rear stabilizer bar
 - Carefree® armless patio awning with LED light strip and wind sensor
 - Double roof rack and moveable roof ladder
 - Front and rear wind deflectors with front LED light bar
 - Hydronic heating system with LED touchscreen control
 - 48V Coleman® 10 air conditioner
 - Black aluminum wheels with BFGoodrich® All-Terrain T/A® KO2® tires

- STANDARD INTERIOR EQUIPMENT**
- 10.25 in. MBUX infotainment center
 - Power windows and door locks
 - A/C and adaptive cruise control
 - Active brake assist
 - Heated power swivel driver/passenger seats
 - Rain-sensing wiper system
 - Lane keeping assist
 - Blind spot assist
 - Traffic sign assist
 - Leather wrapped tilt steering wheel with integrated controls
 - Cnb area privacy shade
 - Removable privacy shade for sliding door window
 - Custom-molded, vinyl-wrapped ABS interior wall panels
 - Soft touch vinyl ceiling
 - High-intensity LED ceiling lights
 - Tecnoform® European-style cabinetry
 - Tecnoform® pull out kitchen countertop extension
 - Pantry with Tecnoform® pull out extension
 - Durable rubber flooring
 - JAY COMMAND® powered by Firefly
 - (2) sliding vented windows
 - Rear dual pane acrylic window with cassette shades
 - Maxxair Deluxe roof vent
 - (2) additional cab bucket seats with slide and recline features
- OPTIONAL EQUIPMENT**
- BOSS® dual zone radio with Bluetooth®
 - Collapsible dinette table
 - 3 cu ft DC refrigerator
 - Portable induction cooktop
 - Stainless steel sink
 - 110V/USB outlets throughout
 - Pop-down overhead bed with 750 lb. capacity
 - Fiberglass side pods create larger sleeping surface
 - Rear garage under bed with L-track mounts for securing cargo
 - (2) recessed under-bed storage bags
 - RAM® Tough-Track™ mounts throughout
 - All-in-one wet bath with shower and cassette toilet
 - Removable bamboo shelves in wet bath
 - Powered roof vent in bathroom
 - Retractable clothes line in shower
 - Sealbolts in all sealing locations
 - Driver and passenger airbags
 - Smoke alarm
 - Carbon monoxide detector
 - Fire extinguisher

UNIT TOTAL 231,375.00

DEALER INSTALLED OPTIONS

23-21628N

Manufacturer's Suggested Retail Price \$231,375.00

TOTAL AMOUNT DOES NOT INCLUDE STATE AND LOCAL TAXES OR LICENSE FEES. THE PRICE SHOWN ABOVE MAY OR MAY NOT BE REPRESENTATIVE OF THE ACTUAL SELLING PRICE OF SIMILAR RECREATIONAL VEHICLES IN YOUR AREA.

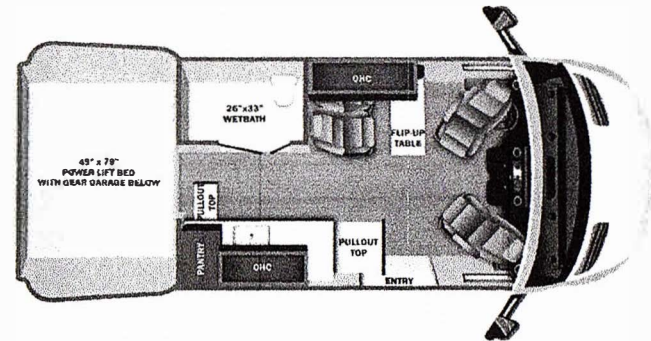

DIMENSIONS

Exterior height:126.00"
 Exterior width:82.50"

CAPACITIES

Fresh water tank (gals.):...22.00
 Gray water tank (gals.):...20.00
 Black water/toilet tank (gals.):4.75
 Propane (lbs.):0
 Water heater (gals.):0.00

TIRES

Tire size (front):LT245/70R17 E
 Tire size (mid):
 Tire size (rear):LT245/70R17 E

Some dimensions may be rounded and may vary from the actual dimensions
 Weights may be estimated calculations and may vary from the actual weight - refer to the vehicle weight labels for actual weights
 Floorplans, features and specifications are subject to change without notice.

2+3
 YEAR | YEAR
 WARRANTY