



Jay Flight SLX



Serial #: 1UJB0BM3N1720089
Model: 240RBS JAY FLIGHT SLX TT

Model Year: 2022 Dealer Name: CAMPERLAND OF OKLAHOMA LLC
8347 EAST 11TH STREET
TULSA, OK 74112
USA

Standard Equipment

THE FOLLOWING ITEMS ARE STANDARD ON THIS MODEL
AT NO EXTRA CHARGE

- EXTERIOR**
- Axles with electric, self-adjusting brakes and easy lube nuts
 - Chromized steel, impact-resistant wheel wells
 - 1/2" 3x5" galvanized structural steel I-beams
 - Fully integrated 4 frame
 - 5/8 in tongue and groove plywood floor decking
 - Magnam Truss™ Roof System with plywood decking
 - Seamless roof material with 20 year warranty
 - Large exterior downspouts
 - 13,500 BTU roof mounted A/C
 - 30-amp service
 - Rooftop air prep
 - 20 lb propane bottles (2) with cover
 - Spine tire with cover
 - Camp kitchen (select models)
 - Backup & side marker camera prep
 - Exterior TV mount & bracket
 - LED exterior lighting
 - Friction tongue entry door with window
 - C20 dark tinted safety glass privacy windows
 - Detachable power cord
 - LP quick connect (outside grill prep)

- CUSTOMER VALUE PACKAGE (MANDATORY)**
- Goodman® Enclosed® tires (made in the USA)
 - Front diamond plate
 - 6 gal gas electric DSI water heater
 - Spine tire with cover
 - Outside shower
 - Power awning with LED lights
 - Marine grade exterior speakers
 - Stabilizer jacks (4)
 - Water heater bypass
 - Keyed Aisle™ entry and baggage doors
 - Large loading entry door grab handle
 - Power tongue jack
 - Black fans, front
 - Window shades
 - 3 burner range with glass cover
 - 6 cu ft gas/electric refrigerator with temperature controls
 - Oven with glass door and interior light
 - Micro-wave oven
 - Range hood
 - Fitted bed sheet
 - Bathroom skylight

Optional Equipment

OPTIONAL EQUIPMENT INSTALLED ON THIS VEHICLE
BY MANUFACTURER

Base price	37,493.00
Classic Cottage	n/c
USA Standards	n/c
Customer Value Package	3,300.00
15,000 BTU AC	188.00
6 Cu. Ft. RV Refrigerator	n/c
Enclosed Underbelly	293.00
Silver Spoke Rims	n/c
Morryde Step Above Steps	143.00
20# LP Gas Bottles	n/c
Theater Seating Sofa	n/c

UNIT TOTAL **41,417.00**

DEALER INSTALLED OPTIONS

Manufacturer's Suggested Retail Price \$41,417.00

TOTAL AMOUNT DOES NOT INCLUDE STATE AND LOCAL TAXES OR LICENSE FEES. THE PRICE SHOWN ABOVE MAY OR MAY NOT BE REPRESENTATIVE OF THE ACTUAL SELLING PRICE OF SIMILAR RECREATIONAL VEHICLES IN YOUR AREA.

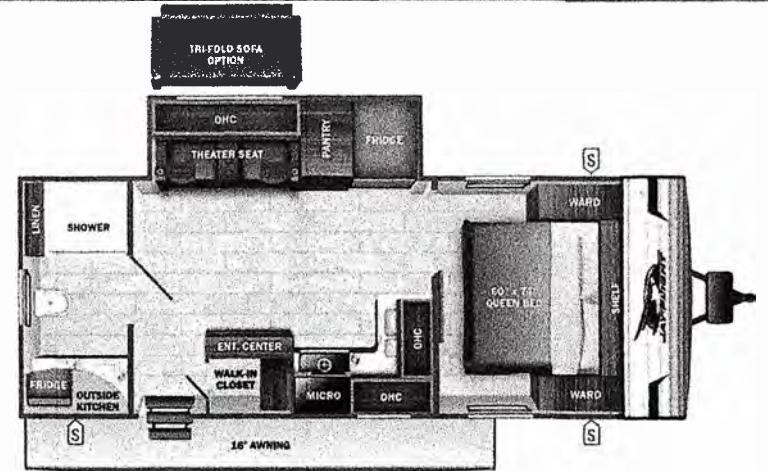

UVW
5626 lbs



Sleeps



Length
27' 3.75"

DIMENSIONS

Exterior height: 131.35"

Exterior width: 95.88"

WEIGHTS

GVMR: 6750

GAWR (front): 4500

GAWR (rear): 3300

Approx. Gross Cargo Carrying Capacity (GCCC): 1124

TIRES

Tire size (front): ST205/75R14D

Tire size (mid): ST205/75R14D

Tire size (rear): ST205/75R14D

Tire size (spare): ST205/75R14D

CAPACITIES

Fresh water tank (gals.): 38.00

Gray water tank (gals.): 7.00

Black water toilet tank (gals.): 39.00

Propane (lbs.): 4.48

Propane (gals.): 1.9

Water heater (gals.): 7.00

SEATING & SLEEPING

2+3
YEAR YEAR
WARRANTY

Some dimensions may be rounded and may vary from the actual dimensions

***Weights may be estimated calculations and may vary from the actual weight

- refer to the vehicle weight labels for actual weights***

Floorplans, features and specifications are subject to change without notice.

22-21498N