



# White Hawk



Serial #: 1UJB0BT6N14C0243  
 Model: 32BH WHITE HAWK TT

Model Year: 2022 Dealer Name: CAMPERLAND OF OKLAHOMA LLC  
 8347 EAST 11TH STREET  
 TULSA, OK 74112  
 USA

## Standard Equipment

## Optional Equipment

THE FOLLOWING ITEMS ARE STANDARD ON THIS MODEL AT NO EXTRA CHARGE

OPTIONAL EQUIPMENT INSTALLED ON THIS VEHICLE BY MANUFACTURER

- EXTERIOR**
- Aerodynamic, rounded front profile with front diamond plate
  - Stronghold VBL™ vacuum-bonded, laminated side and rear walls with Azdel composite (including slideout room walls)
  - Magnium Truss™ Roof System with one-piece seamless roof material with 20 year warranty
  - 5/8 in. tongue-and-groove plywood decked flooring
  - American-made frame with integrated A-frame
  - G20 dark tinted safety-glass windows
  - 30 in. friction-hinged main entry doors (select models)
  - Swing out grab handle
  - Exterior TV bracket with 120V and cable outlets
  - Outdoor camp kitchen with embossed metal countertops (select models)
  - Slam latches on front pass-through storage doors (select models)
  - Marine-grade exterior speakers with blue LED accent lighting (2)
  - Galvanized steel and impact-resistant wheel wells
  - 30-amp service
  - Stabilizer jacks with sump pads (4)
  - Mounted camera bracket for pre-wired side and rear backup prep
  - Keyed-Alike™ lock system
  - Detachable power cord
  - A-frame mounted solar prep
  - Battery quick disconnect
  - Black tank flush
  - ABS propane bottle cover
  - Automotive-style aluminum nuts
  - Spare tire with cover
  - Inverter pre-wire
  - MQRyde® StepAbove™ entrance steps

- LUXURY PACKAGE (MANDATORY)**
- Climalife Shield™ zero-degree tested weather protection
  - Fully enclosed and heated underbelly (ducted)
  - 35,000 BTU output furnace
  - Double layer fiberglass batt insulation in ceiling and floor
  - Double sided radiant barrier insulation (roof, floor, cap, and slide room floors)
  - PEX plumbing
  - Front molded fiberglass cap with automotive-style windshield and blue LED accent lighting
  - Frameless windows
  - Fold-down aluminum tread entry steps (main entry), aluminum tread entry steps (second entry, select models)
  - JAYS MART™ (Safely Markers And Reverse Travel) LED lighting (patent-pending)
  - Roof-mount solar prep
  - Kitchen skylight with shade
  - Power roof vent (main living area)
  - JAYCOMMANDO™ Smart RV™ system with TPMS

- INTERIOR**
- Arched interior ceiling
  - LED lighting throughout
  - Electric fireplace (mandatory)
  - Directional and closable central A/C vents
  - Plywood dinette, bunk and bed bases (applicable models)
  - Decorative wall clock in main living area (select models)
  - Residential vinyl flooring with cold crack resistance
  - High output auto-ignition 35,000 BTU furnace with wall thermostat
  - Front windshield with roller shade with radiant barrier backer
  - Spig hardwood, joined cabinets with screwed and glued lumbercore cabinet sides
  - Drop, splitbow, stainless steel sink with high-rise, pull-out faucet and dry rack/sink cover combo
  - Decorative backsplash
  - Ball-bearing drawer guides with 75 lb capacity
  - Wood panel fridge inserts
  - 60 in. x 80 in. queen bed (60 in. x 75 in. in Murphy bed models)
  - 72 in. x 80 in. king bed (n/a 2BPK)
  - Murphy bed design allowing pass-through exterior storage access (2MBB & 2SMBH)
  - Fixed bunks with 120V outlet and cargo net (bunk models only)

- CUSTOMER VALUE PACKAGE (MANDATORY)**
- American-made niro filled Goodyear® radial tires with self-adjusting brakes (made in the USA)
  - 8 gal. gas/electric DSI water heater
  - 55 gal. fresh water tank
  - 30 lb propane bottles (2)
  - Outside shower
  - Power awning with LED light
  - Power tongue jack
  - Slide topper prep
  - LED TV
  - 14,500 BTU A/C
  - AM/FM/Bluetooth® stereo with speakers
  - 8 cu. ft. gas/electric refrigerator
  - Oven with 3-burner recessed cooktop
  - Microwave
  - Porcelain foot flush toilet
  - Showers with solid enclosures
  - Bathroom skylight

Base price	60,030.00
Modern Farmhouse	n/c
USA Standards	n/c
Customer Value Package	5,250.00
Luxury Package	3,000.00
Solar Power Package Prep	n/c
2nd AC	743.00
50 AMP Service	353.00
Fireplace	338.00
10 Cu. Ft. 12v Refrigerator	293.00
Electric Stabilizer Jacks	638.00
Roof Ladder (Std)(14C)	n/c
Sola	n/c
Dinette	n/c
Queen Bed	n/c

UNIT TOTAL **70,645.00**  
 DEALER INSTALLED OPTIONS

## Manufacturer's Suggested Retail Price \$70,645.00

TOTAL AMOUNT DOES NOT INCLUDE STATE AND LOCAL TAXES OR LICENSE FEES. THE PRICE SHOWN ABOVE MAY OR MAY NOT BE REPRESENTATIVE OF THE ACTUAL SELLING PRICE OF SIMILAR RECREATIONAL VEHICLES IN YOUR AREA.

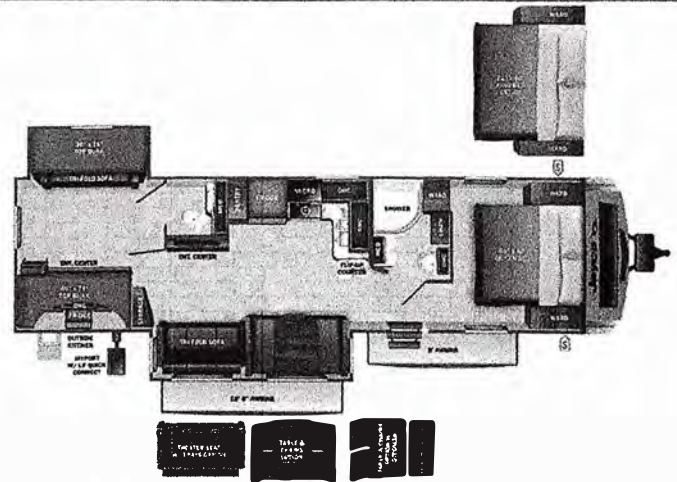

**UVW**  
8425 lbs



**Sleeps**  
8-9



**Length**  
37' 11.63"

### DIMENSIONS

Exterior height: 134.75"  
 Exterior width: 96.00"

### WEIGHTS

GVWR: 9995  
 GAWR (front): 4400  
 GAWR (rear): 4400  
 Approx. Gross Cargo Carrying Capacity (GCCC): 1570

### TIRES

Tire size (front): ST225/75R15E  
 Tire size (mid): ST225/75R15E  
 Tire size (rear): ST225/75R15E  
 Tire size (spare): ST225/75R15E

### CAPACITIES

Fresh water tank (gals.): 55.00  
 Gray water/toilet tank (gal.): 71.00  
 Black water/toilet tank (gal.): 61.00  
 Propane (lbs.): 60  
 Propane (gals.): 14  
 Water heater (gals.): 6.00

### SEATING & SLEEPING

**2+3**  
 YEAR | YEAR  
 WARRANTY

\*\*\*Some dimensions may be rounded and may vary from the actual dimensions\*\*\*  
 \*\*\*Weights may be estimated calculations and may vary from the actual weight - refer to the vehicle weight labels for actual weights\*\*\*  
 Floorplans, features and specifications are subject to change without notice.

22-21436N