



# Jay Flight SLX



Serial #: 1UJBJSBN3N1790115  
 Model: 236TH JAY FLIGHT SLX TT

Model Year: 2022 Dealer Name: CAMPERLAND OF OKLAHOMA LLC  
 8347 EAST 11TH STREET  
 TULSA, OK 74112  
 USA

## Standard Equipment

## Optional Equipment

THE FOLLOWING ITEMS ARE STANDARD ON THIS MODEL  
 AT NO EXTRA CHARGE

OPTIONAL EQUIPMENT INSTALLED ON THIS VEHICLE  
 BY MANUFACTURER

- EXTERIOR**
- Axles with electric, self adjusting brakes and easy lube hubs
  - Galvanized steel, impact-resistant wheel wells
  - I-Class™ cantibered structural steel I-beams
  - Fully-enclosed A-frame
  - 5/8 in. tongue and groove plywood floor decking
  - Magnium Truss™ Roof System with plywood decking
  - Seamless roof material with 20 year warranty
  - Large exterior downspouts
  - 13,500 BTU roof mounted A/C
  - 30 amp service
  - Rooftop solar prep
  - 20 lb propane bottles (2) with cover
  - Spare tire with cover
  - Camp kitchen (select models)
  - Backup & drive marker camera prep
  - Exterior TV mount & bracket
  - LED exterior lighting
  - Friction hinge entry door with window
  - 500 dyk tented safety-glass privacy windows
  - Detachable power cord
  - LP quick connect (outside gnl prep)

- INTERIOR**
- 8'1" in ceiling height
  - Solid hardwood cabinet doors
  - LED interior lighting
  - J-Step™ jackknife sofa w/ walmrest
  - Vinyl flooring throughout (including slide floors)
  - Premium multimedia sound system with MP3/iPod input jacks and Bluetooth® connectivity
  - Digital TV antenna
  - Cable/satellite TV hookup
  - Smoked-glass cabinet door inserts (select models)
  - Residential style kitchen counter tops
  - Heavy-duty, 75lb full extension, steel ball bearing drawer guides
  - Plywood bed platforms
  - Bedroom doors in place of curtains (select models)
  - Queen bed struts
  - Queen mattress
  - Bedroom LED accent lighting
  - 300 lb. rated bunk beds (select models)
  - 600 lb. rated bunk beds (double bunks only)
  - Privacy curtains in bunk areas (select models)
  - 4 in. thick bunk mats (select models)
  - Marine grade (mat with foot flush
  - Tub surround
  - Bathroom exhaust vent
  - Shower curtain with curved shower track (select models)
  - Wood-trimmed mirror in bathroom

- CUSTOMER VALUE PACKAGE (MANUFACTORY)**
- Goodyear® Endurance® tires (made in the USA)
  - Front diamond plate
  - 6 gal gas/electric DSI water heater
  - Spare tire with cover
  - Outside shower
  - Power awning with LED lights
  - Marine grade exterior speaker
  - Sirocco jacks (4)
  - Water heater bypass
  - Kayak-Alike™ entry and baggage doors
  - JaySMART™ Safety Markers And Reverse Travel
  - LED lighting (patent pending)
  - Large folding entry door grab handle
  - Power tongue jack
  - Black tank flush
  - Window shades
  - 3-burner range with glass cover
  - 6 cu. ft. gas/electric refrigerator with temperature controls
  - Oven with glass door and interior light
  - Microwave oven
  - Range hood
  - Fitted bed sheet
  - Bathroom skylight

Base price	32,535.00
Classic Cottage	n/c
USA Standards	n/c
Customer Value Package	3,300.00
Solar Power Package	360.00
15,000 BTU AC	150.00
6 Cu. Ft. RV Refrigerator	n/c
Enclosed Underbelly	225.00
Silver Spoke Firms	n/c
Morryde Step Above Steps	143.00
20# LP Gas Bottles	n/c
Ramp Patio	1,493.00

UNIT TOTAL **38,206.00**

DEALER INSTALLED OPTIONS

22-21416N

Manufacturer's Suggested Retail Price **\$38,206.00**

TOTAL AMOUNT DOES NOT INCLUDE STATE AND LOCAL TAXES OR LICENSE FEES. THE PRICE SHOWN ABOVE MAY OR MAY NOT BE REPRESENTATIVE OF THE ACTUAL SELLING PRICE OF SIMILAR RECREATIONAL VEHICLES IN YOUR AREA.

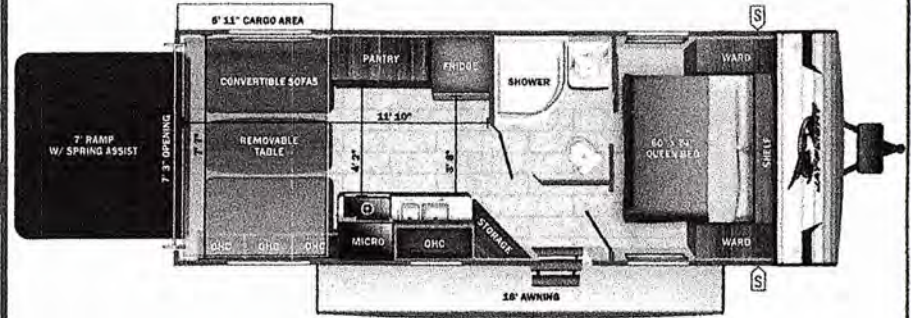

**UVW**  
5090 lbs



**Sleeps**



**Length**  
28' 4.38"

### DIMENSIONS

Exterior height: 127.25'  
 Exterior width: 95.75'

### WEIGHTS

GVWR: 7500  
 GAWR (front): 3500  
 GAWR (rear): 3500  
 Approx. Gross Cargo Carrying Capacity (GCCC): 2410

### TIRES

Tire size (front): ST205/75R14D  
 Tire size (mid):  
 Tire size (rear): ST205/75R14D  
 Tire size (spare): ST205/75R14D

### CAPACITIES

Fresh water tank (gals.): 42.00  
 Gray water tank (gals.): 39.00  
 Black water/toilet tank (gals.): 39.00  
 Propane (lbs.): 40  
 Propane (gals.): 9  
 Water heater (gals.): 6.00

### SEATING & SLEEPING

\*\*\*Some dimensions may be rounded and may vary from the actual dimensions\*\*\*  
 \*\*\*Weights may be estimated calculations and may vary from the actual weight - refer to the vehicle weight labels for actual weights\*\*\*  
 Floorplans, features and specifications are subject to change without notice.

