



Redhawk



Serial #: 1UJLJCBR1N1XF4156
 Model: 31F REDHAWK MHC
 VIN#: 1FDXE4FN5NDC20692
 Model Year: 2022 Dealer Name: CAMPERLAND OF OKLAHOMA LLC
 8347 EAST 11TH STREET
 TULSA, OK 74112
 USA

Manufacturer's Suggested Retail Price \$134,433.00

TOTAL AMOUNT DOES NOT INCLUDE STATE AND LOCAL TAXES OR LICENSE FEES. THE PRICE SHOWN ABOVE MAY OR MAY NOT BE REPRESENTATIVE OF THE ACTUAL SELLING PRICE OF SIMILAR RECREATIONAL VEHICLES IN YOUR AREA.

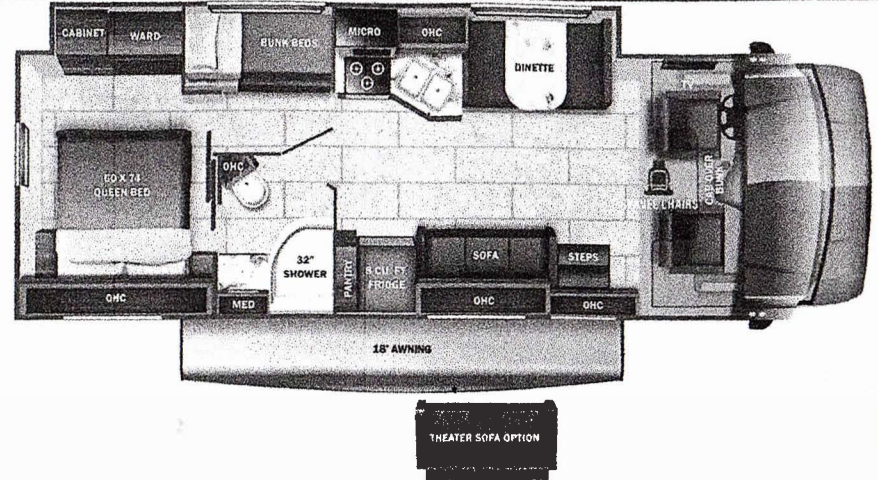

Standard Equipment

Optional Equipment

THE FOLLOWING ITEMS ARE STANDARD ON THIS MODEL AT NO EXTRA CHARGE

OPTIONAL EQUIPMENT INSTALLED ON THIS VEHICLE BY MANUFACTURER

- EXTERIOR**
- Ford® E-450 chassis
 - GVWR- 14,500 lb
 - GVWR- 22,000 lb
 - 7.3L V-8 350 HP engine with 468 ft.-lb torque
 - 6 speed FordShift® series transmission with overdrive
 - 210-amp alternator
 - E-rated highway tires- LT225/75R16
 - Tire pressure monitoring system (TPMS)
 - Power anti-lock brakes with power steering
 - 7,500 lb. hitch with 750 lb. torque capacity and 7-pin plug
 - 12V chassis battery
 - 55 gal. fuel tank
 - Remote-controlled, side-view mirrors
 - StrongholdVBL™ roof, floor and sidewalls
 - Bead-board insulation (R-24 max. roof, R-6 max. floor, R-5 max. walls)
 - TPO laminated roof
 - Aluminum running boards
 - Fiberglass exterior walls with vinyl graphics
 - Leveling jack prep
 - Frameless windows
 - Remote keyless entry
 - Entrance door with industry's largest travel-view window
 - Electric-powered entrance step with integrated house battery compartment
 - 12V house battery
 - (2) high-output, marine grade exterior speakers
 - Slide-out cover awnings
 - Pass-through storage compartment with night (select models)
 - 12.2 gal. propane tank (41 lb.)
 - LP quick-connect hookup
 - Exterior utility center
 - Ventilation drain system
 - Outside shower
 - 12V demand water pump
 - Onan® 4,500-watt MicroQuiet™ generator with auto changeover
 - Transfer switch with reverse polarity protection
 - 30-amp electrical service
 - Solar prep
 - Third brake light
 - Porch light
 - Roof ladder
 - 4 in. bumper tube sewer hose storage

- INTERIOR**
- Swivel driver and passenger seats (N/A 25R)
 - Driver and passenger airbags
 - Power windows and door locks
 - Tilt steering wheel
 - A/C and cruise control
 - Auxiliary start switch
 - Privacy curtains for cab area
 - 84 in. ceiling height
 - High-intensity, recessed LED ceiling lights
 - LED tilt slideout table
 - Hardwood cabinet doors and drawers
 - Bath-bearing drawer guides
 - Jayco-exclusive, easy-operation legless dinette table
 - 2-point lap safety belts in all designated seating locations
 - Interior entrance door grab handle
 - Interior command center
 - Pleated blackout shades
 - 15,000 BTU ducted A/C
 - 31,000 BTU auto-ignition furnace
 - 6 gal. gas/electric DSI auto-ignition water heater
 - Prep top satellite dish
 - Cable TV hookup with RG-6 coax
 - Digital antenna with signal booster
 - Furrion® all-in-one cooktop and oven
 - Residential-size microwave
 - Stainless steel kitchen sink
 - Decorative kitchen backsplash
 - Pop-up charging station with 110 outlet and USB plugs
 - LED ill. pressed countertops
 - Water filtration system
 - Shower with decorative ABS surround and skylight
 - Stainless steel bathroom sink
 - Toilet with foot flush
 - Vent fan in bathroom
 - Queen-size bed with bedspread
 - Under-bed storage (select models)
 - Large wardrobes
 - Overhead bunk with 750 lb. capacity and safety net
 - Bunks with industry-exclusive 300 lb. capacity each (31F)
 - Smoke alarm
 - Carbon monoxide detector

- Base price 121,718.00
- Modern Farmhouse 443.00
- USA Standards n/c
- 22 FD E45 14500 158* n/c
- 7.3L WHITE NC10 n/c
- Customer Value Package 6,000.00
- Dual A/Cs 1,193.00
- Hydraulic Auto Leveling Jacks 3,893.00
- 190W Roof Mounted Solar panel w/2nd House Battery 743.00
- Standard House Battery n/c
- Folding Sun Shade 443.00
- Windshield n/c
- Sofa n/c

- CUSTOMER VALUE PACKAGE**
- JRD® Computer-balanced driveshell, standard front and rear stabilizer bars, Helwig® helper springs, rubber isolation body mounts
 - One-piece, seamless, fiberglass front cap
 - Heated holding tanks (12V pads)
 - Electric pilot awning with LED lights
 - Black holding tank sprayer
 - Sony® infotainment center with Apple® CarPlay™ and Android Auto™
 - Backup and side-view cameras
 - LED HD Smart Fire TV in living area
 - 8 cu. ft. flush-mount, double-door refrigerator

UNIT TOTAL **134,433.00**

DEALER INSTALLED OPTIONS

DIMENSIONS

- Exterior height: 138.00"
- Exterior width: 100.00"
- Tire size (front): LT225/75R16S
- Tire size (mid):
- Tire size (rear): LT225/75R16E

CAPACITIES

- Fresh water tank (gals.): 47.00
- Gray water/toilet tank (gals.): 41.00
- Black water/toilet tank (gals.): 31.00
- Propane (lbs.): 41
- Propane (gals.): 9
- Water heater (gals.): 6.00

TIRES

- Tire size (front): LT225/75R16S
- Tire size (mid):
- Tire size (rear): LT225/75R16E

Some dimensions may be rounded and may vary from the actual dimensions
 Weights may be estimated calculations and may vary from the actual weight - refer to the vehicle weight labels for actual weights
 Floorplans, features and specifications are subject to change without notice.



22-21015N