



# White Hawk



Serial #: 1UJB0BN3M1440194  
 Model: 24MBH WHITE HAWK TT

Model Year: 2021 Dealer Name: CAMPERLAND OF OKLAHOMA LLC  
 8347 EAST 11TH STREET  
 TULSA, OK 74112  
 USA

## Standard Equipment

THE FOLLOWING ITEMS ARE STANDARD ON THIS MODEL AT NO EXTRA CHARGE

## Optional Equipment

OPTIONAL EQUIPMENT INSTALLED ON THIS VEHICLE BY MANUFACTURER

- Exterior**
- Aerodynamic, rounded front profile with front diamond plate
  - Stronghold VBL™ vacuum-bonded, laminated side, rear and front walls (including slideout room walls)
  - Magnum Truss™ Roof System with seamless DiFlex I material
  - 8 in. tongue-and-groove plywood decked flooring
  - Fully integrated A-frame
  - G20 dark tinted safety-glass windows
  - 30 in. friction-hinged main entry doors (select models)
  - Swing out grab handle
  - Exterior TV backer with 110V and cable outlets
  - Outdoor camp kitchen with embossed metal countertops (select models)
  - Slam latches on front pass-through storage doors (select models)
  - Marino-grade exterior speakers with blue LED accent lighting (2)
  - Galvanized steel and impact-resistant wheel wells
  - American-made Dexter® axles with E-Z Lube®
  - Slideout rooms with double seals, barrier sponges, and U-channel drip spouts
  - 30-amp service
  - Stabilizer jacks with sand pads (4)
  - Mounted camera bracket for pre-wired rear backup
- Interior**
- Solid hardwood joined cabinets with screwed and glued lumbercore cabinet stiles
  - Deep, split bowl, stainless steel sink with high rise, pull out faucet and dry rack/sink cover combo
  - Decorative backsplash
  - Ball-bearing drawer guides with 75 lb. capacity
  - Arched interior ceiling
  - LED lighting throughout
  - Directional and closeable central A/C vents
  - Plywood dinette, bunk and bed bases (applicable models)
  - 60 in. x 80 in. queen beds (60 in. x 75 in. in the 24MBH)
  - 72 in. x 80 in. king bed (standard on 30FLS, 30FKS & 32KBS)
  - Murphy bed design allowing pass-through exterior storage access (24MBH)
  - Solid wood door enclosures for master bedroom (N/A on Murphy bed models)
  - Full bedroom closet (27RB & 29BH)
  - Fixed bunks with 120V outlet and corner shelf (bunk models only)
  - Jayco exclusive Teddy Bear "soft-touch" bunk mats (bunk models only)
  - Bathroom medicine cabinets
  - 14 in. x 14 in. powered roof vents in bathroom and main bedroom
  - L-lounger sofa (standard in the 24MBH)
  - Residential vinyl flooring with cold crack resistance
  - High output auto-ignition furnace with wall thermostat
  - Wood panel fridge inserts
  - 360° Siphon® roof vent cap
  - Decorative wall clock in main living area (select models)
  - Electric fireplace (mandatory)
  - Front windshield offers a roller shade with retract bar

- Base price** 40,035.00  
**Modern Farmhouse** n/c  
**USA Standards** n/c  
**Customer Value Package** 5,260.00  
**Luxury Package** 3,000.00  
**Solar Power Package Prep** n/c  
**No 2nd AC** n/c  
**50 AMP Service** 353.00  
**Fireplace** 338.00  
**10 Cu. Ft. 12v Refrigerator** 30.00  
**Electric Stabilizer Jacks** 638.00  
**Free Standing Table with 2 Chairs and Ottoman** 473.00

- CUSTOMER VALUE PACKAGE (MANDATORY)**
- American-made nitro-filled Goodyear® radial tires (made in the USA)
  - Self-adjusting electric brakes
  - 8 cu. ft. refrigerator
  - Porcelain foot flush toilet
  - 34 in. radius showers with solid enclosure
  - 40 in. LED TV (N/A on 32KBS & 32RL)
  - 50 in. LED TV (32KBS & 32RL)
  - Roof ladder
  - 14,500 BTU A/C
  - 6 gal. gas/electric DSI water heater
  - 30 lb. propane bottles (2)
  - Bathroom skylight
  - Outside shower
  - Oven with 3-burner recessed cooktop with glass cover
  - Power awning with LED light
  - Slide topper prep
  - Microwave
  - AM/FM/CD/DVD/Bluetooth® stereo with speakers
  - Power tongue jack
  - Inverter pre-wire

UNIT TOTAL 50,117.00

DEALER INSTALLED OPTIONS

## Manufacturer's Suggested Retail Price \$50,117.00

TOTAL AMOUNT DOES NOT INCLUDE STATE AND LOCAL TAXES OR LICENSE FEES. THE PRICE SHOWN ABOVE MAY OR MAY NOT BE REPRESENTATIVE OF THE ACTUAL SELLING PRICE OF SIMILAR RECREATIONAL VEHICLES IN YOUR AREA.

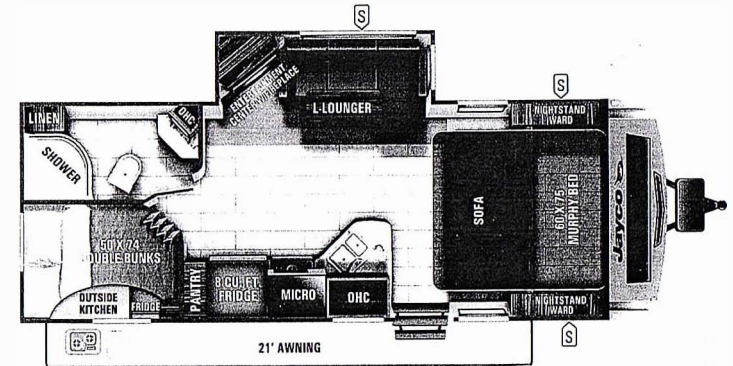

**UVW** 6235 lbs **Sleeps** 6-7 **Length** 29' 4.5"

### DIMENSIONS

Exterior height: 131.50"  
 Exterior width: 95.88"

### WEIGHTS

CVWR: 7350  
 GAWR (front): 3500  
 GAWR (rear): 3500  
 Approx. Gross Cargo Carrying Capacity (GCCC): 1115

### TIRES

Tire size (front): ST205/75R14D  
 Tire size (mid):  
 Tire size (rear): ST205/75R14D  
 Tire size (spare): ST205/75R14D

### CAPACITIES

Fresh water tank (gals.): 42.00  
 Gray water tank (gals.): 30.50  
 Black water/toilet tank (gals.): 30.50  
 Propane (lbs.): 60  
 Propane (gals.): 14  
 Water heater (gals.): 6.00

### SEATING & SLEEPING

Murphy bed: 60 X 75  
 Sofa jack knife: 64 X 42  
 Sofa L-Lounge standard: 47 X 69  
 Table 4 chairs option: 24 X 40  
 Theater w/End Tables option: 60  
 Ottoman & Table 2 Chairs option: 24 X 40  
 Bunk bed 2: 49 X 73



\*\*\*Some dimensions may be rounded and may vary from the actual dimensions\*\*\*  
 \*\*\*Weights may be estimated calculations and may vary from the actual weight - refer to the vehicle weight labels for actual weights\*\*\*  
 Floorplans, features and specifications are subject to change without notice.

21-20856N