



White Hawk



Serial #: 1UJB0BN6M1440142
Model: 24MBH WHITE HAWK TT

Model Year: 2021 Dealer Name: CAMPERLAND OF OKLAHOMA LLC
8347 EAST 11TH STREET
TULSA, OK 74112
USA

Standard Equipment

THE FOLLOWING ITEMS ARE STANDARD ON THIS MODEL AT NO EXTRA CHARGE

- Exterior**
- Aerodynamic, rounded front profile with front diamond plate
 - Stronghold VGL™ vacuum-bonded, laminated side, rear and front walls (including slideout room walls)
 - Magnum Truss™ Roof System with seamless DiFlex II material
 - 5/8 in. tongue-and-groove plywood decked flooring
 - Fully integrated A-frame
 - G20 dark tinted safety-glass windows
 - 30 in. friction-hinged main entry doors (select models)
 - Swing out grab handle
 - Exterior TV backer with 110V and cable outlets
 - Outdoor camp kitchen with embossed metal countertops (select models)
 - Stair latches on front pass-through storage doors (select models)
 - Marine-grade exterior speakers with blue LED accent lighting (2)
 - Galvanized steel and impact-resistant wheel wells
 - American-made Dexter® axles with E-Z Lube®
 - Slideout rooms with double seats, barrier sponges, and U-channel drip spouts
 - 30-amp service
 - Stabilizer jacks with sand pads (4)
 - Mount camera bracket for pre-wired rear backup prep
 - Black tank flush
 - ABS propane bottle cover
 - Automotive-style aluminum rims
 - Spare tire with cover
 - Keyed Alike™ lock system
 - Detachable power cord
 - Exterior LED lighting
 - A-Frame mounted solar prep
 - Battery quick disconnect

- LUXURY PACKAGE (MANDATORY)**
- Kitchen skylight with shade
 - Front molded fiberglass cap with automotive-style windshield and blue LED accent lighting
 - Frameless windows
 - MORyde® StepAbove™ entry steps (main entry), aluminum tread steps (second entry on select models)
 - JaySMART™ (Safety Markers And Reverse Travel) LED lighting (patent-pending)
 - Climate Shield™ zero-degree tested weather protection:
 - Fully encapsulated and heated underbody (ducted)
 - 35,000 BTU output furnace (25,000 BTU on 24MBH)
 - Double layer fiberglass batt insulation in ceiling and floor
 - Double sided radiant barrier insulation (roof, floor, and behind cap)
 - PEX plumbing
 - Roof-mount solar prep
 - Power roof vent (main living area)
 - JAYCOMMAND™ "Smart RV" system (includes TPMS option)

- Interior**
- Solid hardwood joined cabinets with screwed and glued lumbercore cabinet sillies
 - Deep, split bowl, stainless steel sink with high rise, pull out faucet and dry rack/sink cover combo
 - Decorative backsplash
 - Belt-bearing drawer guides with 75 lb. capacity
 - Arched interior ceiling
 - LED lighting throughout
 - Directional and closeable central A/C vents
 - Plywood dinette, bunk and bed bases (applicable models)
 - 60 in. x 80 in. queen beds (60 in. x 75 in. in the 24MBH)
 - 72 in. x 80 in. king bed (standard on 30FLS, 30FKS & 32KBS)
 - Murphy bed design allowing pass-through exterior storage access (24MBH)
 - Solid wood door enclosures for master bedroom (N/A on Murphy bed models)
 - Full bedroom closet (27RB & 29BH)
 - Fixed bunks with 120V outlet and corner shelf (bunk models only)
 - Jayco exclusive Teddy Bear "soft-touch" bunk mats (bunk models only)
 - Bathroom medicine cabinets
 - 14 in. x 14 in. powered roof vents in bathroom and main bedroom
 - L-lounger sofa (standard in the 24MBH)
 - Residential vinyl flooring with cold crack resistance
 - High output auto-ignition furnace with wall thermostat
 - Wood panel fridge inserts
 - 360° Siphon® roof vent cap
 - Decorative wall clock in main living area (select models)
 - Electric fireplace (mandatory)
 - Front windshield offers a roller shade with radiant barrier backer

- CUSTOMER VALUE PACKAGE (MANDATORY)**
- American-made nitro-filled Goodyear® radial tires (made in the USA)
 - Self-adjusting electric brakes
 - 8 cu. ft. refrigerator
 - Porcelain toilet flush toilet
 - 34 in. radius showers with solid enclosure
 - 40 in. LED TV (N/A on 32KBS & 32RL)
 - 50 in. LED TV (32KBS & 32RL)
 - Roof ladder
 - 14.5 00BTU A/C
 - 6 gal. gas/electric DSI water heater
 - 30 lb. propane bottles (2)
 - Bathroom skylight
 - Outside shower
 - Oven with 3-burner recessed cooktop with glass cover
 - Power awning with LED light
 - Slide topper prep
 - Microwave
 - AM/FM/CD/DVD/Bluetooth® stereo with speakers
 - Power tongue jack
 - Inverter pre-wire

Optional Equipment

OPTIONAL EQUIPMENT INSTALLED ON THIS VEHICLE BY MANUFACTURER

Base price	36,510.00
Modern Farmhouse	n/c
USA Standards	n/c
Customer Value Package with 15,000 A/C	5,400.00
Luxury Package	3,000.00
Solar Power Package Prep	n/c
No 2nd AC	n/c
50 AMP Service	353.00
Fireplace	338.00
10 Cu. Ft. 12v Refrigerator	30.00
TPMS	203.00
Electric Stabilizer Jacks	338.00
Free Standing Table with 2 Chairs and Ottoman	473.00

UNIT TOTAL **46,945.00**

DEALER INSTALLED OPTIONS

Manufacturer's Suggested Retail Price \$46,945.00

TOTAL AMOUNT DOES NOT INCLUDE STATE AND LOCAL TAXES OR LICENSE FEES. THE PRICE SHOWN ABOVE MAY OR MAY NOT BE REPRESENTATIVE OF THE ACTUAL SELLING PRICE OF SIMILAR RECREATIONAL VEHICLES IN YOUR AREA.

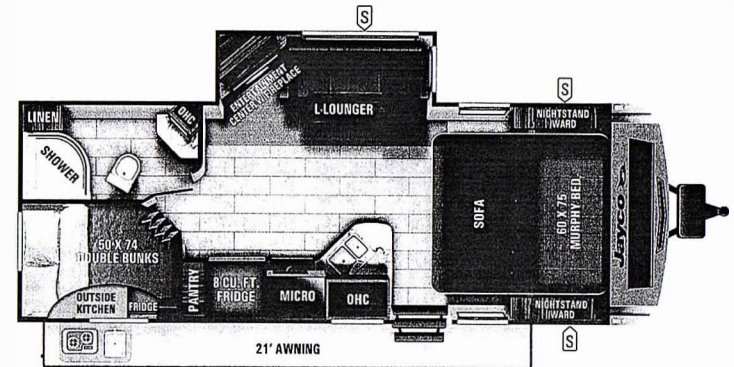

UVW
6245 lbs



Sleeps
6-7



Length
29' 4.5"

DIMENSIONS

Exterior height:	131.50"
Exterior width:	95.88"
WEIGHTS	
GVWR:	7350
GAWR (front):	3500
GAWR (rear):	3500
Approx. Gross Cargo Carrying Capacity (GCCC):	1105

CAPACITIES

Fresh water tank (gals.):	42.00
Gray water tank (gals.):	30.50
Black water/toilet tank (gals.):	30.50
Propane (lbs.):	60
Propane (gals.):	14
Water heater (gals.):	6.00

TIRES

Tire size (front):	ST205/75R14D
Tire size (mid):	
Tire size (rear):	ST205/75R14D
Tire size (spare):	ST205/75R14D

SEATING & SLEEPING

Murphy bed:	60 X 75
Sofa jack knife:	64 X 42
Sofa L-Lounge standard:	47 X 69
Table 4 chairs option:	24 X 40
Theater w/End Tables option:	60
Ottoman & Table 2 Chairs option:	24 X 40
Bunk bed 2:	49 X 73

2+3
YEAR LIMITED STRUCTURAL WARRANTY

Some dimensions may be rounded and may vary from the actual dimensions

***Weights may be estimated calculations and may vary from the actual weight

- refer to the vehicle weight labels for actual weights***

Floorplans, features and specifications are subject to change without notice.

21-20826N

TJB