



Jay Feather



Serial #: 1UJB0BN0M1J60247
Model: 24RL JAY FEATHER TT

Model Year: 2021 Dealer Name: CAMPERLAND OF OKLAHOMA LLC
8347 EAST 11TH STREET
TULSA, OK 74112
USA

Manufacturer's Suggested Retail Price \$36,909.00

TOTAL AMOUNT DOES NOT INCLUDE STATE AND LOCAL TAXES OR LICENSE FEES. THE PRICE SHOWN ABOVE MAY OR MAY NOT BE REPRESENTATIVE OF THE ACTUAL SELLING PRICE OF SIMILAR RECREATIONAL VEHICLES IN YOUR AREA.

Standard Equipment

THE FOLLOWING ITEMS ARE STANDARD ON THIS MODEL AT NO EXTRA CHARGE

- Exterior
 - Aerodynamic, rounded front profile with diamond plate
 - Modern retro graphics package with two-colored sidewall
 - Stowage'd VBL™ vacuum-bonded, laminated floor, side, rear and slide room walls
 - Keyed-Alike™ lock system
 - Magnum Truss™ Roof System with one-piece seamless Dura-Tex II material
 - American-made Norco® frame with integrated A-frame
 - Dualaxles
 - G20 tinted safety-glass windows
 - Marine-grade exterior speakers with blue LED accent lighting (2)
 - American-made Dexter® E-Z Lube® axles
 - Galvanized steel and impact-resistant wheel wells
 - Slideouts with double seals, barrier sporgies and U-channel drip spout (select models)
 - 30-amp service
 - Outside grill propane quick-connect port
 - Rear camera backup prep
 - Folding assist handle on main entry doors
 - Aluminum tread entry steps
 - Outside camp kitchen (standard on select models)
 - Battery quick disconnect
 - Slide lopper prep (select models with slide rooms)
 - Exterior TV prep with 120V electric and cable outlets

- Interior
 - Choice of two interior design packages- Modern Farmhouse or Vintage Washed Gray
 - Screwed and glued cabinetry
 - Smoked glass decorative inserts (select overhead cabinets)
 - Ball-bearing drawer guides with 75 lb. capacity
 - LED lighting throughout
 - 6 cu. ft. gas/electric refrigerator
 - Residential oven with 3-burner recessed cooktop and glass cover
 - Residential-style kitchen countertops
 - Residential vinyl flooring with cold crack resistance
 - Microwave
 - Flywood dinette, bunk and bed bases (applicable models)
 - 4 in. high-density dinette cushions with vinyl backing
 - Mattress with bedspread (select models)
 - Jayco exclusive Teddy Bear "soft-touch" residential-style bed mats (select models)
 - 120V outlet and corner stall in fixed bunks (bunk models only)
 - Plastic foot lush toilet
 - Decorative wall clock (select models)
 - Decorative backplash
 - Bathroom skylight and roof vent

- CUSTOMER VALUE PACKAGE (MANDATORY)
 - American-made nitro-filled Goodyear® radial tires with self-adjusting brakes
 - Aluminum rims
 - 20 lb. propane bottles with auto regulator (2)
 - 14,500 BTU A/C
 - Spare tire
 - Detachable power cord
 - Power awning with LED lights
 - Black tank flush
 - Outside shower
 - Power tongue jack
 - 6 gal. gas/electric DSI water heater
 - AM/FM/Bluetooth® stereo
 - Side marker camera prep
 - Rear camera backup prep
 - 360° Siphon® roof vent cap
 - Manual stabilizer jacks (4)
 - Inverter pro-wire

- SPORT PACKAGE (MANDATORY)
 - 24 in., 32 in. or 40 in. LED TV
 - Aluminum tread entry steps
 - Drying rack/sink cover
 - Enhanced graphics package
 - JaySMART™ (Safety Markers And Reverse Travel)
 - LED lighting (patent-pending)
 - Roof ladder
 - Roof-mount solar prep
 - Gleclor Package
 - Power roof vent (main living area)

Optional Equipment

OPTIONAL EQUIPMENT INSTALLED ON THIS VEHICLE BY MANUFACTURER

Base price	30,405.00
Modern Farmhouse	n/c
USA Standards	n/c
Customer Value Package	4,875.00
Sport Package	n/c
Solar Power Package Prep	n/c
JayCommand Control System W/TPMS	1,443.00
15,000 BTU AC Roof Mounted	150.00
30 AMP Service	n/c
8 Cu. Ft. 12v Refrigerator	30.00
20# LP Gas Bottles	n/c
Morryde Step Above Steps	113.00
Theater Seating w/Table	893.00
Trays	

UNIT TOTAL **36,909.00**

DEALER INSTALLED OPTIONS

21-20588N

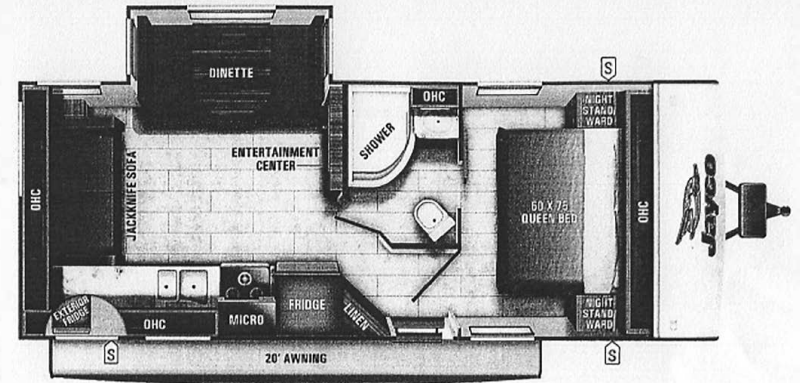

UVW
5570 lbs



Sleeps
4-6



Length
28' 7.13"

DIMENSIONS

Exterior height:.....127.88"
Exterior width:.....95.75"

WEIGHTS

GVWR:.....6500
GAWR (front):.....3500
GAWR (rear):.....3500

Approx. Gross Cargo Carrying Capacity(GCCC):.....930

TIRES

Tire size (front):.....ST205/75R14D
Tire size (mid):.....
Tire size (rear):.....ST205/75R14D
Tire size (spare):.....ST205/75R14D

CAPACITIES

Fresh water tank (gals.):...42.00
Gray water tank (gals.):...30.50

Black water/toilet tank (gals.):...30.50
Propane (lbs.):...40
Propane (gals.):...9
Water heater (gals.):...6.00

SEATING & SLEEPING

Queen bed:.....60 x 75
Sofa jack knife standard: 42 x 60
Sofa trifold option:.....47 x 73
Theater option:.....60
Dinette:.....40 x 70

Some dimensions may be rounded and may vary from the actual dimensions

Weights may be estimated calculations and may vary from the actual weight - refer to the vehicle weight labels for actual weights

Floorplans, features and specifications are subject to change without notice.

2+3
YEAR | YEAR
LIMITED STRUCTURAL
WARRANTY