

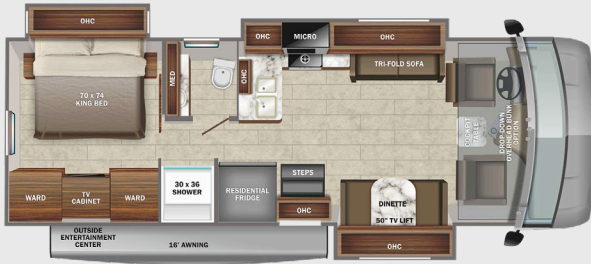

PRECEPT

31UL

OPTIONS: A, B



34B

OPTIONS: A, C

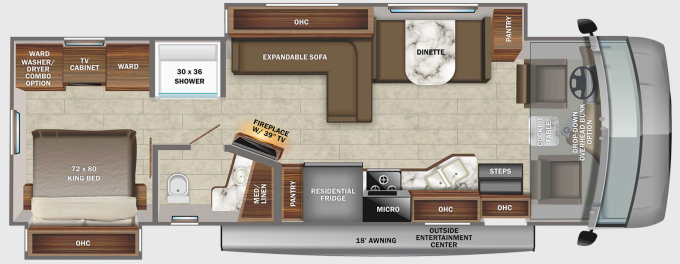

34G

OPTIONS: A



36A

OPTIONS: A, B



36C

OPTIONS: A



OPTIONS

A



12 Cu. Ft. Fridge

B



Theater Sofa

C



93" Reclining Sofa

EXTERIOR SELECTIONS



Standard Graphics Package



Alpine Full-Body Paint



Denali Full-Body Paint



Everlast Full-Body Paint

STANDARDS & OPTIONS

CUSTOMER VALUE PACKAGE

JRIDE® PLUS: Computer-balanced driveshaft, variable-rate front and rear jounce bumpers, heavy-duty front and rear stabilizer bars, SACHS shocks, 22.5" Michelin® tires
Automatic hydraulic leveling jacks
Frameless windows
15,000 BTU A/C unit with heat pump and second 13,500 BTU A/C unit
Exterior entertainment center with outside speakers, LED TV mounted on swivel bracket and single-disc DVD/FM radio
Electric patio awning with LED lights
Slideout cover awnings
Onan® Marquis Gold Genset 5,500-watt gas generator with auto-gen start
1,000-watt inverter
50-amp electrical service
Girard® tankless LP water heater
Sony® infotainment center with Apple® CarPlay™ and Android Auto™
Backup and side-view cameras
Removable driver/passenger cockpit table
LED-lit, solid-surface kitchen countertops with integrated stainless steel sink and sink covers
LED HD Smart Fire TV in living area
Day/night roller shades in living area

DRIVING

Ford® F53 chassis
GVWR- 22,000 lb. (31UL, 34B, 34G), 24,000 lb. (36A, 36C)
GCWR- 26,000 lb. (31UL, 34B, 34G), 30,000 lb. (36A, 36C)
7.3L V-8 350 HP engine with 468 ft.-lb. torque
6-speed automatic TorqShift® transmission with overdrive and tow haul mode
210-amp alternator
G-rated highway tires- 235/80R22.5 (31UL, 34B, 34G), 255/80R22.5 (36A, 36C)
Front and rear disc, 4-wheel anti-lock brakes
5,000 lb. rear hitch receiver with dual connector and 7-pin plug
12V chassis battery
80 gal. fuel tank
120 in. panoramic windshield - largest in the industry
Swivel driver and passenger seats
Soft-touch, vinyl-wrapped automotive dash
Tilt steering wheel
A/C and cruise control

EXTERIOR

StrongholdVBL™ roof, floor and sidewalls
Bead-foam insulation (R-24 max roof, R-9 max floor, R-5 max walls)
One-piece, seamless, fiberglass front and rear caps
One-piece, crowned fiberglass roof
Fiberglass exterior walls with vinyl graphics
Entrance door with industry's largest travel-view window
Electric-powered entrance step
Lockable, pass-through storage compartments with metal slam latches

Heated holding tanks (12V pads)
16.5 gal. propane tank (56 lb.)
LP quick-connect hookup
Exterior utility center
Winterization drain system
Outside shower
12V demand water pump
Transfer switch with reverse polarity protection
(2) 6V AGM (220Ah) house batteries on slideout tray
190W solar panel with dual controller
Flush-mount LED marker lights
Third brake light
Porch light

INTERIOR

Power front privacy shade with manual side privacy shades
JAYCOMMAND™ powered by Firefly
84 in. interior ceiling height with padded vinyl ceiling
High-intensity, recessed LED ceiling lights
LED-lit hardwood fascia
Hardwood cabinet doors and drawers
Ball-bearing drawer guides
Jayco-exclusive, easy-operation legless dinette table
2-point lap safety belts in all designated seating locations
Auto-ignition ducted furnace- 30,000 BTU (31UL), 35,000-BTU (34B, 34G, 36C), (2)30,000 BTU (36A)
Furrion® electric fireplace (34B, 34G, 36C)
Prep for satellite dish
Cable TV hookup with RG-6 coax and video selector switch
Winegard 2.0 Wifi/4G antenna
21 cu.ft. residential refrigerator with ice and water in door
Furrion® all-in-one cooktop and oven
Residential-size microwave
Decorative kitchen backsplash
Water filtration system
Shower with decorative surround, glass door, skylight and light
Stainless steel bathroom sink
Porcelain toilet with foot flush
Powered roof vent in bathroom with wall switch
Walk-around King-size bed with bedspread and nightstands
LED TV in bedroom
Under-bed storage (select models)
Large wardrobes
Bunks with industry-exclusive 300 lb. capacity each (36A)
Smoke alarm
Carbon monoxide detector

OPTIONS

Drop-down overhead bunk in cab area with 750 lb. capacity
Power theater seating (N/A 34B) (STD 34G, 36C)
93 in. straight reclining sofa (34B)
12 cu.ft. gas/electric refrigerator
Stackable washer/dryer (36C)
Combination washer/dryer (34B, 34G, 36A)

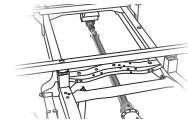

COMPUTER-BALANCED DRIVESHAFT

Ensures smooth and efficient power transfer to the wheels



VARIABLE RATE FRONT & REAR JOUNCE BUMPERS

Assist during extreme road occurrences to absorb impact and dampen excess road noise

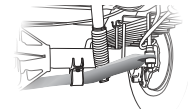

HEAVY-DUTY FRONT & REAR STABILIZER BAR

A large bar and polyurethane bushings, instead of rubber, transfer power faster for extra support, more stability and easier handling



SACHS SHOCK ABSORBERS

Large-diameter tube design pairs gas and hydraulics to resist heat and pressure while independently adjusting to changing road conditions

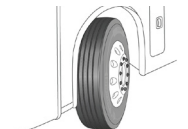

22.5" MICHELIN® TIRES

Commercial-grade tires built for long hauls and heavy loads

FLOORPLAN	GVWR (lbs.)	GCWR (lbs.)	WHEEL BASE	OVERALL LENGTH	EXTERIOR HEIGHT (with A/C) & SATELLITE	EXTERIOR WIDTH	INTERIOR HEIGHT	FRESH WATER CAPACITY (gal.)	GRAY WASTE WATER CAPACITY (gal.)	BLACK WASTE WATER CAPACITY (gal.)
31UL	22,000	26,000	228"	33'	12' 10"	101"	84"	72	40	50
34B	22,000	26,000	228"	36' 11"	12' 10"	101"	84"	72	40	40
34G	22,000	26,000	238"	36' 6"	12' 10"	101"	84"	72	40	50
36A	24,000	30,000	252"	38' 10"	12' 10"	101"	84"	72	40/32	40/32
36C	24,000	30,000	252"	38' 10"	12' 10"	101"	84"	72	40/32	40/32