

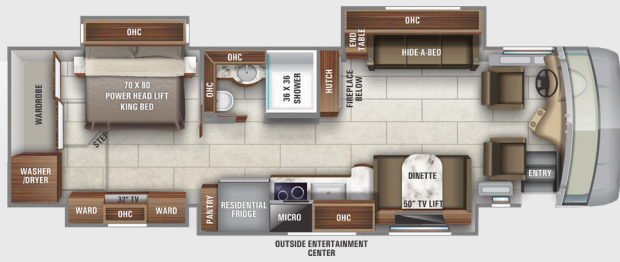

EMBARK

37K OPTIONS: A



39BH OPTIONS: A

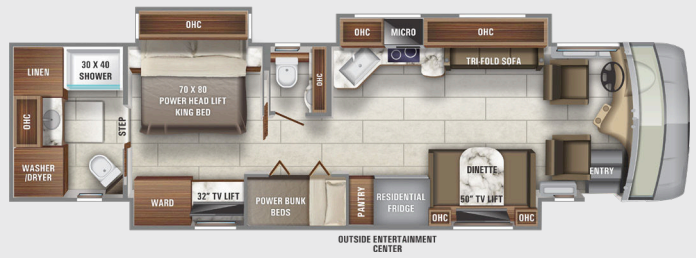

39T2 OPTIONS: A



OPTIONS

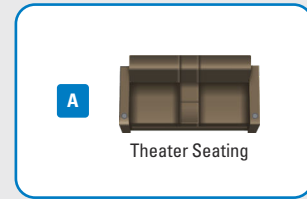

PAINT SELECTIONS

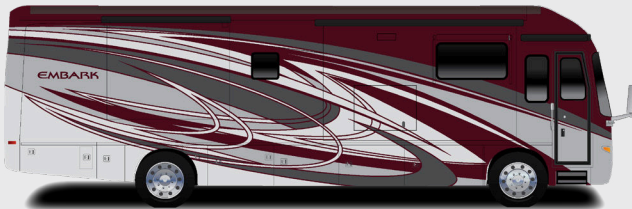

Dark Crimson Full-Body Paint

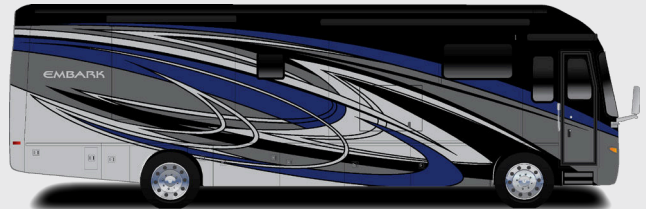

Summit Blue Full-Body Paint

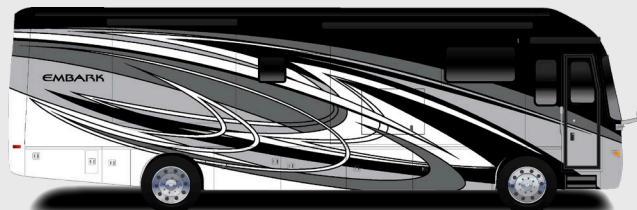

Shadow Grey Full-Body Paint

STANDARDS & OPTIONS

CHASSIS

Spartan® K1 raised-rail chassis
 Cummins® B6.7 turbocharged 360 HP engine with 800-lb. ft. torque at 1,800 RPM
 Allison® 3,000 MH 6-speed transmission
 Rear-mounted radiator
 170-amp alternator
 750 watt engine block heater
 Variable geometry turbo (VGT) engine brake
 Independent front air suspension (IFS) front axle - 12,600 lb. (37K) 14,320 lb. (39BH/39T2)
 Rear axle- 20,000-lb. (37K) 22,000 lb. (39BH/39T2)
 4.88 rear axle ratio
 Michelin® 275/80R 22.5" tires
 Bilstein® 46mm shocks
 Tire pressure monitoring system (TPMS) with temperature monitoring
 Equalizer™ hydraulic automatic coach leveling
 Remote air connection
 (2) 12V chassis batteries
 100-gal. fuel tank
 10-gal. DEF tank
 55 degree turning radius
 Spartan® Safehaul tow vehicle air brake system
 10,000-lb. hitch with 7-pin plug

CONSTRUCTION

Roof: One-piece fiberglass with 3/8" plywood decking, 4" arched aluminum trusses, insulation and reflective Flexfoil® (R-24)
 Sidewalls: Vacuum-bonded, high-gloss gelcoat with R-8 bead-foam insulation
 Floors: Vacuum-bonded layers of Darco underbelly, a welded aluminum frame, R-9 bead-foam insulation, 3/8" Structurwood® and 1/4" plywood
 X-Bridge™ bracing welded into chassis frame
 Heated basement storage
 Insulated front and rear caps (R-24)
 Steel-reinforced front cap and windshield frame
 Electric-powered slideout rooms

HEAT, A/C, POWER, AND WATER

Onan® 8,000-watt diesel generator, with automatic start, on slide-out tray
 2,000-watt pure sine wave inverter with 100-amp battery charger
 (2) L16 AGM batteries (6V/390 amp hrs. ea.)
 50-amp power cord
 Automatic transfer switch with surge protection
 (3) 15,000 BTU A/C units with heat pumps [(2)15,000-BTU units with heat pumps on 37K]
 35,000-BTU furnace (37K) / (1) 20,000 and (1) 30,000 (39BH, 39T2)
 Tankless gas water heater
 24.5-gal. propane tank
 LED-lit fireplace with 5,000-BTU heating element (37K only)
 Sani-Con® Macerator holding tank dump system with manual gate valves, manual backup and metal door
 Black holding tank sprayer
 City and tank water filtration system
 Winterizing drain system

EXTERIOR

Carefree® power patio awning with LED lights
 Carefree® power entrance door awning with LED lights
 Carefree® slideout awnings
 Carefree® window awnings
 Frameless, dual-pane, tinted, safety-glass windows
 Grab handle and keypad system for keyless entry
 43" Samsung® 4K UHD Smart TV with tilt, swivel, and extend adjustment
 JBL radio and speakers with USB port and receptacle
 Heated, remote-control, side-view mirrors with integrated cameras
 Diamond Shield™ front protective film mask
 Halogen high/low beam headlights and fog lights
 Daytime running lights
 LED marker lights, turn lights, license plate light, third brake light, accent lights and docking lights
 Porch light
 Mudflap with chrome "Entegra" nameplate

Winegard® TRAV'LER satellite dish DIRECTV® - standard with option
 Winegard® TRAV'LER satellite dish Shaw TV - standard with CSA option
 Winegard® Rayzar Z1 TV antenna
 Winegard® WiFi extender with 4G/LTE
 Solar power prep
 Exterior utility center
 Slideout basement storage tray
 Sikkens custom full-body paint

COCKPIT

Valid 12.3" digital dash with quad core graphics processor, on-board diagnostics, selector knob and ability to display traditional instrument cluster, 360° camera system or GPS navigation
 Xite™ 360° HD digital camera system
 Xite™ XSG4 infotainment system with 9" touchscreen, iGO navigation, Bluetooth®, Sirius XM™ and AM/FM tuner, integrated camera control and house mode whole-coach audio distribution
 Steering wheel with integrated controls for cruise, wipers, radio and Bluetooth® phone functionality
 Manual tilt and telescoping steering column
 Ultra-Vision® one-piece wrap-around tinted windshield
 6-way power adjustable driver and passenger seats
 Powered flush stepwell cover
 Power adjustable brake and accelerator pedals
 Powered front sun visors and privacy shades
 (2) dual USB ports and (2) 12V sockets for charging

INTERIOR

JAYCOMMAND® powered by Firefly with 7" VegaTouch touchscreen for complete integration of coach controls (mobile app available)
 50" Samsung® 4K UHD Smart TV
 Samsung® sound bar with subwoofer
 Sony® Blu-ray™ player
 Premium furniture
 Hand-laid porcelain tiled floors
 LED interior lighting
 Decorative ceiling feature with integrated accent lighting
 Manual solar day shades and blackout night shades
 Central vacuum system
 Removable screen on entry door

KITCHEN

Window with slider and screen
 Whirlpool® stainless-steel residential refrigerator with ice maker and water dispenser
 Induction cooktop
 1.5-cu. ft. convection microwave oven
 Solid-surface countertops with stainless steel sink
 Fan-Tastic power exhaust fan with intake

BEDROOM

King-size pillow-top mattress on tilt bed
 32" Samsung® LED 1080P Smart TV
 Sony® Blu-ray™ player

BATHROOM

Solid-surface countertops with integrated sink
 One-piece fiberglass shower with skylight
 Aqua View® SHOWERMISER™ water saving system
 Thetford® Aqua Magic toilet with foot flush
 Fan-Tastic power exhaust fan with intake
 Whirlpool® stacked washer and dryer

SAFETY

Combination carbon monoxide detector and LP gas alarm
 Smoke alarm

OPTIONS

Canadian standards (CSA)
 Theater seating with power recliners
 Winegard® in-motion satellite dome
 Winegard® TRAV'LER satellite dish Dish Network®

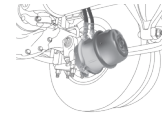

FULL AIR BRAKES
 Deliver robust stopping power, even on grades

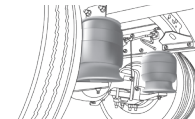

FULL AIR SUSPENSION
 Softens ride and improves handling

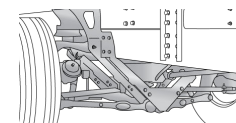

INDEPENDENT FRONT SUSPENSION
 For more precise steering and less body-roll on turns

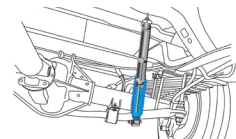

BILSTEIN® SHOCKS
 Eliminate excessive sway and bounce

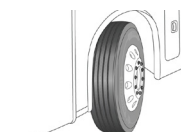

MICHELIN® XZE TIRES
 Commercial-grade tires built for long hauls and heavy loads

FLOORPLAN	GVWR (lbs.)	GCWR (lbs.)	WHEEL BASE	OVERALL LENGTH	EXTERIOR HEIGHT (with A/C) & SATELLITE	EXTERIOR WIDTH	INTERIOR HEIGHT	FRESH WATER CAPACITY (gal.)	GRAY WASTE WATER CAPACITY (gal.)	BLACK WASTE WATER CAPACITY (gal.)
37K	32,600	42,000	236"	37' 10"	12' 10"	101"	84"	100	62	41
39BH	36,320	46,320	261"	39' 11"	12' 10"	101"	84"	100	62	41
39T2	36,320	46,320	261"	39' 11"	12' 10"	101"	84"	100	62	41

Meet your Jayco Dealer



Some specs at the time of print may include estimates. For the most updated information, please visit Jayco.com. *Indicates split tanks

Scan QR code for specification definitions

Jayco, Inc. | P.O. Box 460 | Middlebury, IN 46540

See dealer for further information and prices. All information in this brochure and on www.jayco.com is the latest available at the time of publication approval. Jayco reserves the right to make changes and to discontinue models without notice or obligation. Photography may show optional equipment or props used for decoration purposes only. RVs built for sale in Canada may differ to conform to Canadian codes. JAYCO and the JAYCO BIRD IN FLIGHT are registered trademarks of Jayco, Inc. Printed in USA 10/21 ©2021 Jayco, Inc. 257072

Jayco - Part of the Jayco Family of Companies

