

# SENECA



CLASS C MOTORHOME

SENECA

POWER AND LUXURY COMBINED



# SENECA



**Seneca 37M Shown in Richmond Interior Design**



**China Hutch Featuring 40" Furrion® Electric Fireplace**



**Bedroom with Walk-Around King-Sized Bed, Overhead Storage & LED TV**

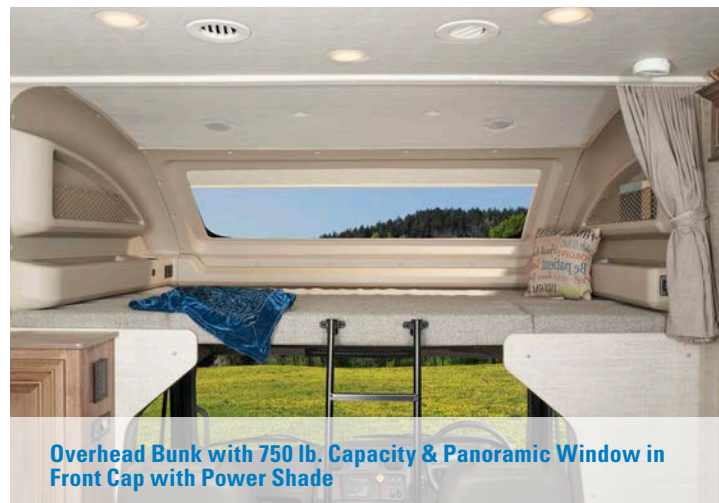

**Overhead Bunk with 750 lb. Capacity & Panoramic Window in Front Cap with Power Shade**



**Kitchen Featuring 21 Cu. Ft. Electric Refrigerator, Furrion® Recessed Gas Cooktop with Cast Iron Grill & Convection Microwave**





Seneca Dash Featuring Sony® Infotainment Center with Apple® Carplay™ & Android Auto™



Carpeted, Full Pass-Through Storage Compartments with Lockable Slam Latches

Raised-Panel Hardwood Cabinetry, LED-Lit Hardwood Fascia & High-Intensity Recessed LED Lights



Click here to visit  
gallery on website

## LUXURY AND LEISURE

Top notch interior and exterior features with four new full-body paint options make the 2021 Seneca C diesel RV the ultimate companion for your next road trip.



Bathroom Featuring One-Piece, Fiberglass Shower with Glass Door & Recessed LED-Lit Stainless Steel Sink

# SENECA FLOORPLANS

There's sure to be a spacious Seneca floorplan that will make you feel right at home.

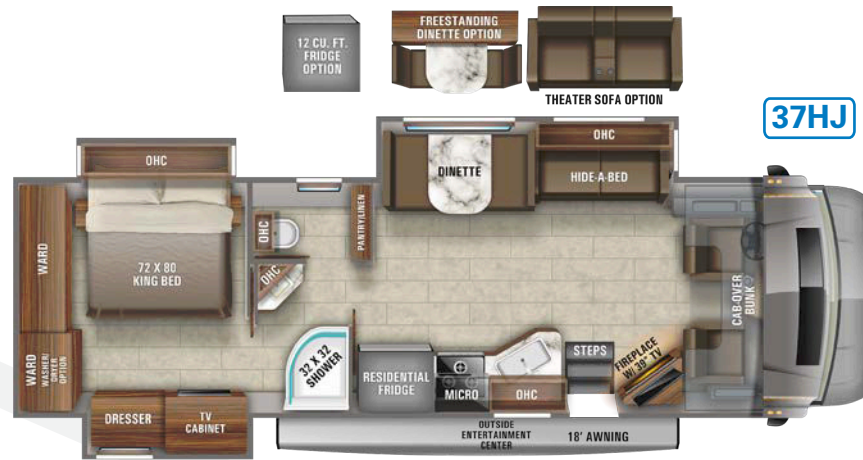

Ext. Lgth: **39' 4"** Wheelbase: **279"** GVWR: **31,000 lbs.**

[Click here to build & price your RV](#)

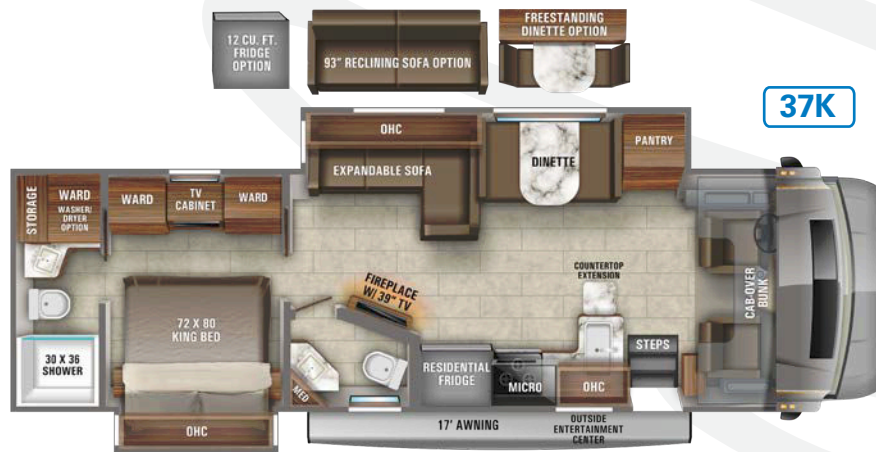

Ext. Lgth: **39' 4"** Wheelbase: **279"** GVWR: **31,000 lbs.**

[Click here to view 360° tour](#)

[Click here to build & price your RV](#)

## SPECS

MODEL	FLOORPLAN	EXTERIOR LENGTH	EXTERIOR WIDTH	EXTERIOR HEIGHT (WITH A/C)	INTERIOR HEIGHT	WHEEL BASE	FRESH WATER CAPACITY (GAL.)	GRAY WASTE WATER CAPACITY (GAL.)	BLACK WASTE WATER CAPACITY (GAL.)
SENECA	37HJ	39' 4"	101"	13' 4"	84"	279"	72	40	33
	37K	39' 4"	101"	13' 4"	84"	279"	72	51	40
	37L	39' 4"	101"	13' 4"	84"	279"	72	50/31	50
	37M	39' 4"	101"	13' 4"	84"	279"	72	50/31	50
	37RB	39' 4"	101"	13' 4"	84"	279"	72	40	33
	37TS	39' 4"	101"	13' 4"	84"	279"	72	40	50

[Click here for specification definitions](#)



360°

Click here to view 360° tour



Click here to build & price your RV



37L

Ext. Lgth: 39' 4" Wheelbase: 279" GVWR: 31,000 lbs.

360°

Click here to view 360° tour



Click here to build & price your RV



37M

Ext. Lgth: 39' 4" Wheelbase: 279" GVWR: 31,000 lbs.

37RB

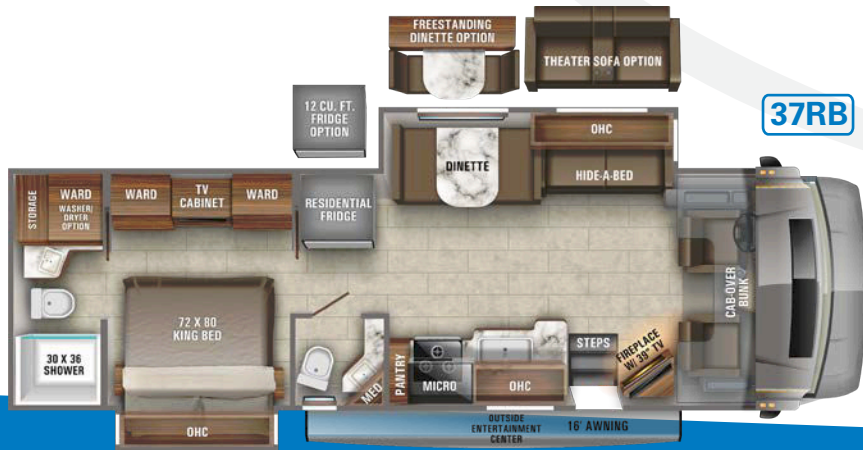

Ext. Lgth: 39' 4" Wheelbase: 279" GVWR: 31,000 lbs.

37TS



Ext. Lgth: 39' 4" Wheelbase: 279" GVWR: 31,000 lbs.

360°

Click here to view 360° tour



Click here to build & price your RV

360°

Click here to view 360° tour



Click here to build & price your RV

# TRUE INTERIOR DESIGN. MORE CHOICE. MINDFUL CRAFTSMANSHIP.

Say goodbye to simple RV “decor” and hello to interior design.

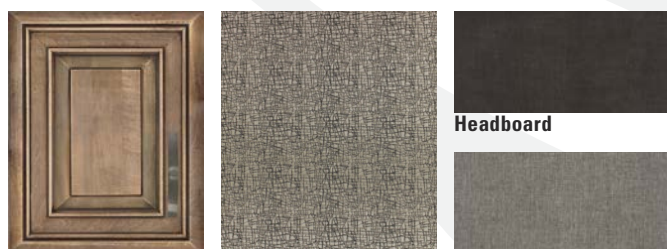

Cabinet Doors

Valance

Headboard

Bedsread



Bedroom Accents



Countertops



Backsplash



Flooring

PROVIDENCE INTERIOR DESIGN

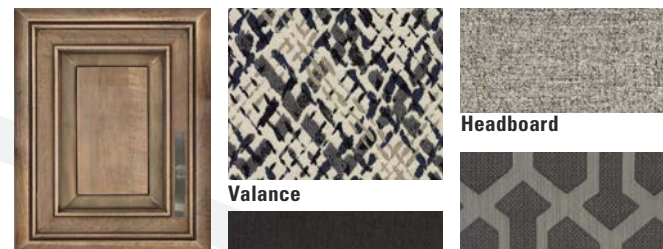

Cabinet Doors

Valance

Headboard

Bedsread

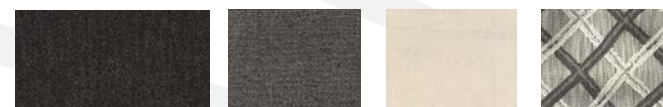

Bedroom Accents



Countertops

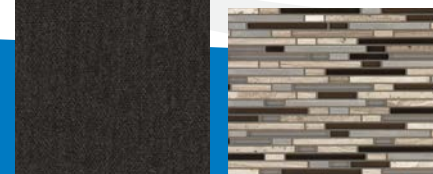

Backsplash



Flooring

RICHMOND INTERIOR DESIGN

# PREMIUM EXTERIORS

Jayco's premium full-body paint schemes are not only eye catching, but durable and easy to maintain.



**BLUE-SPRUCE FULL-BODY PAINT**

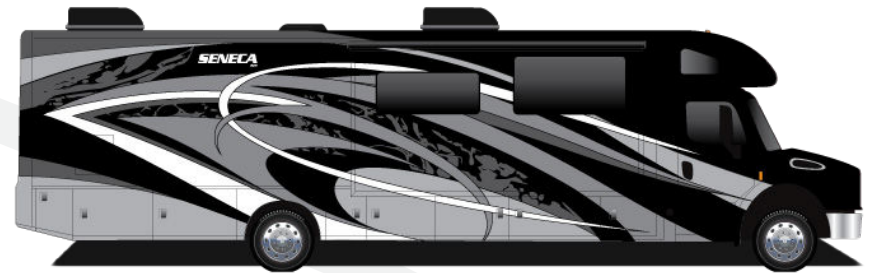

**ACADIA FULL-BODY PAINT**



**MAHOGANY FULL-BODY PAINT**



**YELLOWWOOD FULL-BODY PAINT**



# MORE STANDARDS. LESS OPTIONS.

The Seneca is full of features to make your next camping trip convenient, comfortable and fun.

  
[Click here to  
view Standards &  
Options on website](#)

## CUSTOMER VALUE PACKAGE

JRIDE® PREMIUM: Rear air suspension, heavy-duty rear stabilizer bar, full air brakes, Bilstein® shocks  
One-piece, seamless, fiberglass front and rear caps  
Automotive-bonded, panoramic window in front cap with power shade  
Dual-pane, tinted, safety-glass windows  
15,000 BTU A/C unit with heat pump and second 13,500 BTU A/C unit  
Electric patio awning with LED lights  
2,000-watt pure sine wave inverter  
Power cord reel with 50-amp service  
10 gal. gas/electric water heater  
Sony® infotainment center Apple® CarPlay and Android Auto™  
Backup and side-view cameras  
21 cu. ft. residential refrigerator with ice and water in door  
Convection microwave

## STANDARD DRIVING EQUIPMENT

Freightliner® S2RV chassis  
GVWR - 31,000 lb.  
GCWR - 43,000 lb.  
Cummins® ISB 6.7L 360 HP diesel engine with 800 ft.-lb. torque  
Allison® 3000 MH automatic transmission  
185-amp alternator  
G-rated highway tires- 275/80R22.5  
Alcoa® aluminum rims  
Engine exhaust brake  
12,000-lb. rear hitch receiver  
7-pin plug  
Dual 12V chassis batteries  
100 gal. fuel tank  
10 gal. DEF tank  
Deluxe heated, remote-controlled, side-view mirrors  
Power driver and passenger seats  
Driver and passenger air bags  
Power windows and door locks  
Tilt steering wheel  
A/C and cruise control

Auxiliary start switch  
Privacy curtains for cab area

## STANDARD EXTERIOR EQUIPMENT

StrongholdVBL™ vacuum-bond laminated roof, floor and sidewalls  
Bead-foam insulation (R-24 max roof, R-9 max floor and R-8 max walls)  
One-piece, seamless, crowned fiberglass roof  
Premium Sikkens full-body paint  
Automatic hydraulic leveling jacks  
Entrance door with industry's largest travel view window  
Electric-powered entrance step  
Slideout cover awnings  
Exterior entertainment center with outside speakers, LED TV mounted on swivel bracket and single-disc DVD/CD/AM/FM radio  
Winegard® In-motion satellite dish  
Carpeted, full pass-through storage compartments with lockable, Slam-latch™ doors  
24.5 gal. propane tank (83 lb.)  
LP quick-connect hookup  
Thetford® Sani-Con Turbo Macerator system  
Exterior utility center  
Winterization drain system  
Black tank flush  
Outside shower  
12V demand water pump  
Onan® 8,000-watt Quiet Diesel generator and auto-gen start  
(4) 6V AGM (220Ah) house batteries on slideout tray  
Solar prep  
Flush-mount LED marker lights  
Third brake light  
Porch light

## STANDARD INTERIOR EQUIPMENT

Custom-molded ABS surround in cab-over area  
Overhead bunk with 750 lb. capacity  
JAYCOMMAND® powered by Firefly  
84 in. interior ceiling height with padded vinyl ceiling

High-intensity, recessed LED ceiling lights  
Tile-like vinyl flooring  
Raised-panel, hardwood cabinetry throughout  
Deluxe hidden cabinet hinges  
Ball-bearing drawer guides  
Jayco-exclusive, easy-operation legless dinette table  
2-point lap safety belts in all designated seating locations  
34,000 BTU auto-ignition furnace  
Furrion® electric fireplace (N/A 37TS)  
LED TV in living area  
Blu-Ray™ with HDMI® connections to all televisions  
Cable TV hookup with RG-6 coax and video selector switch  
Furrion® stainless, recessed gas cooktop with cast iron grill  
LED-lit, solid-surface kitchen countertops with integrated stainless steel sink and sink covers  
Pull-out countertop extension (select models)  
Decorative kitchen backsplash  
Water filtration system  
One-piece, fiberglass shower with glass door, skylight and light  
Porcelain toilet with foot flush  
LED-lit, stainless-steel bathroom sink  
Powered roof vent in bathroom with wall switch  
Walk-around King-sized bed with bedspread and nightstands  
Under-bed storage (select models)  
LED TV in bedroom  
Large wardrobes  
Bunks with industry-exclusive 300 lb. capacity each (37L)  
Smoke alarm  
Carbon monoxide detector

## OPTIONS

Power theater seating (N/A 37K)  
93 in. straight reclining sofa (37K)  
Freestanding table with 4 chairs  
12 cu. ft. gas/electric, 4-door refrigerator  
Combination washer/dryer (37K, 37L, 37RB & 37TS)  
Stackable washer/dryer (37HJ only)  
Canadian Shaw® TRAV'LER® satellite dish  
Winegard® TRAV'LER® satellite dish - DIRECTV®



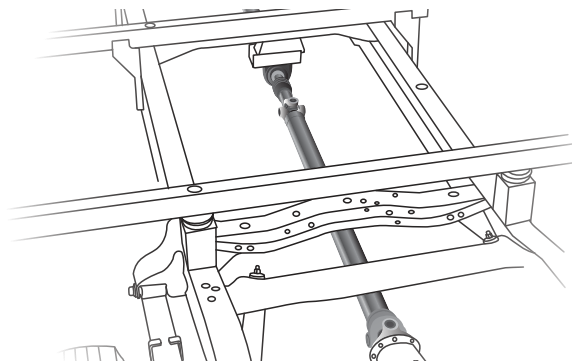

#### **COMPUTER-BALANCED DRIVESHAFT**

Ensures smooth and efficient power transfer to the wheels

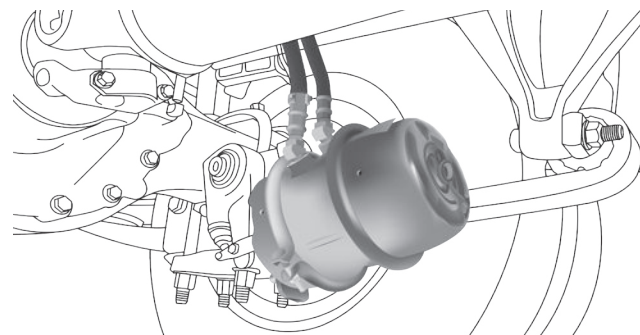

#### **FULL AIR BRAKES**

Deliver robust stopping power, even on grades

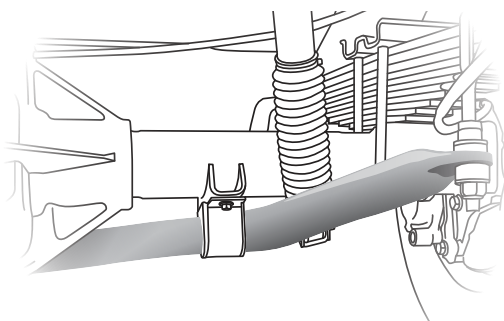

#### **HEAVY-DUTY REAR STABILIZER BAR**

A larger bar and polyurethane bushings, instead of rubber, transfer power faster for extra support, more stability and easier handling

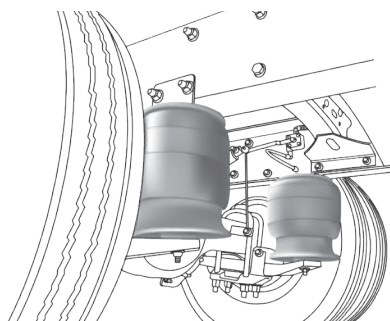

#### **REAR AIR SUSPENSION**

Softens ride and improves handling

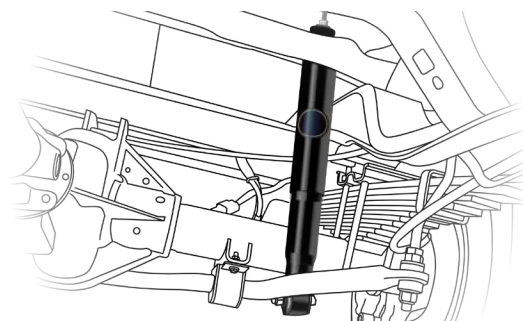

#### **SACHS SHOCK ABSORBERS**

Large-diameter tube design pairs gas and hydraulics to resist heat and pressure while independently adjusting to changing road conditions

## **RIDE & HANDLING. DEFINED.**

At Jayco, we believe the journey is just as important as the destination, which is why we engineered an industry-first Ride and Handling package - Jayco exclusive JRide®. Packed with ride-enhancing upgrades, get ready for a drive that'll move you.



# THE JAYCO DIFFERENCE



**2+3**  
YEAR YEAR  
WARRANTY

## 1 Jayco 2+3 Warranty

A quality warranty represents huge value. Of course it saves you money in case there's a manufacturer defect, but it also represents a lot more. The longer and more complete the warranty a manufacturer offers, the more confidence they have in their work - the higher quality product and more value you'll be taking home.

Jayco's warranty is the best in the RV business. The two-year limited warranty is twice as long as the industry standard, keeping you covered for two full camping seasons. Add to that the three-year limited structural warranty and you've got the most complete coverage, coverage that provides a peace of mind.



[Click here to learn more!](#)



## 2 STRONGHOLD VBL™ laminated walls

Jayco's exclusive STRONGHOLD VBL (vacuum-bond lamination) wall construction process uses vacuum bonding to combine laminated fiberglass with welded aluminum framing, metal backers, decorative interior wall panels, and fiberglass exterior siding. This super-durable structure is designed specifically for heavy use and travel while still reducing weight. Simply put, Jayco's Stronghold VBL construction lessens the chance of delamination and stands up to the elements longer.



[Click here to learn more!](#)



## 3 The JRide® ride and handling package

In a motorhome, the adventure does not begin and end at the campsite; the ride to and from camp is an important part of the journey, which is why comfort is a top priority at Jayco. Improving the journey is what inspired our exclusive JRide packages, which offer a powerful blend of precise handling and renowned stability. These important additions make your trip more comfortable without the need for expensive aftermarket upgrades.



[Click here to watch video](#)





Click here  
to watch video

#### 4 Safety belts in every designated seating location

Everyone would agree the most precious cargo is the loved ones you travel with. Jayco installs stress-tested seatbelts in every designated seating location to ensure the safety of your entire family. In a Jayco motorhome, you won't have to put anyone at risk due to limited safety belts.



#### 7 Third brake light and backup cameras

Backing up a motorhome is unlike backing up your everyday vehicle. It can be expensive, tricky and even impossible to retrofit some motorhomes with additional safety signals or rearview cameras. At Jayco, backup cameras and third brake lights are installed on each and every motorhome. These features allow you to navigate with ease, while helping deliver you to your camping destination safely.



Click here  
to learn more!

#### 10 Solar hookups, LED lighting

It's not only environmentally friendly, but solar hookups reduce the cost and load of electrical use in your RV at camp. More and more motorhomes are equipped with solar hookups or prepped for easy installation. LED lights are another energy saving option many RVs offer. Both solar prep and LED lights will be found on all Jayco motorhomes.

**750-lbs.**

Jayco's Overhead Bunk Capacity

**300-lbs.**

Jayco's Standard Bunk Capacity



Click here  
to watch video

#### 5 Unbeatable bunk ratings

Overhead bunks are a great way to add extra sleeping space without impacting the layout of a motorhome. Unfortunately, customers in competing coaches often have to be very careful about who sleeps in the overhead bunk, or what gear is stored there, due to weight limits of 350-500 lbs.

Jayco has designed our overhead bunks to hold 750 lbs.- this is 250 lbs. more than any of our competitors. In a Jayco overhead bunk, two adults can comfortably rest and relax, or you can safely read a book to your kids at night.

Jayco's superior bunk capacities extend beyond the overhead bunks, with a capacity of 300 lbs. in each standard bunk, as well.



Click here  
to watch video

#### 8 Towing Capabilities

The ability to tow a small trailer or vehicle is one of the top perks of owning a motorhome. While this is an important feature, not all manufacturers are created equal regarding towing capacities.

Jayco engineers motorhomes with a tongue capacity at ten percent of the tow capacity, which is the optimal ratio. In turn, this allows the customers to tow more, without the need for a weight distribution hitch.



#### 11 Strong Roof

Not only is a strong roof important because it's key to the overall structural integrity of a unit, but also for maintenance purposes. The roof may need some TLC throughout the camping season. The ability to safely walk on the roof to perform some simple cleaning and sealant maintenance, is a huge perk for Jayco owners. Not to mention how it can endure a surprisingly heavy snowfall or falling tree limb.



Click here  
to watch video

#### 6 One-piece, seamless front cap

The front cap of a motorhome bears the brunt of road travel. Seams along the front and sides of the front cap create ample opportunities for water intrusion, where rain and debris are hitting hardest during travel. A poorly built front cap can lead to unsightly wear and tear, as well as unwanted time in service bays.

Jayco's front cap sets the bar in the industry as the only one-piece seamless cap available. This industry-exclusive cap resists water damage from moisture and debris better than the competition, which reduces the chances of costly repairs and time off the road.



#### 9 Resale Value

Most RV owners will upgrade their rig at some point in their camping lifetime. The list of hidden value items discussed above improves the longevity of a Jayco, which increases resale value. Also, when establishing a trade-in value, motorhomes are valued by their base price only. Any optional equipment will not be included in this number. Jayco motorhomes come packed full of standard features, with very few items left to option in. By building desired options into the base price of the coach as standard features, rather than adding them as options, Jayco builds a higher resale value into their motorhomes. This leads to a better return on your hard-earned investment.

## WE GO TO GREAT LENGTHS TO BUILD BETTER RVs

You can count on our motorhomes - and our focus on family fun - to go the distance. So you can maximize every moment, no matter where the journey takes you. These are the extra steps we take to set our RVs apart.

# WHY YOUR LOCAL DEALER IS YOUR GREATEST ASSET



Before purchasing an RV of your own, you need to explore, touch and test drive one for yourself. From the sales experience to service after the sale, we consider our dealers to be an important part of the Jayco family. Establishing a strong relationship with your local Jayco dealer is a key factor in the enjoyment of your new unit for more than just the buying stage.



**Research:** The initial research that goes into choosing an RV can be overwhelming and with so many different options, how will you narrow it down? Having a local dealer who is knowledgeable and can answer all of the questions you will inevitably have as well as make helpful suggestions will make the buying experience a positive one. From towing weights and cargo capacity to living space and in-unit technology, your Jayco dealer will have all the information you need to make an informed decision and pick out the unit that fits your wants and needs.



**Sale:** Once you have decided which RV is right for you, signing the papers and picking up your new Jayco comes next; a huge step that should be an exciting and smooth process for you. The last thing you want when you're making this kind of commitment is to feel that you're being taken for a ride. It's comforting having someone behind you that ensures your needs are being met as the sale progresses. The luxury of your dealer walking you through each step will give you the peace of mind that all of your bases will be covered.



**Post-Sale:** After the sale, maintaining a strong relationship with your local dealer has tons of benefits that will come in handy. Most dealers offer after-sale service on your coach that will make it easier to get fixes or upgrades so you can spend less time waiting and more time exploring. Having them just a short drive from you is just an added bonus that will make your experience so convenient and enjoyable.

Whatever stage of RV ownership you find yourself in, your local Jayco dealer is your greatest advantage. Creating a lasting relationship with them will benefit you and your RVing experience for years to come. So go ahead, locate your nearest dealer and see what they can do for you!



[Click here  
to visit our  
dealer locator](#)