



Generations of family fun.

# JAY FEATHER



TRAVEL TRAILER

JAY FEATHER



LIGHTWEIGHT FEATURE-FRIENDLY SERIES

**2+3**  
YEAR | YEAR  
WARRANTY



# JAY FEATHER HYBRID



X23B Shown in Modern Farmhouse Interior Design



X23B Kitchen with Standard 3-Burner Cooktop and Glass Cover

## FLOORPLANS

Scan QR code to view 360° tours



**LEGEND**

- STORAGE
- MICRO MICROWAVE
- OHC OVERHEAD CABINETS
- FRIDGE REFRIGERATOR
- WARD WARDROBE

## SPECS

FLOORPLAN	EXTERIOR TRAVEL LENGTH	EXTERIOR WIDTH	EXTERIOR HEIGHT (WITH A/C)	INTERIOR HEIGHT	UNLOADED VEHICLE WEIGHT	DRY HITCH WEIGHT	GVWR	CARGO CARRYING CAPACITY	FRESH WATER CAPACITY (INCLUDING WATER HEATER)	GRAY WASTE WATER CAPACITY	BLACK WASTE WATER CAPACITY	SLEEPING CAPACITY
<b>X17Z</b>	TBD	TBD	TBD	TBD	TBD	TBD	TBD	TBD	TBD	TBD	TBD	6-7
<b>X19H</b>	20' 10"	8' 0"	10' 4"	6' 6"	3,910	375	4,950	1,040	48	30.5	22.5	6-7
<b>X23B</b>	24' 7"	8' 0"	10' 4"	6' 6"	4,490	490	5,500	1,010	48	30.5	22.5	6-7
<b>X23E</b>	26' 10"	8' 0"	10' 9"	6' 6"	5,235	620	6,150	915	48	30.5	30.5	8-9

Some specs at the time of print may include estimates. For the most updated information, please visit [Jayco.com](http://Jayco.com).

# JAY FEATHER MICRO



166FBS Shown in Vintage Washed Gray Interior Design



12SRK Exterior Kitchen with Blackstone® Griddle

## FLOORPLANS

Scan QR code to view 360° tours



12SRK



166FBS



171BH



173MRB



199MBS



Ext. Lgth: 13' 4"  
Weight: 1,585 lbs.  
Hitch: 180 lbs.



Ext. Lgth: 19' 8"  
Weight: 4,035 lbs.  
Hitch: 480 lbs.



Ext. Lgth: 20' 2"  
Weight: 3,865 lbs.  
Hitch: 405 lbs.



Ext. Lgth: TBD  
Weight: TBD  
Hitch: TBD



Ext. Lgth: TBD  
Weight: TBD  
Hitch: TBD

## SPECS

Scan QR code for specification definitions



FLOORPLAN	EXTERIOR TRAVEL LENGTH	EXTERIOR WIDTH	EXTERIOR HEIGHT (WITH A/C)	INTERIOR HEIGHT	UNLOADED VEHICLE WEIGHT	DRY HITCH WEIGHT	GVWR	CARGO CARRYING CAPACITY	FRESH WATER CAPACITY (INCLUDING WATER HEATER)	GRAY WASTE WATER CAPACITY	BLACK WASTE WATER CAPACITY	SLEEPING CAPACITY
12SRK	13' 4"	6' 8"	7' 10"	4' 7"	1,585	180	2,795	1,210	25.5	N/A	N/A	2
166FBS	19' 8"	8' 4"	10' 4"	6' 6"	4,035	480	4,995	960	61	30	30	3-4
171BH	20' 2"	8' 4"	10' 4"	6' 6"	3,865	405	4,995	1,130	61	30.5	30.5	4-5
173MRB	TBD	TBD	TBD	TBD	TBD	TBD	TBD	TBD	TBD	TBD	TBD	2-4
199MBS	TBD	TBD	TBD	TBD	TBD	TBD	TBD	TBD	TBD	TBD	TBD	5-8

Some specs at the time of print may include estimates. For the most updated information, please visit Jayco.com.

# STANDARDS & OPTIONS

## STANDARD EXTERIOR EQUIPMENT

	Hybrid	Micro	12SRK	TT
Aerodynamic, rounded front profile with diamond plate	X	X	X	X
Modern retro graphics package with two-colored sidewall	X	X	X	X
Stronghold VBL™ vacuum-bonded, laminated floor & walls	X			X
Stronghold VBL™ vacuum-bonded, laminated composite floor & walls		X		
Vacuum-bonded, laminated bed platforms with reverse-cambered support (1,100 lb. capacity) (all hybrids)	X			
Keyed-Alike™ lock system (includes all tent latches)	X	X	X	X
Magnum Truss™ Roof System with one-piece seamless DiFlex II material	X	X		X
American-made Norco® frame with integrated A-frame	X	X	X	X
American-made Dexter® E-Z Lube® axles (rubber torsion on the Micro series)	X	X	X	X
Single axle (X17Z hybrid & Micro series)	X	X	X	
Dual axles (N/A X17Z hybrid)	X			X
G20 tinted safety-glass windows	X	X	X	X
Marine-grade exterior speakers with blue LED accent lighting (2)	X	X		X
Galvanized steel and impact-resistant wheel wells	X	X	X	X
30-amp service	X	X	X	X
Outside grill propane quick-connect port	X	X	X	X
Water-repellent, scratch resistant Jayco DuraTek™ vinyl tent material with zipper windows (all hybrids)	X			
Permanently attached tent-to-bed base design (all hybrids)	X			
Aluminum tread entry steps	X	X	X	X
Outside camp kitchen (standard on select models)			X	X
Battery quick disconnect		X	X	X
Slide topper prep (select models with slide rooms)	X	X		X
Exterior TV prep with 120V electric and cable outlets	X	X		X

## STANDARD INTERIOR EQUIPMENT

	Hybrid	Micro	12SRK	TT
Choice of two interior design packages - Modern Farmhouse or Vintage Washed Gray	X	X	X	X
Retractable futon sofa			X	
LED lighting throughout	X	X	X	X
Smoked glass decorative inserts (select overhead cabinets)	X	X		X
Screwed and glued cabinetry	X	X	X	X
Residential vinyl flooring with cold crack resistance	X	X	X	X
Decorative wall clock (select models)	X			X
Plywood dinette, bunk and bed bases (applicable models)	X	X		X
Ball-bearing drawer guides with 75 lb. capacity	X	X		X
6 cu. ft. gas/electric refrigerator	X	X		X
Residential oven with 3-burner recessed cooktop and glass cover	X			X
3-burner recessed cooktop with glass cover		X		
Residential-style kitchen countertops	X	X		X
Microwave	X	X		X
Decorative backslash	X	X		X
4 in. high-density dinette cushions with vinyl backing	X	X		X
Jayco exclusive Teddy Bear "soft-touch" residential-style bed mats (select models)	X	X		X
120V outlet and corner shelf in fixed bunks (bunk models only)		X		X
Plastic foot flush toilet	X	X		X
Bathroom skylight and roof vent	X	X		X

## CUSTOMER VALUE PACKAGE (MANDATORY)

	Hybrid	Micro	12SRK	TT
American-made nitro-filled Goodyear® radial tires	CVP		CVP	CVP
Self-adjusting electric brakes	CVP		CVP	CVP
Rubber torsion axle			CVP	
Aluminum rims	CVP	CVP	CVP	CVP
2 - 20 lb. propane bottles with auto regulator	CVP	CVP		CVP
1 - 20 lb. propane bottle with auto regulator			CVP	
13,500 BTU A/C	CVP	CVP		CVP
Spare tire	CVP	CVP	CVP	CVP
Detachable power cord	CVP	CVP	CVP	CVP
Power awning with LED lights	CVP	CVP		CVP
Power tongue jack	CVP	CVP	CVP	CVP
Black tank flush	CVP	CVP		CVP
Outside shower	CVP	CVP		CVP
Outside spray port			CVP	
Manual stabilizer jacks (4)	CVP	CVP		CVP
6 gal. gas/electric DSI water heater	CVP	CVP		CVP
32" 12V LED TV w/built-in soundbar with AM/FM/Bluetooth®			CVP	
AM/FM/Bluetooth® stereo	CVP			CVP
Side-marker camera prep	CVP	CVP	CVP	CVP
Rear camera backup prep	CVP	CVP	CVP	CVP
360° Siphon® roof vent cap	CVP	CVP		CVP
Enclosed underbelly	CVP			
Enclosed underbelly with insulation			CVP	
Power roof vent (in main living area)	CVP	CVP		CVP
Roof-mount solar prep	CVP		CVP	
Inverter pre-wire	CVP		CVP	CVP
JaySMART™ (Safety Markers And Reverse Travel) LED lighting (patent-pending)	CVP		CVP	
Drying rack - sink cover combo for dual bowl sink	CVP			
12V/120V Dometic® cooler			CVP	
17 in. Blackstone® griddle		CVP	CVP	
25 gal. fresh water tank			CVP	

## SPORT PACKAGE (MANDATORY)

	Hybrid	Micro	12SRK	TT
Roof ladder				SP
Aluminum tread entry steps				SP
Enhanced graphics package				SP
Front molded fiberglass cap				SP
JaySMART™ (Safety Markers And Reverse Travel) LED lighting (patent-pending)				SP
Roof-mount solar prep				SP
Glacier Package includes enclosed underbelly				SP
24 in. , 32 in. or 40 in. LED TV				SP
Drying rack/ sink cover				SP
Power roof vent (main living area)				SP

## JAY PRO PACKAGE (MANDATORY - (JAY FEATHER MICRO SERIES ONLY) (N/A 12SRK))

	Hybrid	Micro	12SRK	TT
16 in. Goodyear® off-road tires			JP	
Rubber torsion axle			JP	
Glacier Package includes enclosed underbelly			JP	
Roof-mount solar prep			JP	
Inverter pre-wire			JP	
JaySMART™ (Safety Markers And Reverse Travel) LED lighting (patent-pending)			JP	
6 cu. ft. gas/electric refrigerator			JP	
12V LED TV			JP	

## OPTIONS

	Hybrid	Micro	12SRK	TT
12V heated tank pads	0	0		0
15,000 BTU roof-mounted A/C	0	0		0
50-amp service with 2nd A/C prep (select models)				0
2 - 30 lb. propane bottles with auto regulator (select models)		0		0
1 - 30 lb. propane bottle with auto regulator (select models)			0	
MORryde® StepAbove™ aluminum entry steps on main door (standard 16RK, 22RB, 24BH and all Micro series models)				0
Accessory roof rack system		0	0	
8 cu. ft. 12V refrigerator	0	0		0
24 in. LED TV (select models)	0			
32 in. LED TV (select models)	0			
New JAYCOMMAND® "Smart RV" system (includes TPMS)		0		0
Tri-fold sofa with table trays (select models)				0
Heated bunk mats (2 for X17Z, X19H, X23B; 3 for X23E)	0			
Theater seating (select models)				0
U-dinette in place of theater seating (16RK)				0
L-lounger sofa in place of U-dinette (22RB, 24BH & 30QB)				0
Booth dinette in place of theater seating (22RK)				0
Convection microwave		0		
Solar Power Package	0	0		0
17" Blackstone® griddle	0			0
2-bike storage rack		0		0
Side-mount 8,000 BTU A/C				0
Thule® awning				0

X - Standard    0 - Optional    CVP - Customer Value Package  
 SP - Sport Package    JP - Jay Pro Package



# JAY FEATHER



27BHB Shown in Modern Farmhouse Interior Design



22RB Shown in Vintage Washed Gray Interior Design

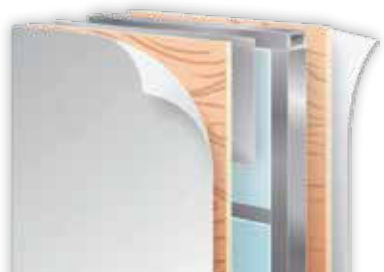

**STRONGHOLD VBL™**  
ALUMINUM-FRAMED VACUUM BOND LAMINATION

16 MIN 144 TONS



Jayco's exclusive laminated wall construction process



MADE IN USA

Featuring Durawall®  
Technology - ENGINEERED  
to help you tow with confidence



**50 percent Stronger**  
4,500 lbs. on a Jayco roof  
vs. other roofs



Jayco's roof **vs.** other roofs



Safety Markers And Reverse Travel

**JaySMART™ Lighting**

LED light system, which provides 360 degrees of driver intentionality



Jayco's exclusive, patent-pending JaySMART lighting system more clearly indicates braking, reverse travel and turn signals to others on the road or at camp.

# FLOORPLANS

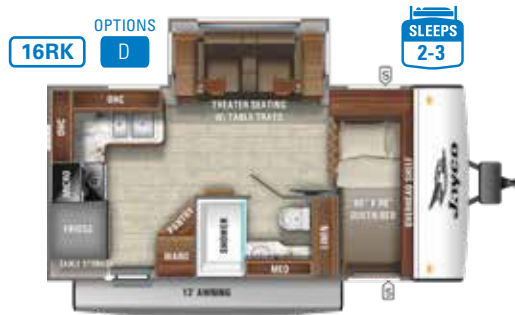

Ext. Lgth: **22' 4"** Weight: **4,755 lbs.** Hitch: **465 lbs.**



Ext. Lgth: **24' 2"** Weight: **4,625 lbs.** Hitch: **495 lbs.**



Ext. Lgth: **27' 9"** Weight: **5,655 lbs.** Hitch: **660 lbs.**



Ext. Lgth: **27' 10"** Weight: **5,490 lbs.** Hitch: **530 lbs.**



Ext. Lgth: **28' 7"** Weight: **5,360 lbs.** Hitch: **650 lbs.**



Ext. Lgth: **30' 2"** Weight: **6,220 lbs.** Hitch: **660 lbs.**



Ext. Lgth: **30' 7"** Weight: **5,850 lbs.** Hitch: **630 lbs.**



Ext. Lgth: **31' 8"** Weight: **6,030 lbs.** Hitch: **730 lbs.**





Ext. Lgth: **33' 1"** Weight: **6,300 lbs.** Hitch: **695 lbs.**



Ext. Lgth: **36' 11"** Weight: **7,295 lbs.** Hitch: **835 lbs.**

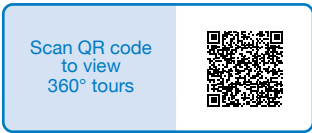

**LEGEND**

- STORAGE
- MICRO MICROWAVE
- OHC OVERHEAD CABINETS
- FRIDGE REFRIGERATOR
- WARD WARDROBE

**OPTIONS**

A

B

C

D

E

F

# SPECS

Scan QR code for specification definitions



FLOORPLAN	EXTERIOR TRAVEL LENGTH	EXTERIOR WIDTH	EXTERIOR HEIGHT (WITH A/C)	INTERIOR HEIGHT	UNLOADED VEHICLE WEIGHT	DRY HITCH WEIGHT	GVWR	CARGO CARRYING CAPACITY	FRESH WATER CAPACITY (INCLUDING WATER HEATER)	GRAY WASTE WATER CAPACITY	BLACK WASTE WATER CAPACITY	SLEEPING CAPACITY
16RK	22' 4"	8' 0"	10' 8"	6' 6"	4,755	465	6,000	1,245	48	30.5	30.5	2-3
X213	24' 2"	8' 0"	10' 8"	6' 6"	4,625	495	5,500	875	48	30.5	22.5	6-9
22RB	27' 9"	8' 0"	10' 8"	6' 6"	5,655	660	6,750	1,095	48	61*	22.5	2-3
22RK	27' 10"	8' 0"	10' 8"	6' 6"	5,490	530	6,750	1,260	48	61*	30.5	2
24RL	28' 7"	8' 0"	10' 8"	6' 6"	5,360	650	6,500	1,140	48	30.5	30.5	4-6
24BH	30' 2"	8' 0"	10' 8"	6' 6"	6,220	660	7,250	1,030	48	61*	30.5	7-8
25RB	30' 7"	8' 0"	10' 8"	6' 6"	5,850	630	7,000	1,150	48	61*	30.5	4-6
27RL	31' 8"	8' 0"	10' 8"	6' 6"	6,030	730	7,000	970	48	30.5	30.5	4-6
27BHB	33' 1"	8' 0"	10' 8"	6' 6"	6,300	695	7,600	1,300	48	61*	30.5	8-9
30QB	36' 11"	8' 0"	10' 8"	6' 6"	7,295	835	8,500	1,205	48	61*	30.5	8-9

Some specs at the time of print may include estimates. For the most updated information, please visit [Jayco.com](http://Jayco.com).

\*Indicates split tanks

Two **Unique & Beautiful** Concepts



Scan QR code to view Interior Design

# True interior design. More choice. Mindful craftsmanship.

Every fixture, fabric and feature has been carefully selected and expertly installed. The result is an aesthetic that's extraordinary — with Jayco's famous high level of livability. Designer-selected patterns and fabrics enhance the overall look and feel, while unique furniture designs and contrasting hand-picked hardware and lighting enhance each exclusive decor package.

## MODERN FARMHOUSE



WOOD



MAIN FABRIC



ACCENT FABRIC



FLOOR



COUNTERTOP

## VINTAGE WASHED GRAY

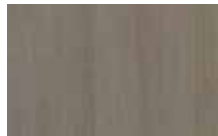

WOOD



MAIN FABRIC



ACCENT FABRIC



FLOOR



COUNTERTOP



Jayco, Inc. | P.O. Box 460 | Middlebury, IN 46540

See dealer for further information and prices. All information in this brochure and on [www.jayco.com](http://www.jayco.com) is the latest available at the time of publication approval. Jayco reserves the right to make changes and to discontinue models without notice or obligation. Photography may show optional equipment or props used for decoration purposes only. RVs built for sale in Canada may differ to conform to Canadian codes. JAYCO and the JAYCO BIRD IN FLIGHT are registered trademarks of Jayco, Inc. Printed in USA 11/20 ©2020 Jayco, Inc.

# 2+3

YEAR LIMITED | YEAR STRUCTURAL  
**WARRANTY**

## Travel With Confidence

### NO ONE OFFERS A BETTER WARRANTY

At Jayco, we build our RVs to handle every adventure, then back them with our industry-leading 2+3 limited warranty. Our 2-year limited warranty has you covered for 2 camping seasons. That's 730 days. In addition, our 3-year structural limited warranty has you covered for 3 camping seasons or 1,095 days. You won't find a better limited warranty in the business, because the only strings that we attach are those that deliver the ultimate in reliability. That's the Jayco difference. So go explore. For a copy of our 2-year limited + 3-year structural limited warranty with complete terms and conditions, please contact your local Jayco dealer.

# JAYCOMMAND<sup>®</sup>

The JAYCOMMAND<sup>®</sup> system puts RVers in full control of their unit. The system was custom-built by our product development teams so that **owners can monitor and control key RV operations from a phone or a tablet.** (JAYCOMMAND<sup>®</sup> is optional on select Jay Feather products).

From the sales experience to service after the sale, we consider our dealers to be an important part of the Jayco family. Establishing a solid relationship with your local Jayco dealer is a key component in the enjoyment of your new Jayco. By purchasing from a local dealer, you will have a convenient location for sales, parts and service support. We hope you consider them a part of your camping family.

Meet your Jayco Dealer \_\_\_\_\_

Follow Jayco  
#LetsJayco

