

1995
JAYCO
DESIGNER SERIES™
TRAVEL
TRAILERS &
FIFTH WHEELS



WELCOME HOME



THE 1995 DESIGNER SERIES™: THE LUXURY YOU EXPECT... UNEXPECTEDLY AFFORDABLE!

Designer Series travel trailers and fifth wheels have the look, the “feel,” the warm, home-like atmosphere most RVers associate with the finest luxury RVs. And for good reason: They *are* luxurious!

What sets the Designer Series apart, however, is its *value*. All its style, all its comforts are yours for a price thousands of dollars *below* that of other, similarly “upscale” RVs. Result: You needn't empty your wallet to fill your life with the features you see on the following pages.

On the Cover: Designer Series 2600 FS Travel Trailer, top, and Designer Series 3030 RK Fifth Wheel, with Optional Fiberglass Sidewalls

▼ Designer Series 2600 FS Travel Trailer, Teal Decor





▲ Designer Series 3030 RK Fifth Wheel, Brown Decor



Designer Series Luxury Upgrades:

- ▶ Exquisite professionally designed interiors
- ▶ Solid-oak cabinet doors and drawers with raised front panels
- ▶ Elegant high-line designer fabrics
- ▶ Window treatments with padded valances, strong metal mini blinds and color-coordinated drapes with tie-backs
- ▶ A decor-enhancing chair rail of solid oak
- ▶ Fashionable, practical countertops edged with rich oak inlays

Continued on Page 4 ...

◀ Kitchen, Designer Series 3420 FK SS Travel Trailer



▲ Optional Sidewalls of Smooth, High-gloss Fiberglass shown on Designer Series 3030 RK Fifth Wheel, right. Standard Aluminum Sidewalls shown on Designer Series 3420 FK SS Travel Trailer

...Continued from Page 3

- ▶ An entertainment center with a standard overhead cabinet in most models
- ▶ Tight-gripping, spring-loaded roller catches on all cabinets
- ▶ Thoughtful, strategically placed nightlights
- ▶ A decorator clock
- ▶ Access doors to a storage area under the dinette seating
- ▶ A systems monitor panel on the range hood
- ▶ A decor-coordinated oak door front on the refrigerator
- ▶ Bathroom hardware with a bright, warm, brass-like finish
- ▶ An easy-to-clean ABS tub surround
- ▶ A fashionable pleated shower door in most models
- ▶ A padded headboard on travel trailer beds
- ▶ A fine, quilted, designer bedspread with a matching pillow sham and two matching throw cushions
- ▶ Exterior end caps of attractive, durable molded fiberglass
- ▶ A fiberglass front stoneguard (on travel trailers) — recessed for a sleek appearance

- ▶ Sidewalls radius-wrapped along the bottom and the top for a more “finished,” aerodynamic look
- ▶ An aluminum-covered bumper

Other Notable Standard Features:

In addition to the luxury upgrades described above, Designer Series travel trailers and fifth wheels offer these superb, travel-enhancing standards...



▲ A Garden Tub is standard in several models, including the 3420 FK SS Travel Trailer shown here

Two Corner Wardrobes are standard in all Fifth Wheel bedrooms.
▼ Shown here in 3030 RK, Brown Decor





Clockwise from top: Blue, Teal, Brown, Clay

- ▶ Space-adding slide-out sections — standard in select models; optional in most — including the option of Jayco's huge SuperSlides in many models
- ▶ A Jayco-made J-steel convertible sofa that has comfy layered-foam cushioning and a hinged front for access to a storage area underneath
- ▶ Drawer sides of real wood, not particle board
- ▶ A three-burner range with a 9000 BTU high-output front burner and an oversized built-in oven
- ▶ In-floor ducted heating
- ▶ An oak cutting board
- ▶ A walk-around queen bed that lifts up easily on piston supports to expose a large storage area underneath
- ▶ An innerspring mattress
- ▶ Two bedroom-corner wardrobes in fifth-wheel models; shirt closets in most travel trailers
- ▶ A convenient flip-up TV shelf in most bedrooms
- ▶ A water-heater bypass that simplifies winterizations; saves time and money
- ▶ A water-system winterization kit

CONSTRUCTION

With these features, we ensure that your Designer Series travel trailer or fifth wheel will provide pleasure mile after mile, year after year:

- 1) A heavy-gauge, 6" steel-tube frame (a 12" frame on SuperSlide models).
- 2) Heavy-duty steel outriggers for total wall-to-wall floor support.
- 3) A 2x3 longitudinal floor system —
- front and rear end caps.
- 9) A heavy-duty aluminum outer skin — thicker at mid- and lower-wall (.024" compared to .019" at the top), so it's more dent-and-scratch-resistant where it's most likely to need that extra protection.
- 10) An incredibly strong plywood floor with durable tongue-and-groove seams.
- 11) Strong 2x4 roof rafters, tapered to provide a slope for proper water runoff.
- 12) Superior fiberglass insulation cut and glued between the studs throughout — stays put, eliminates uninsulated spots, retains high insulation value, and helps make Designer Series RVs ideal for year-round use.

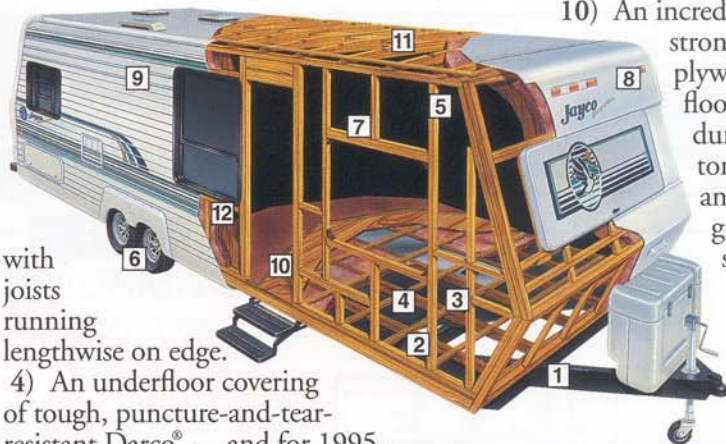

with joists running lengthwise on edge.

- 4) An underfloor covering of tough, puncture-and-tear-resistant Darco® — and for 1995, we've added the option of a fully enclosed aluminum underbelly.
- 5) Walls with 2x2 studs on 16" centers for greater strength and rigidity.
- 6) Insulated wheel wells of galvanized steel for strength and rust-resistance.
- 7) 2x3s across the tops of all windows for extra reinforcement.
- 8) One-piece, molded-fiberglass

Optional sidewalls of smooth, high-gloss fiberglass give the exterior an even more refined look. For maximum strength, the fiberglass is laminated to luan and attached to studs with high-bond adhesive.

DESIGNER SERIES TRAVEL TRAILERS

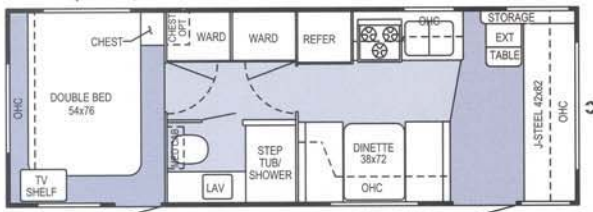

2600 FS

Options A, B, E, H

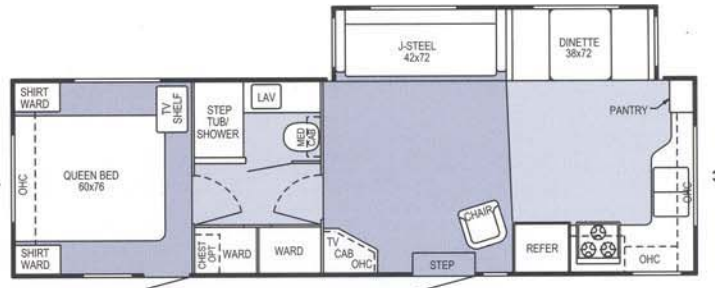

3120 FK SS

Options C, E, I

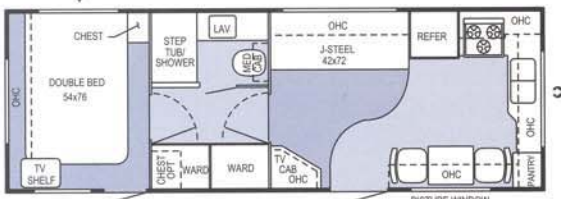

2620 FK

Options A, B, I

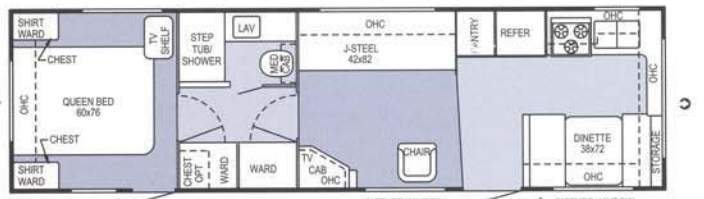

3220 FK

Options C, E, I

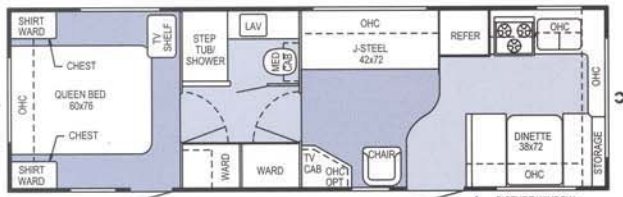

3020 FK

Options C, E, I



3420 FK SS

Option E



3100 FS SS

Options C, E

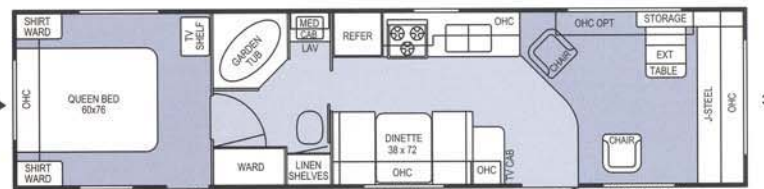

3500 FS

Options D, E, F

KEY TO TRAVEL TRAILER FLOOR PLAN CODES

FS = Front Sofa
FK = Front Kitchen

SS = SuperSlide
☞ = Front

▶ = Outside Storage
Compartment

DESIGNER SERIES FIFTH WHEELS

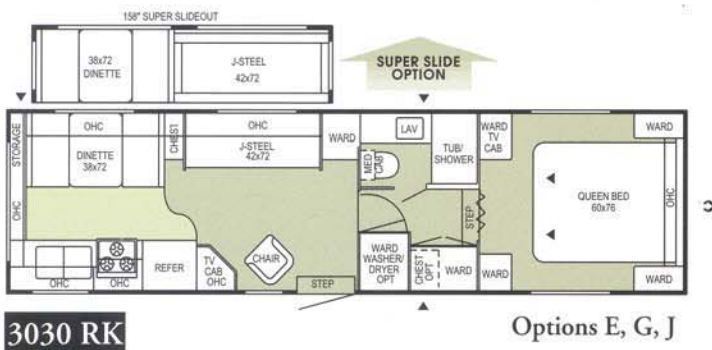
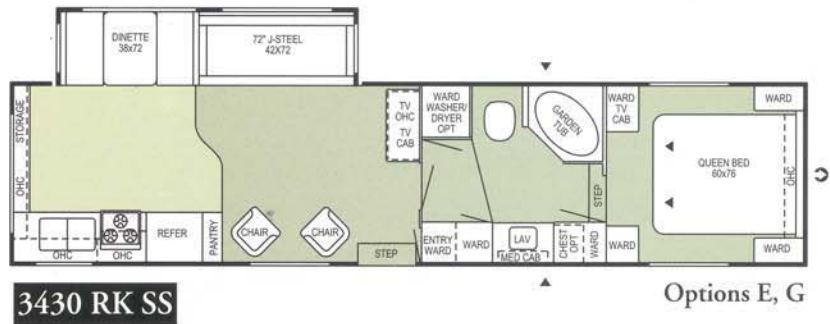
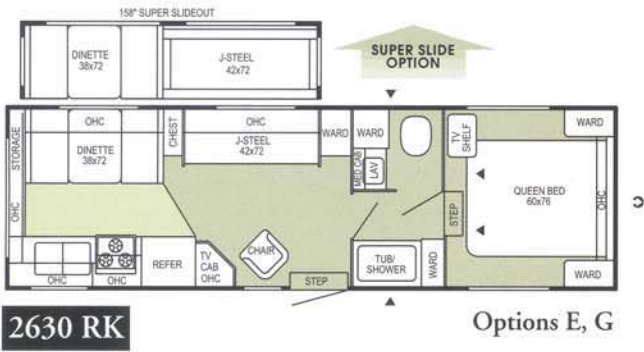

KEY TO FIFTH WHEEL FLOOR PLAN CODES

- RK = Rear Kitchen
- RB = Rear Bathroom
- RLR = Rear Living Room
- SS = SuperSlide
- = Optional SuperSlide
- = Front
- = Outside Storage Compartment

OPTIONAL ARRANGEMENTS

SEE CODES UNDER FLOOR PLANS

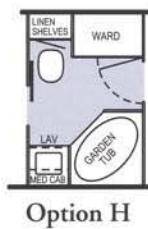
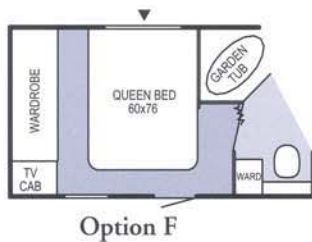
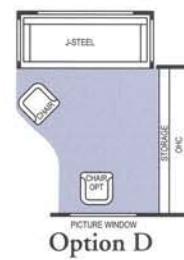
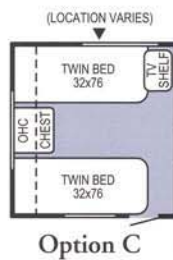
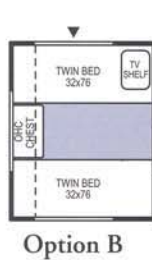
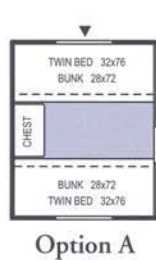

COMPLETE STANDARD FEATURES

Heat, Power, and Water: single battery; city water hookup; 12-volt demand water pump; ducted in-floor heat; 12-volt electric system with 110-volt converter; 110-volt exterior receptacle; systems monitor panel; 30-amp power cord; hot-water heater (LP gas).

Exterior: drain-hose carrier bumper; aluminum bumper cover; gas-bottle cover (travel trailers); white, radius-cornered entrance door; entrance-door dead-bolt lock; front stone-guard window awning (travel trailers only); 12-volt hitch light; 12-volt patio light; radius-cornered jalousie windows; crank-up TV antenna; stabilizer jacks (std. with slide-out); recessed tail lights; recessed water fill.

Living Room: carpet and pad; drapes and valances; mini blinds; framed picture (most models); decorator clock; solid-oak doors and drawer fronts; stile-constructed cabinets; J-steel sofa; courtesy night-lights.

Kitchen: porcelain double sink; flush-mounted double-door refrigerator; high-output three-burner range with oven; range hood with power vent and light; bi-fold stove cover; sink-cover cutting board; divided wooden cutlery drawer.

Bedroom: carpet and pad; designer bedspread; padded headboard (travel trailers only); innerspring mattress; easy-lift bed struts; TV cabinet or flip-up TV shelf.

Bathroom: medicine cabinet with mirror; 12-volt power vent; tub or tub-shower surround; pleated shower door.

COMPLETE OPTIONS

Heat, Power, and Water: ceiling-ducted air-conditioner (13,500 BTU); second battery; dual-battery box (fifth wheels only); outside shower; gas-electric hot-water heater; gas auto-ignition hot-water heater; gas-electric auto-ignition hot-water heater; Fome-Cor® insulation (not available with fiberglass sidewalls); 4KW generator (some fifth wheels); generator prep (some fifth wheels).

Exterior: patio awning; rubber roof; shock absorbers; fiberglass exterior sidewalls; fully enclosed underbelly; insulated holding tanks; rear-window stone-guard awning; spare tire and wheel; spare-tire carrier; vinyl spare-tire cover; stabilizer jacks; electric front jacks (fifth wheels only); front "snap-jacks" (fifth wheels only); safety glass and tinted windows.

Living Room: pleated window shades; stereo AM/FM radio-cassette player; cable TV hookup; telephone jack.

Kitchen: ice-maker inside refrigerator; microwave oven; solid-oak free-standing table & chairs.

Bathroom: skylight over tub; washer-dryer combo (some fifth wheels); washer-dryer prep (some fifth wheels).

SPECIFICATIONS

	MODELS												
	Exterior length	Exterior height	Interior headroom-bedroom	Approx. dry axle weight with std. equipment (lbs.)	Approx. dry hitch weight (lbs.)	Gross Vehicle Weight Rating (lbs.)	Approx. weight opt. slide out (lbs.)	Approx. weight fiberglass ext. option	Fresh water tank (gals.)	Gray water holding tank (gals.)	Toilet w/waste holding tank (gals.)	Sleeping capacity	
TRAVEL TRAILERS	2600 FS	28' 10"	109"	77"	4355	880	7500	N/A	390	36	29	36	4-8
	2620 FK	27' 11"	109"	77"	4465	880	7500	N/A	390	36	29	36	3-6
	3020 FK	30' 6"	109"	77"	4600	945	7800	N/A	460	36	29	36	4-6
	3100 FSSS	30' 11"	119"	77"	5970	970	9500	STD	480	36	43	36	4-7
	3120 FKSS	31' 11"	119"	77"	6345	970	9500	STD	480	36	58	36	4-6
	3220 FK	32' 10"	109"	77"	4840	910	9000	N/A	500	36	29	36	4-6
	3420 FKSS	34' 10"	119"	77"	6035	1165	9700	STD	530	36	64	42	4-6
	3500 FS	36' 5"	110"	77"	5310	925	9400	450	550	46	29	36	4-6
FIFTH WHEELS	2630 RK	28' 3"	132"	63"	5015	1200	9700	845	460	50	63	33	6
	2770 RBSS	29' 1"	131"	62"	5595	1600	10200	STD	480	50	43	43	6
	3030 RK	30' 8"	134"	72"	5070	1665	10700	845	530	50	70	37	6
	3210 RLR	33' 1"	134"	72"	5155	1750	10700	845	560	50	37	37	6
	3430 RKSS	36' 4"	134"	72"	6720	1710	11600	STD	600	50	70	37	6

N/A = Not Available

STD = Standard Feature

For Further Information and Prices, See:



LIMITED WARRANTY

Jayco recreation vehicles are warranted to the original owner for twelve (12) months from the date of purchase against defects in materials and workmanship. There are certain exclusions to this limited warranty; details of which are available at your Jayco dealership.

PLEASE NOTE

All information in this brochure is the latest available at the time of publication approval. Jayco reserves the right to make changes and to discontinue models without notice or obligation. Pictures in this brochure may show optional equipment. RVs built for sale in Canada may differ to conform to Canadian codes.



Printed Entirely on Recycled Paper

Welcome Home



Jayco®

Jayco, Inc.
P.O. Box 460
Middlebury, IN 46540