

1994 JAY SERIES™ TRAVEL TRAILERS & 5TH WHEELS

W E L C O M E H O M E

JAYCO



Jayco

WELCOME HOME ... to luxurious travel living, without the luxury price tag!

And make no mistake: Jayco's Jay Series models are, indeed, luxurious. Their features are those most people associate with much more expensive travel trailers and fifth wheels: Their styling is genuinely "upscale"; their comfort unmatched; their floor plans spacious and thoughtfully conceived.

Yet Jayco, with its quarter-century-plus of manufacturing expertise, has found a way to offer all this luxury at a truly competitive price; one that won't break the bank!

That makes the Jay Series a genuine "*best-built value*". Just look at all it gives you for your money. And pay particular attention to the specially marked features on the following pages. They're the kind of luxuries that set the Jay Series far apart from other, so-called "value" RVs; the kind of luxuries that make a Jay Series the perfect home away from home — for freedom-loving families like yours.



3000 FK Travel Trailer, Blue Décor





3050 RK-SS Fifth Wheel with Optional SuperSlide, Teal Décor



Large Outside Storage Compartments



Optional Combination Washer-Dryer



New! Extremely Quiet 110-volt to 12-volt Deluxe Electric Converter. Makes lights shine 25% brighter; improves smooth operation of electric slideout sections; operates all 12-volt motors (such as those controlling vent fans) more efficiently.





EXTERIORS WITH LOTS OF "CURB APPEAL" ...

- ↳ Smooth, sleek molded-fiberglass front and rear caps
- A molded-fiberglass stoneguard on travel trailers — recessed into the cap for a neater appearance
- ↳ Radiused exterior corners on the front, back, and roof, and at the bottom of the sidewalls

- ↳ Stylish, contemporary outside storage compartment doors — featuring radius corners and white trim that matches the exterior sidewalls
- A recessed water fill
- Recessed automotive tail lights
- ↳ A chrome bumper cover
- Spoked, high-end wheels and whitewall radial tires
- A radius-cornered entrance door with a dead-bolt lock

SO MUCH COMFORT AND PRACTICALITY BUILT RIGHT IN ...

- All models eight feet wide — permitting especially generous living quarters
- The availability of space-adding, optional slideouts, including — in several models — Jayco's huge SuperSlides
- ↳ Interiors that rival many so-called "high-line" RVs — in the richness and elegance of their design, the quality of their materials, the craftsmanship and detailing of their furnishings
- ↳ Abundant storage space throughout; primarily contained in warm, rich cabinetry — custom-built by Jayco for Jayco — with solid oak doors and drawers, handsome raised panels, gleaming brass hardware, sturdy, stile-constructed cabinet fronts
- ↳ An overhead cabinet with mirrored doors — above the entertainment center in most models
- ↳ Oak chair rails
- ↳ A beveled oak edge on the kitchen countertops
- ↳ Appealing window treatments throughout, featuring decor-coordinated fabric valances, drapes with tie-backs, and fashionable mini blinds
- ↳ Extra-long J-steel sofas — up to 82 inches in many models — with plump, attractive bolster cushions
- Plush, durable padded



Kitchen, 3050 RK Fifth Wheel

Optional Central Air Conditioning

- Dual 30-pound LP-gas tanks with an automatic changeover regulator, and, in Jay Series travel trailers, a deluxe ABS bottle cover for a more unified exterior look
- A crank-up TV antenna
- A 12-volt hitch light for fast, easy hookups or unhooking at night



↳ Features with this symbol are deluxe amenities that you won't find on most low-priced trailers

Solid Oak Freestanding Table with Chairs — an attractive option in many models

High-output Three-burner Range heats up faster; cooks more efficiently





Brown

carpeting in the living room and bedroom areas

- A large-capacity, double-door, flush-mounted refrigerator with an oak front — to match the cabinet doors

- A high-output three-burner range — attractively finished in black and featuring an oversized built-in oven, a bi-fold stove-top cover, and a range hood with a power vent, a light, and a Systems Monitor Panel

- A double porcelain sink
- A sink-cover cutting board
- A 12-volt power roof vent in the bathroom

- A good-looking tub or tub-and-shower surround of molded ABS, which is especially easy to clean

- An elegant, roomy garden tub — either standard or optional depending on the model

- Bathroom fixtures with the look of polished brass (towel ring, towel bar, faucets)

- A large medicine cabinet with a mirror — in most models
- A queen or double bed with extra storage space underneath

- (in most models) — accessed by raising the bed on piston supports
- A comfortable innerspring mattress
- A quilted designer bedspread, custom-made by Jayco
- Custom-padded headboards — standard in Jay Series travel trailers
- Plenty of appealing “little” touches — like two or three floor-level nightlights (depending on the model), a flip-up TV shelf in most bedrooms, and, in Jay Series travel trailers, a double entrance step, standard
- Central air conditioning — available on all models

- Heated holding tanks — to help prevent freezing
- A generator — available for most Jay Series fifth wheels
- A European-style combination washer-dryer — available as an option in some models (see floor plans)
- A dual battery box for fifth wheels
- A telephone jack
- Cable TV hookup

See the complete list of optional features on page 5.



Big, Roomy Triple Wardrobes in some models



Wardrobes are featured on both sides in most walk-around bed models.

SERIOUS OPTIONS FOR THE SERIOUS RVer ...

- Excellent amenities for snowbirds, full-timers, or frequent travelers; permit long-term or year-round travel in virtually any climate — without adding a lot of expense
- 1/4" Fome-Cor® board insulation — a complete wrap in all four walls, the ceiling, and the floor



Bedroom, 3000 FK Travel Trailer, Blue Decor



Bathroom, 3050 RK Fifth Wheel, with New Pleated Shower Door

Optional Bathroom Skylight



Optional Outside Shower

SPECIFICATIONS

	5th Wheels							Travel Trailers							
	2650 RK LP	2650 RLR LP	3050 RK	3050 RLR	3250 FLR	3250 RLR	3450 RK SO	2650 FS	2650 FK	3000 FS	3000 FK	3050 FK SS	3250 FK	3450 FK SS	3500 FS
Exterior length	27'11"	27'11"	30'11"	30'11"	32'11"	32'11"	35'11"	26'10"	27'10 ³ / ₄ "	30'5 ¹ / ₂ "	30'5 ¹ / ₂ "	31'10"	32'9 ¹ / ₂ "	34'11"	36'4 ¹ / ₂ "
Exterior height	132"	132"	134"	134"	134"	134"	134"	108"	108"	109"	109"	117"	109"	117-1/2"	110"
Exterior width	98"	98"	98"	98"	98"	98"	98"	98"	98"	98"	98"	98"	98"	98"	98"
Interior headroom	77"	77"	77"	77"	77"	77"	77"	77"	77"	77"	77"	77"	77"	77"	77"
Approx. dry axle weight with std. equip. (lbs.)	5040	5185	5690	5575	5065	5730	N/A*	4270	4260	4515	4570	N/A*	4635	6295	5310
Approx. dry hitch weight (lbs.)	1130	1130	1555	1700	1795	1660	N/A*	570	720	965	865	N/A*	885	1090	925
Approx. gross vehicle weight rating (lbs.)	9230	9230	10155	10300	9895	10910	N/A*	7560	7700	7835	7795	N/A*	8165	9690	8550
Sleeping capacity	6	6	6	6	6	6	6	4-8	3-6	4-6	4-6	4-6	4-6	4-6	4-6
2-door LP/110V refrigerator (cu. ft.)	6	6	6	6	6-STD 8-OPT	6-STD 8-OPT	6-STD 8-OPT	6	6	6-STD 8-OPT	6-STD 8-OPT	6-STD 8-OPT	6-STD 8-OPT	6-STD 8-OPT	6-STD 8-OPT
Hitch ball height	—	—	—	—	—	—	—	20"	20"	20"	20"	22 ¹ / ₄ "	20"	22 ¹ / ₄ "	21"
Awning size (opt.)	18'	18'	20'	20'	20'	20'	20'	20'	20'	20'	20'	20'	23'	21'	24'
Furnace with thermostat & auto. ignition (BTU input)	25M	25M	31M	31M	31M	31M	40M	25M	25M	25M	25M	31M	31M	31M	31M
Fresh water tank capacity (approx. gals.)	50 ¹ / ₂	50 ¹ / ₂	50 ¹ / ₂	50 ¹ / ₂	46	50 ¹ / ₂	50 ¹ / ₂	36	36	36	36	36	36	36	46
Hot water heater (approx. gals.)	6	6	6	6	6	6	10	6	6	6	6	6	6	10	10
Gray water holding tank (approx. gals.)	63	30	70	37	37	37	70	29	29	29	29	58	29	64	29
Toilet with waste holding tank (approx. gals.)	33	33	37	37	37	37	37	36	36	36	36	36	36	42	36
Electric brakes/all wheels	12"	12"	12"	12"	12"	12"	12"	10"	10"	10"	10"	10"	10"	12"	12"
Tire size	ST225/ 75R15	ST225/ 75R15	ST225/ 75R15	ST225/ 75R15	ST225/ 75R15	ST225/ 75R15	ST225/ 75R15	ST205/ 75R15	ST205/ 75R15	ST205/ 75R15	ST205/ 75R15	ST205/ 75R15	ST205/ 75R15	ST225/ 75R15	ST225/ 75R15
Twin LP gas bottles with auto. change-over regulator (lbs.)	30	30	30	30	30	30	30	30	30	30	30	30	30	30	30

* These are new models. Certain specifications not available at time of publication. See your dealer for details.

	5th Wheels	Travel Trailers
HEAT, POWER & WATER		
Demand water pump (12V)	S	S
Ducted floor heat	S	S
Electrical system (12V) with convertor	S	S
Exterior receptacle (110V)	S	S
Monitor panel in range hood	S	S
Power cords (amps)	30	30

EXTERIOR/CONSTRUCTION FEATURES		
Chrome bumper cover	S	S
Cover for double 30-lb. gas bottles	N/A	S
Drain hose carrier bumper	S	S
Entrance door with screen, assist handle and dead bolt lock	S	S
Front window awning (stone guard)	O*	S
Hitch light (12V)	S	S
Outside trunk storage	S	S
Patio light (12V)	S	S
Radius metal skirt	S	S
Radius-cornered awning windows with screens	S	S
Recessed tail lights	S	S
TV antenna	S	S

LIVING ROOM FEATURES		
Carpet and pad (living room and bedroom)	S	S
Decorator clock	S	S
Drapes and valances	S	S
Framed picture (most models)	S	S
J-steel sofa	S	S
Mini-blinds on most windows	S	S
Polyfoam/Dacron® cushions (5" thick)	S	S

LIVING ROOM FEATURES (continued)		
Radius-cornered cabinets	S	S
Solid oak cabinet doors	S	S
Two or three night lights	S	S

BEDROOM FEATURES		
Bed struts with queen & double bed	S	S
Bedsprad	S	S
Inner-spring mattress	S	S
TV top	S	S

KITCHEN FEATURES		
Double porcelain sink	S	S
Free standing table & chairs	See Floor-plans	See Floor-plans
Range hood with power vent and light	S	S
Sink cover cutting board	S	S
Stove cover	S	S
Three-burner high output range and oven	S	S
Wooden divided cutlery drawer	S	S

BATHROOM FEATURES		
Medicine cabinet with mirror (most models)	S	S
Power roof vent (12V)	S	S
Tub or tub/shower surround	S	S

OPTIONAL FEATURES		
AM/FM/cassette radio with speakers and antenna (12V)	O	O
Awning	O	O
Cable TV hook-up	O	O

OPTIONAL FEATURES (continued)		
Ceiling ducted air conditioner (13.5M & 15M BTU)	O	O
Dual battery box	O	N/A
Electric front jack	O	N/A
Fifth wheel hitch	O	N/A
Fome-Cor® board insulation (1/4")	O	O
Gas/electric hot water heater	O	O
Generator (30' and larger)	O	N/A
Generator prep (30' and larger)	O	N/A
Heated pads for holding tanks	O	O
Ice maker in Norcold® refrigerator	O	O
Microwave oven	O	O
Outside shower	O	O
Rear window stone guard	O	O
Reinforced roof for luggage rack and ladder	O	N/A
Roof rack and ladder	O	N/A
Rubber roof	O	O
Safety glass windows	O	O
Skylight over tub	O	O
Slide out	See Floor-plans	See Floor-plans
Spare tire and wheel	O	O
Spare tire carrier	O	O
Spare tire cover	O	O
Stabilizer jacks	O	O
Storm windows	O	O
Telephone jack	O	O
Tinted windows	O	O
Washer/dryer	See Floor-plans	N/A

S = Standard O = Optional N/A = Not Available
*With 3250 FLR only

CONSTRUCTION

Jay Series travel trailers and fifth wheels are built to provide families like yours years of pleasure — wherever you go, how often you go, whatever you love to do. Superb construction features like these ensure it:

- 1) A heavy-gauge steel frame.
- 2) Numerous steel outriggers for wall-to-wall floor support.
- 3) A 2x3 longitudinal floor system — with joists running lengthwise on edge and cross-pieces to provide extra stability.
- 4) In-floor ducted heating — frees up cabinet space.
- 5) An underbelly of tough, puncture-and-tear-resistant Darco® — much stronger and lighter than aluminum.



Tongue-and-Groove Plywood Floor. Better than in most homes; prevents problems at seams; provides extra durability.

- 6) Walls with 2x2 studs on 16-inch centers for greater strength and rigidity.
- 7) 2x3s all around doors to maintain the integrity of the sidewalls.
- 8) 2x3s across the tops of all windows for extra reinforcement.
- 9) One piece molded fiberglass front and rear end caps
- 10) A heavy-duty aluminum outer skin — thicker at mid- and lower-wall (.024 inches compared to .019 inches at



Genuine Wood Drawer Sides. Hold fasteners better than pressed fiberboard; won't swell with moisture. Also, high-quality drawer slides keep operation smooth.

the top), so it's more dent-and-scratch-resistant where it's most likely to need that extra protection.

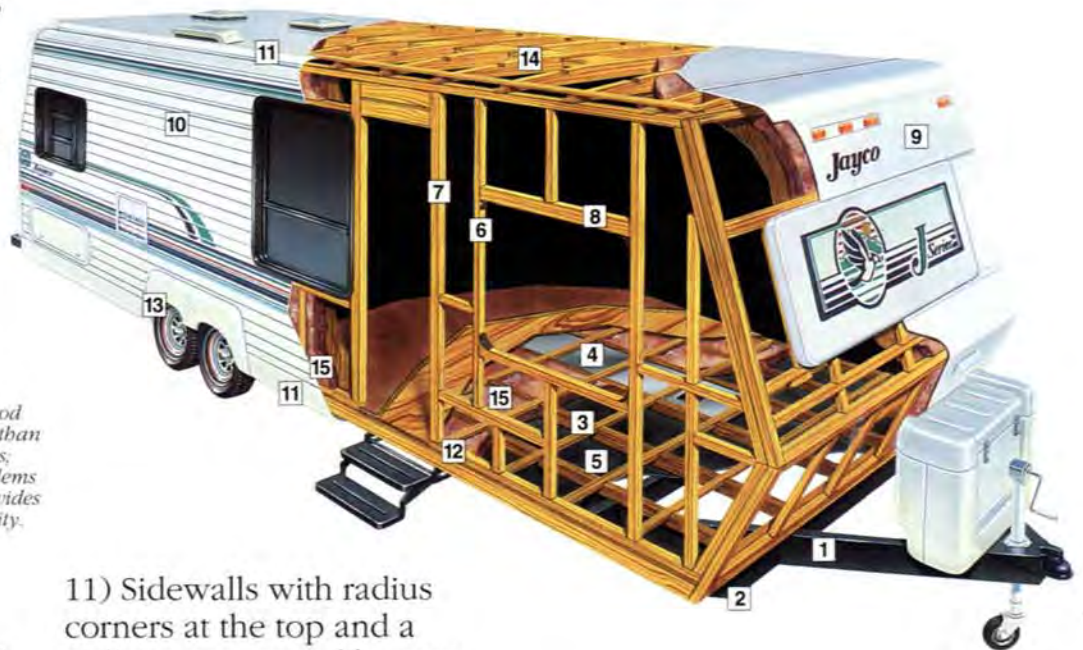

11) Sidewalls with radius corners at the top and a radius wraparound bottom edge — both of which make for a truly great-looking exterior!



Stile Cabinet Construction. Extra strong; uses screws, not staples.

- 12) Walls mounted on top of the floor instead of being screwed to the outer edge. Thus, in a Jay Series RV, the floor, not the screws, supports all of the weight.
- 13) Insulated wheel wells of galvanized steel for strength and rust-resistance.
- 14) Strong 2x4 roof rafters, tapered to provide a slope for proper water runoff.
- 15) Superior fiberglass insulation throughout the roof, walls, and floor — helps make Jay Series RVs ideal for year-round use.



Insulation Cut & Glued Between Studs. Unlike blanket-laid insulation, Jayco's stays put; won't leave uninsulated spots; retains high insulation value year after year.

TRAVEL TRAILERS

2650 FS

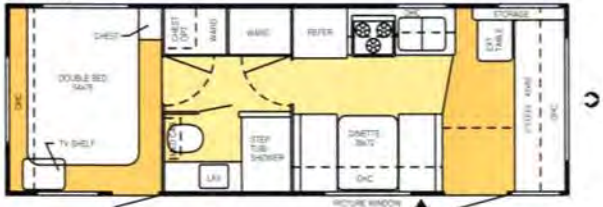

Options A, B, D, G

2650 FK

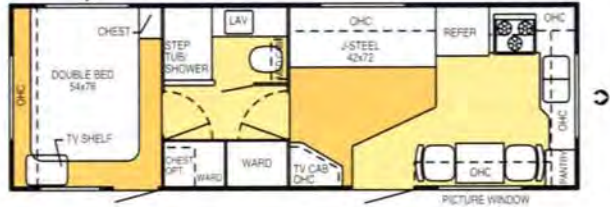

Options A, B, F

3000 FS

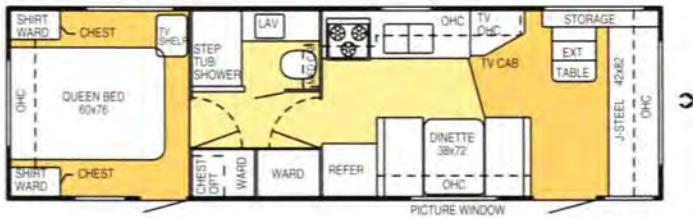

Options C, D, F

3000 FK

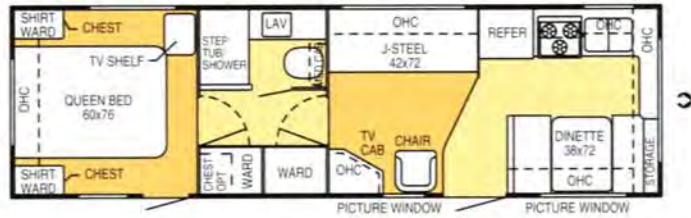

Options C, D, F

3050 FK SS



Options C, D, F

3250 FK

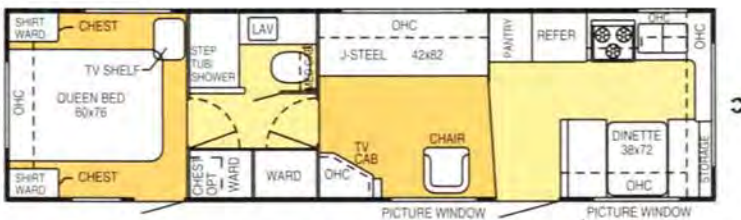

Options C, D, F

3450 FK SS



Option D

3500 SS

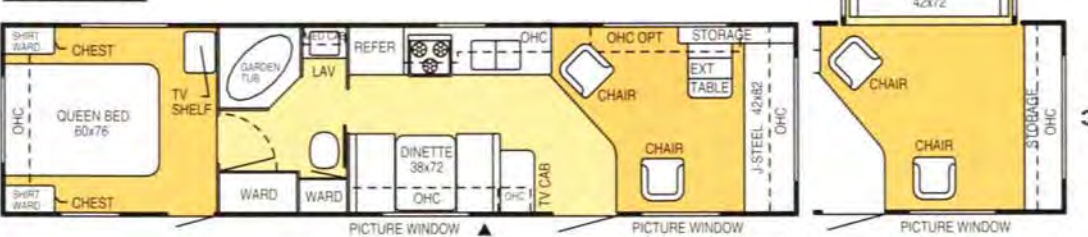

Options C, D, E

Optional Arrangements, See Codes Under Floor Plans

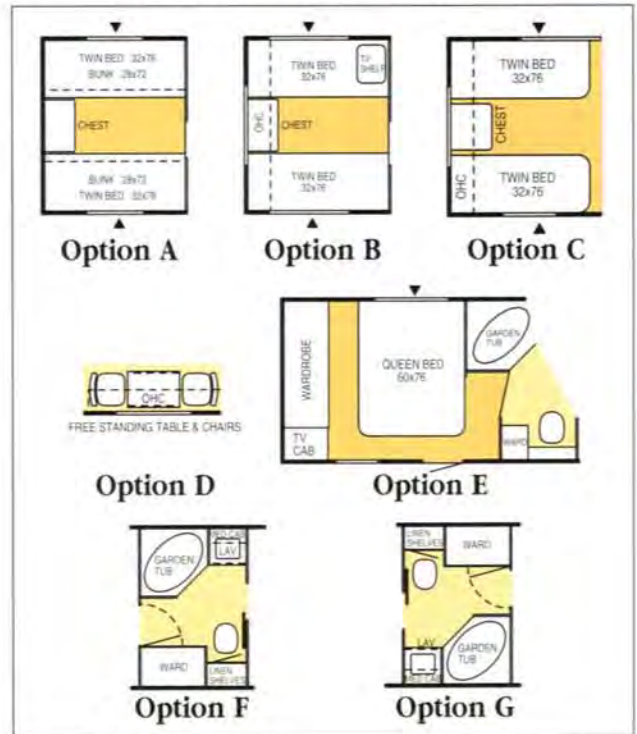

FIFTH WHEELS



Options A, B

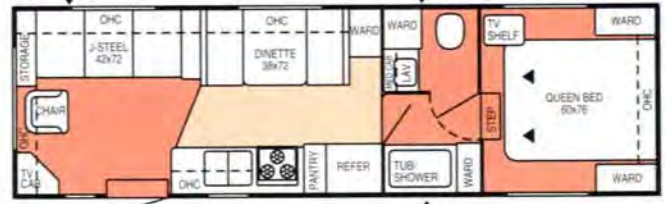

Options A, B



Options A, B, D

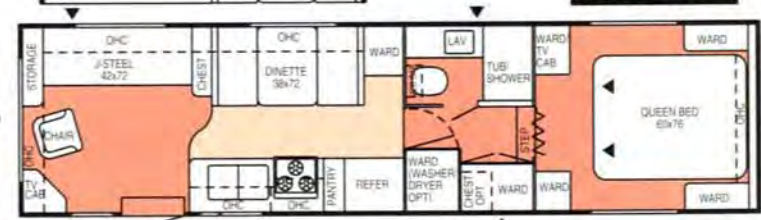

Options A, B, D



Options B, C



Options A, B



Options A, B

Optional Arrangements, See Codes Under Floor Plans

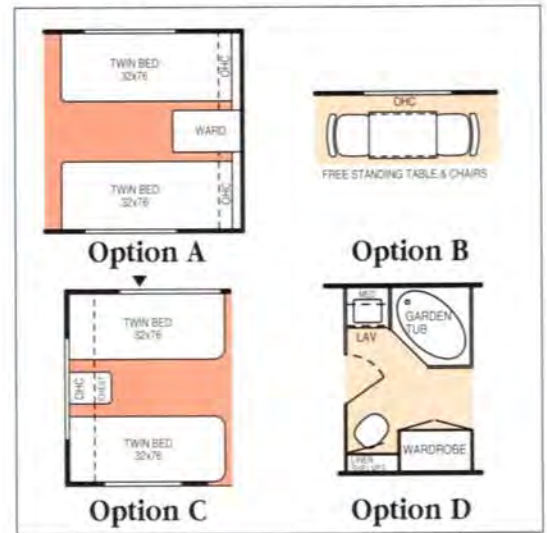

KEY TO FLOOR PLAN CODES:

- ↻ = Front of Unit
- ▶ = Outside Storage Compartment

- = SuperSlide Option
- FK** = Front Kitchen
- FLR** = Front Living Room

- FS** = Front Sofa
- LP** = Low Profile
- RK** = Rear Kitchen

- RLR** = Rear Living Room
- SO** = Slideout
- SS** = SuperSlide

THE JAYCO STORY

For over 25 years, Jayco recreation vehicles have been favorites of people who love to travel.

And for good reason. Our products are designed to be true homes.

They're built by a largely Amish work force, justifiably famous for its careful, meticulous detailing and fine craftsmanship.

They're solidly constructed for the long haul, too, combining traditional "one-unit-at-a-time" care with modern engineering and manufacturing processes, including computer-aided design.

A professional interior designer ensures that every Jayco RV home is appealingly styled and appointed to provide years of exceptional comfort; years of pleasure.

And a comprehensive Quality Assurance Program sees to it that Jayco's high standards are met at every stage of production.

Why do we go to such great lengths? Because we're a people-oriented company; a company that considers its employees, its dealers, and its customers alike as "family." And in that spirit, Jayco is committed to building products that not only bring our family, but yours closer together.

From Jayco's family to yours: "Welcome Home!"



Welcome Home



We cordially invite you, as we do all Jayco owners, to join the Jayco Jafari International Travel Club. Ask your dealer about the Jafari chapter, or "flight," as it's called, in your area. Or write Jayco directly.

LIMITED WARRANTY
Jayco recreational vehicles are warranted for twelve (12) months from the date of purchase against defects in materials and workmanship. Such warranty applies only to the original owner. A copy of this limited warranty is available for inspection upon request from your Jayco dealer. Separate manufacturers' warranties cover various components used in Jayco products.

PLEASE NOTE:
All illustrations and specifications contained in this brochure are based on the latest product information available at the time of publication approval. Because Jayco continually seeks to improve its products, and also because of changes in the availability of various components, Jayco reserves the right to make changes at any time in prices, colors, materials, equipment, specifications, and models, and to

discontinue models without notice or obligation. Components or parts may have been manufactured at times other than the model year indicated. Also, pictures in this brochure may show optional equipment available at extra cost. Recreation vehicles built for sale in Canada may differ somewhat to conform to Canadian codes. See your dealer for details.

For Further Information and Prices, See:

