

1994 EAGLE SL™ TRAVEL TRAILERS & 5TH WHEELS

ALL NEW SL!

JAYCO

**INTRODUCING A NEW CONCEPT IN RVs,
DESIGNED AND BUILT FOR TODAY'S TOW VEHICLES.
FEATURING STATE-OF-THE-ART ALUMINUM FRAME CONSTRUCTION.**



WELCOME HOME... TO THE EAGLE SL™

Built for the Way You Live Today!

The new Eagle SL™ travel trailers and fifth wheels have been created so you can enjoy the best of RV living — without having to invest in a bigger, heavier duty tow vehicle.

They're designed, you see, for towing behind today's lighter, more fuel-efficient transports: like light pickups, compact vans or trucks, mini vans, sport utility trucks, and

those popular multi-purpose vehicles that look more like cars. What you get is an RV that lets you enjoy a smoother, less stressful, more relaxed trailering experience. Our engineers managed to do all this without sacrificing one bit of home-like comfort, either.

In the Eagle SL, you'll find all the standard amenities that make RV living so enjoyable —

plus a few more to increase the fun! Every model is fully self-contained with its own, permanent sleeping accommodations, a big bathroom, a complete kitchen, and a separate area for lounging and dining. You *can* add options, if you like. But most everything you need is already included in its low base price.

From the start, your Eagle SL is ready to go when you are. Check out all its features and specifications on the back cover. And remember: We build your Eagle SL to last through a lifetime of good times. Its strong, state-of-the-art, tubular aluminum frame helps see to that. From our family to yours, "Welcome Home!"

Eagle SL Travel Trailer, Model 188SL

Shown on front cover: Top - Eagle SL Travel Trailer, Model 188SL, towed behind Jayco mini van conversion; Bottom - Eagle SL Fifth Wheel, Model 195SL, towed behind Chevy S-10 pickup.



Unique front-end exterior storage compartment is easy to get at — and built in to blend beautifully with the aerodynamic profile.



Practical, easy to use supports hold the door open to reveal a full-width storage area, completely free to hold your extra gear.

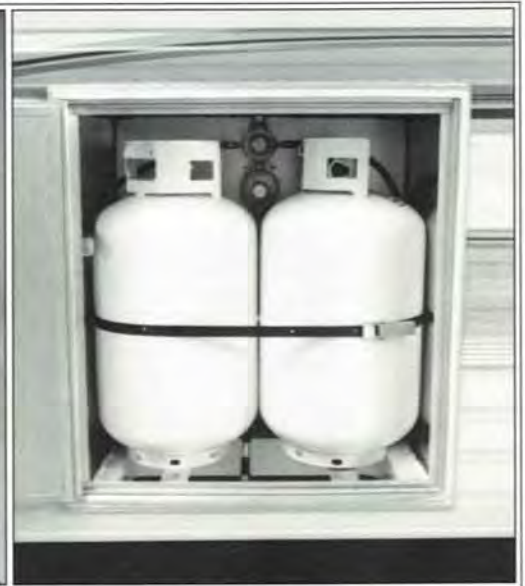

Dual LP bottles are stowed securely in their own storage compartment on the side of the trailer.

195 SL



219 SL

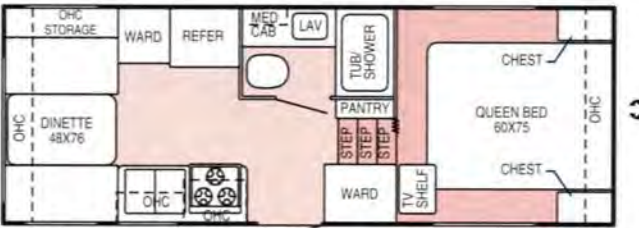

Option A

241 SL

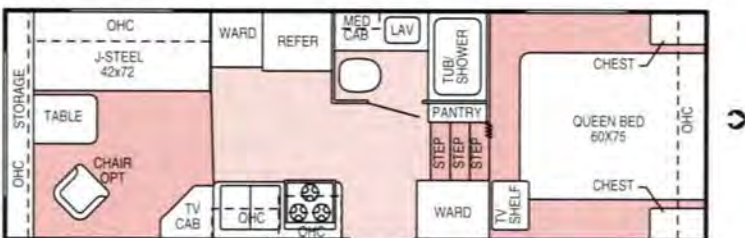

Option A

245 SL

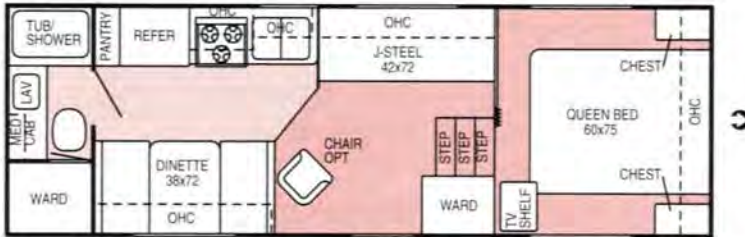

Option A

188 SL



Option B

200 SL

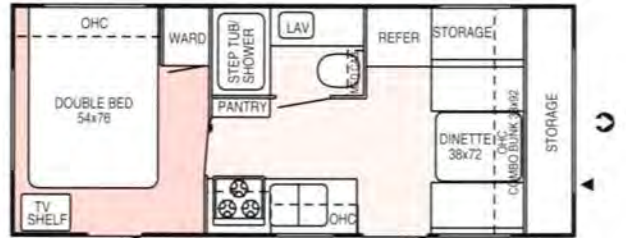

218 SL



Options B, C

224 SL

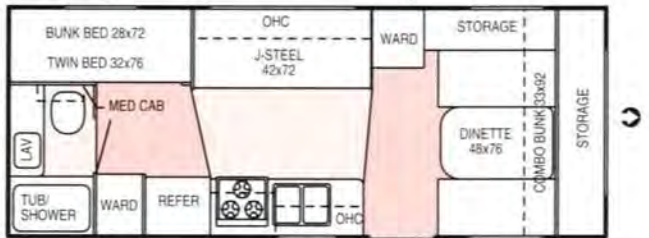

The All-New Eagle SL is Built with State-of-the-Art Aluminum Frame Construction

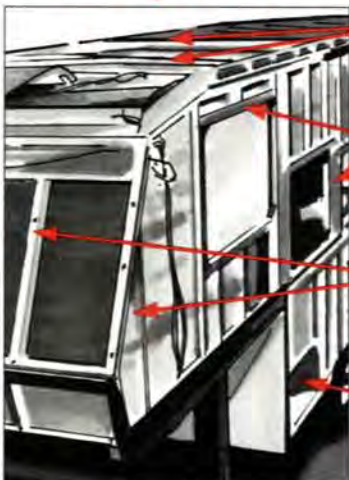

Truss aluminum rafters form a ridged, all aluminum roof for greater structural integrity; greater strength

Windows and doors are completely surrounded by aluminum framing for a solid structure throughout

Tubular aluminum frame provides exceptional strength, yet lighter weight

Dual LP bottles stow away in separate compartment on the side of the trailer

Optional Arrangements, See Codes Under Floor Plans

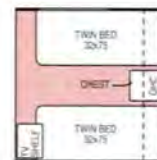

Option A



Option B

Option C

KEY TO FLOOR PLAN CODES:

- ↻ = Front of Unit
- ▶ = Outside Storage Compartment

SPECIFICATIONS

	5th Wheels				Travel Trailers			
	195	219	241	245	188	200	218	224
Exterior length	21'4"	21'10"	24'11"	24'11"	21'3"	23'7"	24'9"	24'9"
Exterior height	109"	109"	109"	109"	106"	106"	106"	106"
Exterior width	90"	90"	96"	96"	96"	96"	96"	96"
Interior headroom	77"	77"	77"	77"	77"	77"	77"	77"
Dry axle weight	3115	3405	3595	3695	3055	3215	3315	3455
Dry hitch weight	730	865	790	730	425	550	505	515
Gross vehicle weight rating	6130	6465	6990	6930	5825	6150	6505	6515
Payload	2285	2195	2605	2505	2345	2385	2685	2545
Sleeping capacity	6	6	6	6	6	6	6	6
Twin LP gas bottles with auto. change-over regulator (lbs.)	20	30	30	30	30	30	30	30
Hitch ball height	—	—	—	—	20"	20"	20"	20"
Awning size (opt.)	10'	13'	16'	16'	11'	14'	14'	14'
Furnace with thermostat & auto. ignition (BTU input)	20M	20M	25M	25M	20M	20M	20M	20M
Gray water holding tank	25	25	25	25	25	25	25	25
Waste holding tank	25	25	25	25	25	25	25	25
Fresh water tank	38	38	38	38	36	36	36	30

* Certain specifications not available at time of publication. See your dealer for details.

MAJOR FEATURES

- Strong tubular aluminum frame. True state-of-the-art construction!
- Custom-designed interiors, including color-coordinated window treatments with elegant fabric valances
- Radius-cornered windows
- A residential-grade carpet and pad in the living room and bedroom areas of most models
- Abundant storage space, inside and out (after all, you can *never* have *too much!*) — including a unique, roomy front-end exterior storage compartment in Eagle SL travel trailers: so easy to access, it's like having a spare trunk
- Deep, large-capacity overhead cabinets with oak-framed doors and stylish hardware
- Accommodating wardrobes with convenient hanger bars
- A large-capacity, flush-mounted refrigerator — standard in all models
- A high-output (9000 BTU) three-burner range with built-in oven
- A systems monitor panel for checking the holding tanks, the fresh water tank, and the battery levels
- In-floor ducted heating (with automatic ignition and a wall thermostat) for superior heat distribution; since there are no ducts in cabinets, you've got more space freed up for storage
- An oak cutting board
- A porcelain double sink
- A bathroom power vent
- Quilted designer bedspreads
- A dependable 5/8-inch plywood floor with tongue-and-groove seams
- Dual 30-pound LP-gas tanks with an auto regulator on most models — out of sight, yet easily accessible in their own, separate outside storage compartment
- A dead-bolt lock on the entrance door
- A 12-volt patio light
- A convenient 110-volt exterior outlet
- Sporty, yet tasteful contemporary striping
- Radial tires



We cordially invite you, as we do all Jayco owners, to join the Jayco Jafari International Travel Club. Ask your dealer about the Jafari chapter, or "flight," as it's called, in your area. Or write Jayco directly.

LIMITED WARRANTY
Jayco recreational vehicles are warranted for twelve (12) months from the date of purchase against defects in materials and workmanship. Such warranty applies only to the original owner. A copy of this limited warranty is available for inspection upon request from your Jayco dealer. Separate manufacturers' warranties cover various components used in Jayco products.

PLEASE NOTE:
All illustrations and specifications contained in this brochure are based on the latest product information available at the time of publication approval. Because Jayco continually seeks to improve its products, and also because of changes in the availability of various components, Jayco reserves the right to make changes at any time in prices, colors, materials, equipment, specifications, and models, and to

discontinue models without notice or obligation. Components or parts may have been manufactured at times other than the model year indicated. Also, pictures in this brochure may show optional equipment available at extra cost. Recreation vehicles built for sale in Canada may differ somewhat to conform to Canadian codes. See your dealer for details.

For Further Information and Prices, See:

Welcome Home

