



JAYCO[®]
DESIGNER
SERIES[™]

1993 TRAVEL TRAILERS & FIFTH WHEELS



32' Crane RLR Fifth Wheel

32' Hawk FS Travel Trailer



For you, travel is a way of life. Here, now, is a way of travel that truly lets you *live*.

It's the 1993 Jayco Designer Series™ — totally re-created to reflect everything Jayco's learned in its 25 years of design experience.

These exquisite travel trailers and fifth wheels are much more than RVs. They're *homes*, opening up a new world of luxurious residential living to those who make the world their home.

Whether you're snowbirds, full-timers, or long-term vacationers, you'll find the Designer Series unsurpassed in comfort, styling, craftsmanship, and durability. The following pages will show you why.

Jayco's 1993 Designer Series. Superior residential living ... for those on the move.



living... for those on the move.
Jayco's 1993 Designer Series. Superior residential
durability. The following pages will show you why.
unsurpassed in comfort, styling, craftsmanship, and
vacationers, you'll find the Designer Series
Whether you're snowbirds, full-timers, or long-term
make the world their home.
world of luxurious residential living to those who
much more than RVs. They're homes, opening up a new
These exquisite travel trailers and fifth wheels are
years of design experience.
re-created to reflect everything Jayco's learned in its 25
It's the 1993 Jayco Designer Series™ — totally
of travel that truly lets you live.
For you, travel is a way of life. Here, now, is a way



35' Crane RLR Fifth Wheel, DesignLine™ Interior in Mountain Sage



35' Crane RLR Fifth Wheel with DesignLine™ Interior in Victorian Blue



Victorian Blue Bedroom, 35' Crane RLR Fifth Wheel

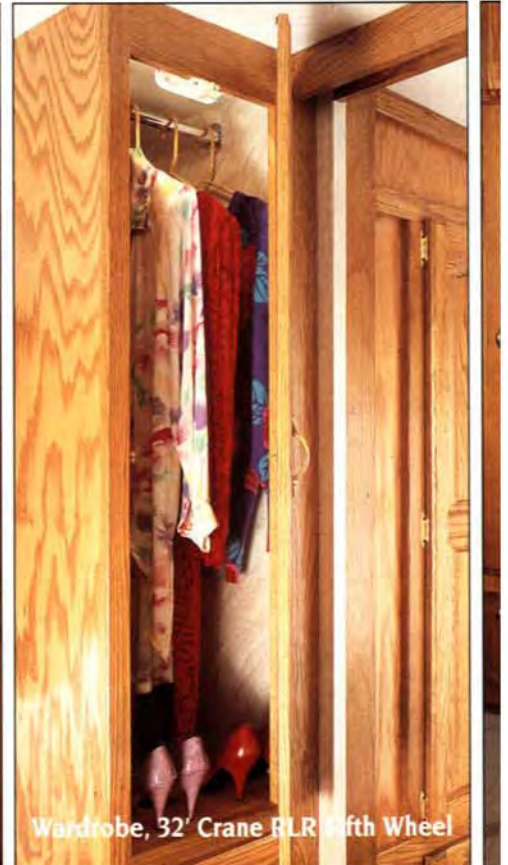

Wardrobe, 32' Crane RLR Fifth Wheel



Entertainment Center Cabinetry, 35' Crane RLR Fifth Wheel



Kitchen, 35' Crane RLR Fifth Wheel

Now — with unprecedented success — the comforts of home have been beautifully translated to the requirements of travel trailer and fifth wheel living.

One look, and you'll agree: The Jayco Designer Series truly is residential — in its styling, its feel, its overall "attitude." It's the perfect travel accommodation for people who demand real home-style luxury.

For all its residential appeal, however, the Designer Series is tough. It's built for people who are serious about travel; people on the go, who need accommodations that will hold up to their rigorous way of life.

That's especially evident in the Designer Series' laminated sidewalls. The materials that go into them are vacuum-bonded together. This creates a bond that's actually stronger than the materials themselves. Result: Designer Series sidewalls are the strongest in the industry. And you can count on it — year after year, mile after mile.

You can also count on the Designer Series to provide you the space you need for gracious living. Every Fifth Wheel model, but one, is available with Jayco's exclusive SuperSlide slideouts. They're *huge!* And they add much more than space: They add immensely to the comfort of the interior, giving you that feeling of freedom one experiences in today's finest "open-concept" homes.



32' Hawk FS Travel Trailer, DesignLine™ Interior in Coral Peach



Bedroom, 32' Hawk FS Travel Trailer



Kitchen, 32' Hawk FS Travel Trailer

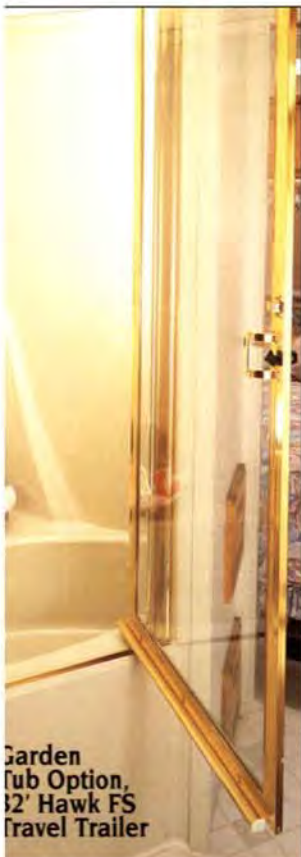

Garden
Tub Option,
32' Hawk FS
Travel Trailer



Dinette, 32' Hawk FS
Travel Trailer

Examine the following features closely. They're standard in all models, except where noted. And, taken together, they comprise the Designer Series' most impressive home-like virtues:

- Abundant custom-built cabinets of solid oak throughout
- Doors and drawers detailed with raised oak panels
- Overhead cabinets featuring doors with raised oak "cathedral-style" panels
- Wall-length cabinetry with a complete entertainment center in some models
- Jayco's unique and exquisite DesignLine™ Interiors in Coral Peach, Forest Green, Mountain Sage, or Victorian Blue — each with its own, distinctive fabric pattern, window treatment, and "designer" accessories
- Solid oak trimwork throughout
- A ceiling tastefully covered in fabric to absorb sound and increase eye-appeal
- A full eight-foot width
- Top-quality, brand-name appliances and electronic equipment
- Central air conditioning with ceiling ducts
- Central heat with floor ducts
- A high-line stereo system
- A microwave oven
- A black range hood and a black stove top with a folding cover
- A ceramic-top sink cover
- A sink sprayer
- Deep kitchen drawers
- A pullout pantry in most models



32' Crane RLR Fifth Wheel with DesignLine™ Interior in Forest Green



Bedroom, 32' Crane RLR Fifth Wheel





Kitchen, 32' Crane RLR Fifth Wheel



Freestanding Table & Chairs, 32' Crane RK Fifth Wheel



Bathroom, 32' Crane RLR Fifth Wheel

- Large windows throughout — with simple Jalousie operation
- Two dinette seating arrangements: in most models, a free-standing oak table and two chairs (with extra chairs optional), and in other models a dinette with Flex-O-Lator® spring seating
- A full bathtub in many models
- An easy-to-clean fiberglass tub-surround
- Roomy wardrobes with automatic lights and cedar bottoms in most models
- A queen-size bed with an inner-spring mattress and box springs in most models
- Elegant light fixtures throughout
- Lots of extra “little” touches, like phone jacks, a doorbell, and cable TV hookup
- Smooth, sleek, exterior sidewalls of molded fiberglass with a gleaming, high-gloss gel-coat finish
- Plenty of exterior storage — with most fifth wheels featuring a big storage-compartment pullout tray for easier loading
- A giant, full-width rear storage compartment with a door that lifts up on piston supports
- An automotive-style fiberglass rear bumper
- Automotive-style clearance lights
- Dual batteries
- A luggage rack and ladder on fifth wheels
- Electric jacks on fifth wheels
- A handy holding-tank sprayer

OPTIONS

At Jayco we recognize that everyone has his or her highly individual preferences. Different people can always think of different things they'd like to have on an extended trip. So we help you out — with a wide range of options that's sure to include something just right for *you*.

For a full listing of all the options we offer, please see the specifications chart on page 14 of this brochure. Highlights include:

- A double electric step (travel trailers only)
- A color television and a built-in VCR
- A built-in stereo system
- A washer-dryer combo (available in some models)
- A dishwasher (32' RLR and 35' RLR Crane only)
- A garbage disposal
- A recliner chair
- An ottoman
- A convenient Hi-Lo table
- Genuine parquet flooring in the kitchen
- A skylight with a shade in the bathroom
- A lift-up bed frame
- An outside shower
- A MOR/ryde® rubber suspension system

FULL-TIMER'S OPTION PACKAGE

It's uniquely Jayco's. It's available for any Designer Series model. And it offers, in one easy-to-order package, many of the very best features desired by experienced full-time RVers:

- 110-volt light fixtures
- A higher-BTU furnace in all models — 40,000 BTUs
- More insulation in the underbelly, for the water and holding tanks
- Maximum insulation everywhere
- A porcelain toilet



Washer-Dryer Combo



Hi-Lo Table (Down)



Hi-Lo Table (Up)



Color TV & VCR



Ottoman

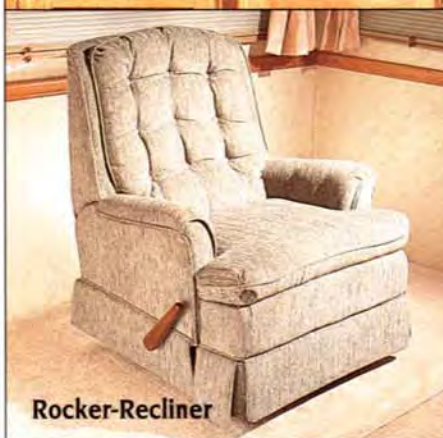

Rocker-Recliner



Parquet Floor



Bathroom Skylight



Outside Shower

CONSTRUCTION

In addition to their meticulous craftsmanship, so appealing to the eye, Designer Series™ travel trailers and fifth wheels are built to endure. That's a Jayco hallmark — reflecting 25 years of design and engineering excellence.

Features like these make the difference:

1. A standard, seamless rubber roof that helps keep the interior quiet.
2. A 3/8" plywood deck, to which the rubber is bonded. This roof deck is strong enough to walk on. (The front portion only of Designer Series fifth wheels is 1/4"-thick luan.)
3. A 2x4 tapered rafter system. It allows room for the ducting that comes with Jayco's standard central air conditioning.
4. Fiberglass and Fome-Cor® insulation. With a total R-8 insulation factor.
5. A stylish front end cap of molded fiberglass that resists dents and scratches; provides exceptional strength.
6. Laminated sidewalls — the industry's strongest — vacuum-bonded to make each entire wall more structurally sound. Vacuum-bonding is far superior to pinch-roller lamination, because, a) it uses a urethane adhesive that actually creates a bond stronger than the materials being bonded, and b) the laminated materials are kept under pressure for about 45 minutes, as opposed to the mere seconds other lamination processes use.
7. A smooth fiberglass outer skin — actually molded in one large sheet to a luan plywood backer. It has a thick gel-coat finish, too, which gives the surface a bright, lustrous, high-gloss sheen. This is then laminated to ...
8. 1-1/2" polystyrene substrate insulation with an R-7 insulation factor ...
9. And a frame that includes aluminum reinforcement for additional strength.
10. A completely enclosed underbelly that fully protects all systems and has removable holding tank covers for easy maintenance access.
11. A 2x3 floor system, with members running front to back. This allows the heating ducts to run full-length.
12. A strong 5/8" plywood deck with tongue-and-groove joints.
13. Floor insulation of R-7 fiberglass and R-1 Fome-Cor, the latter of which also insulates the heat ducts to reduce heat loss.
14. Enclosed holding tanks and plumbing with heat ducted to them to prevent freezing. This, among other notable features, makes the Designer Series ideal for year-round travel in virtually any weather.
15. Large storage compartments with protective "automotive" liners.

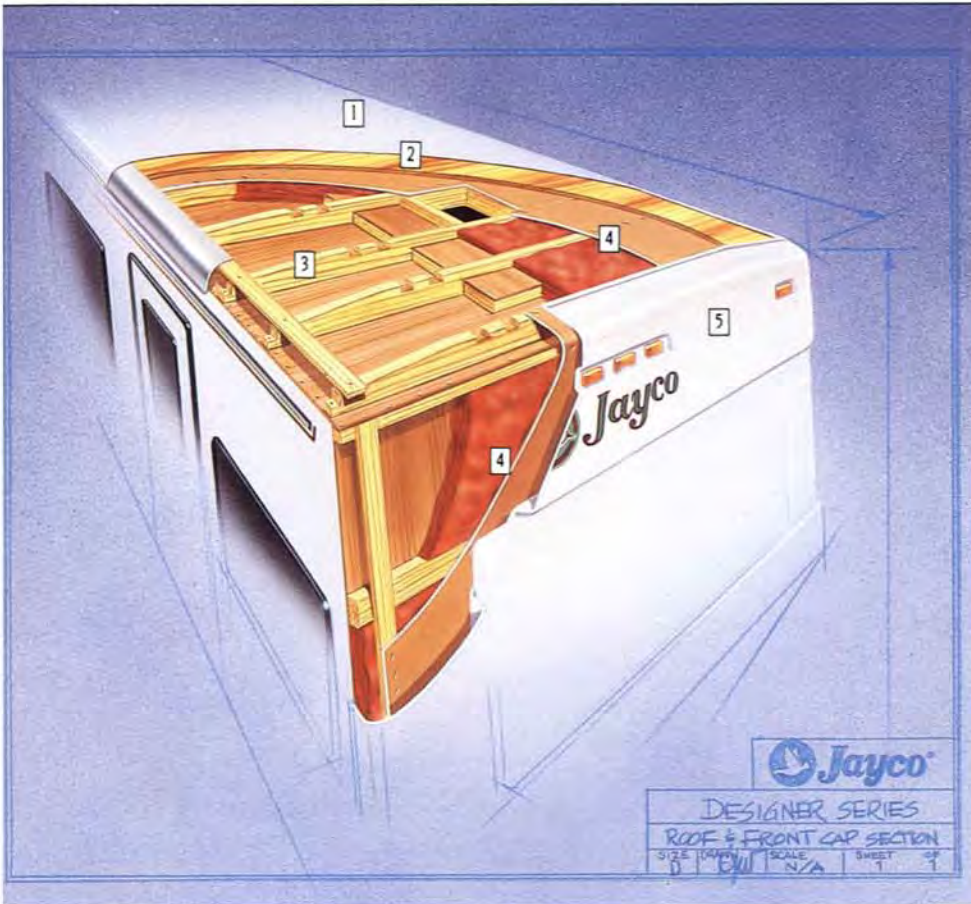

Roof and Front-end Cap

Sidewalls and Floor

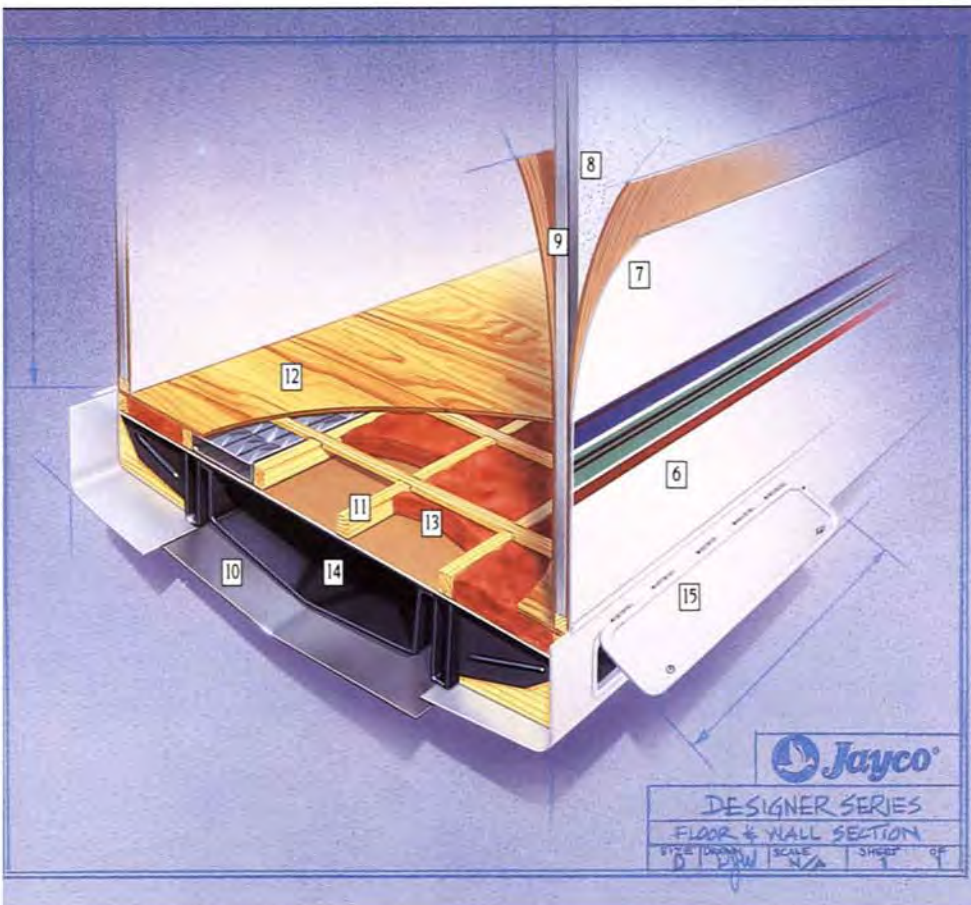

TRAVEL TRAILERS

32' HAWK FS



FIFTH WHEELS

30' CRANE RK

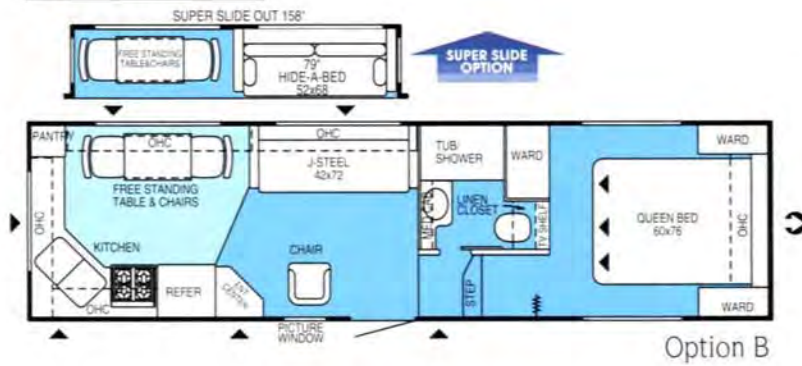

OPTIONAL ARRANGEMENTS, SEE CODES UNDER FLOORPLANS

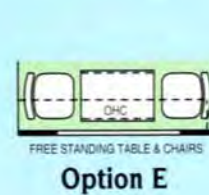
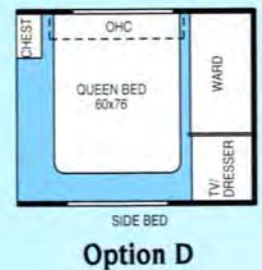
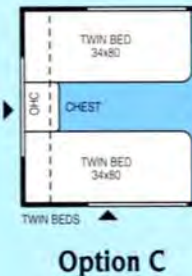
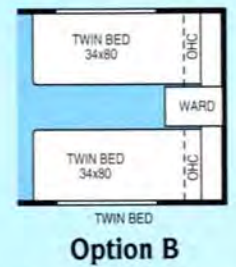

30' CRANE RLR



32' CRANE FLR

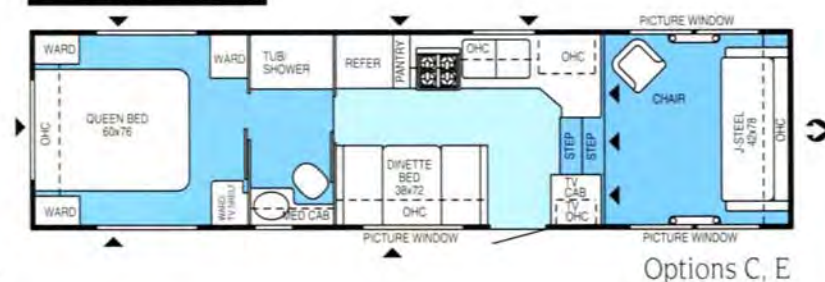

FIFTH WHEELS

32' CRANE RK

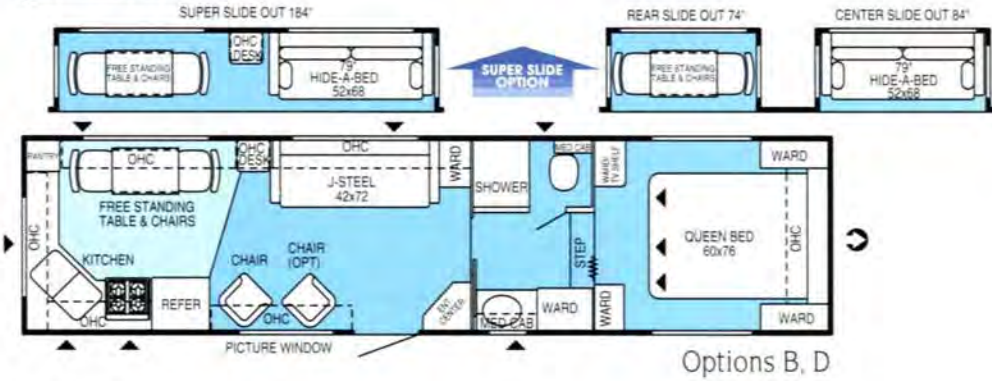

32' CRANE RLR

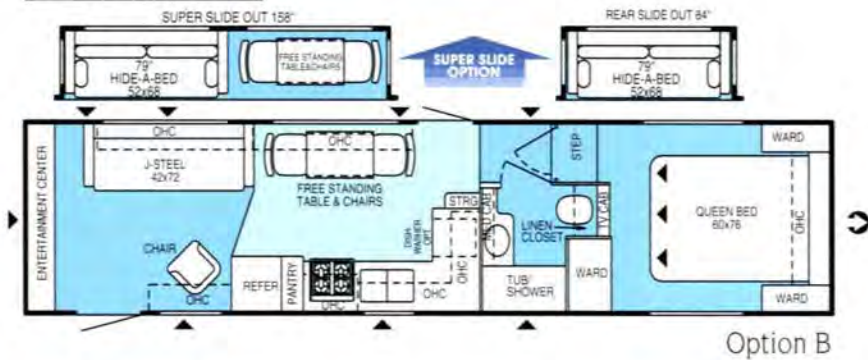

35' CRANE RLR



37' CRANE RK



KEY TO FLOORPLAN CODES:

- ↻ = Front of Unit
- ▲ = Outside Storage Compartment
- ↗ = SuperSlide Option
- FK = Front Kitchen
- FLR = Front Living Room
- FS = Front Sofa
- RK = Rear Kitchen
- RLR = Rear Living Room

DESIGNER SERIES™ SPECIFICATIONS

	Travel Trailers			Fifth Wheels				
	32' FS	30' RK	30' RLR	32' FLR	32' RK	32' RLR	35' RLR	37' RK
Exterior length	33'6-3/4"	31'8-3/4"	32'6-3/8"	34'4-1/4"	34'4-1/4"	34'4-1/4"	37'3-3/8"	39'4-7/8"
Exterior height	108"	11'5-1/2"	11'5-1/2"	11'5-1/2"	11'5-1/2"	11'5-1/2"	11'5-1/2"	11'5-1/2"
Exterior width	96"	96"	96"	96"	96"	96"	96"	96"
Interior headroom	77"	80"	80"	80"	80"	80"	80"	80"
Approx. dry axle weight with std. equip. (lbs.)	6340	6405	—*	6250	6825	7035	8000	—*
Approx. dry hitch weight (lbs.)	935	2040	—*	2125	2105	1905	1810	—*
Approx. gross vehicle weight (lbs.)	9935	11440	—*	11525	12105	11905	13310	—*
Sleeping capacity	4	4	4	4-6	4	4	4	4
2-door LP/110V refrigerator (Cubic Feet)	8	8	8	8	8	8	8	8
Hitch ball height	21-1/4							
Awning size	23'	19'	21'	22'	20'	22'	25'	25'
Furnace with thermostat and auto ignition (BTU input)	31M	31M	31M	31M	31M	31M	40M	40M
Fresh water tank capacity (approx. gallons)	46	50-1/2	50-1/2	50-1/2	50-1/2	50-1/2	50-1/2	83
Hot water heater, auto. ignition (approx. gallons)	10	10	10	10	10	10	10	10
Gray water holding tank (approx. gallons)	35	43	43	39	43	43	43	43/30-1/2
Toilet holding tank (approx. gallons)	42	43	43	42	43	43	43	43
Electric brakes/all wheels	12"	12"	12"	12"	12"	12"	12"	12"
Tire size	ST225/ 75R15W	HT235/ 85R16	HT235/ 85R16	HT235/ 85R16	HT235/ 85R16	HT235/ 85R16	HT235/ 85R16	HT235/ 85R16
Twin LP gas bottles with auto. change-over regulator (lbs.)	30	30	30	30	30	30	30	30

—* Information is not available at the time of printing

HEAT, POWER & WATER	Travel Trailers	5th Wheels
12V electrical system with convertor	S	S
Power cords (USA, 50 amps)	S	S
110V exterior receptacle	S	S
12V Demand water pump	S	S
Ducted floor heat	S	S
Monitor panel in range hood vent	S	S
Combination city/gravity water fill	S	S
Wired for radio system	S	S
Dual batteries	S	S
Holding tank sprayer	S	S

EXTERIOR/CONSTRUCTION FEATURES	Travel Trailers	5th Wheels
Smooth glass laminated walls	S	S
12V electric jacks	S	S
Stabilizer jacks	S(4)	S(2 rear)
Safety glass	S	S
Spare tire bracket	S	S
Rubber roof	S	S
Radius metal skirt	S	S
Completely enclosed underbelly and frame	S	S
Reinforced roof for luggage rack and ladder	S	S
1/4" Fome-Cor® board insulation (front wall & roof)	S	S
Radius-cornered awning windows with screens	S	S
Entrance door with screen, assist handle and dead bolt lock	S	S
12V hitch light	S	S
12V patio light (door side & off door side)	S	S
Recessed combination water fill	S	S
Wrap around automotive tail lights	S	S
TV antenna	S	S
Outside trunk storage	S	S
Shock absorbers	S	S
Cover for double 30 lb. gas bottles	S	N/A
Front window awning (stone guard)	S	N/A
Gas struts, rear storage door and stone guards	S	S
13.5M ceiling ducted A/C	S	S

LIVING ROOM FEATURES	Travel Trailers	5th Wheels
Radius cornered cabinets	S	S
Solid oak cabinet fronts	S	S
Solid oak cabinet doors (uppers cathedral)	S	S
Telephone jack	S	S
Cable TV hook-up	S	S
Drapes and valances	S	S
Pleated shades (living and bedroom areas)	S	S
Mini-blinds (bathroom/kitchen)	S	S
Carpet and pad* (living room, bedroom & bathroom/5th wheels)	S	S
5" polyfoam/Dacron® cushions	S	S
Oak assist handle	S	S
Spice rack	S	S
Magazine rack	S	S
1-steel sofa with two bolster cushions	S	S
Two or three night lights	S	S
Framed mirror	S	S
Decorator clock	S	S

BEDROOM FEATURES	Travel Trailers	5th Wheels
Inner-spring mattress	S	S
Bedsread	S	S
Bed struts (with queen)	S	**O

KITCHEN FEATURES	Travel Trailers	5th Wheels
Microwave (in OHC)	S	S
4-burner range and oven	S	S
Piezo lighter for range	S	S
Stove cover	S	S
Range hood with power vent and light	S	S
Double porcelain sink	S	S
Pull out pantry (not all models)	S	S
Wooden divided cutlery drawer	S	S
Sink cover cutting board/hot plate	S	S
Doorbell	S	S
Sink sprayer	S	S

BATHROOM FEATURES	Travel Trailers	5th Wheels
12V power roof vent	S	S
Medicine cabinet with mirror	S	S
One piece tub/shower	S	S
Sliding or swinging tub enclosure	S	S

OPTIONAL FEATURES	Travel Trailers	5th Wheels
Full timer package	O	O
Extra roof insulation	O	O
12V AM/FM/cassette radio with speakers and antenna	O	O
12V AM/FM/Cassette CD w/speakers and antenna	O	O
Convection microwave	O	O
Garbage disposal	O	O
Gas/electric auto. ignition hot water heater	O	O
Day/night pleated shades	O	O
Parquet floor (kitchen area)	O	O
Outside shower	O	O
Water purifier	O	O
Storm windows	O	O
MOR/ryde suspension	O	O
Rear window awning (stone guard) (RKs only)	O	O
Awning	O	O
Roof rack and ladder	O	O
Norcold® refrigerator with ice maker	O	O
Ottoman	O	O
Hi-Lo table	O	O
Washer/dryer (available w/garden tub only)	O	O (35' RLR & 37' RK only)
Slide out (see individual floorplans)	O (32' FS only)	O
Electric step (double)	O	N/A
TV	O	O
VCR	O	O
Solar panel	O	O
Electric front tongue jack	O	N/A
5th wheel hitch	N/A	O
Generator	N/A	O
Generator prep	N/A	O
14x22 skylight over tub (w/pleated shade)	O	O
14x30 skylight in living area (w/pleated shade)	N/A	O (32' FLR only)
13.5M non-ducted A/C (in bedroom)	N/A	O (35' RLR only)

* Living room/bedroom Travel Trailers

** Standard on 32' FLR



JAYCO. A FAMILY TRADITION FOR 25 YEARS.

Twenty-five years. Such a long time. Yet it seems like only yesterday that Lloyd J. Bontrager's dream of Jayco became a reality.

It was a dream founded on the highest principles ... nurtured by sound, traditional values ... and shaped by a desire to strengthen and preserve America's families through shared recreation experiences.

"Family" became the word by which Jayco grew and prospered. And everyone associated with Jayco was treated like family — Jayco employees, Jayco dealers, and Jayco customers alike.

Back in 1968, the company's first year, Jayco turned out 132 fold-down camping trailers in Lloyd's barn and chicken house in Middlebury, Indiana. The company quickly outgrew these facilities. It expanded its product line, too. And over the years, Jayco earned a formidable reputation for travel trailers, fifth wheels, mini motorhomes, and truck campers, as well as fold-downs. Today, Jayco is one of the largest RV manufacturers in the U.S.

The reason for its success is obvious. Year after year, Jayco has remained true to its mission. It's still very much a family oriented company; still very much committed to traditional values.

In that respect, RVers know we're not just selling recreation vehicles. They understand that we're selling a way of life; a way for families to enjoy being together.

That's the theme — the heart, if you will — of our 25th Anniversary. It is, in every sense, a "Family Celebration!" And in that spirit, we'd like to welcome you into the Jayco family!



JAYCO. A FAMILY TRADITION FOR 25 YEARS.

Twenty-five years. Such a long time. Yet it seems like only yesterday that Lloyd Bortner's dream of Jayco became a reality. It was a dream founded on the highest principles — nurtured by sound, traditional values — and shaped by a desire to strengthen and preserve America's families through shared recreation experiences.

"Family" became the word by which Jayco grew and prospered. And everyone associated with Jayco was treated like family — Jayco employees, Jayco dealers, and Jayco customers alike. Back in 1968, the company's first year, Jayco turned out 132 fold-down camping trailers in Lloyd's barn and chicken house in Middlebury, Indiana. The company quickly outgrew these facilities. It expanded its product line, too. And over the years, Jayco earned a formidable reputation for travel trailers, fifth wheels, mini motorhomes, and truck campers, as well as fold-downs. Today, Jayco is one of the largest RV manufacturers in the U.S.

The reason for its success is obvious. Year after year, Jayco has remained true to its mission. It's still very much a family-oriented company; still very much committed to traditional values.

In that respect, RVers know we're not just selling recreation vehicles. They understand that we're selling a way of life; a way for families to enjoy being together.

That's the theme — the heart, if you will — of our 25th Anniversary. It is, in every sense, a "Family Celebration!" And in that spirit, we'd like to welcome you into the Jayco family!



32' Hawk FS Travel Trailer



We cordially invite you, as we do all Jayco owners, to join the Jayco Safari International Travel Club. Ask your dealer about the Safari chapter, or "flight," as it's called, in your area. Or write Jayco directly.

LIMITED WARRANTY

Jayco recreation vehicles are warranted for 12 months from the date of purchase against defects in materials and workmanship. Such warranty applies only to the original owner. A copy of this limited warranty is available for inspection upon request from your Jayco dealer. Separate manufacturers' warranties cover various components used in Jayco products.

PLEASE NOTE:

All illustrations and specifications contained in this brochure are based on the latest product information

available at the time of publication approval. Because Jayco continually seeks to improve its products, and also because of changes in the availability of various components, Jayco reserves the right to make changes at any time in prices, colors, materials, equipment, specifications, and models, and to discontinue models without notice or obligation. Components or parts may have been manufactured at times other than the model year indicated. Also, pictures in this brochure may show optional equipment available at extra cost. Recreation vehicles built for sale in Canada may differ somewhat to conform to Canadian codes. See your dealer for details.



32' Crane RLR Fifth Wheel

For Further Information and Prices, See:



Jayco, Inc. • P.O. Box 460
Middlebury, IN 46540