



Jayco

1985

Fold-down Camping Trailers



How America camps in comfort.



Jayco fold-downs. For years they've been favored by families across the U.S.A. Experienced campers trust Jayco to bring exceptional comfort and convenience to their campsite living . . . yet in a way that also lets them fully

enjoy their natural surroundings.

What's more, people trust Jayco for quality craftsmanship; for rugged dependability, best exemplified by Jayco's patented, easy-to-operate crank lifter system; and for solid construction that holds up to years of hard use.

Examine any 1985 Jayco fold-down. You'll be a believer. And you'll make Jayco *your* family favorite, too!

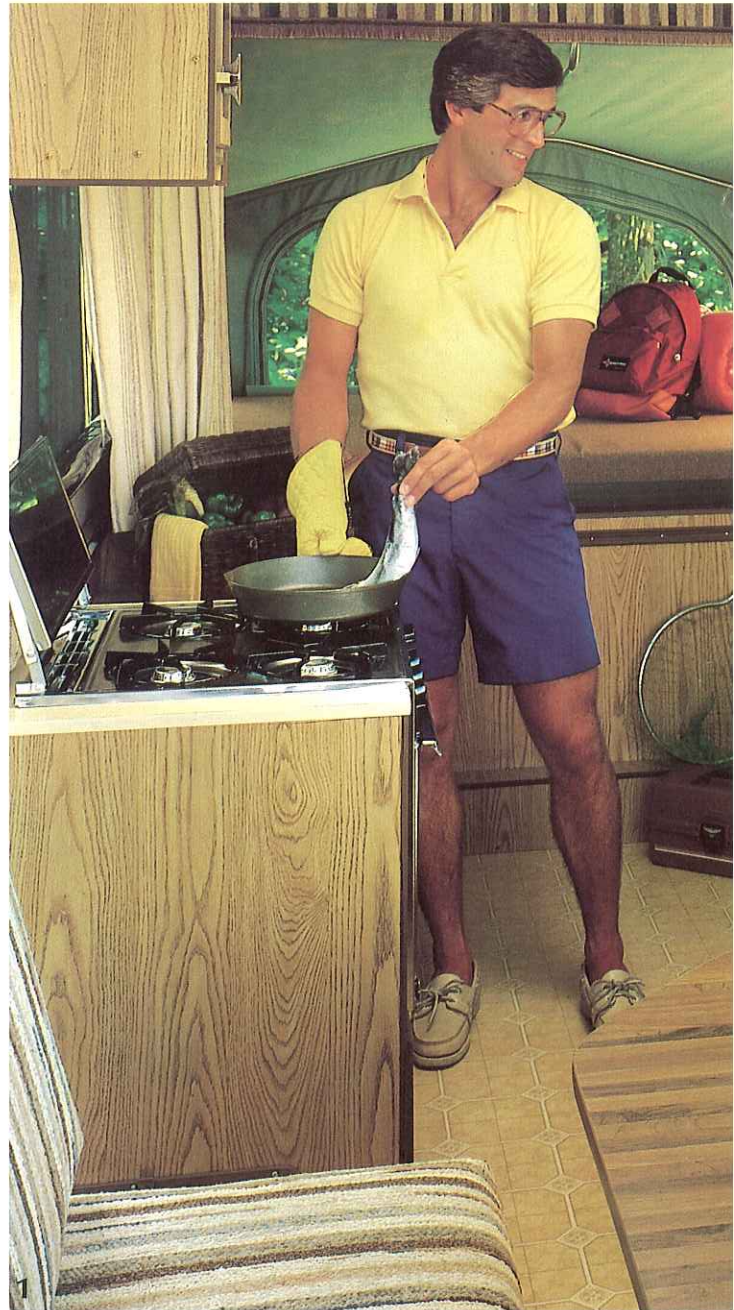

1) The spacious and beautifully appointed interior of the King 6 typifies all Jayco fold-downs. 2) The Cardinal Deluxe sleeps up to eight people comfortably—a perfect example of why Jayco fold-downs are so popular with families. 3) End bunks are extra-wide and accommodating, with plenty of headroom. They also feature thick, firm mattresses and attractive privacy drapes.

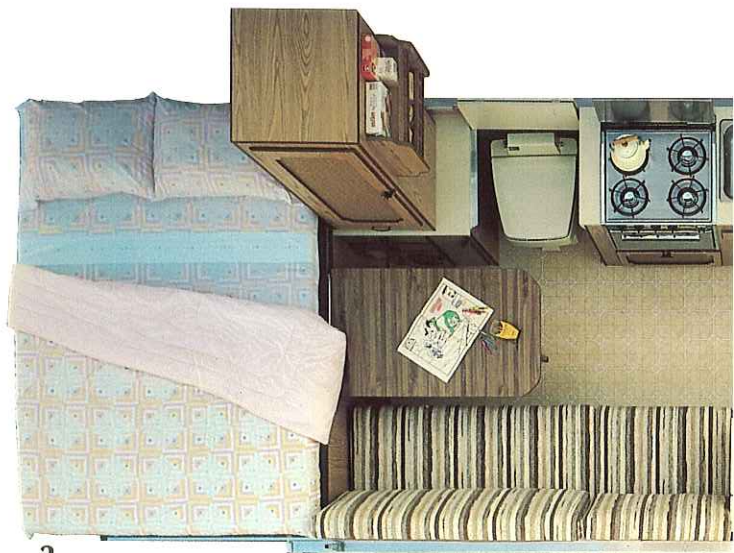



1) Jayco knows how important storage is to you, so every inch of available space is devoted to just that. You'll even find two convenient outside storage compartments in the back of most units. Note also that the spare tire is recessed for safety. 2) Inside, there are cabinets and drawers everywhere you look . . . which means you can bring along whatever it takes to make your travels come alive. All drawers and doors feature positive-locking catches. And Jayco's is the only line of fold-downs with *standard* overhead cabinets. They don't have to be removed or flipped over to lower the roof for towing, either. 3) Our optional awning canopy comes with spring-loaded poles to simplify setup. 4) The optional screen room offers more enclosed space to keep insects out, while letting in air and light. 5) For a more private enclosed addition, an optional add-a-room is available. Both the screen enclosure and the add-a-room attach to the awning canopy easily. 6) All Jayco fold-downs are available with optional Evolution 3* tent fabric—a bonded, man-made material.

*Evolution 3 is a registered trademark of Kimberly-Clark Corporation.

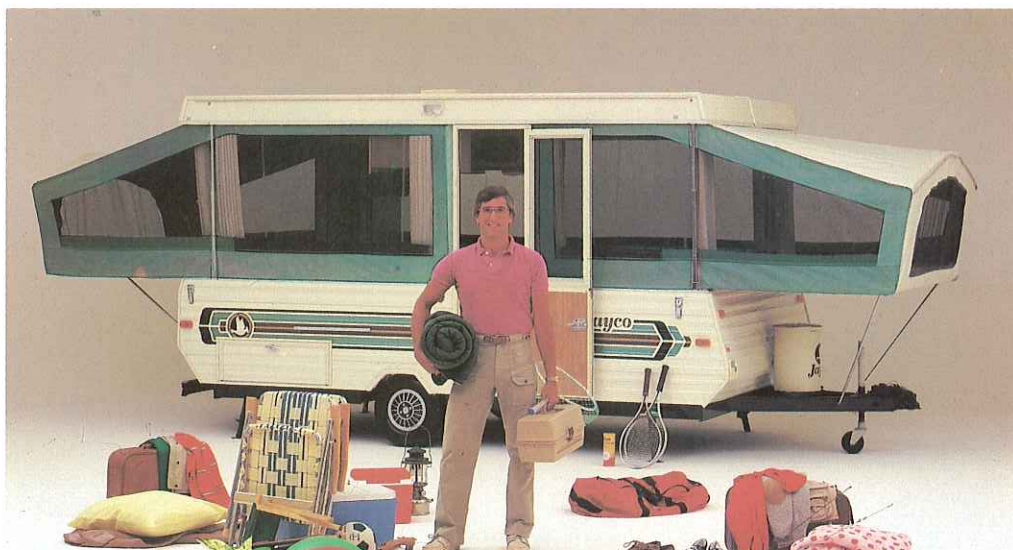

2

3



6



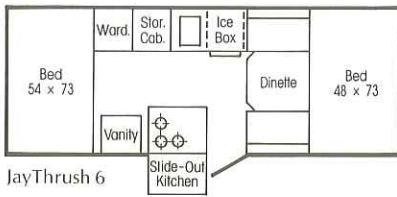

JayThrus 6

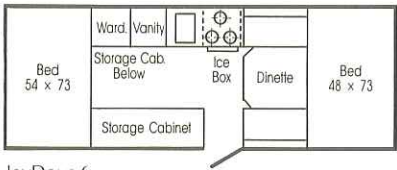

JayDove 6

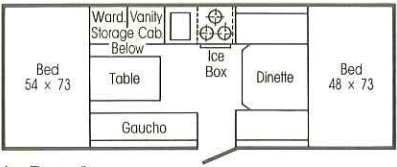

JayDove 8

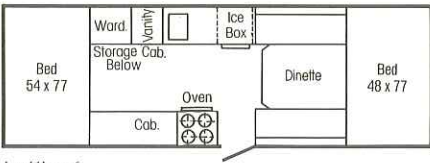

JayKing 6

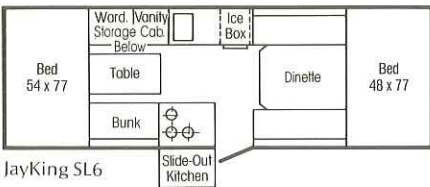

JayKing SL6

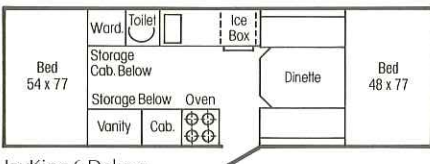

JayKing 6 Deluxe

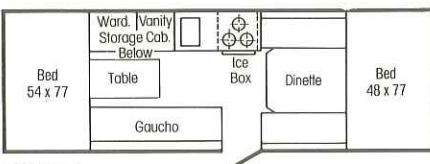

JayKing 8

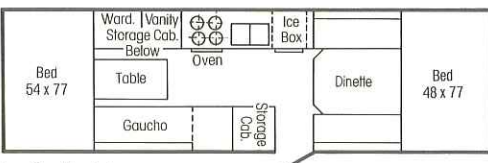

JayCardinal 8

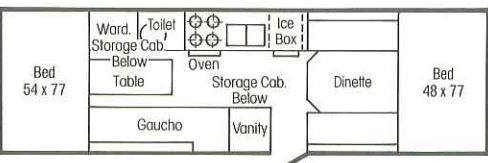

JayCardinal 8 Deluxe

SPECIFICATIONS	Jay Thrus 6	Jay Dove 6	Jay Dove 8	Jay King 6	Jay King SL6	Jay King 6 Deluxe	Jay King 8	Jay Cardinal 8	Jay Cardinal 8 Deluxe
Travel length	14'9"	14'9"	14'9"	16'10"	16'10"	16'10"	16'10"	18'10"	18'10"
Campsite length	19'11"	19'8"	19'8"	21'8"	21'8"	21'8"	21'8"	23'8"	23'8"
Travel height	47"	53"	53"	53"	53"	53"	53"	53"	53"
Campsite height	94"	94"	94"	94"	94"	94"	94"	94"	94"
Interior campsite height	77"	77"	77"	77"	77"	77"	77"	77"	77"
Exterior width	81"	81"	81"	85"	85"	85"	85"	85"	85"
Approx. dry weight w/std. equipment (lbs.)	1410	1400	1420	1740	1730	1780	1690	2090	2140
Axle weight	1250	1245	1265	1585	1575	1615	1535	1925	1975
Approx. cargo capacity (lbs.)	940	945	930	855	865	810	905	1235	1190
Approx. dry hitch weight (lbs.)	160	155	155	155	155	165	155	165	165
Hitch ball coupler size w/safety chain	2"	2"	2"	2"	2"	2"	2"	2"	2"
Hitch ball height	15 1/4"	15 1/4"	15 1/4"	13 1/2"	13 1/2"	13 1/2"	13 1/2"	13 1/2"	13 1/2"
C-channel steel frame	4"	4"	4"	4"	4"	4"	4"	4"	4"

EXTERIOR FEATURES									
Four self-storing stabilizer jacks	S	S	S	S	S	S	S	S	S
Tire size 20 x 8:00 x 10	S	S	S	S	S	S	S	S	S
2 lockable trunk compartments in rear	NA	S	S	S	S	S	S	S	S
Deluxe molded wheel covers	S	S	S	S	S	S	S	S	S
12V patio light	S	S	S	S	S	S	S	S	S
25' power cord	S	S	S	S	S	S	S	S	S
Outside storage trunk	NA	S	S	S	NA	S	S	S	S
Safety recessed spare tire mount	S	S	S	S	S	S	S	S	S
Heavy-duty welded safety bumper	S	S	S	S	S	S	S	S	S
1"-thick self-storing full-screen door w/storm window	S	S	S	S	S	S	S	S	S
Hydraulic surge brakes w/breakaway chain	O	O	O	S	S	S	S	S	S
20# LP gas tank w/regulator	S	S	S	S	S	S	S	S	S
Recessed taillights w/backup light	S	S	S	S	S	S	S	S	S
Outside table bracket	S	S	S	S	S	S	S	S	S

CONSTRUCTION FEATURES									
Galvanized wheel wells	S	S	S	S	S	S	S	S	S
Undercoated flooring	S	S	S	S	S	S	S	S	S
Torsion axle suspension system	S	S	S	S	S	S	S	S	S
Double sidewall construction	S	S	S	S	S	S	S	S	S
Metal track slide-in bed rails	S	S	S	S	S	S	S	S	S
Domed insulated roof	S	S	S	S	S	S	S	S	S
Patented Jayco lift system	S	S	S	S	S	S	S	S	S
Bed roller system	S	S	S	S	S	S	S	S	S
Exclusive nylon bearings in lifter system	S	S	S	S	S	S	S	S	S
Permanently attached zippered duck canvas	S	S	S	S	S	S	S	S	S
Water-repellent canvas (10.10oz.)	S	S	S	S	S	S	S	S	S
Smoked side windows/screens	S	S	S	S	S	S	S	S	S

GALLEY FEATURES									
Fresh water tank w/galley hand pump (gallons)	10	10	10	15	15	20	15	15	20
Ice chest size (lbs.)	35	75	75	75	75	NA	75	75	NA
Demand water pump, 12-volt	NA	NA	NA	NA	NA	S	NA	NA	S
LP gas stove (# burners)	3	3	3	4 w/oven	3	4 w/oven	3	4 w/oven	4 w/oven
City water hook-up	S	S	S	S	S	S	S	S	S
12-volt electric system w/convertor	S	S	S	S	S	S	S	S	S
Overhead cabinet	S	S	S	S	S	S	S	S	S
Light under overhead cabinet	S	S	S	S	S	S	S	S	S
Padded pull-out kitchen top	S	NA	NA	NA	S	NA	NA	NA	NA
Galley & stainless steel sink	S	S	S	S	S	S	S	S	S

INTERIOR FEATURES									
Fire extinguisher	S	S	S	S	S	S	S	S	S
Wing bunks with vinyl roof	1-54x73 1-48x73	1-54x73 1-48x73	1-54x73 1-48x73	1-54x77 1-48x77	1-54x77 1-48x77	1-54x77 1-48x77	1-54x77 1-48x77	1-54x77 1-48x77	1-54x77 1-48x77
4" foam cushions & backs w/zippers	S	S	S	S	S	S	S	S	S
12V ceiling light(s)	2	2	2	3	3	3	3	3	3
Additional 1" Dacron padding in cushions	S	S	S	S	S	S	S	S	S
Roof vent	S	S	S	S	S	S	S	S	S
Emergency exit	S	S	S	S	S	S	S	S	S
Inside 110-volt receptacles	S	S	S	S	S	S	S	S	S
Top grade vinyl flooring	S	S	S	S	S	S	S	S	S
Oak-grain interior paneling	S	S	S	S	S	S	S	S	S
Convenient adjustable mirror on entrance door	-	-	-	-	-	S	-	-	S
Portable toilet compartment	S	S	S	S	S	NA	S	S	NA
Recirculating toilet	NA	NA	NA	NA	NA	S	NA	NA	S
Wood drawers w/Delta nylon guide system & rollers	S	S	S	S	S	S	S	S	S
Positive drawer & door catches	S	S	S	S	S	S	S	S	S
Window curtains	S	S	S	S	S	S	S	S	S
Bunk end privacy curtains	S	S	S	S	S	S	S	S	S
Comfort wedge gauchio	-	-	S	-	-	-	S	S	S

OPTIONAL FEATURES									
Water repellent 7-oz. Evolution 3 tent fabric	O	O	O	O	O	O	O	O	O
LP gas/12V electric refrigerator - Dometic RM-190 (opt.)	O	O	O	O	O	NA	O	O	NA
LP gas/110V electric refrigerator - Dometic RM-211	O	O	O	O	O	S	O	O	S
Awning size - ft. (opt.)	10	10	10	12	12	12	12	14	14
Furnace (12M or 16M BTU input, Piezo Ign.)	O	O	O	O	O	O	O	O	O
Furnace (12M or 16M BTU input, Electronic Ign.)	O	O	O	O	O	O	O	O	O
20# LP gas tank w/regulator	O	O	O	O	O	O	O	O	O
Canopy/screen enclosure	O	O	O	O	O	O	O	O	O
Jayco Add-A-Room enclosure	O	O	O	O	O	O	O	O	O
"Safety Step" (removable)	O	O	O	O	O	O	O	O	O
"Step-N-Stor" (self-storing)	O	O	O	O	O	O	O	O	O

S = Standard O = Optional NA = Not Available

JAYCO CONSTRUCTION. Look beneath the surface and you'll really appreciate "The Jayco Difference." It's what's underneath that puts Jayco on top!

1) Single, easy-to-use crank that operates Jayco's patented lifter system. 2) Lifter system cables, fully enclosed along with winch to protect against salt, road tar, and dirt that create havoc with other lift systems. 3) Lifter system push rods, located at floor level, and easily accessible for servicing. 4) Lifter posts of strong, tubular steel with nylon bushings for less wear and smoother operation. 5) Built-in brake for extra safety. 6) Rugged 4" C-channel frame with added bracing in key areas. 7) Open wheel wells for easy tire changing and better axle/bearing ventilation. 8) Heavy-duty, welded safety bumper; an extension of the frame itself. 9) Four permanently attached and self-storing stabilizing jacks—standard. 10) Double sidewall construction for extra durability. 11) 2x2 bracing. 12) 5/8" exterior-grade plywood floor, fully undercoated. 13) Galvanized steel wheel wells. 14) Extra-wide flotation tires (20 x 8:00 x 10) for more stability (feature standard wheel covers). 15) Rubber-and-steel torsion-axle suspension system for safer, smoother towing. 16) Smooth-operating, reliable, interlocking aluminum slider tracks to brace end bunks. 17) Nylon rollers in endwalls to make pulling out end bunks a smooth, easy operation. 18) Durable, easy-to-clean, vinyl-clad interior paneling. 19) Attractive, durable aluminum exterior. 20) City water fill for running water without pumping. 21) Grey water drain outlet from sink. 22) 110-volt electric hookup with 25' power cord. 23) 2" hitch ball coupler with safety chain. 24) Hatch cover to protect receptacle for wiring that connects trailer to tow vehicle. 25) Superior-grade vinyl floor. 26) Insulated, fully laminated roof (not shown), domed for greater strength and proper water runoff. 27) Double-stitched, heavy-duty duck canvas and moisture barrier on end bunks (not shown).

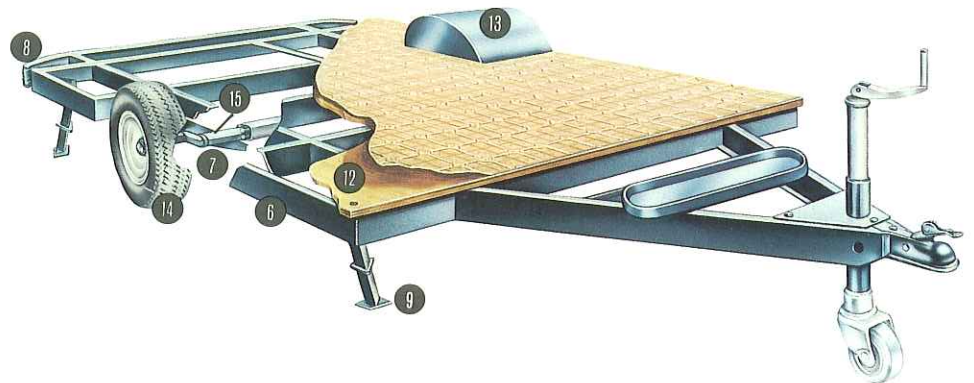
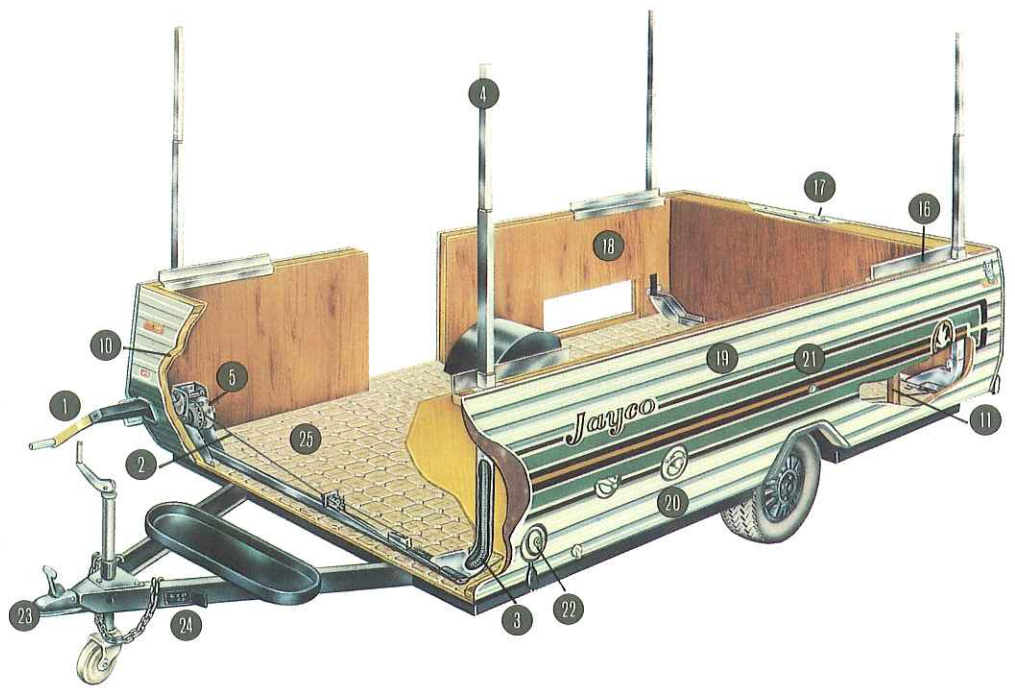

1) Jayco's unique, patented crank lifter system makes setup a breeze. Before you begin, be sure to position the unit's permanently attached leveling/stabilizing jacks. They swing down into place easily. 2) Unlatch the roof. Then open up the hatch at the front of the unit, insert the crank handle, and turn it. As you do, the roof will begin to rise almost effortlessly. Unlike conventional fold-downs, there are no awkward outside arms to contend with. And a built-in brake mechanism reduces the danger of free-fall. 3) Once the roof is up, the end bunks can be pulled out and the canvas positioned. 4) Next, insert the support bars under the end bunks to give them extra strength and stability. 5) Now you can go inside the unit, unfold the upper screen door and frame from the ceiling, put the door in place by means of Jayco's simple, ingenious double hinge, and insert the upper wall canvas into the groove around the door frame. This interlocking groove system holds the canvas in place much more firmly than the Velcro fasteners used on some other fold-downs.

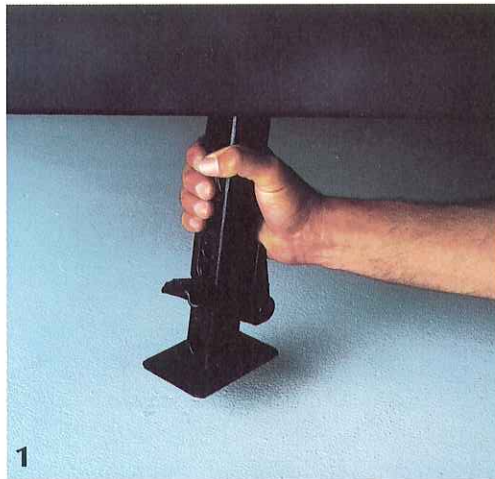

Jayco Fold-down Campers



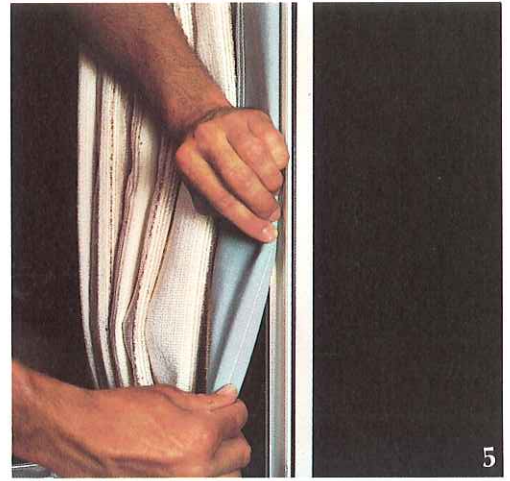
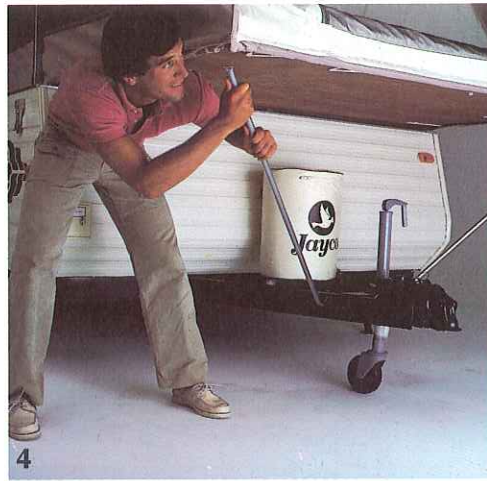

**THE INDUSTRY'S FIRST
LIFETIME
LIFTER SYSTEM
WARRANTY**

We are proud to offer a lifetime limited warranty on our patented lifter system to the original owner of this recreational vehicle. Due to our stringent quality control, and superior engineering design, we are confident that this lifter system will last a lifetime. In the unlikely event that the lifter system will need any work, however, it is reassuring to know that Jayco backs it with a lifetime limited warranty. Please see the back of this page for the complete warranty statement.



Jayco

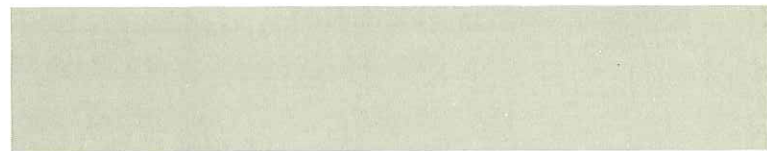

It should interest you to know that in the photo at left, the fold-down on the right is a 10-year-old Jayco — still going strong after all these years! Many Jayco fold-downs in use are more than 15 years old! And their lifter systems are working as smoothly as ever! Of course, that's no accident. Lloyd J. Bontrager, Jayco's founder, *designed* this lifter system to last a lifetime. His reasoning was simple. Who'd hang on to a fold-down they couldn't set up?

Well, campers *do* hang on to their Jayco fold-downs. And the proven reliability of Jayco's unique, patented lifter system is one major reason why. It also explains why Jayco can offer a Lifetime Limited Lifter System Warranty. Which, in turn, partly explains why Jaycos have such a high resale value. Ask your dealer for a complete, written copy of this warranty. It's your assurance that the Jayco you buy today will still be as easy to set up tomorrow. And tomorrow. And tomorrow . . .

"J" Series Fold-down Campers

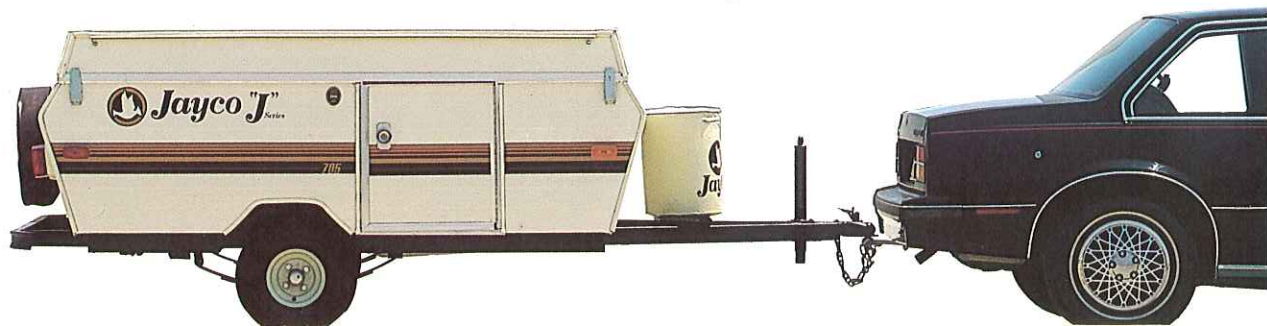

SPECIFICATIONS	"J" Series 705	"J" Series 806	"J" Series 1008 DD	"J" Series 1008 SG	"J" Series 1208
Travel length	11'4"	12'8"	14'8"	14'8"	16'9"
Campsite length	14'10"	17'4"	19'10"	19'10"	21'7"
Travel height	46½"	46½"	48½"	48½"	54½"
Campsite height	93½"	93½"	95½"	95½"	95½"
Interior campsite height	77"	77"	77"	77"	77"
Exterior width	79"	81"	81"	81"	81"
Approx. dry weight w/standard equipment (lbs.)	825	975	1240	1220	1520
Axle weight	735	865	1085	1065	1365
Approx. cargo capacity (lbs.)	700	775	980	1000	825
Approx. dry hitch weight (lbs.)	90	110	155	155	155
Hitch ball coupler size w/safety chain	2"	2"	2"	2"	2"
Hitch ball height	14½"	14½"	17½"	17½"	16"
C-channel steel frame	3"	3"	3"	3"	4"
EXTERIOR FEATURES					
Self-storing stabilizer jacks	2	2	2	2	4
Tire size 20 x 8:00 x 10	5:70x8	5:70x8	5:30x12	5:30x12	S
25' power cord	S	S	S	S	S
Spare tire mount	S	S	S	S	S
Heavy-duty welded safety bumper	S	S	S	S	S
1"-thick self-storing full-screen door w/storm window	S	S	S	S	S
20# LP gas tank w/regulator	O	O	S	S	S
CONSTRUCTION FEATURES					
Galvanized wheel wells	S	S	S	S	S
Undercoated flooring	S	S	S	S	S
Leaf spring suspension	S	S	S	S	S
Double sidewall construction	Laminated	S	S	S	S
Metal track slide-in bed rails	S	S	S	S	S
Domed insulated roof	S	S	S	S	S
Patented Jayco lift system	S	S	S	S	S
Bed roller system	S	S	S	S	S
Exclusive nylon bearings in lifter system	S	S	S	S	S
Permanently attached zippered duck canvas	S	S	S	S	S
Water-repellent canvas (10.10 oz.)	S	S	S	S	S
Smoked side windows/screens	S	S	S	S	S
GALLEY FEATURES					
Fresh water tank w/galley hand pump (gallons)	Opt. 5	Opt. 5	5	5	10
Ice chest size (lbs.)	35	35	35	35	75
LP gas stove (# burners)	Opt. 2	Opt. 2	3	3	3
City water hook-up	O	O	S	S	S
12-volt electric system w/convertor	O-Conv.	O-Conv.	S	S	S
Galley & stainless steel sink	O	O	S	S	S
INTERIOR FEATURES					
Fire extinguisher	S	S	S	S	S
Wing bunks with vinyl roof	1-30x70 1-54x70	2-48x72	1-54x73 1-48x73	1-54x73 1-48x73	1-54x73 1-48x73
Foam cushions & backs w/zippers	3" (4" opt.)	3" (4" opt.)	3" (4" opt.)	3" (4" opt.)	3" (4" opt.)
12V ceiling light(s)	1	1	2	2	2
Roof vent	NA	S	S	S	S
Emergency exit	S	S	S	S	S
Inside 110-volt receptacles	S	S	S	S	S
Top grade vinyl flooring	S	S	S	S	S
Oak-grain interior paneling	Cabinetry Only	S	S	S	S
Portable toilet compartment	NA	NA	NA	NA	S
Wood drawers w/nylon center guides	S	S	NA	S	S
Positive drawer & door catches	S	S	S	S	S
Window curtains	S	S	S	S	S
OPTIONAL FEATURES					
Water repellent 7-oz. Evolution 3 tent fabric	O	O	O	O	O
LP gas/12V electric refrigerator - Dometic RM-190 (opt.)	NA	O	O	O	O
LP gas/110V electric refrigerator - Dometic RM-211	NA	O	O	O	O
Awning size—ft. (opt.)	7	8	10	10	12
Deluxe package (includes privacy drapes, 4" cushions, patio light, outside table bracket & adjustable table leg)	O	O	O	O	O
Furnace (12M or 16M BTU input, Piezo Ign.)	O	O	O	O	O
Furnace (12M or 16M BTU input, Electronic Ign.)	O	O	O	O	O
20# LP gas tank w/regulator	O	O	O	O	O
Canopy/screen enclosure	O	O	O	O	O
Jayco Add-A-Room enclosure	O	O	O	O	O
"Safety Step" (removable)	O	O	O	O	O
"Step-N-Stor" (self-storing)	O	O	O	O	O
Hydraulic surge brakes w/breakaway chain	O	O	O	O	O
Kitchen console	O	O	S	S	S

S = Standard O = Optional NA = Not Available

"J" SERIES CONSTRUCTION. Who else but Jayco could offer construction this detailed; this rugged at so economical a price?

1) Single, easy-to-use crank that operates Jayco's patented lifter system. 2) Lifter system cables, fully enclosed along with winch to protect against salt, road tar, and dirt that create havoc with other lift systems. 3) Lifter system push rods, located at floor level, and easily accessible for servicing. 4) Lifter posts of strong, tubular steel. 5) Built-in brake for extra safety. 6) Rugged 3" C-channel frame with added bracing in key areas (4" in 1208 model). 7) Open wheel wells for easy tire changing and better axle/bearing ventilation. 8) Two permanently attached and self-storing stabilizing jacks—standard. 9) Double sidewall construction for extra durability. 10) 2x2 bracing. 11) Fully undercoated exterior-grade plywood floor. 12) Leaf-spring suspension for dependable towing. 13) Smooth-operating, reliable, interlocking aluminum slider tracks to brace end bunks. 14) Nylon rollers in endwalls to make pulling out end bunks a smooth, easy operation. 15) Durable, easy-to-clean, vinyl-clad interior paneling. 16) Attractive, durable aluminum exterior. 17) City water fill for running water without pumping. 18) 2" hitch ball coupler with safety chain. 19) Hatch cover to protect receptacle for wiring that connects trailer to tow vehicle. 20) Top-grade vinyl floor. 21) Insulated, fully laminated roof (not shown), domed for greater strength and proper water runoff. 22) Heavy-duty, welded safety bumper (not shown); an extension of the frame itself. 23) Galvanized steel wheel wells. 24) 110-volt electric hookup with 25' power cord (not shown).

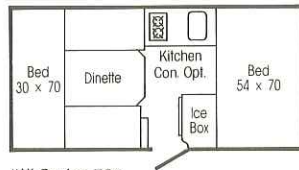
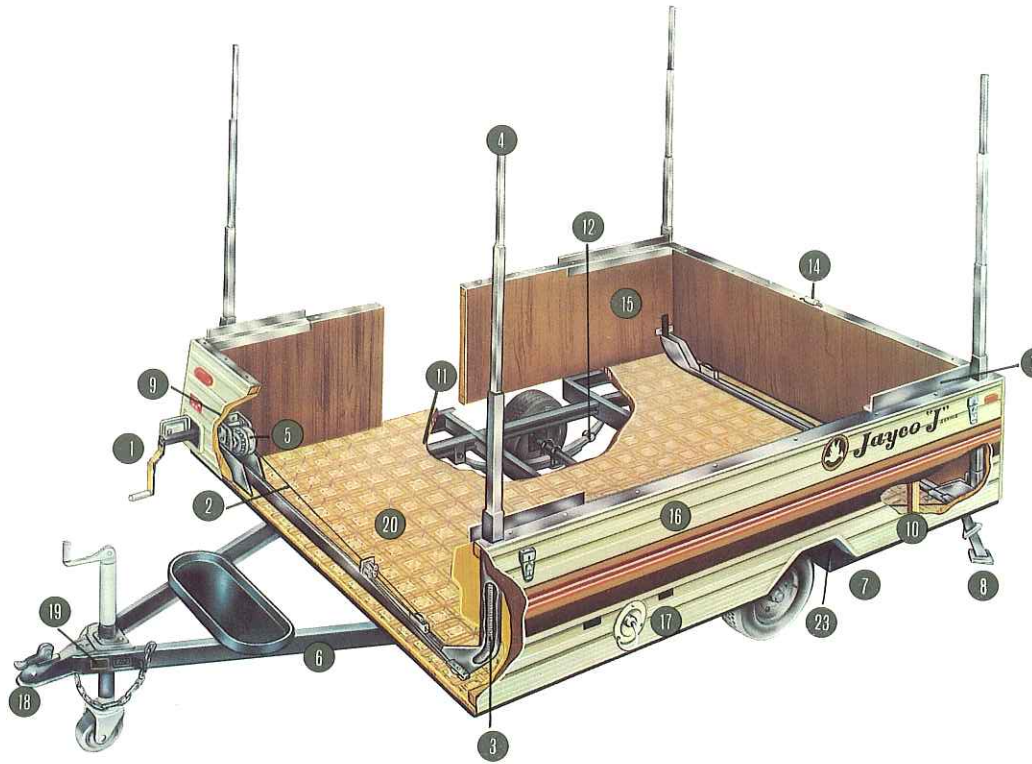

"J" Series 705

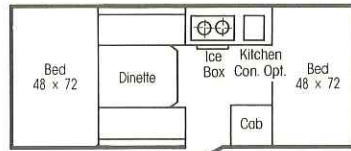

"J" Series 806

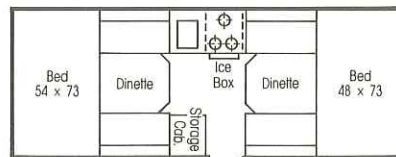

"J" Series 1008 DD

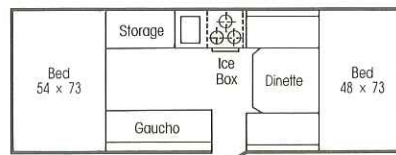

"J" Series 1008 SG

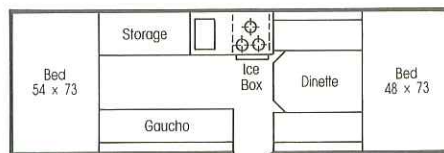

"J" Series 1208

How America camps in comfort. . . on a budget.



Jayco "J" Series fold-downs fill a pretty tall order. They offer camping families the comfort and convenience they want . . . at an even more comfortable, convenient price. No wonder they're so popular with younger, first-time

buyers. But, then, anyone with an eye for extra value can find plenty to like in a Jayco "J".

For starters, there's Jayco's patented, easy-to-operate crank lifter system. Then there are those warm, practical interiors. They're handsomely styled and lovingly appointed with an array of features that add zest to the camping lifestyle. Jayco "Js" are built rugged, too; built to go the distance, wherever the good times lead.

You want comfort, convenience, *and* economy? To be sure, you want a Jayco "J"!



1

1) The "J" Series 1008 SG combines attractive decor styling and a wide range of conveniences in a practical, spacious floorplan. 2) Even though it's small enough to be towed by today's smaller, lightweight cars, the "J" Series 705 is big enough to sleep five people comfortably. 3) When the bedding isn't set up, the Jayco "J" gives you plenty of room for a variety of family camping activities.

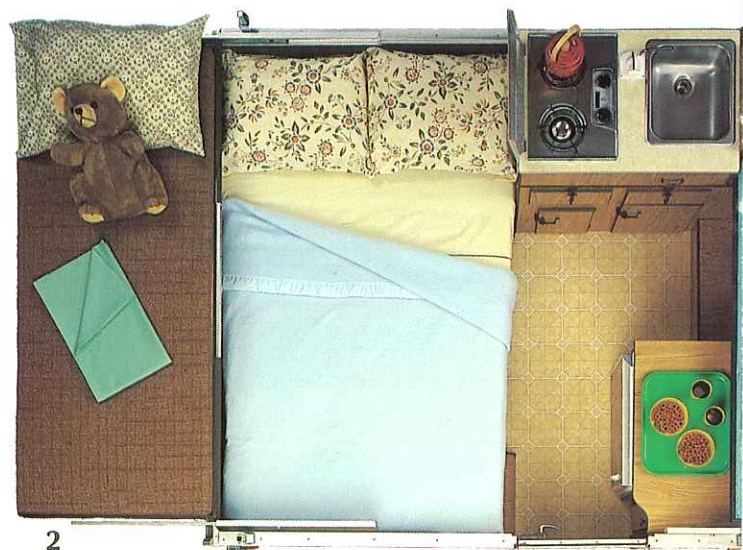

2

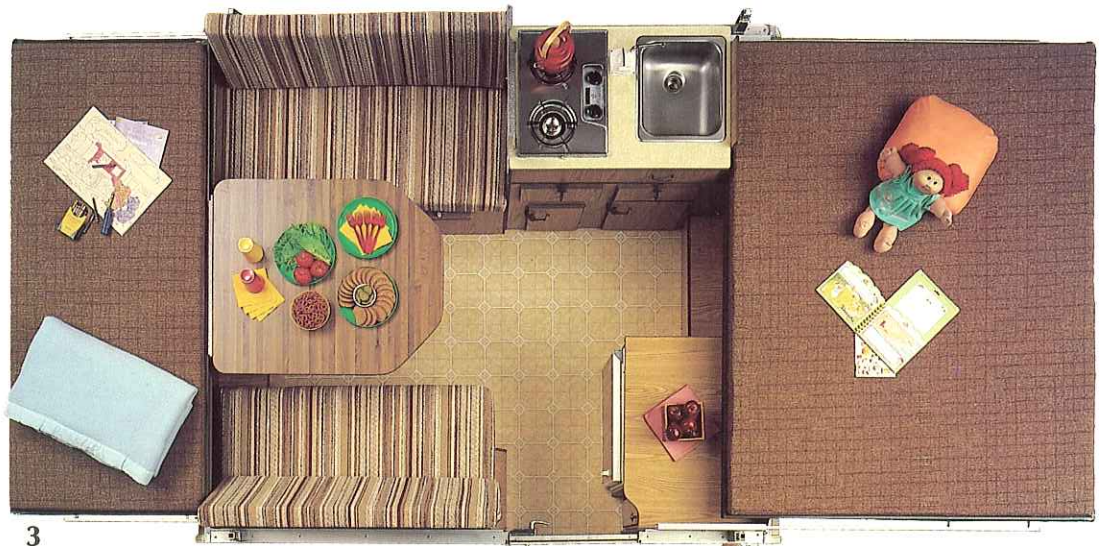

1) The optional awning canopy, shown here on our "J" Series 1008 SG, features spring-loaded poles for easy setup. 2) Jayco "Js" give you so much storage space, you may not need to use your car trunk—but at least it's free when you want it. 3) Attractive end-bunk privacy drapes are part of our Deluxe Optional Package. 4) Another convenient feature included in the Deluxe Optional Package is a patio light, mounted on the side of the roof section. 5) Standard in every Jayco "J" are conveniently located 110-volt outlets. Now you can make use of all those little electric amenities you've always wished you could take camping with you.



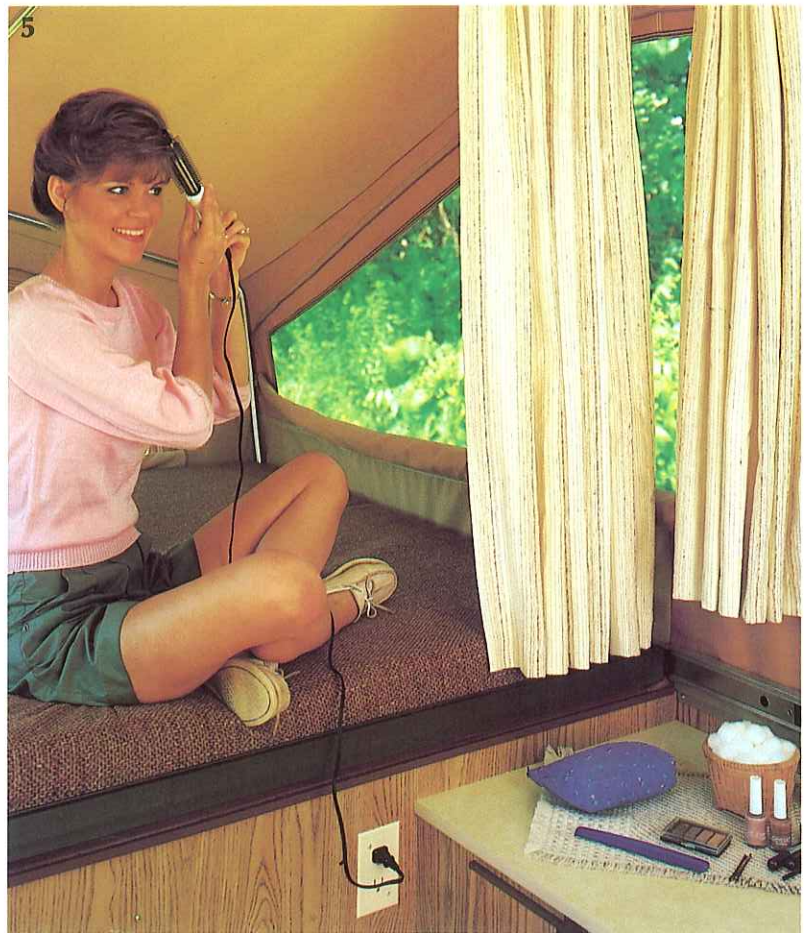



WHERE QUALITY IS A "GOING" CONCERN.

Since its founding in 1968, Jayco has become one of the most respected recreational vehicle manufacturers in the country. Its reputation is due in large part to its commitment to quality. And that commitment was made at the start, so that, now, it's an integral part of Jayco's operating philosophy.

Consider the company's extensive Quality Control Program. Under its provision, every Jayco product is thoroughly tested and evaluated according to a rigid set of construction standards. No RV "passes" unless it meets those standards perfectly. Also, unlike many such programs, Jayco's utilizes well-trained, full-time inspectors who check each RV at each stage of production—from the receipt of raw materials to the finished product. It's exactly this kind of dedication that has earned Jayco the trust of consumers everywhere. They believe in Jayco quality. And Jayco is resolved to keep them believing for as long as Jayco RVs keep rolling down the highways!

See your local dealer for more details and pricing information.
Your nearest Jayco dealer is:

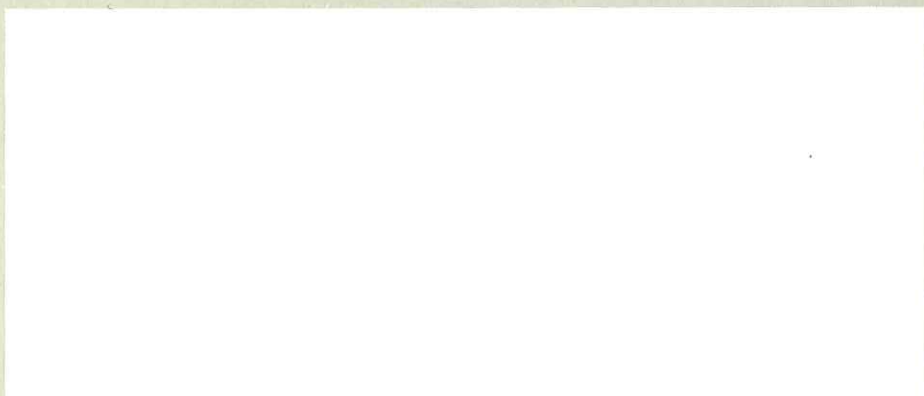

Join the Jafari International Travel Club

A lifetime of good times starts with your new Jayco RV. And the good times get even better when you share them with other camping families.

That's why we encourage you, as we do all Jayco owners, to join your local Jayco Jafari International Travel Club chapter. As soon as you do, you'll be eligible to participate in the fun and adventure of many specially planned local and regional outings. You'll also be able to join any of the numerous Jafari excursions that are scheduled each year—excursions that take you to fascinating places around the country; even around the world!

Ask your dealer about the Jafari chapter or "flight," as it's called, in your area. Or write Jayco Jafari at the address below.



Limited Warranty

Jayco recreational vehicles are warranted for 12 months from date of purchase against defects in materials and workmanship only to the original owner, as outlined in the Jayco Owner's Manual. A copy of this limited warranty is available for inspection upon request at your Jayco dealer. Separate manufacturers' warranties cover various components used in the Jayco recreational vehicles.

All illustrations and specifications contained in this literature are based on the latest product information available at the time of publication approval. Because of progressive product improvements and availability of components, Jayco reserves the right to make changes at any time in prices, colors, materials, equipment, specifications, and models, and to discontinue models without notice or obligation. Components or parts may have been manufactured at times other than the model year indicated. Pictures in this brochure may show optional equipment. Recreational vehicles built for sale in Canada may differ somewhat to conform to Canadian code; see your dealer for details.



Jayco

Jayco, Inc.
P.O. Box 460
Middlebury, IN 46540