

OUTLAW

MADE TO FIT
YOUR FAMILY



OUTLAW

BY THOR MOTOR COACH

WHEN WE SAY *MADE TO FIT*,
WE MEAN IT.

With so many unique models available, Thor Motor Coach motorhomes are priced to fit anyone's budget – from families buying their first motorhome, to full-timers looking for a roaming “dream home”. No matter how you choose to spend your time or your money, there's a TMC motorhome that fits your needs. Welcome to the Outlaw, the motorhome that is *Made to Fit* your family.



COCKPIT W/LEATHERETTE CHAIRS



29H | RUSH HOUR | SYDNEY MAPLE



CLASS C



BEAUTY INSIDE & OUT



METALLIC



PARADISE CITY



RESIDENTIAL VINYL FLOORING



MOONDANCE



RUSH HOUR

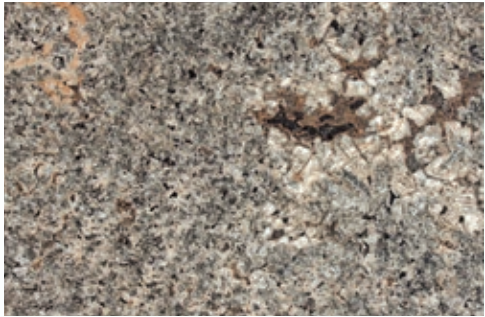

COUNTERTOPS



29H | RUSH HOUR | SYDNEY MAPLE



29H | RUSH HOUR | SYDNEY MAPLE



OLYMPIC CHERRY



SYDNEY MAPLE

FORD® E-SERIES



TRITON® V10 ENGINE

The 6.8L V10 engine has a proven track record of durability and low-hassle maintenance. Extremely smooth running with a commanding 305-horsepower and 420 lb.-ft. of torque.

TORQSHIFT® 6-SPEED AUTOMATIC TRANSMISSION

Provides crisp, firm and quick shifting without sacrificing driver comfort.

TWIN I-BEAM FRONT SUSPENSION

Provides a comfortable ride by allowing the front wheels to work independently of each other, reducing driver stress.

POWER 4-WHEEL DISC ANTI-LOCK BRAKE SYSTEM

Maintains brake balance in heavy use and varying road conditions. Reduces wheel lock up and helps maintain superior steering control.

LIMITED WARRANTY

The Ford® Motorhome Chassis has a Bumper-to-Bumper Limited Warranty for 3 years or 36,000 miles and a Powertrain Limited Warranty for 5 years or 60,000 miles, whichever comes first.

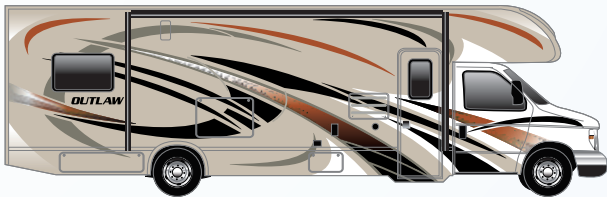

AFTER BURNER-CHAMPAGNE **THOR**

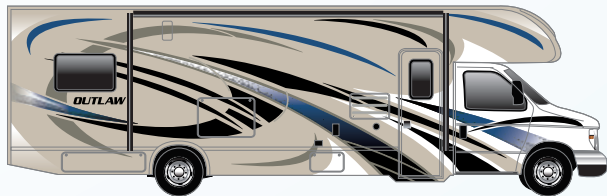

COLD FUSION-CHAMPAGNE **THOR**

Taking the extra time to ensure the best possible structure is exactly what you deserve, and this is why Thor Motor Coach insists on vacuum-bond laminating not only the sidewalls of the motorhome, but also the floor and roof. Vacuum-bonding is the optimum manufacturing process to ensure multi-layer integrity.



ROOF

- A** One-piece exterior TPO membrane
- B** Luan panels
- C** Aluminum structure with bowed framing
- D** Block foam insulation
- E** Interior panel with hard vinyl covering

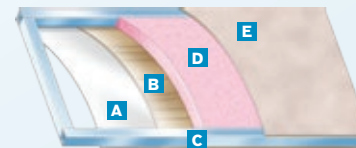

SIDEWALLS

- A** High-gloss fiberglass
- B** Luan panels
- C** Aluminum structure with framing at all openings
- D** Block foam insulation
- E** Interior panel with designer wall covering



FLOOR

- A** Residential vinyl flooring
- B** OSB structure wood base
- C** Structural steel framing
- D** Block foam insulation
- E** Luan with woven plastic exterior finish

CLASS C FLOOR PLAN

29H

Chassis	Ford
Gross Vehicle (GVWR)	14,500
Gross Combined (GCWR)	22,000
Wheel Base	219"
Exterior Length	30'-9"
Exterior Height (w/AC)	10'-10"
Exterior Width (w/o mirrors)	99"
Interior Height (living area)	82"
Awning Size	16'
Fuel (gal)	55
LPG (lbs)	40.9
Fresh/Waste/Gray Water (gal)	40 / 31 / 32
Water Heater (gal)	6
Furnace (BTUs)	19,000
Exterior Storage Capacity (cu. ft.)	17.2 (plus Garage)

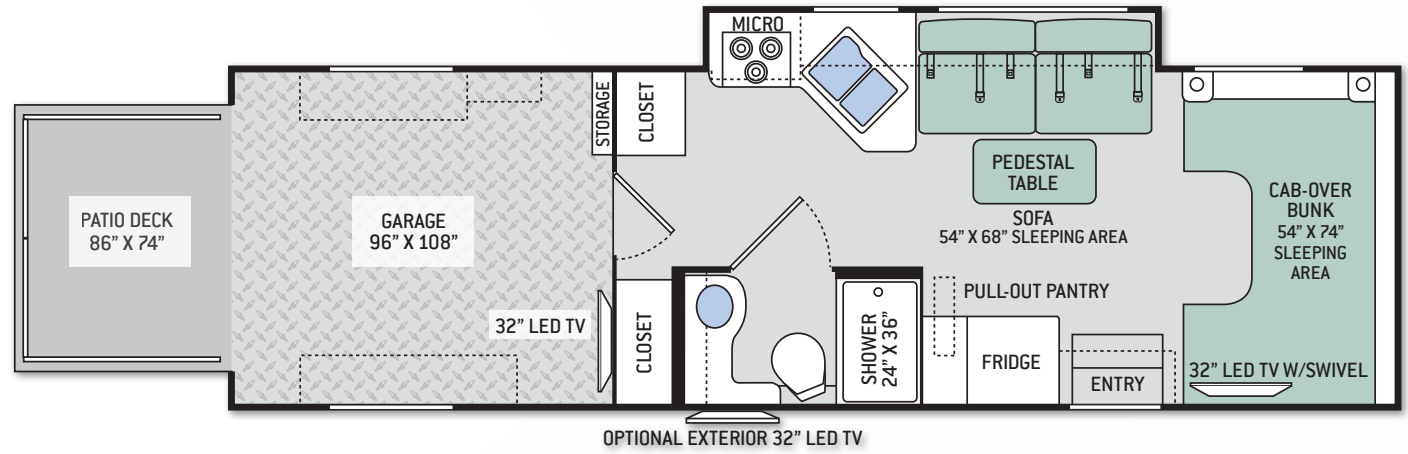

OPTIONAL SOFAS IN GARAGE



PULL-OUT PANTRY | OLYMPIC CHERRY

CLASS C STANDARDS & OPTIONS

CONSTRUCTION & EXTERIOR

- Ford® E-Series Chassis – 6.8L Triton® V10, 305HP & 420 lb.-ft. Torque – TorqShift® 6-Speed Automatic Transmission
- Premium One-Piece Crown TPO Roof 
- HD-MAX® Exterior with Graphics Package
- Rotocast Storage Compartments
- Flush Mount Radius Compartment Doors
- Power Patio Awning with Integrated LED Lighting
- Patio & Rear Spot Lights
- Frameless Windows
- Outside Shower
- Drop-Down Ramp Door with Patio Railings & Manual Patio Awning
- Air Ventilation Sidewall Vents in Garage
- Stainless Steel Storage Cabinet in Garage

CONSTRUCTION & EXTERIOR OPTIONS

- Automatic Leveling Jacks with Touchpad Controls

AUTOMOTIVE & COCKPIT

- Touchscreen AM/FM Dash Radio with CD/DVD Player, Bluetooth® & Back-Up Monitor
- Heated/Remote Exterior Mirrors with Integrated Side View Cameras
- Leatherette Captain's Chairs
- Keyless Entry System
- Windshield Privacy Curtain
- Valve Stem Extenders
- Aluminum Running Boards
- 8,000-lb. Trailer Hitch with 7-pin Round Connector
- Wheel Liners

AUTOMOTIVE & COCKPIT OPTION

- Power Driver's Seat

INTERIOR

- Residential Vinyl Flooring Throughout
- Ceiling Ducted Air Conditioning System in Living Area
- Hard Vinyl Ceiling in Living Area
- Cab-Over Bunk Ladder
- LED Ceiling Lights

- Raised Panel Cabinet Doors with Nickel Finish Hardware
- Leatherette Sofa & Removable Pedestal Table
- Window Privacy Roller Shades
- Tread Plate Non-Slip Flooring in Garage
- Tie Down Rings in Garage

INTERIOR OPTIONS

- Two Opposing Leatherette Jack-Knife Sofas in Garage
- Bug Screen Curtain in Garage
- 12-volt Attic Fan in Cab-Over

KITCHEN

- 6 cu. ft. Double Door Refrigerator with Smoked Acrylic Panel Inserts
- 3-Burner Gas Cooktop
- Convection Microwave Oven
- Laminate Countertops
- Pop-Up Countertop Outlet*
- Decorative Backsplash
- Large, Double Bowl Stainless Steel Sink & Double Handle Kitchen Faucet

KITCHEN OPTION

- 12-volt Attic Fan

BEDROOM & BATHROOM

- Power Vent in Bathroom
- Stainless Steel Bathroom Sink
- Porcelain Toilet
- Shower with Retractable Door

ENTERTAINMENT

- 32" LED TV (HMDI Ready) on Manual Swivel & DVD Player in Cab-Over
- 32" LED TV in Garage
- Bluetooth® Coach Radio System in Garage with Exterior Speakers
- Cable TV Ready
- Digital TV Antenna*
- Power Charging Center for Electronics

ENTERTAINMENT OPTION

- Exterior 32" LED TV

ELECTRICAL & PLUMBING

- Cummins Onan® RV QG 4000 Gas Generator
- 30-amp Shoreline Power Cord
- Automatic Shoreline-to-Generator Transfer Switch
- 13,500 BTU Front Roof Air Conditioner
- 5,000 BTU Air Conditioner in Garage
- Battery Disconnect Switch
- Dual Auxiliary House Batteries
- Emergency Start Switch
- 1,000-watt Entertainment Inverter
- 6-gallon DSI Gas/Electric Water Heater
- Whole Coach Water Filtration System*
- Water Heater Bypass System
- Black Tank Flush System*
- Systems Control Center
- **Rapid Camp®** Wireless Control System

ELECTRICAL & PLUMBING OPTION

- Holding Tanks with Heat Pads

*INCLUDED ON UNITS BUILT AFTER 10/01/15



Made to fit.

MORE THAN JUST A MOTORHOME

The Outlaw Class A expands the limits of what a motorhome could be. Unique, distinctive floor plans, interiors, and sleeping spaces put the Outlaw in a class of its own.

When you're ready to get out of the ordinary and into the extraordinary, the Outlaw has no equal.



LEATHERETTE CAPTAIN'S CHAIRS W/TABLE



38RE | MOONDANCE | GLAZED SYDNEY MAPLE



37RB | METALLIC | GLAZED OLYMPIC CHERRY



38RE | MOONDANCE | GLAZED SYDNEY MAPLE



CLASS A



BEAUTY INSIDE & OUT



METALLIC



MOONDANCE



PARADISE CITY



RUSH HOUR



RESIDENTIAL VINYL FLOORING



COUNTERTOPS



GLAZED OLYMPIC CHERRY



GLAZED VINTAGE MAPLE



CHERRY FIRE FULL-BODY PAINT

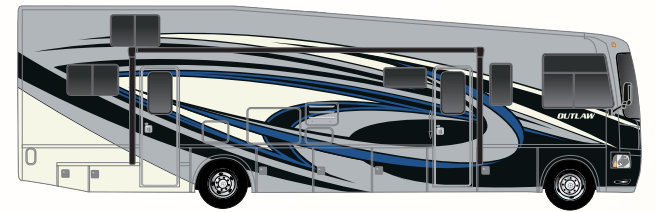

SUPER NOVA FULL-BODY PAINT



OVERDRIVE FULL-BODY PAINT



RED ROCK FULL-BODY PAINT

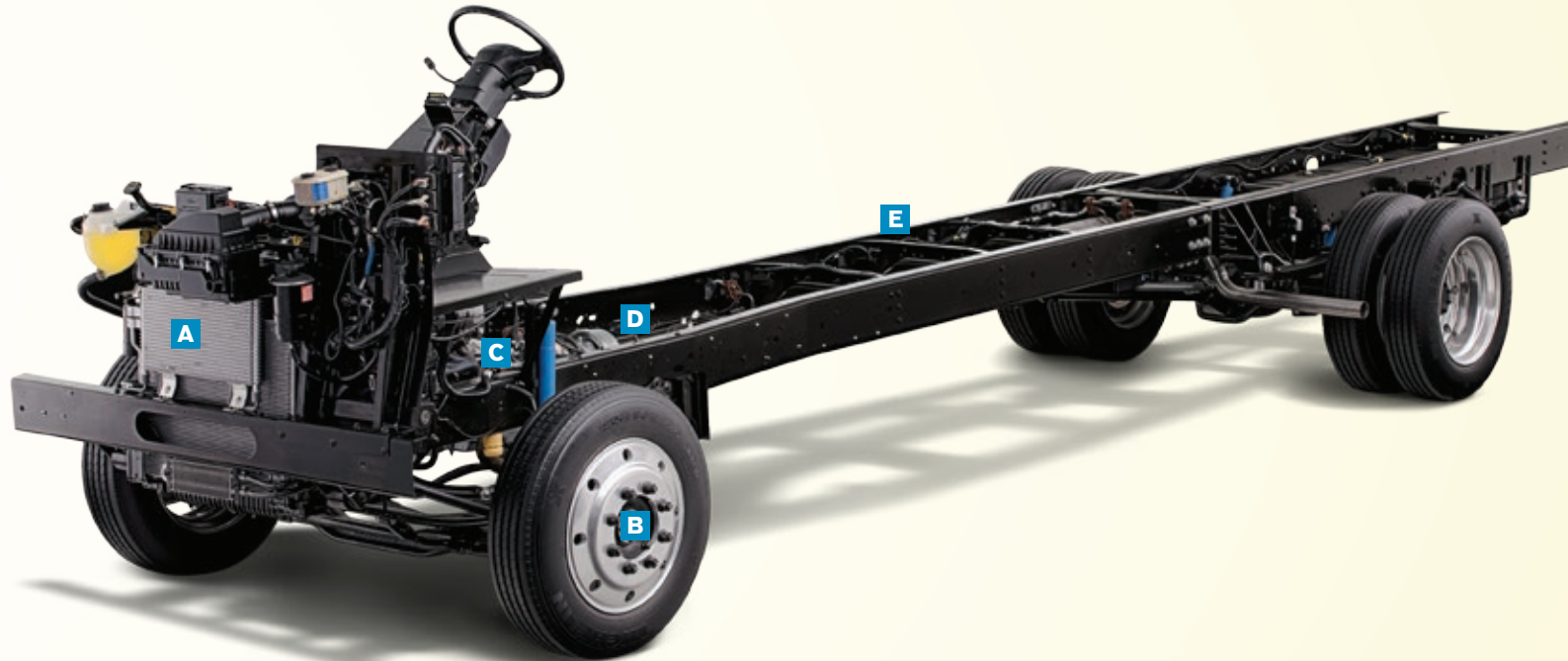

A | TRITON® V10 ENGINE

The 6.8L V10 engine has a proven track record of durability and low-hassle maintenance. Extremely smooth running with a commanding 362-horsepower and 457 lb.-ft. of torque.

B | POWER 4-WHEEL DISC ANTI-LOCK BRAKES

Maintains brake balance in heavy use and varying road conditions. Reduces wheel lock up and helps maintain superior steering control.

C | BILSTEIN SHOCKS

Long lasting, rugged shocks provide greater stability and better road handling.

D | TORQSHIFT™ 6-SPEED AUTOMATIC TRANSMISSION

Provides crisp, firm and quick shifting without sacrificing driver comfort.

E | LIMITED WARRANTY

The Ford® Motorhome Chassis has a Bumper-to-Bumper Limited Warranty for 3 years or 36,000 miles and a Powertrain Limited Warranty for 5 years or 60,000 miles, whichever comes first.

Taking the extra time to ensure the best possible structure is exactly what you deserve, and this is why Thor Motor Coach insists on vacuum-bond laminating not only the sidewalls of the motorhome, but also the floor and roof. Vacuum-bonding is the optimum manufacturing process to ensure maximum strength.



ROOF

- A** One-piece exterior TPO membrane
- B** Luan panels
- C** Aluminum structure with bowed framing
- D** Block foam insulation
- E** Interior panel with soft touch vinyl covering

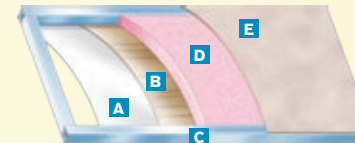

SIDEWALLS

- A** High-gloss or gel-coat fiberglass
- B** Luan panels
- C** Aluminum structure with framing at all openings
- D** Block foam insulation
- E** Interior panel with designer wall covering



FLOOR

- A** Residential vinyl flooring or carpet
- B** OSB structure wood base
- C** Structural steel framing
- D** Block foam insulation
- E** Luan with woven plastic exterior finish

CLASS A FLOOR PLANS

37LS

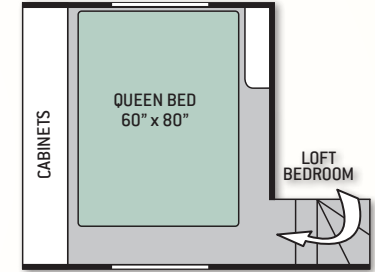
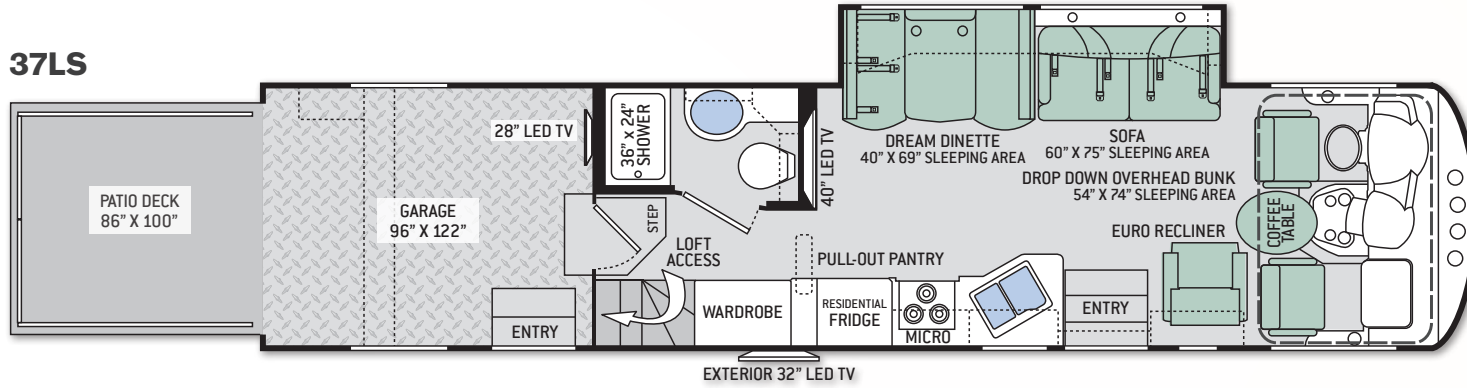

37RB

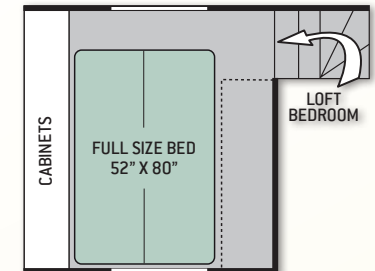
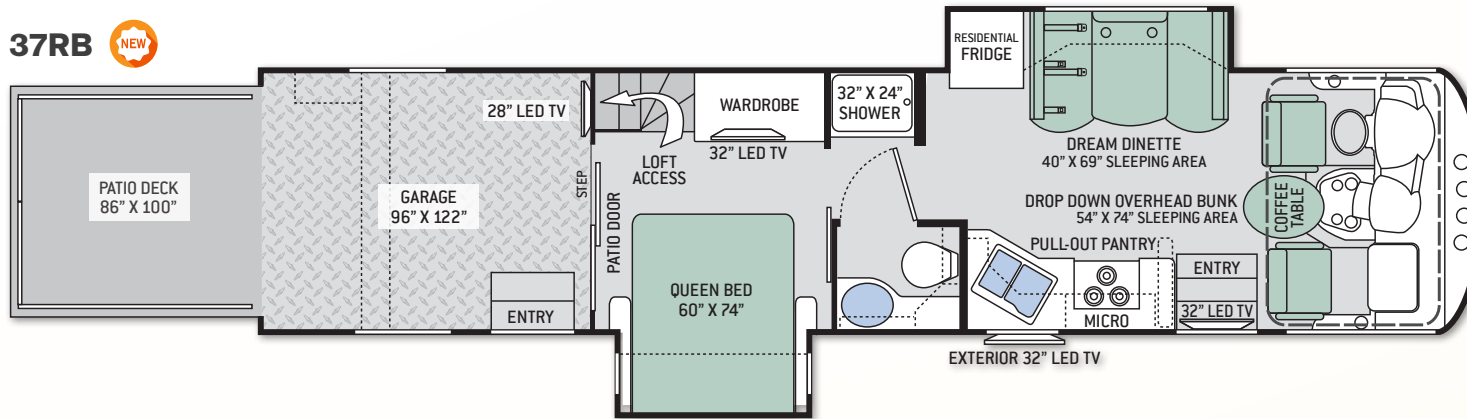

FLOOR PLAN	37LS	37RB	38RE	38RF
Chassis	Ford	Ford	Ford	Ford
Gross Vehicle (GVWR)	26,000	26,000	26,000	26,000
Gross Combined (GCWR)	30,000	30,000	30,000	30,000
Wheel Base	252"	252"	252"	252"
Exterior Length (w/o ladder)	38'-6"	38'-9"	39'-11"	39'-11"
Exterior Height (w/AC)	13'-3"	13'-3"	13'-3"	13'-3"
Exterior Width (w/o mirrors)	101"	101"	101"	101"
Interior Height	80"-97"	80"-97"	80"-105"	80"-105"
Awning Size	21'	9' & 13'	19'	20'
Fuel (gal)	80	80	80	80
LPG (lbs)	105	105	105	105
Fresh/Waste/Gray Water (gal)	100 / 43 / 43	100 / 43 / 43	150 / 40F - 29R / 43	150 / 40F - 29R / 43
Water Heater (gal)	6	6	6	6
Furnace (BTUs)	35,000	35,000	35,000 F - 20,000 R	35,000 F - 20,000 R
Exterior Storage Capacity (cu. ft.)	132	127	158	159

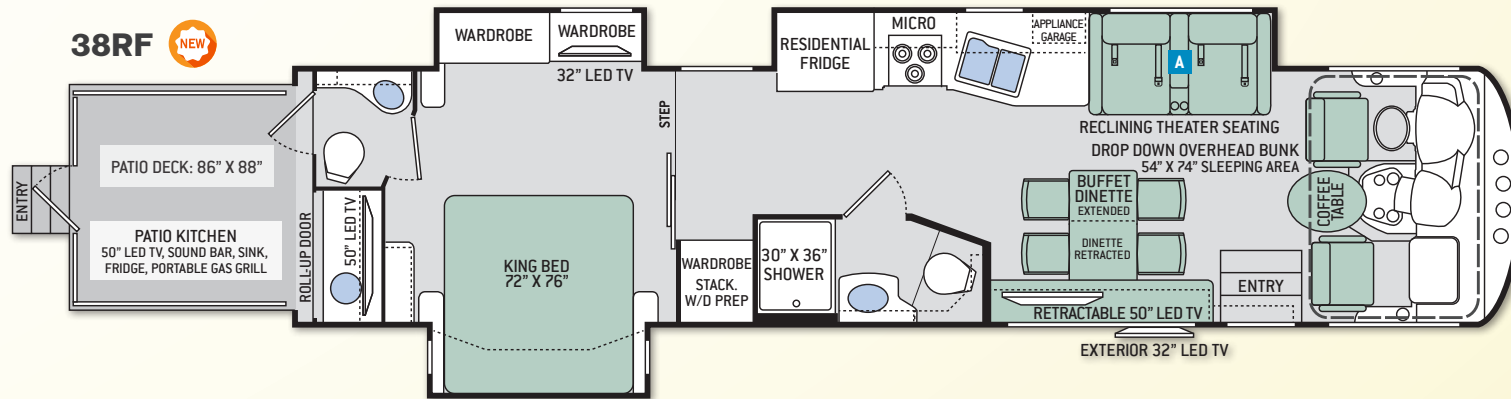
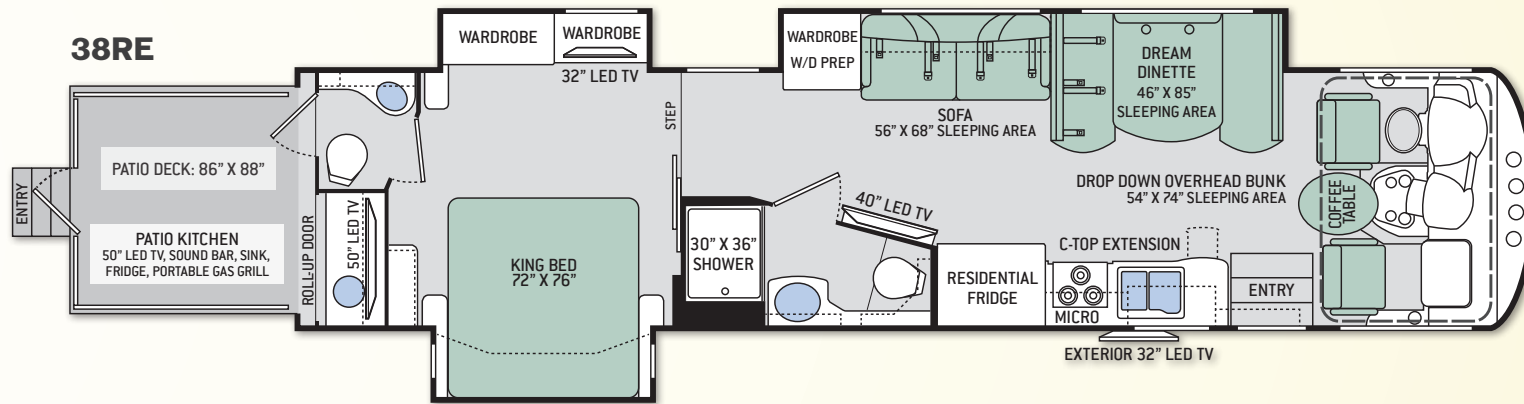

OPTION

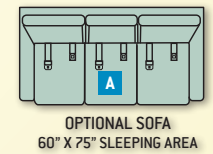

3TRAX™ is our in-wall slideout system, housing all the moving and mechanical parts within the sidewall of the motorhome. This triple track design supports large rooms, like those found in full-wall slideouts, ensuring simple, reliable, maintenance-free operation. What sets 3TRAX™ apart is the patented rail system, in-floor roller guides and electric motor design. For more information, visit thormotorcoach.com/3TRAX.



Made to fit.

CLASS A STANDARDS & OPTIONS

CONSTRUCTION & EXTERIOR

- Ford® F-53 Chassis - 6.8L Triton® V10 Engine, 362HP, 457 lb.-ft. Torque - TorqShift® 6-Speed Automatic with Overdrive Transmission
- Fully Welded Tubular Steel Floor System
- Fully Welded Tubular Aluminum Roof & Sidewall Cage Construction
- Vacu-Bond Laminated Roof, Sidewalls and Floor with High-Density Block Foam Insulation
- Fiberglass Front Cap
- One-Piece Windshield
- Full-Body Paint Package with Gel-Coat Sidewalls
- Automatic Leveling Jacks with Touchpad Controls
- Full Basement Pass-Through Storage
- Rotocast Storage Compartments
- Power Patio Awning with Integrated LED Lighting
- 3TRAX® Wall Slide System (38RE & 38RF) 
- Rear Spot Lights
- Patio Lights
- Double Electric Automatic Entry Step
- Outside Shower
- Frameless Windows
- Pet-Link™ Multi-Purpose Tie-Down
- Drop-Down Ramp Door w/Spring Assist, Patio Railings & Power Patio Awning (37LS & 37RB)
- Drop-Down Patio Deck w/Railings, Staircase to Ground Level & Power Patio Awning (38RE & 38RF)
- Air Ventilation Sidewall Vents in Garage (37LS & 37RB)

CONSTRUCTION & EXTERIOR OPTION

- Frameless Dual Pane Windows

AUTOMOTIVE & COCKPIT

- Touchscreen AM/FM Dash Radio with CD/DVD Player, Bluetooth®, Back-Up Monitor & Mirror Display
- Heated/Remote Exterior Mirrors with Integrated Side View Cameras
- Reclining/Swivel Leatherette Captain's Chairs with Stow-Away Coffee Table in Between
- Cruise Control

- Tilt Steering Wheel
- Electric Windshield Solar & Privacy Shades
- Dash Fans
- Map Light
- 8,000-lb. Trailer Hitch with 7-pin Round Connector
- 22.5" Tires with Aluminum Wheels
- Valve Stem Extenders on Rear Tires
- Rear Mud Flap
- Dash Workstation with 110-volt & 12-volt Outlets

INTERIOR

- Residential Vinyl Flooring Throughout
- 80" Interior Height (At Lowest Point)
- LED Ceiling Lights
- Soft Touch Vinyl Ceiling
- Ceiling Ducted Air Conditioning System in Living Area (37LS & 37RB includes Loft)
- Solid Wood Glazed Cabinetry with Raised Panel Cabinet Doors & Nickel Finish Hardware
- Leatherette Sofa (37LS & 38RE)
- Leatherette Theater Seating (38RF)
- Leatherette Euro Recliner (37LS)
- Leatherette Dream Dinette® Booth (37LS, 37RB & 38RE)
- Buffett Dinette with Two (2) Chairs & Two (2) Folding Chairs (38RF)
- Sofa Pillows
- Power Drop-Down Hide-Away Overhead Bunk with Cotton Cloud™ Mattress & Bunk Ladder
- Window Solar & Privacy Roller Shades in Living Area
- Tread Plate Non-Slip Flooring, Tie Down Rings & Stainless Steel Storage Cabinet in Garage (37LS & 37RB)
- 12-volt Attic Fan in Garage (37LS & 37RB)

INTERIOR OPTIONS

- Leatherette Sofa (38RF)
- Electric Fireplace with Remote Control (37LS & 38RE)
- Bug Screen Curtain in Garage (37LS & 37RB)
- Two (2) Opposing Jack-Knife Sofas in Garage (37LS & 37RB)

KITCHEN

- 11 cu. ft. Double Door Residential Refrigerator (37LS & 37RB)
- 22 cu. ft. Stainless Steel Side-by-Side Residential Refrigerator (38RE & 38RF)
- 3-Burner Gas Cooktop with Oven
- 30" Over-the-Range Microwave Oven
- Solid Surface Countertops & Sink Cover
- Large, Double Bowl Kitchen Sink & Single Handle Faucet w/Pull-Down Sprayer
- 12-volt Attic Fan

BEDROOM & BATHROOM

- Vaulted Ceiling (38RE & 38RF)
- Denver Mattress® King Size Bed with Designer Headboard (38RE & 38RF)
- Denver Mattress® Queen Size Bed (37RB)
- Queen Size Bed in Loft (37LS)
- Full Size Bed in Loft (37RB)
- Bedsread & Pillow Shams
- Privacy Curtain in Loft (37LS)
- Window Privacy Roller Shades in Loft (37LS & 37RB)
- 12-volt Attic Fan in Bathroom
- Foot Flush Porcelain Toilet
- Shower with Glass Door

ENTERTAINMENT

- Entertainment Center with Retractable 50" LED TV in Buffet Dinette & DVD Player in Living Area (38RF)
- Mid-Ship Entertainment Center with 40" LED TV & DVD Player in Living Area (37LS & 38RE)
- Entertainment Center with 32" LED TV & DVD Player in Living Area (37RB)
- 32" LED TV in Bedroom (37RB, 38RE & 38RF)
- 28" LED TV in Garage (37LS & 37RB)
- Exterior 32" LED TV
- TV Ready in Loft (37LS & 37RB)
- Cable TV & HDMI Ready
- Digital TV Antenna*
- Bluetooth® Coach Radio System with Exterior Speakers
- Power Charging Center for Electronics

- Rear Patio Outside Kitchen including 50" LED TV, Bluetooth® Sound Bar, 2.6 cu. ft. Refrigerator, Sink & Portable Gas Grill (38RE & 38RF)

ELECTRICAL & PLUMBING

- Cummins Onan® RV QG 5500 Gas Generator
- 50-amp Shoreline Power Cord
- Dual 13,500 BTU Low Profile Roof Air Conditioners
- 5,000 BTU Air Conditioner in Garage (37LS & 37RB)
- 6,000 BTU Air Conditioner with Remote in Bedroom* (38RE & 38RF)
- Emergency Start Switch
- Battery Disconnect Switch
- Four (4) Auxiliary House Batteries
- 1800-watt Inverter
- 55-amp Converter
- 6-gallon DSI Gas/Electric Water Heater
- Whole Coach Water Filtration System*
- Water Heater Bypass System
- Enclosed & Heated Holding Tanks
- Black Tank Flush System
- Washer/Dryer Prep (37LS, 38RE & 38RF)
- Systems Control Center
- **Rapid Camp®** Wireless Control System

*INCLUDED ON UNITS BUILT AFTER 10/01/15

IT'S NEVER BEEN THIS EASY.

Whether you choose a Class C or Class A Outlaw, you can entertain or relax on your own ultimate patio deck. Safety railings line the edges of the deck for peace of mind while the garage radio with Bluetooth® lets you enjoy the big game or your favorite tunes!



NON-SLIP FLOORING & TIE-DOWN RINGS



37LS & 37RB | OPTIONAL JACK-KNIFE SOFAS



38RE & 38RF | PATIO DECK FEATURING KITCHENETTE & 50" LED TV



Thor Motor Coach is the industry leader in innovative design and builds a variety of unique styles, sizes and floor plans that feel custom-made – at a truly competitive price.

IMPORTANT-PLEASE READ: This brochure reflects product design, fabrication, material, components and specifications at the date of printing, which date is disclosed below. Please visit us online at ThorMotorCoach.com or consult with your selling dealership for the latest in standards, options, specification and technical information. Photographs in the brochure may depict optional equipment or may only be available in certain floor plans. Components, appliances and the chassis may have been manufactured in a calendar year before the vehicle's designated model year. All capacities are approximate. The actual length of the vehicle may differ from that indicated in the brochure due to variances in the manufacturing processes and/or installed components. All dry weights are based on standard model features and do not include optional features or equipment. Component part and appliance manufacturers issue limited warranties covering portions of the vehicle not covered under the limited warranty we issue. Copyright Thor Motor Coach, Inc. © 12/15/15

YOUR LOCAL THOR MOTOR COACH DEALER



Made to fit.

P.O. Box 1486, Elkhart, IN 46515
Sales Department: 800.860.5658
Customer Service: 877.855.2867

thormotorcoach.com/outlaw