

*INDUSTRIAL LUXURY LIGHTWEIGHT*  
**PREMIER**

*— ULTRA LITE BY BULLET —*



[www.keystonerv.com/Premier](http://www.keystonerv.com/Premier)



[www.keystonerv.com/premier](http://www.keystonerv.com/premier)

# PREMIER

ULTRA LITE BY BULLET



***EASY TO TOW WITH THE NEW MORE FUEL EFFICIENT CROSSOVERS, CARS AND TRUCKS, THE PREMIER ULTRA LITE TRAVEL TRAILER HERALDS IN A NEW GENERATION OF RVs.***

*Sleek and smooth on the outside and loaded with features and conveniences inside, the new Premier Ultra Lite will set you free to explore the open road.*



**PREMIER 30R1PR KITCHEN**



**PREMIER 30RIPR SHOWN IN SADDLE DECOR**



**PREMIER 30RIPR LIVING AREA**



**PREMIER 30RIPR BEDROOM**



**EXTERIOR KITCHEN  
(AVAILABLE ON 22RBPR, 31BHPR, 34BHPR)**



**THE INDUSTRY'S FIRST, LUXURY  
ULTRA LITE NOW HAS DEEPER  
SLIDES AND MORE FEATURES!**

**← 3 FEET WIDE! →**

**PREMIER 34BHPR SHOWN IN SADDLE DECOR**



**PREMIER 34BHPR KITCHEN**

**CONVENIENCE,  
COMFORT & STYLE**

**LAUNDRY CHUTE IN EVERY  
PREMIER FLOOR PLAN**



**PREMIER 34BHPR BEDROOM SHOWN IN SADDLE DECOR**



**PREMIER 34BHPR BUNK ROOM SHOWN IN SADDLE DECOR 5**



**ELECTRIC ADJUSTABLE AWNING WITH LED LIGHTING**



**STOR-MOR DINETTE DRAWERS ON STEEL BALL BEARING DRAWER GUIDES**



**MULLION DOORS**



**LARGEST PASS-THRU STORAGE IN ITS CLASS**



**LAUNDRY CHUTE IN THE MASTER BEDROOM**



**FRAMELESS TINTED WINDOWS**



**PROGRESSIVE INTERIOR LIGHTING IN MASTER BEDROOM**



**TRI-FOLD SOFA**



**MAX DEPTH SLIDEOUT ROOM IS 36" DEEP**

## COMPARE PREMIER'S DINETTE TO THE COMPETITION



**LARGE RADIUS DINETTE (N/A 19FB & 22RB)**

### PREMIER

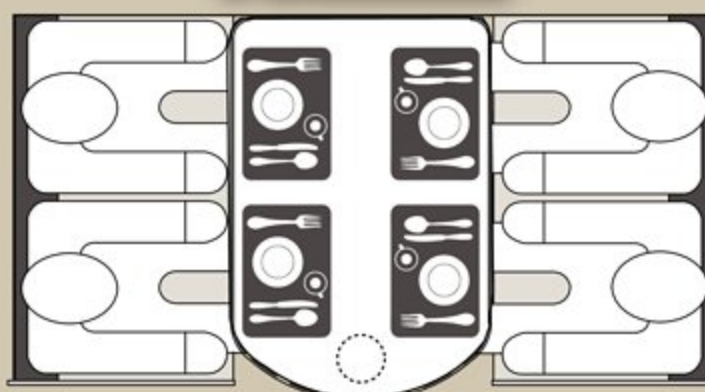

**COMFORTABLY SEATS 4 ADULTS**

- PLENTY OF ROOM FOR 4 PLACEMATS
- ONLY NEEDS ONE TABLE SUPPORT
- CONVERTS TO 80" BED

### COMPETITION

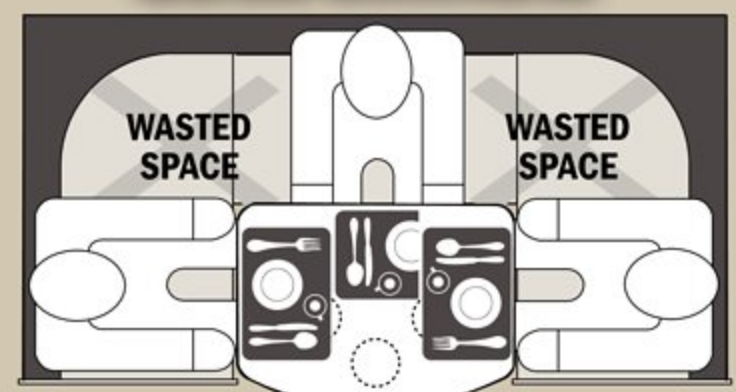

**DON'T BE FOOLED! ONLY SEATS 3 ADULTS**

- ONLY ENOUGH ROOM FOR 2.5 PLACEMATS
- 3 PEDESTAL SUPPORTS REDUCE LEG ROOM
- ALSO CONVERTS TO 80" BED



**8 CU. FT. REFRIGERATOR**



**RETRACTABLE KITCHEN FAUCET**

[www.keystonerv.com/premier](http://www.keystonerv.com/premier)  
**PREMIER**  
— ULTRA LITE BY BULLET —

**LUXURY FEATURES**  
that matter most in  
**Ultra-Lites.**



**CD/DVD/AM/FM/MP3  
BLUETOOTH STEREO**



**SLAM LATCH PASS THRU  
STORAGE DOORS**



**STORAGE UNDERNEATH THE  
QUEEN BED**



**ROLLED ROOF EDGE PROMOTES  
INCREASED WATER RUNOFF**



**LED PUCK CEILING LIGHTS**



**RAISED PANEL CABINETRY**



Premier is the only ultra lite travel trailer to offer the following climate control features in all floorplans:



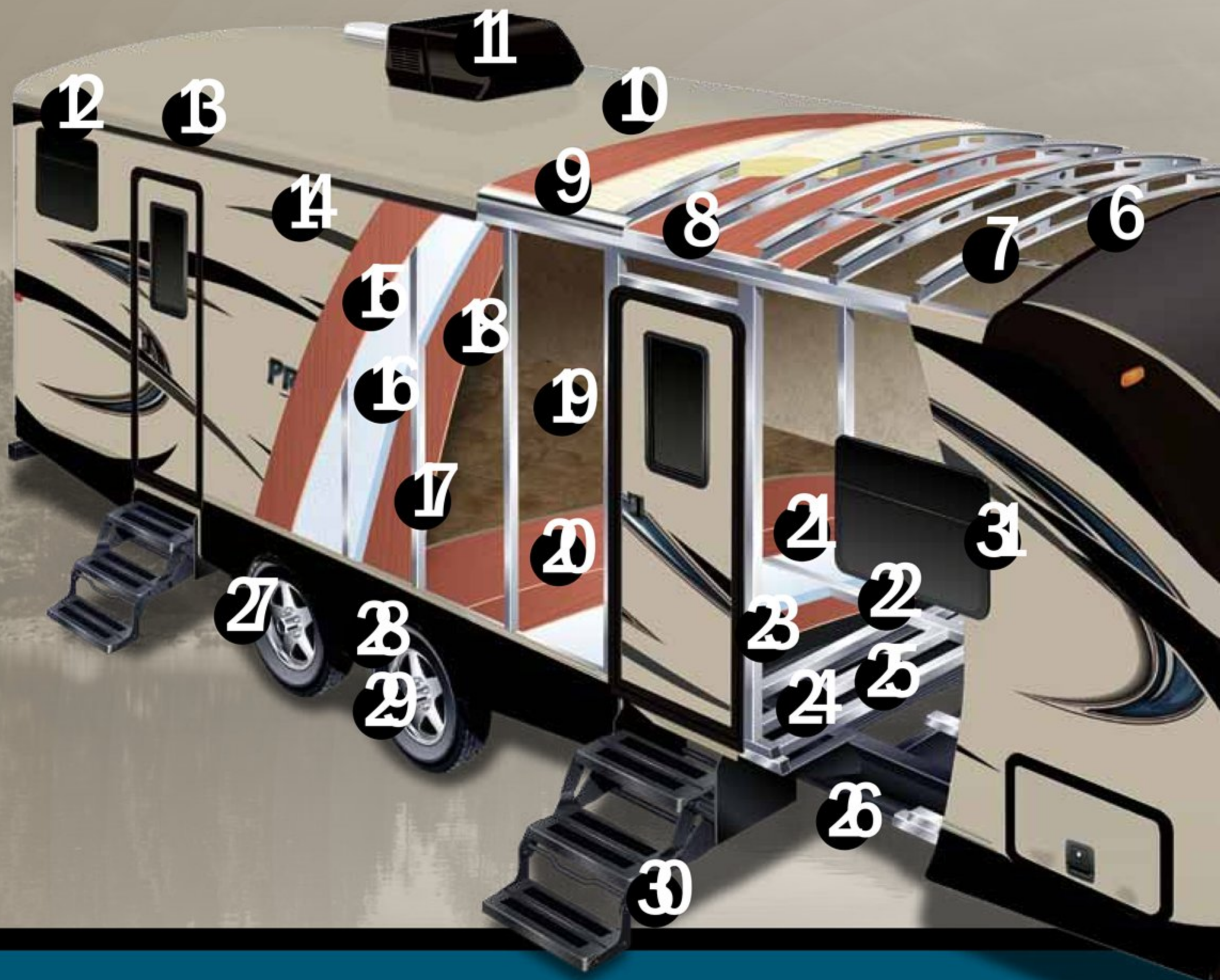

<b>PREMIER</b>	<b>COMPETITION</b>
Enclosed underbelly	Exposed Tanks
2" pipe off of furnace with forced air into underbelly and radiant heat	Radiant Heat Only
30,000 BTU Furnace	20,000 - 25,000 BTU Furnace
Ducted Heat and A/C	Non Ducted Heat and A/C



## BENEFITS OF A MOLDED PAINTED FIBERGLASS FRONT CAP



### PREMIER vs.

- 
 1/4" Thick molded painted fiberglass won't cold crack and is strong enough to hold up to rock damage unlike competitors ABS panels.
- 
 High gloss finish eliminates the fading that happens over time on ABS panels.
- 
 Molded over edges of front end of trailer to prevent leaks
- 
 Radius shape vertically and also side to side for superior aerodynamics

### COMPETITION





# PREMIER

— ULTRA LITE BY BULLET —

## LIGHTWEIGHT SOLID CONSTRUCTION



1. Power Tongue Jack
2. Quick Access LP Cover
3. Integrated Dual Battery Tray
4. LED Docking Lights
5. Dual Radius Fiberglass Front Cap
6. 5" Radius Galvanized Stamped Steel Roof Trusses
7. Hurricane Straps
8. Fully Insulated Roof
9. Durable Roof Decking
10. One Piece TPO Roof
11. 13,500 BTU Quick Cool Air Conditioning (optional 15,000 BTU)
12. Full Length Rain Gutter and 4" Drip Spouts
13. Rolled Roof Edge
14. Smooth Fiberglass Exterior
15. 1/8" Luan Wall Backing
16. Hi-Density Block Foam Insulation
17. 1 1/2" Box Double Welded Aluminum Frame Structure
18. Decorative Interior Wall Board
19. Residential Stain Resistant Trek Linoleum (resistant to cold cracking)
20. Plyvener Floor Decking (water resistant)
21. Hi-Density In Floor Block Foam Insulation
22. Double Welded Aluminum Floor Joists
23. 3rd Layer Floor Decking
24. 6.5" - 10" Steel I-Beam Frame
25. Darco Vapor Barrier Wrap
26. Enclosed Underbelly
27. Radial Tires with Electric Brakes (4)
28. 43" Wide Stance Axles
29. Easy Lube Axles
30. Triple Entry Radius Entry Steps
31. Frameless Jalousie Tinted Windows

## BEST TOWING TRAVEL TRAILER IN THE INDUSTRY

*Increased MPG and Easier to tow*



*The rear departure angle increases efficiency of windflow underneath and behind the trailer.*



*The enclosed underbelly eliminates turbulence caused by exposed frame members, holding tanks, plumbing etc.*



*43" wide stance axle greatly reduces sway and bouncing*

# TRAVEL TRAILER FLOORPLANS

You'll find a Premier floorplan to fit your lifestyle perfectly.



19FBPR



22RBPR



30REPR



30RIPR

*Stay in Touch*



Premier is always just a touch away. You'll find 360 virtual tours, location of your nearest dealer, photos, videos and all of the latest information about Premier on our easy to navigate website. Everything you need can be accessed anytime, day or night, from home or on the road. You can also find us on the Keystone RV facebook.

[www.keystonerv.com/premier](http://www.keystonerv.com/premier)

# PREMIER

— ULTRA LITE BY BULLET —



26RBPR



29BHPR

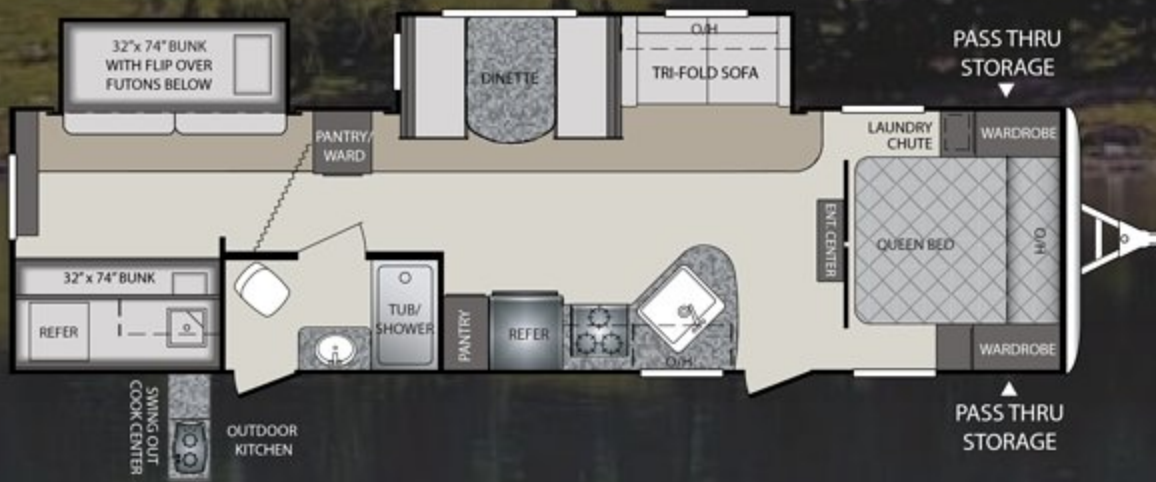

31BHPR

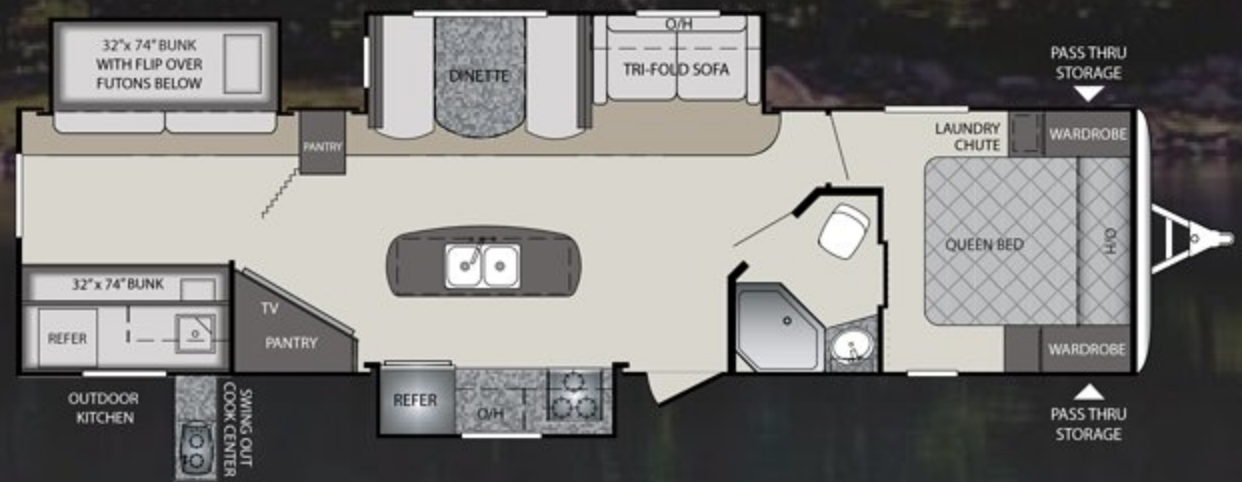

34BHPR

## WEIGHTS & MEASUREMENTS

TRAVEL TRAILERS	19FBPR	22RBPR	26RBPR	29BHPR	30REPR	30RIPR	31BHPR	34BHPR
SHIPPING WEIGHT	4206	4765	5788	6260	6463	6850	6482	7079
CARRYING CAPACITY	2294	1735	1712	1490	1537	1350	1518	1721
HITCH WEIGHT	410	510	835	835	745	790	795	845
EXTERIOR LENGTH	23' 2"	25' 6"	30' 6"	33' 8"	34' 11"	35' 4"	35' 4"	37' 0"
EXTERIOR WIDTH	8'	8'	8'	8'	8'	8'	8'	8'
EXT. HEIGHT - A/C TOP	10' 11"	10' 11"	10' 11"	10' 11"	10' 11"	10' 11"	10' 11"	11' 0"
FRESH WATER (GAL.)	43	43	43	43	43	43	43	43
WASTE WATER (GAL.)	30	30	30	30	30	30	30	30
GRAY WATER (GAL.)	30	30	60	60	30	60	30	60
LP CAPACITY (LBS.)	40	40	40	40	40	40	40	40

Product information is as accurate as possible at the date of publication of this brochure. Features, floor plans, and specifications are subject to change without notice. Please also consult Keystone's web site at keystonerv.com for more current product information and specifications. Tow Vehicle Disclaimer: CAUTION: Owners of Keystone recreational vehicles are solely responsible for the selection and proper use of tow vehicles. All customers should consult with a motor vehicle manufacturer or their dealer concerning the purchase and use of suitable tow vehicles for Keystone products. Keystone disclaims any liability or damages suffered as a result of the selection, operation, use or misuse of a tow vehicle. KEYSTONE'S LIMITED WARRANTY DOES NOT COVER DAMAGE TO THE RECREATIONAL VEHICLE OR THE TOW VEHICLE AS A RESULT OF THE SELECTION, OPERATION, USE OR MISUSE OF THE TOW VEHICLE.

# STANDARDS & OPTIONS

## CONSTRUCTION STANDARDS

- Aggressive Front Profile for Increased Towability
- Aluminum Framed Front, Rear, and Side Walls
- Aluminum Framed Slideouts
- Laminated Fiberglass Exterior Side Walls
- 2" Thick Laminated Aluminum Floor
- In Frame Fresh, Grey, and Black Water Tanks
- 6.5" - 10" Steel I-Beam with Full-Length Welded Outrigger
- 1/4" ABS Enclosed Underbelly
- Darco Moisture Barrier
- One Piece TPO Roof
- E-Z Lube Axles
- Electric Brake System (4 wheels)
- R-11 Insulation in Floor
- R-7 Insulation in Sidewalls
- R-11 Insulation in Roof

## EXTERIOR CAMPING PACKAGE

- Wide Stance E-Z Lube Axles
- 6 Gallon Gas/Electric DSI Water Heater with Quick Recovery
- Radius Entry Door with Gas Strut
- Outside Speakers
- Outside Shower (Hot and Cold Water)
- 4 Stabilizer Jacks
- TV Antenna and Cable Hook-Up
- Electric Awning with LED Lights
- Radial Tires
- Black Tank Flush

## EXTERIOR FEATURES

- Outdoor Kitchen with Galvanized Countertop (22RBPR, 30RIPR, 31BHPR, 34BHPR)
- Aluminum Wheels
- Dual Propane Tanks with Cover
- In Frame Dual Battery Rack
- Oversized Exterior Pass Thru Storage with Lighting
- LP Quick Connect
- Amber Patio Light
- Spare Tire
- Oversized Grab Handle (main door)
- Triple Entry Steps
- Slam Baggage Doors

## INTERIOR CAMPING PACKAGE

- 13.5 BTU Ducted A/C
- Night Shades
- CD/DVD/AM/FM Bluetooth Stereo with Aux and I-Pod Hookup
- 32" LED TV (19FBPR, 22RBPR, 30REPR, 31BHPR)
- 42" LED TV (26RBPR, 29BHPR, 30RIPR, 34BH)
- Microwave
- 8 cu./ft. Double Door Refrigerator
- 3 Burner High Output Range
- Retractable Faucet
- All Raised Panel Hardwood Cabinet Doors
- Foot Flush Toilet
- Tub Surround with Shelves
- Full Extension Drawer Glides
- Tri-Fold Sofa (N/A 19FBPR, 22RBPR)
- Stainless Steel Sink

## INTERIOR FEATURES

- 6' 11" Vaulted Ceiling
- Flexible Fiberglass Reinforced Flooring
- Upgraded Residential Furniture
- Night Shades in Living Area
- 17" Oven
- Back Splash (residential)
- Stor-mor Dinette
- Retractable Kitchen Faucet

## BATHROOM

- Oversized Showers w/GlassDoor (N/A on 19FBPR, 31BHPR)
- Power Vent Fan
- Solid Wood Medicine Cabinet
- Linen Storage

## MASTER BEDROOM

- Upgraded Foam Mattress
- Mirrored Wardrobes
- Laundry Chute
- Under Bed Storage
- Individual Reading Lights
- Accent Wallboard

## SAFETY EQUIPMENT

- Carbon Monoxide Detector
- Smoke Alarm
- Fire Extinguisher
- Electric Brakes
- Safety Chains
- Frameless Tinted Safety Glass Windows, Egress Windows (Fire Escape)
- GFI Receipts

## OPTIONS

- Bumper Mounted Aussie Grill
- 15K A/C
- 50 AMP Service w/Wire and Brace for second A/C (N/A 19FBPR, 22RBPR)

## THERMAL PACKAGE

- Ducted Heat and Enclosed Underbelly
- 2" Pipe off of Furnace to Underbelly
- 30K BTU Furnace and Residential Heat Ducts
- Radiant Heat



## PREMIER PACKAGE

- Aerodynamic Fiberglass Front Cap
- Vaulted Ceiling System
- Frameless Tinted Windows
- Power Tongue Jack
- Tri-Fold Sofa
- Max Depth Slides
- LED Flush Mounted Puck Lighting
- Upgraded Exterior Graphics Package
- Black Tank Flush

DUNE



SADDLE



CHARCOAL



YOUR LOCAL DEALER:



Go RVing  
Life's A Trip

[www.keystonerv.com/Premier](http://www.keystonerv.com/Premier)

**PREMIER**  
— ULTRA LITE BY BULLET —

 **Keystone RV Company**  
[www.keystonerv.com](http://www.keystonerv.com)

2642 Hackberry Drive | PO Box 2000  
Goshen, IN 46527-2000  
(574) 535-2100

NOVEMBER 2014